

1/81 WTO

Recorded by WTO

Date 6/3/82

*need to field check Loc.??*

DOH # 7000 11-02 34  
U.S. GEOLOGICAL SURVEY  
WATER RESOURCES DIVISION  
MISSISSIPPI DISTRICT  
WELL RECORD

Walnut

GW897

Well No. B21  
E-Log No. 28  
County Tippah

TRANSMITTED FOR ADP 12/82

Site ID 3.4.5.7.10.0.8.8.5.3.5.6.0.1 R=0\* \*T=A\* 2=W\*

GEN. SITE DATA

Data reliab. 3=C\* Report. agency 4=USGS\* Dist. 6=28\* 7=28\* Co. 8=1.39\*

Lat. Long 9=3.4.5.7.10\* 10=0.8.8.5.3.5.6\* Well No. 12=8027\*

Location 13=NWSE S 32 T 01 S R 04 E\* Alt. 16=500.\* 470

Hyd. Unit (OWDC) 20=---\* Date 21=04/13/1982\*

Well use 23=W\* Water Use 24=P\* Hole depth 27=1023.\* Well depth 28=952.\*

WL 30=1.57\* Date 31=07/01/1982\* Source 33=D\*

*see GW 397 file*

Status 273=---\* Project No. 5=---\*

OWNER

R=158\* T=A\* Date 159#07/01/1982\* Owner No. Well #2

Owner 161#WALNUT\*

FIELD OV

R=192\* T=A\* Date 193#    /   /   \* Temp. 196#00010\* 197=   .\*

R=192\* T=A\* Date 193#    /   /   \* Cond. 196#00095\* 197=   .\*

R=192\* T=A\* Date 193#    /   /   \* pH 196#00400\* 197=   .\*

CONSTR.

R=58\* T=A\* 59#1\* Date 60=07/01/1982\* Remarks

Drlg. 63=330\* Name Herndon Method 65=H\* Finish 66=G\*

CASING

R=76\* T=A\* 59#1\*

Top csgn. 77# 0.\* Bot. csgn. 78=866.\* Diam. 79# 1.0.\*

R=76\* T=A\* 59#1\*

Top csgn. 77# 800.\* Bot. csgn. 78=866.\* Diam. 79# 6.\*

*R=76\* T=A\* 59#1\* 77#892.\* 78=911.\* 79#6.\**

OPENINGS

R=82\* T=A\* 59#1\* Top 83# 866.\* Bottom 84=892.\*

Type 85=S\* Diam. 87=6.\* Size 88=   .\*

R=82\* T=A\* 59#1\* Top 83# 911.\* Bottom 84=952.\*

Type 85=S\* Diam. 87=6.\* Size 88=   .\*

YIELD

R=146\* T=A\* 147# 1\* Q 150=317.\* Q/S 272=   .\*

134 Flows 146 pumped

R=42\* T= A \* Lift type 43# T\* Intake 44= \* Power type 45= E\*

LIFT Date 38= 07/01/1982\* H.P. 46= 40.\*

LOGS R=198\* T= A \* Log 199# E\* Top 200= 400\* Bot 201= 1020.\*  
 R=198\* T= A \* Log 199# D\* Top 200= 0.\* Bot 201= 1023.\*  
 R=189\* T= A \* E Log No. 190# 028\* 191= M I S S D I S T \*

ANAL. R=114\* T= A \* Year 115# \* 117= \* 120= \*

AQUIFERS R=90\* T= A \* 256# 1 \* Top 91= 865.\* Bot 92= \*  
 Unit ID 93= ZILCOFF \* Name of Unit  
 R=90\* T= A \* 256# 1 \* Top 91= \* Bot 92= \*  
 Unit ID 93= \* Name of Unit

HYDRAULICS R=98\* T= A \* 99# 1 \* Unit tested 100= \* 103= \*  
 R=105\* T= A \* 99# 1 \* Test No. 106# \*  
 107= \* Transmissivity (gal/d)/ft  
 108= \* Hydraul. cond. (gal/d)/ft<sup>2</sup>  
 110= \* Storage coeff. Boundaries

R=121\* T= \* Yr Begin 122# \* Network 258#

Water Level Data Collection (1)

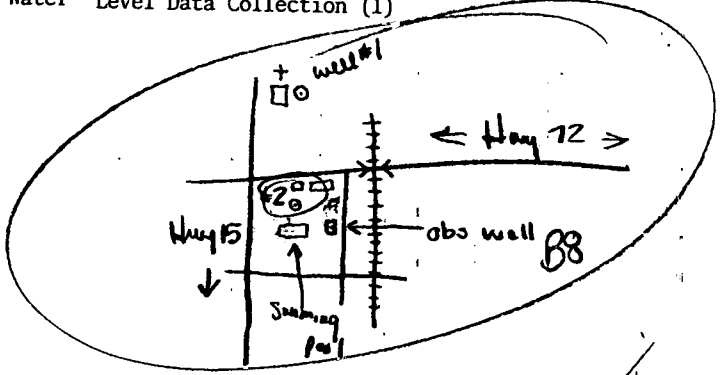

description of formations encountered	from	to
Brown Sandy Clay	0	10
Blue Sand	10	30
Blue Sandy Clay	30	90
Rock	90	95
Shale	95	105
Blue Sandy Clay	105	123
Hard Rock	123	124
Red Sand	124	140
Hard Rock	140	142
Brown Sandy Clay	142	152
Hard Rock	152	154
Sand, Coarse & Gravel	154	175
Hard Rock	175	180
Sand w/streaks of Clay	180	283
Blue Clay	283	295
Sand w/Clay Streaks, Shale	295	400
Blue Clay	400	760
Sandy Blue Clay	760	803
Sand	803	845
Sandy Blue Clay	845	860
Sand	860	890
Sandy Blue Clay	890	910
Sand	910	943
Sandy Clay	948	974
Tight Sand	974	1023
Hard Rock	1023	

See Permit GW 397 SW/SE

?? these are not in NE/SE possibly should be NW/SE

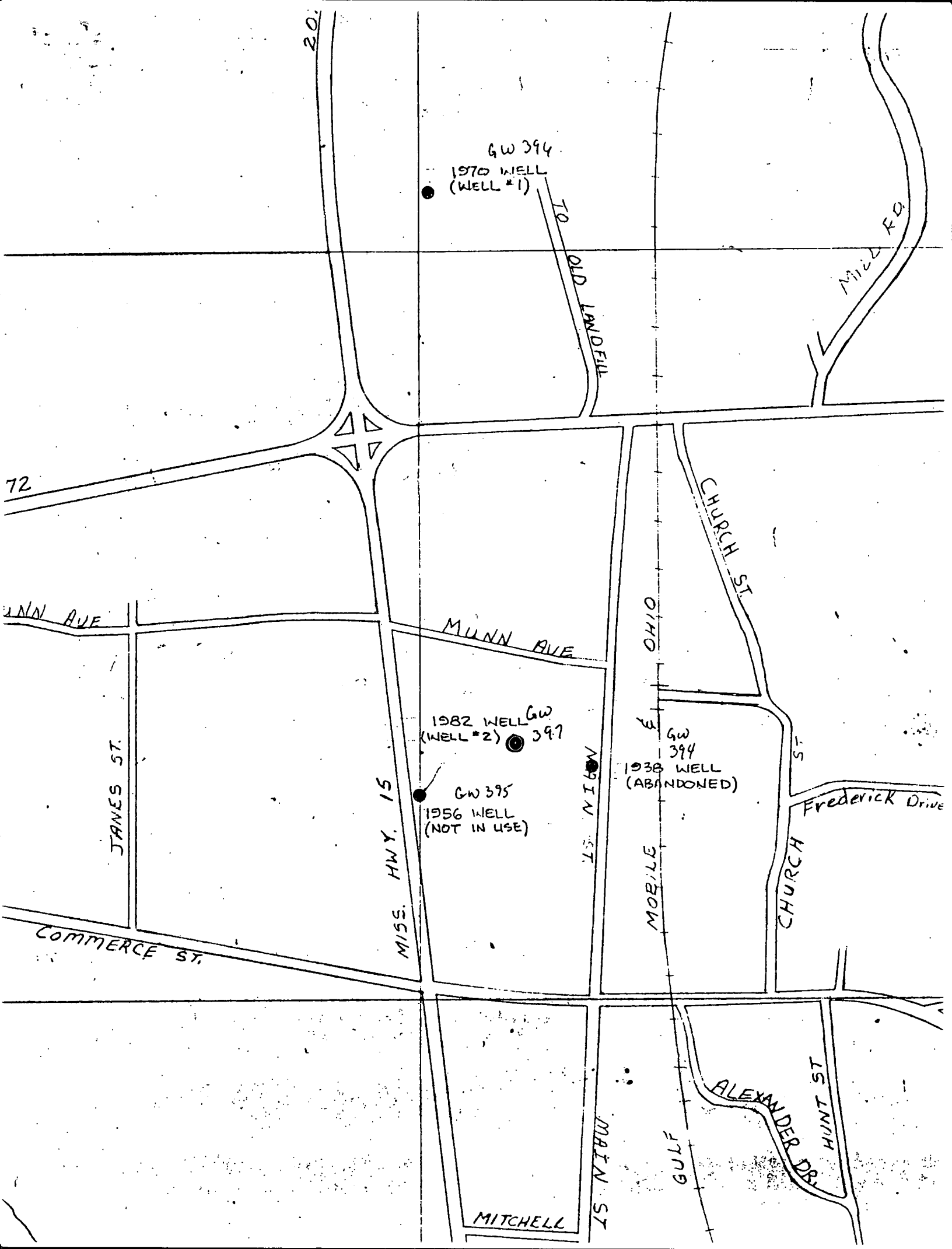

GW 394  
1970 WELL  
(WELL #1)

1982 WELL  
(WELL #2) GW 397

GW 395  
1956 WELL  
(NOT IN USE)

GW 394  
1938 WELL  
(ABANDONED)

20.

72

MUNN AVE

JAMES ST.

COMMERCER ST.

MISS. HWY. 15

MUNN AVE

MAIN ST.

MITCHELL

MAIN ST.

OHIO

MOBILE

CHURCH ST.

CHURCH ST.

FREDERICK DRIVE

ALEXANDER DR.

HUNT ST.

TO OLD LANDFILL

MILL RD.

TIPPAH  
B27  
7-82

MISSISSIPPI  
BOARD OF WATER COMMISSIONERS  
416 North State Street  
Jackson, Mississippi 39201

CODED

WATER WELL DRILLERS LOG

7 1982 Herndon Well & Supply, Inc. Tippah  
date well completed firm name county well located

LANDOWNER: Town of Walnut	description of formations encountered	from	to
Walnut, MS 38683 (mailing address)	Brown Sandy Clay	0	10
	Blue Sand	10	30
	Blue Sandy Clay	30	90
WELL LOCATION: sec. 32 T. 01 N. R. 04 E S S E	Rock	90	95
	Shale	95	105
	Blue Sandy Clay	105	123
	Hard Rock	123	124
(distance) miles (direction) of (nearest town)	Red Sand	124	140
WELL PURPOSE: Municipal (home, irrigation, municipal, industrial)	Hard Rock	140	142
WELL COMPLETION DATA:	Brown Sandy Clay	142	152
(1) diameter (inches) 10"	Hard Rock	152	154
(2) total depth (feet) 952'	Sand, Coarse & Gravel	154	175
(3) static water level (feet) 157' below top of ground.	Hard Rock	175	180
(4) casing Steel 872.73' (material) (depth)	Sand w/streaks of Clay	180	283
10" (size) if telescope see back.	Blue Clay	283	295
(5) screen 66.25' 866.15' (length) (depth to top)	Sand w/Clay Streaks, Shale	295	400
6" (size) Stainless Steel (material)	Blue Clay	400	760
(6) pump 40 HP 317 (yield gpm)	Sandy Blue Clay	760	803
electric (type power)	Sand	803	845
(7) electric log yes (yes or no)	Sandy Blue Clay	845	860
(organization running log)	Sand	860	890
(8) how well bottom plugged 6" BWV	Sandy Blue Clay	890	910
	Sand	910	948
	Sandy Clay	948	974
	Tight Sand	974	1023
	Hard Rock	1023	
DRILLERS REMARKS:			

CODED

DEPT. OF NATURAL RESOURCES  
BUREAU OF LAND & WATER RESOURCES

SEP 20 1982

RECEIVED

If well telescopes please sketch and show depths.

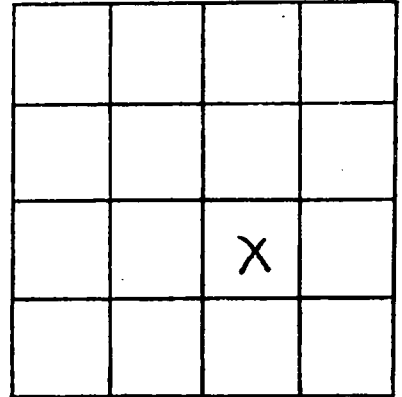
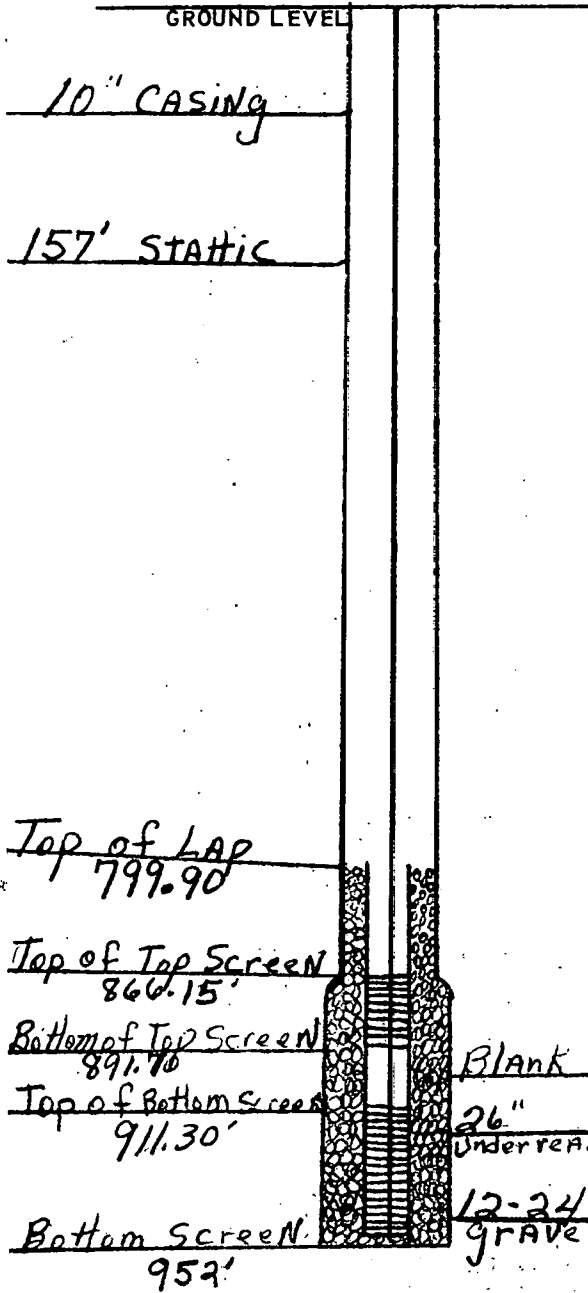

SECTION 32

Please indicate well location X.

ADDITIONAL INFORMATION

If more than one screen, show locations of each on sketch.

WALNUT  
Quad.



3870

57'30"

THEO 9 MI.  
CORINTH 19 MI.

3869

T 1 S

T 2 S

3868

(CHALYBEATE)  
3253 IV NE

3867

3866

72 BR 416

Sewage Disposal  
Pond

Walnut

Radio  
Tower

Hobkins-Cem

Creek

Big

Mia

Branch

Harmony  
Ch

Sandy

Christ Temple

15

430 Creek

430 CREEK

BR 423

BR 42

Moriah

512

527

518

438

440

31

7

32

5

8

33

4

10

452

460

460

460

460

460

460

460

460

460

460

460

460

460

460

460

452

460

460

460

460

460

460

460

460

460

460

460

460

460

460

460

452

460

460

460

460

460

460

460

460

460

460

460

460

460

460

460

452

460

460

460

460

460

460

460

460

460

460

460

460

460

460

460

452

460

460

460

460

460

460

460

460

460

460

460

460

460

460

460

452

460

460

460

460

460

460

460

460

460

460

460

460

460

460

460

452

460

460

460

460

460

460

460

460

460

460

460

460

460

460

460

452

460

460

460

460

460

460

460

460

460

460

460

460

460

460

460

452

460

460

460

460

460

460

460

460

460

460

460

460

460

460

460

452

460

460

460

460

460

460

460

460

460

460

460

460

460

460

460

452

460

460

460

460

460

460

460

460

460

460

460

460

460

460

460

452

460

460

460

460

460

460

460

460

460

460

460

460

460

460

460

452

460

460

460

460

460

460

460

460

460

460

460

460

460

460

460