

Abandoned

GW394

138

FORM 9-1642 (1-68)

Well No.

WELL SCHEDULE

U. S. DEPT. OF THE INTERIOR

GEOLOGICAL SURVEY

WATER RESOURCES DIVISION

PUNCHED AND VERIFIED
ROLLA COMPUTATION BRANCH

MASTER CARD ?

H.C.W. Banks 7/24/40 Walnut

Record by **ENB** Source of data **driller** Date **3/57** Map

State **28** County (or town) **TIPPAN** **70**

Latitude: **34** **56** **58** **N** Longitude: **08** **8** **53** **41** Sequential number: **1**

Lat-long accuracy: **2** T. **1** S. R. **4** W. Sec **32** SE 1/4, SW 1/4, SE 1/4

Local well number: **13008** **D3201** **S04E** Other number: ~~13008~~

Local use: **064** Owner or name: **Town of Walnut**

Owner or name: **WALNUT** Address: **This was the first walnut well, but has been abandoned**

Ownership: County, Fed Gov't, City, Corp or Co, Private, State Agency, Water Dist **M**

Use of water: (A) Air cond, Bottling, Comm, Dewater, Power, Fire, Dom, Irr, Med, Ind, P S, Rec, (S) Stock, Instit, Unused, Repressure, Recharge, Desal-P S, Desal-other, Other **U**

Use of well: (A) Anode, Drain, Seismic, Heat Res, Obs, Oil-gas, Recharge, Test, Unused, Withdraw, Waste, Destroyed. **U**

DATA AVAILABLE: Well data Freq. W/L meas.: Field aquifer char.

Hyd. lab. data:

Qual. water data; type: **USGS 12/54**

Freq. sampling: Pumpage inventory: no, period:

Aperture cards:

Log data: **log in file**

WELL-DESCRIPTION CARD

SAME AS ON MASTER CARD Depth well: **147** ft Meas. rept. accuracy **3**

Depth cased: (first perf.) **137** ft Casing type: **6x4 1/2** in Diam. **6**

Finish: porous concrete, gravel w. (perf.), gravel w. (screen), horiz. gallery, open perf., screen, sd. pt., shored, open hole, other **5**

Method Drilled: (A) air bored, (B) cable, (C) dug, (D) hyd jetted, (E) air percussion, (F) reverse, (G) trenching, (H) driven, (I) drive wash, (J) other **H**

Date Drilled: **8/38** **9/38** Pump intake setting: ft **38**

Driller: **Jayne** name (L) address (M) (N) (P) (R) (S) (T) (U) Deep Shallow

Lift (type): (A) air, (B) bucket, (C) cent, (D) jet, (E) multiple, (F) multiple, (G) none, (H) piston, (I) rot, (J) submerg, (K) turb, (L) other **T**

Power (type): diesel elec gas, gasoline, hand, gas, wind; H.P. **7 1/2** Trans. or meter no. **U**

Descrip. MP **1.0** ft above below LSD, Alt. MP **4**

Alt. LSD: **470** Accuracy: (source) **4**

Water Level **65.10** ft above below MP; Ft above below LSD **65** Accuracy: **A**

Date meas: **10/12/71** **7.8** Yield: **60** gpm Method determined

Drawdown: ft Accuracy: Pumping period: hrs

QUALITY OF WATER DATA: Iron ppm Sulfate ppm Chloride ppm Hard.

Sp. Conduct K x 10 Temp. **63** F Date sampled **12/2/54** **D 5 4**

Taste, color, etc.

WL Data
11/17/82
WL = 67.90
3/28/85
WL = 63.67
8/12/87
WL = 64.98

10/14/78
WL = 64.63

Well No.

138

HYDROGEOLOGIC CARD

SAME AS ON MASTER CARD Physiographic Province: 03 Section: _____

D Drainage Basin: 16L Subbasin: _____

Topo of well site: (D) depression, stream channel, dunes, flat, hilltop, sink, swamp, (E) (F) (H) (K) (L) (P) (S) (T) (U) (V) offshore, pediment, hillside, terrace, undulating, valley flat 27

MAJOR AQUIFER: _____ system series K3 McNairy aquifer, formation, group SM

Lithology: _____ Origin: 3 Aquifer Thickness: _____ ft

Length of well open to: _____ ft 10 Depth to top of: _____ ft 137

MINOR AQUIFER: _____ system series _____ aquifer, formation, group _____

Lithology: _____ Origin: _____ Aquifer Thickness: _____ ft

Length of well open to: _____ ft Depth to top of: _____ ft

Intervals Screened:

Depth to consolidated rock: _____ ft Source of data: _____ 64

Depth to basement: _____ ft Source of data: _____ 69

Surficial material: _____ Infiltration characteristics: _____ 72

Coefficient Trans: _____ gpd/ft Coefficient Storage: _____ 76

Coefficient Perm: _____ gpd/ft² Spec cap: _____ gpm/ft Number of geologic cards: _____ 79

(See location on sched. B7)

- WL 64 6/54
 Q = 110 gpm - 1938, 80 gpm @ 43 psi.
- 0-15 cly
 - 17 sd
 - 20 cly
 - 28 sdy cly
 - 66 soft rk
 - 81 sdy sh + cly
 - 87 Hd rk
 - 89 sh
 - 95 Rk
 - 114 Hd cly
 - 116 Hd rk
 - 131 Blu marl
 - 132 Rk
 - 136 sdy sh
 - 137 Extra hd rk
 - 147 Cs sd
 - cly

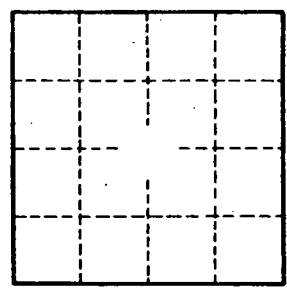

Layne denoted this as #1 Test, #2 well.

Well No.

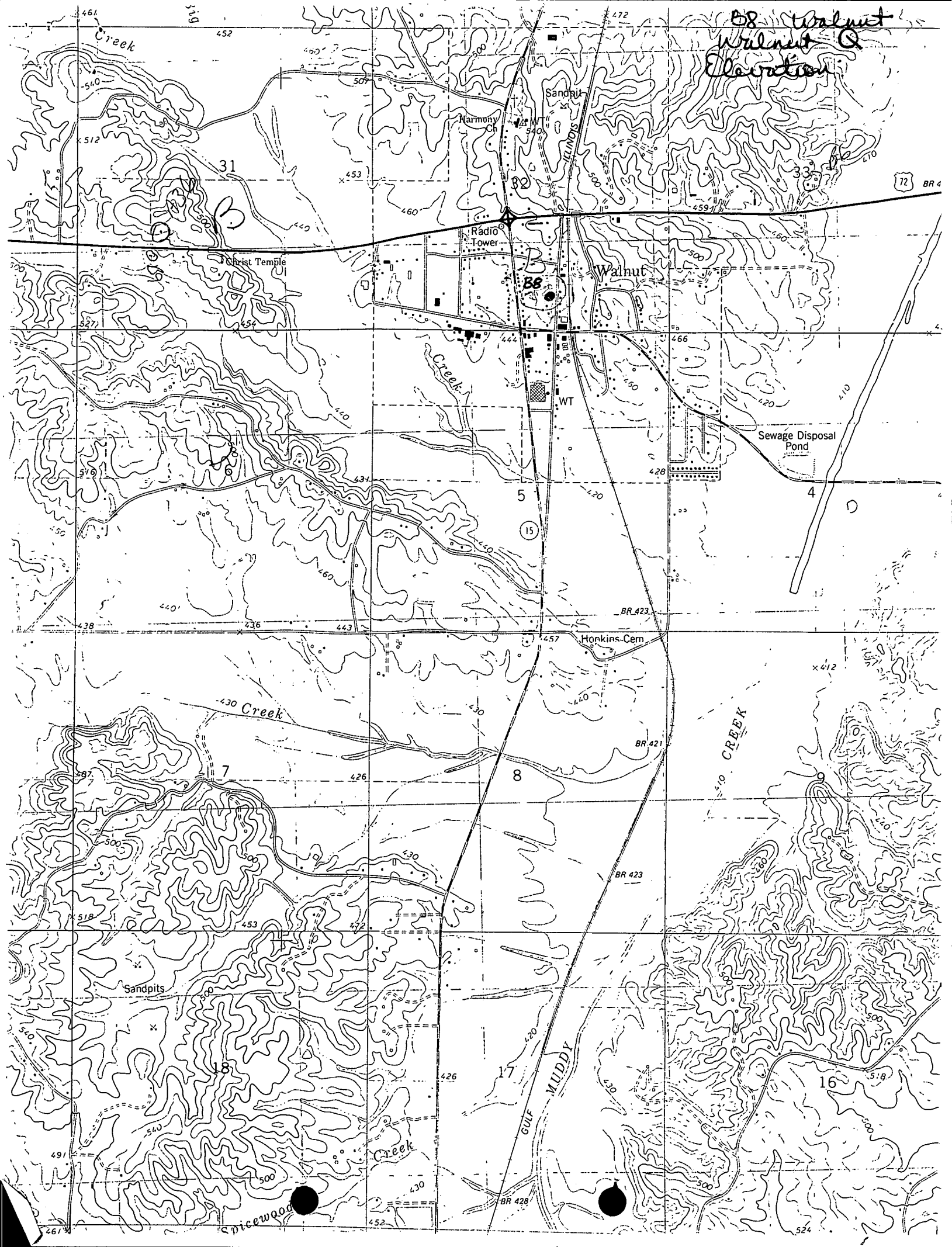

BR Walnut
Walnut Q
Elevation

72 BR 4

15

BR 423

BR 421

BR 423

BR 428

Spicewood