

K. Taylor

Recorded by WTO

U.S. GEOLOGICAL SURVEY  
WATER RESOURCES DIVISION  
MISSISSIPPI DISTRICT  
WELL RECORD

TRANSMITTED FOR ADP.  
1477

Well No. 637  
E-Log No. 15  
County TATE

COLDWATER QUAD SDA

PUNCHED

Site ID 34 38 1 1 0 8 9 5 8 0 4 0 1 R=0\* T=A\* 2=W\*  
5 19

GEN. SITE DATA

Data reliab. 3=C\* Report. agency 4=USGS\* Dist. 5 6=28\* 7=28\* Co. 8=1,3,7\*

Lat. 9=34 38 11 \* Long. 10=0 8 9 5 8 0 4 \* Well No. 12=6 0 3 7 \*

Location 13=NW SW S 20 T 05 S R 0 7 W \* Alt. 16=250 \*

Hyd. Unit (OWDC) 20= \* Date 21=03/13/1972 \*

Well use 23=φ \* Water Use 24=U \* Hole depth 27=1.259 \* Well depth 28=11.80 \*

WL 30=54 \* Date 31=12/01/1972 \* Source 33=S \*

Status 273= \*

OWNER

R=158\* T=A\* Date 159#03/13/1972 \* Owner No. \_\_\_\_\_

Owner 161=SENATORIA \*

FIELD QW

R=192\* T=A\* Date 193# / / \* Temp. 196#00010\* 197= \*

R=192\* T=A\* Date 193# / / \* Cond. 196#00095\* 197= \*

R=192\* T=A\* Date 193# / / \* pH 196#00400\* 197= \*

CONSTR.

R=58\* T=A\* 59#1\* Date 60=03/13/1972 \* Remarks \_\_\_\_\_

Drlg. 63=0.01 \* Name Lipe Method 65=H \* Finish 66=S \*

CASING

R=76\* T=A\* 59#1\*

Top csgn. 77# 0. \* Bot. csgn. 78= \* Diam. 79# 6. \*

R=76\* T=A\* 59#1\*

Top csgn. 77# \* Bot. csgn. 78= \* Diam. 79# \*

OPENINGS

R=82\* T=A\* 59#1\* Top 83# 11.60. \* Bottom 84= 11.80. \*

Type 85=S \* Diam. 87= 4. \* Size 88= \*

R=82\* T=A\* 59#1\* Top 83# \* Bottom 84= \*

Type 85= \* Diam. 87= \* Size 88= \*

YIELD

R= \* T=A \* 147#1\* Q 150= \* Q/S 272= \*

134 flows 146 pumped

R=42\* T= A \* Lift type 43# \* Intake 44= \* Power type 45= \*

LIFT Date 38= / / \* H.P. 46= \* \*

R=198\* T= A \* Log 199# \* Top 200= \* Bot 201= \*

R=198\* T= A \* Log 199# E \* Top 200= 10. \* Bot 201= 1259. \*

R=189\* T= A \* E Log No. 190# 0.15 \* 191= M I S S D I S T \*

ANAL. R=114\* T= A \* Year 115# \* Type 120= \*

R=90\* T= A \* 256# 1 \* Top 91= 1150. \* Bot 92= 1205. \*

Unit ID 93= 124WLCXL \* Name of Unit

R=90\* T= A \* 256# 1 \* Top 91= \* Bot 92= \*

Unit ID 93= \* Name of Unit

R=98\* T= A \* 99# 1 \* Unit tested 100= \*

R=105\* T= A \* 99# 1 \* Test No. 106# \*

107= \* Transmissivity (gal/d)/ft

108= \* Hydraul. cond. (gal/d)/ft<sup>2</sup>

110= \* Storage coeff. Boundaries

WL Data  
 11/28/88  
 WL = 101.50 RE  
 11/28/88  
 WL = 98.05

2-1972, water level by driller 65' below lsd.

Test  
 763'-183'  
 30gpm  
 Meridian  
 sd.

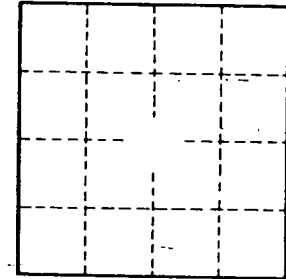
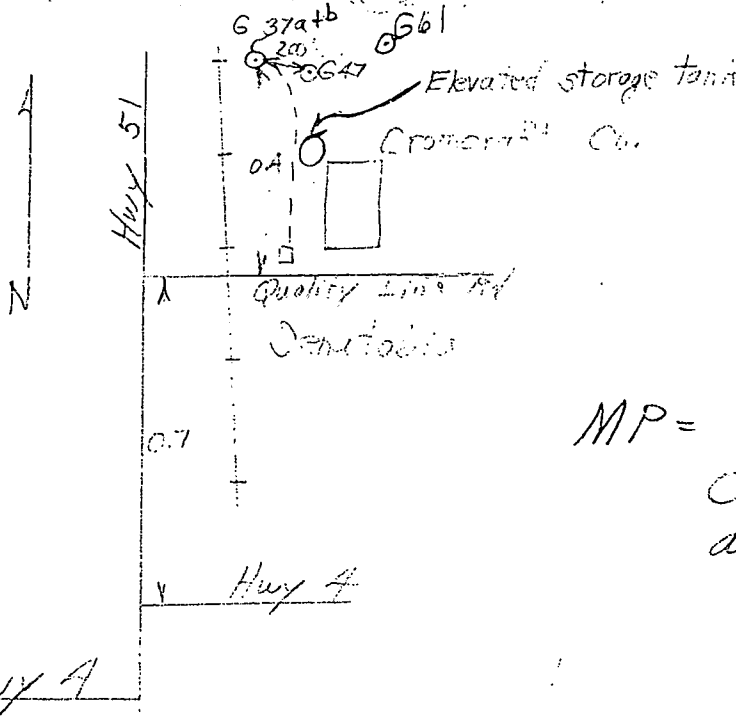

MP = top of casing 2.2' above lsd

pumped 60 gpm by test pump

