

F22

WELL SCHEDULE

Elog #14

PUNCHED

U. S. DEPT. OF THE INTERIOR

GEOLOGICAL SURVEY

WATER RESOURCES DIVISION

NOV 7 1972

MASTER CARD

W/L Data
11/17/82
WL=13025
11/28/88
WL=143.78

Record by WTR Source of data Obs driller Date 12-17-71 Map _____
 State 28 County (or town) TATE 69
 Latitude: 34³37²3¹N Longitude: 08⁹59²8 Sequential number: 1
 Lat-long accuracy: 20⁷ T. 5⁸ R. 8⁹ Sec. 25 SW. SE SE. SE
 Local well number: F022DD2505508W Other number: _____
 Local use: 001041 Owner or name: _____
 Owner or name: SENATOBIA Address: _____

Ownership: County, Fed Gov't, City, Corp or Co, Private, State Agency, Water Dist M

Use of water: (A) Air cond, (B) Bottling, (C) Comm, (D) Dewater, (E) Power, (F) Fire, (H) Irr, (I) Med, (M) Ind, (N) P S, (P) Rec, (S) Stock, (T) Instit, (U) Unused, (V) Recharge, (W) Desal-P S, (X) Desal-other, (Y) Other Water sample

Use of well: (A) Anode, (D) Drain, (G) Seismic, (H) Heat Res, (I) Obs, (J) Oil-gas, (K) Recharge, (L) Test, (M) Unused, (N) Withdraw, (O) Waste, (P) Destroyed Q

DATA AVAILABLE: Well data Freq. W/L meas.: Field aquifer char.
 Hyd. lab. data: _____
 Qual. water data; type: _____
 Freq. sampling: _____ Pumpage inventory: yes no; period: _____
 Aperture cards: _____ yes no
 Log data: Elog 60' - 1242' E

WELL-DESCRIPTION CARD

SAME AS ON MASTER CARD Depth well: 1085 ft Meas. 3
 Depth cased; (first perf.): 1065 ft Casing type: _____; Diam. 5X4 in 5
 Finish: porous concrete, gravel w. (perf.), (screen), (gravel), (horiz. gallery), (open end), (perforated), (screen), (sd. pt.), (shored), (open hole), (other) S
 Method: (A) drilled, (B) bored, (C) cable, (D) dug, (E) hyd jetted, (F) air rot., (G) reverse, (H) trenching, (I) driven, (J) wash, (K) other H
 Date Drilled: 12/71 971 Pump intake setting: _____ ft _____
 Driller: Ray Lipe name _____ address _____
 Lift (type): (A) air, (B) bucket, (C) cent, (D) jet, (E) multiple, (F) multiple, (G) none, (H) piston, (I) rot, (J) submerg, (K) turb, (L) other Deep Shallow 40
 Power (type): (A) diesel, (B) elec, (C) gas, (D) gasoline, (E) hand, (F) gas, (G) wind, (H) H.P. Trans. or meter no. _____

DEC 10 1974
WTR

Descrip. MP _____ ft above _____ below LSD, Alt. MP _____
 Alt. LSD: 340 Accuracy: (source) topo 3
 Water Level: _____ ft above _____ below MP; _____ above _____ below LSD 130 Accuracy: _____ 4
 Date meas: 11-9-72 N72 Yield: _____ gpm 45 Method determined _____
 Drawdown: _____ ft _____ Accuracy: _____ Pumping period _____ hrs _____
 QUALITY OF WATER DATA: Iron _____ ppm Sulfate _____ ppm Chloride _____ ppm Hard. _____ ppm
 Sp. Conduct _____ K x 10⁶ Temp. _____ °F Date sampled _____
 Taste, color, etc. pH=8.0 Fe none (reported long dd)

Well No.

CONCRETE

Well No. _____

Latitude-longitude _____
d m s N S d m s

HYDROGEOLOGIC CARD

1 SAME AS ON MASTER CARD 19 Physiographic Province: 20 21 Section: 03

22 Drainage Basin: D 23 25 Subbasin: 15E 26

27 Topo of well site: (D) depression, stream channel, dunes, flat, hilltop, sink, swamp, (E) (P) (H) (K) (L) (O) (P) (S) (T) (U) (V) offshore, pediment, hillside, terrace, undulating, valley flat

MAJOR AQUIFER: system _____ series TE 28 29 aquifer, formation, group TW 30 31

Lithology: 2S 32 33 Origin: 2 34 Aquifer Thickness: 80 ft

35 Length of well open to: 80 37 ft 38 40 Depth to top of: 1040 41 43 ft

MINOR AQUIFER: system _____ series _____ 44 45 aquifer, formation, group _____ 46 47

Lithology: _____ 48 49 Origin: _____ 50 Aquifer Thickness: _____ ft

51 Length of well open to: _____ 53 ft 54 56 Depth to top of: _____ 57 59 ft

Intervals Screened: _____

Depth to consolidated rock: _____ ft 60 63 Source of data: _____ 64

Depth to basement: _____ ft 65 68 Source of data: _____ 69

Surficial material: _____ 70 71 Infiltration characteristics: _____ 72

Coefficient Trans: _____ gpd/ft 73 75 Coefficient Storage: _____ 76 78

Coefficient Perm: _____ gpd/ft²; Spec cap: _____ gpm/ft; Number of geologic cards: _____ 79

water level by driller = 147' below lsd, 12-1971

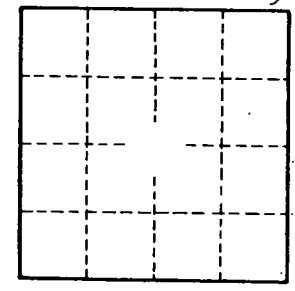
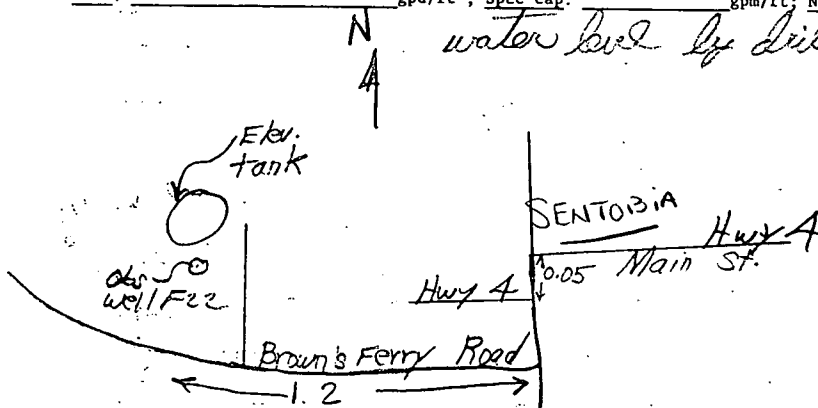

MP = Top of casing 1.3' above lsd

↓ to SARDIS

yield = 45 gpm during test with large dd GPO 937-142