

WELL SCHEDULE

U. S. DEPT. OF THE INTERIOR

GEOLOGICAL SURVEY

WATER RESOURCES DIVISION

MASTER CARD # 8-74

Record by E.H. Source of data C.E. Beardslee Date 11-9-53 Map Cleveland Q.

State 2:8 County (or town) 5:7

Latitude: 30 N 21 S, R 3 Sec 21 Longitude: 12 degrees 13 min 18 sec

Local well number: H1007P03121N03W Other well number: B & H

Local use: 33 40 45 51 Owner or name: Land & Merch Co.

Owner or name: LAND & MERCH CO Address: _____

Ownership: (C) County, (F) Fed Gov't, (M) City, (N) Corp or Co, (P) Private, (S) State Agency, (W) Water Dist P

Use of water: (A) Air cond, (B) Bottling, (C) Comm, (D) Dewater, (E) Power, (F) Fire, (H) Dom, (I) Irr, (M) Med, (N) Ind, (P) S, (R) Rec, (S) Stock, (T) Instit, (U) Unused, (V) Recharge, (W) Recharge, (X) Desal-P S, (Y) Desal-other, (Z) Other I

Use of well: (A) Anode, (D) Drain, (H) Seismic, (I) Heat Res, (O) Obs, (P) Oil-gas, (R) Recharge, (T) Test, (U) Unused, (W) Withdraw, (X) Waste, (Z) Destroyed W

DATA AVAILABLE: Well data 70 Freq. W/L meas.: 71 Field aquifer char. 72

Hyd. lab. data: 73

Qual. water data; Type: 74

Freq. sampling: 75 Pumpage inventory: 76 yes/no; period: 77

Core cards: 78 79

Log data: 78 79

WELL-DESCRIPTION CARD

SAME AS ON MASTER CARD. Depth well: 1100 ft Meas. rept. accuracy 24 6

Depth cased: (first perf.) 75 ft Casing type: 12 in Diam. 18-12 in 29 30

Finish: (C) porous concrete, (F) gravel w. (perf.), (G) gravel w. (screen), (H) horiz. gallery, (I) open end, (J) open perf., (K) screen, (L) sd. pt., (M) shored, (N) open hole, (O) other P

Method: (A) air bored, (B) cable, (C) dug, (D) hyd jetted, (E) rot., (F) percussion, (G) rotary, (H) air reverse, (I) reverse trenching, (J) driven, (K) drive wash, (L) other H

Date Drilled: 9-5-53 Pump intake setting: 36 ft 38

Driller: L. A. ... name address

Lift (type): (A) air, (B) bucket, (C) cent., (D) jet, (E) multiple, (F) multiple, (G) none, (H) piston, (I) rot., (J) submerg, (K) turb, (L) other T Deep 40 Shallow

Power (type): (A) diesel, (B) elec, (C) gas, (D) gasoline, (E) hand, (F) gas, (G) wind, (H) H.P. 50 Trans. or meter no. 41

Descrip. MP 20.17 ft above below LSD, Alt. MP 47 4

Alt. LSD: 12.5 Accuracy: (source) 47 4

Water Level: 20.17 Ft above below MP; Ft above below LSD 20 Accuracy: 52 A

Date meas: 11-5-53 Yield: 2000 gpm Method determined 61

Drawdown: 62 Ft Accuracy: 65 Pumping period: 66 hrs 68

QUALITY OF WATER DATA: Iron 69 ppm Sulfate 70 ppm Chloride 71 Hard. 72

Sp. Conduct 73 K x 10⁶ Temp. 74 °F Date sampled 77 79

Taste, color, etc. _____

Well No. H7

Latitude-longitude N
S
d m s d m s

HYDROGEOLOGIC CARD

SAME AS ON MASTER CARD Physiographic Province: 03 Section: _____

Drainage Basin: E 15H Subbasin: _____

Topo of well site: (D) depression, stream channel, dunes, flat, hilltop, sink, swamp, (E) (F) (H) (R) (L) (P) (S) (T) (U) (V) offshore, pediment, hillside, terrace, undulating, valley flat _____

MAJOR AQUIFER: system _____ series DG aquifer, formation, group MA

Lithology: _____ Origin: _____ Aquifer Thickness: _____ ft

Length of well open to: _____ ft _____ Depth to top of: _____ ft _____

MINOR AQUIFER: system _____ series _____ aquifer, formation, group _____

Lithology: _____ Origin: _____ Aquifer Thickness: _____ ft

Length of well open to: _____ ft _____ Depth to top of: _____ ft _____

Intervals Screened: _____

Depth to consolidated rock: _____ ft _____ Source of data: _____

Depth to basement: _____ ft _____ Source of data: _____

Surficial material: _____ Infiltration characteristics: _____

Coefficient Trans: _____ gpd/ft _____ Coefficient Storage: _____

Coefficient Perm: _____ gpd/ft²; Spec cap: _____ gpm/ft; Number of geologic cards: _____

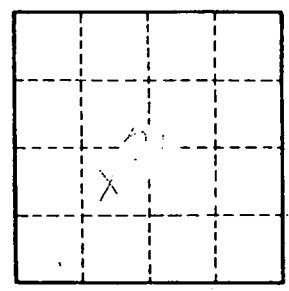
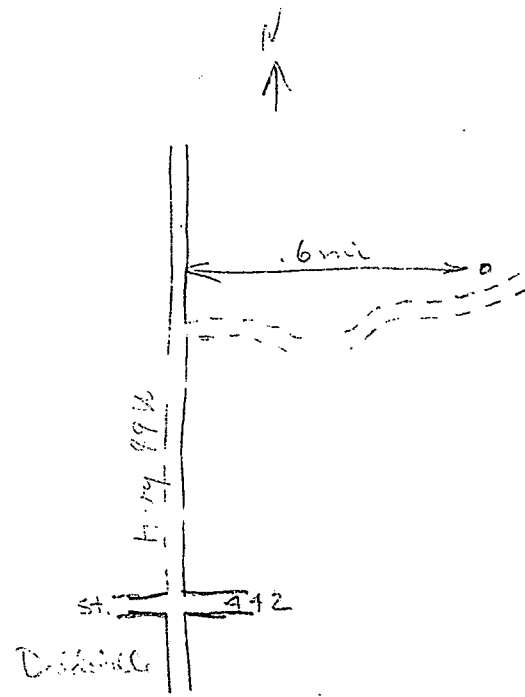

Well No.