

WELL SCHEDULE

U. S. DEPT. OF THE INTERIOR

GEOLOGICAL SURVEY

WATER RESOURCES DIVISION

MASTER CARD # 8-74

Record by C. F. Brown Source of data

Date 6-11-39 Map Cleveland

State 28 County (or town) Sumner 67

Latitude: 33° 43' 21" N Longitude: 090° 32' 50" W Sequential number: 1

Lat-Long accuracy: 30' T 22 S, R 3 Sec 31, SE SW

Local well number: F048D.C3122N03W Other number: B & M

Local use: 35 40 45 51 Owner or name:

Owner or name: CITY OF SCHOOLES Address:

Ownership: County, Fed Gov't, City, Corp or Co, Private, State Agency, Water Dist M

Use of water: (A) Air cond, (B) Bottling, (C) Comm, (D) Dewater, (E) Power, (F) Fire, (G) Dom, (H) Irr, (I) Med, (J) Ind, (K) P S, (L) Rec, (M) Stock, (N) Instt, (O) Unused, (P) Reppure, (Q) Recharge, (R) Desal-P S, (S) Other P

Use of well: (A) Anode, (B) Drain, (C) Seismic, (D) Heat Res, (E) Obs, (F) Oil-gas, (G) Recharge, (H) Test, (I) Unused, (J) Withdraw, (K) Waste, (L) Destroyed W

DATA AVAILABLE: Well data Freq. W/L meas: Field aquifer char.

Hyd. lab. data:

Qual. water data; type:

Freq. sampling: Pumpage inventory: yes no; period:

Structure cards: yes

Log data:

WELL-DESCRIPTION CARD

SAME AS ON MASTER CARD Depth well: ft Meas.

Depth cased: (first perf.) ft Casing type: Diam. in

Finish: porous concrete, gravel w. (perf.), gravel w. (screen), horiz. gallery, open end, other

Method Drilled: (A) air bored, (B) cable, (C) dug, (D) hyd jetted, (E) air rot., (F) reverse, (G) percuss, (H) rotary, (I) trenching, (J) driven, (K) drive wash, (L) other

Date Drilled: 9-1-4 Pump intake setting: ft

Driller: T. R. Miller name address

Lift (type): (A) air, (B) bucket, (C) cent, (D) jet, (E) multiple, (F) turb., (G) none, (H) piston, (I) submerg, (J) turb, (K) other Deep Shallow

Power (type): diesel, elec, gas, gasoline, hand, gas, wind; H.P. Trans. or meter no.

Descrip. MP 1.5 ft above LSD, Alt. MP

Alt. LSD: 134 Accuracy: (source)

Water Level 16.25 ft above below MP; Ft above below LSD 415 Accuracy:

Date meas: 6-3-9 Yield: gpm Method determined

Drawdown: ft Accuracy: Pumping period hrs

QUALITY OF WATER DATA: Iron Sulfate Chloride Hard.

Sp. Conduct K x 10⁶ Temp. 71 °F Date sampled

Taste, color, etc.

Latitude-longitude N
S
d m s d m s

HYDROGEOLOGIC CARD

SAME AS ON MASTER CARD Physiographic Province: 03 Section: _____

Drainage Basin: E 154 Subbasin: _____

Topo of well site: (D) depression, stream channel, dunes, flat, hilltop, sink, swamp, (C) (E) (F) (H) (K) (L) (O) (P) (S) (T) (U) (V) offshore, pediment, hillside, terrace, undulating, valley flat _____

MAJOR AQUIFER: _____ system _____ series _____ aquifer, formation, group _____

Lithology: _____ Origin: _____ Aquifer Thickness: _____ ft

Length of well open to: _____ ft Depth to top of: _____ ft

MINOR AQUIFER: _____ system _____ series _____ aquifer, formation, group _____

Lithology: _____ Origin: _____ Aquifer Thickness: _____ ft

Length of well open to: _____ ft Depth to top of: _____ ft

Intervals Screened: _____

Depth to consolidated rock: _____ ft Source of data: _____

Depth to basement: _____ ft Source of data: _____

Surficial material: _____ Infiltration characteristics: _____

Coefficient Trans: _____ gpd/ft Coefficient Storage: _____

Coefficient Perm: _____ gpd/ft²; Spec cap: _____ gpm/ft; Number of geologic cards: _____

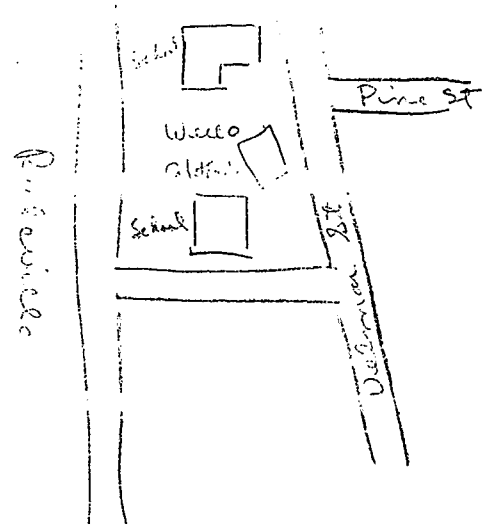
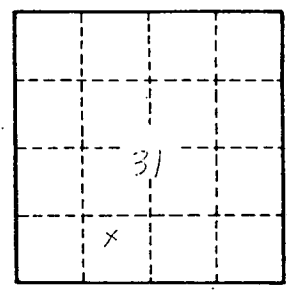

Well No.