

1/81 WTO

TRANSMITTED FOR ADP

Recorded by DMS
Date 1-5-83

U.S. GEOLOGICAL SURVEY
WATER RESOURCES DIVISION
MISSISSIPPI DISTRICT
WELL RECORD

YBS

Well No. C49
E-Log No. _____
County Sunflower

Site ID 335331090353801 R=0* T=A* 2=W*

Data reliab. 3=C Report. agency 4=USGS Dist. 6=28 7=28 Co. 8=133

Lat. _____ Long. 9=335331 10=0903580 Well No. 12=C049

Location 13=NWSE S 03 T 23 N R 04 W Alt. 16=140. 142.8

Hyd. Unit (OWDC) 20= Date 21=01/05/1983

Well use 23=W Water Use 24=I Hole depth 27= Well depth 28=115.

WL 30=27. Date 31=01/05/1983 Source 33=S

Status 273= Project No. 5=

R=158* T=A* Date 159#01/05/1983 Owner No. _____

Owner 161#UNKNOWN
LOMBARDY FARMS

R=192* T=A* Date 193# Temp. 196#00010 197=

R=192* T=A* Date 193# Cond. 196#00095 197=

R=192* T=A* Date 193# pH 196#00400 197=

R=58* T=A* 59#1 Date 60=01/05/1983 Remarks _____

Drlg. 63= Name _____ Method 65=R Finish 66=S

R=76* T=A* 59#1

Top csng. 77#0. Bot. csng. 78= Diam. 79#6.

R=76* T=A* 59#1

Top csng. 77# Bot. csng. 78= Diam. 79#

R=82* T=A* 59#1 Top 83# Bottom 84=

Type 85= Diam. 87= Size 88=

R=82* T=A* 59#1 Top 83# Bottom 84=

Type 85= Diam. 87= Size 88=

R= _____ T=A* 147#1 Q 150= Q/S 272=

134 flows 146 pumped

LIFT: R=42* T= A * Lift type 43# T* Intake 44= * Power type 45= *
 Date 38= 01/05/1983* H.P. 46= *

LOGS: R=198* T= A * Log 199# * Top 200= * Bot 201= *
 R=198* T= A * Log 199# * Top 200= * Bot 201= *
 R=189* T= A * E Log No. 190# * 191= M I S S D I S T *

ANAL.: R=114* T= A * Year 115# * 117= * 120= *

AQUIFERS: R=90* T= A * 256# 1 * Top 91= * Bot 92= *
 Unit ID 93= 112MRYA * Name of Unit
 R=90* T= A * 256# 1 * Top 91= * Bot 92= *
 Unit ID 93= * Name of Unit

HYDRAULICS: R=98* T= A * 99# 1 * Unit tested 100= * 103= *
 R=105* T= A * 99# 1 * Test No. 106# *
 107= * Transmissivity (gal/d)/ft
 108= * Hydraul. cond. (gal/d)/ft²
 110= * Storage coeff. Boundaries

R=121* T= * Yr Begin 122# * Network 258# *

Water Level Data Collection (1)

1-5-83

WL: 27.10

MP = LSD, 1/2" plug on N side of prop base

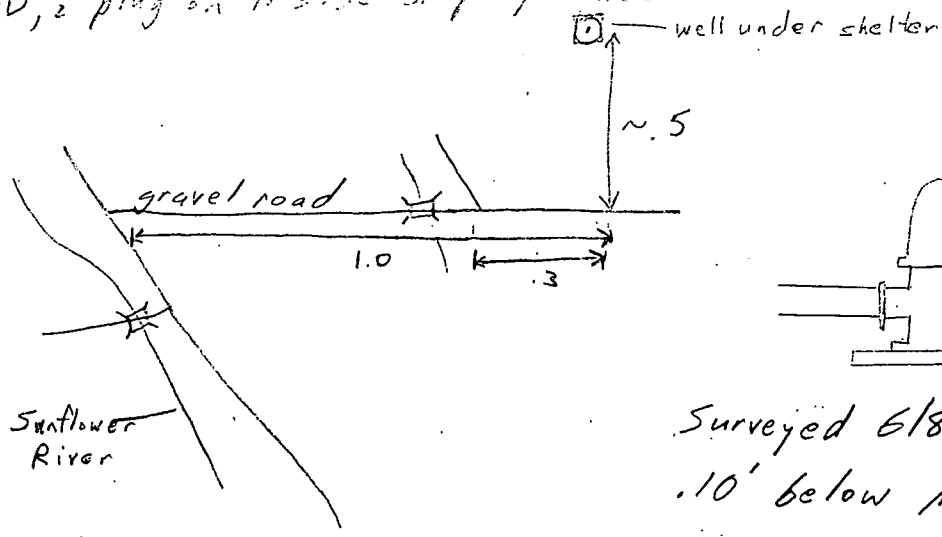

Surveyed 6/8/83 to RP. RP is .10' below MP. RP elev = 143.0'