

6/78 WTO

Recorded by WTO  
Date 7/1/80

U.S. GEOLOGICAL SURVEY  
WATER RESOURCES DIVISION  
MISSISSIPPI DISTRICT  
WELL RECORD

Wiggins

TRANSMITTED FOR ADP

Well No. C92  
E-Log No. \_\_\_\_\_  
County Stone

Site ID 305018089075101 R=0\* T=A\* 2=W\*

Data reliab. 3=U\* Report. agency 4=USGS\* Dist. 6=28\* 7=28\* Co. 8=131\*

Lat. \_\_\_\_\_ Long. 9=305018\* 10=0890751\* Well No. 12=C092\*

Location 13=SESW S 30 T 02 S R 11 W\* Alt. 16=240.\* 215'

Hyd. Unit (OWDC) 20= Date 21=02/16/1980\*

Well use 23=U\* Water use 24=U\* Hole depth 27=360.\* Well depth 28=360.\*

10/15/82  
89'

WL 30=90.\* Date 31=02/16/1980\* Source 33=D\*

Status 273= Project No. 5=

R=158\* T=A\* Date 159# 02/16/1980\* Owner No. Well #1

Owner 161=DUNN, PAPER CO

R=192\* T=A\* Date 193# Temp. 196#00010\* 197=

R=192\* T=A\* Date 193# Cond. 196#00095\* 197=

R=192\* T=A\* Date 193# pH 196#00400\* 197=

R=58\* T=A\* 59# 1\* Date 60=02/16/1980\* Remarks \_\_\_\_\_

Drlg. 63=072\* Name Braden Method 65=H\* Finish 66=S\*

R=76\* T=A\* 59# 1\*

Top csng. 77# 0.\* Bot. csng. 78=300.\* Diam. 79# 8.\*

R=76\* T=A\* 59# 1\*

Top csng. 77# Bot. csng. 78= Diam. 79#

R=82\* T=A\* 59# 1\* Top 83# 300.\* Bottom 84=360.\*

Type 85=S\* Diam. 87=8.\* Size 88=

R=82\* T=A\* 59# 1\* Top 83# Bottom 84=

Type 85= Diam. 87= Size 88=

R= T=A\* 147# 1\* Q 150= Q/S 272=

134 flows 146 pumped

GEN. SITE DATA

OWNER

FIELD QW

CONSTR.

CASING

OPENINGS

YIELD

R=42\* T= A \* Lift type 43# \* Intake 44= \* Power type 45= \*

LIFT Date 38= / / H.P. 46= \*

LOGS  
 R=198\* T= A \* Log 199# D \* Top 200= 0.\* Bot 201= 360.\*  
 R=198\* T= A \* Log 199# \* Top 200= \* Bot 201= \*  
 R=189\* T= A \* E Log No. 190# \* 191= M I S S D I S T \*

ANAL. R=114\* T= A \* Year 115# \* Type 120= \*

AQUIFERS  
 R=90\* T= A \* 256# 1 \* Top 91= 280.\* Bot 92= 350.\*

Unit ID 93= 122HBR5 \* Name of Unit \_\_\_\_\_

R=90\* T= A \* 256# 1 \* Top 91= \* Bot 92= \*

Unit ID 93= \* Name of Unit \_\_\_\_\_

HYDRAULICS  
 R=98\* T= A \* 99# 1 \* Unit tested 100= \* 103= \*

R=105\* T= A \* 99# 1 \* Test No. 106# \*

107= \* Transmissivity (gal/d)/ft \_\_\_\_\_

108= \* Hydraul. cond. (gal/d)/ft<sup>2</sup> \_\_\_\_\_

110= \* Storage coeff. Boundaries \_\_\_\_\_

R=121\* T= \* Yr Begin 122# \* Network 258= \*

Water Level Data Collection (1)

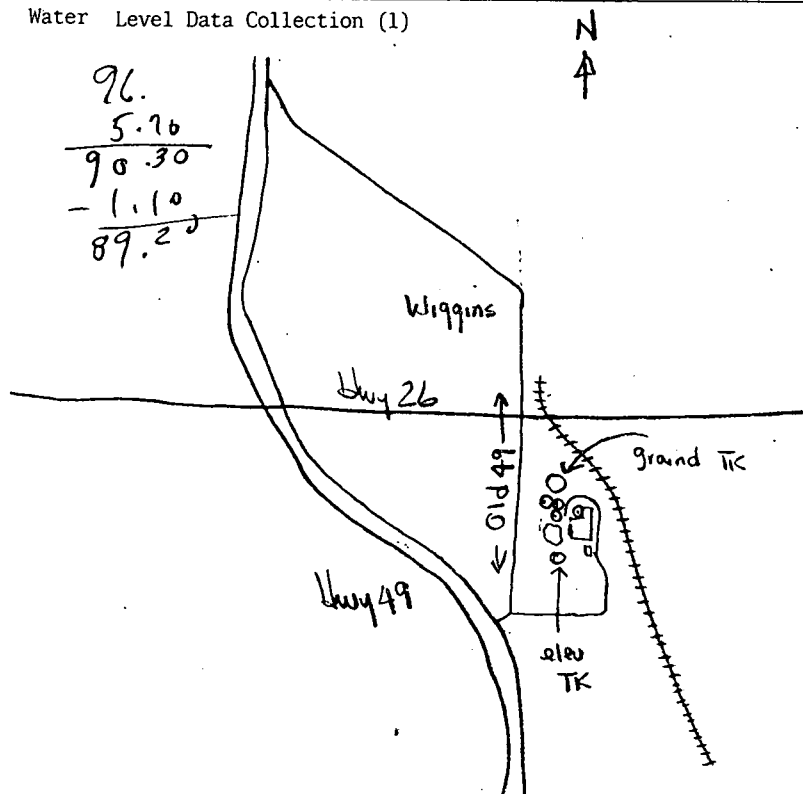

96.  
 5.76  
 90.30  
 - 1.10  
 89.20

No pump in well

description of formations encountered	from	to
clay	0	50
sand	50	70
clay	70	280
sand	280	350
clay	350	360

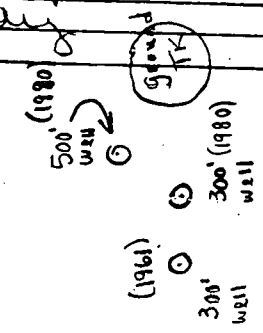

Bldg.