

WRD Exp. (GW)
April 1966

Well No. R3

WELL SCHEDULE

U. S. DEPT. OF THE INTERIOR

GEOLOGICAL SURVEY

WATER RESOURCES DIVISION

MASTER CARD

Record by J. A. Callahan Source W. F. Carter Date 1-16-66 Map
 of data Supt. W. R.
 (E. H. Bowen 11 S. 21-55)

State Miss County Smith 65
 (or town)

Latitude: 31 49 44 N Longitude: 089 26 00 Sequential
 5 deg 7 min 9 sec 11 S 12 degrees 15 min sec 18 number: 1

Lat-long accuracy: 3 T. 10 S, R. 14 Sec. 17, SE $\frac{1}{4}$, SW $\frac{1}{4}$, B & M
 20 30 40 50 60 70 80 90

Local well number: R003CB1710N14W Other number: 1

Local use: 009 Owner or name: Town Taylorsville

Owner or name: T. H. TAYLOR SVILLE Address: Taylorsville Miss

Ownership: County, Fed Gov't, (M) City, (N) Corp or Co, (P) Private, (S) State Agency, (W) Water Dist M

Use of water: (A) Air cond, (B) Bottling, (C) Comm, (D) Dewater, (E) Power, (F) Fire, (G) Dom, (H) Irr, (I) Med, (J) Ind, (K) Rec, (L) P, (M) S, (N) Rec, (O) (S) Stock, (T) Instit, (U) Unused, (V) Reprussure, (W) Recharge, (X) Desal-P S, (Y) Desal-other, (Z) Other P U

Use of well: (A) Anode, (D) Drain, (G) Seismic, (H) Heat Res, (I) Obs, (J) Oil-gas, (K) Recharge, (L) Test, (M) Unused, (N) Withdraw, (O) Waste, (P) Destroyed W U Z 12/9/81

DATA AVAILABLE: Well data Freq. W/L meas.: Field aquifer char.

Hyd. lab. data:

Qual. water data; type: MSB&H Complete 8-9-63

Freq. sampling: Pumpage inventory: no. period:

Aperture cards: yes

Log data:

PUNCHED and VERIFIED
ROLLA COMPUTATION BRANCH

Caped about 1975

WELL-DESCRIPTION CARD

SAME AS ON MASTER CARD Depth well: 360 ft Meas. 360 accuracy 6
 19 20 21 22 23 24

Depth cased; (first perf.) 316 ft Casing type: Steel; Diam. 8x4 in 8
 25 26 27 28 29 30

Finish: porous concrete, gravel w. (perf.), (G) gravel w. (screen), (H) horz. gallery, (I) open end, (J) other S
 (C) concrete, (F) gravel w. (perf.), (G) gravel w. (screen), (H) horz. gallery, (I) open end, (J) other

Method: (A) air bored, (B) cable, (C) dug, (D) hyd rot, (E) jetted, (F) air percussion, (G) reverse, (H) trenching, (I) driven, (J) drive wash, (K) other A
 (A) air bored, (B) cable, (C) dug, (D) hyd rot, (E) jetted, (F) air percussion, (G) reverse, (H) trenching, (I) driven, (J) drive wash, (K) other

Date Drilled: 1-1939 Pump intake setting: 939 ft 36 38

Driller: Carlross Well Co, Memphis, Tenn.

Lift (type): (A) air, (B) bucket, (C) cent, (D) jet, (E) multiple, (F) multiple, (G) none, (H) piston, (I) rot, (J) submerg, (K) turb, (L) other 7 Deep D
 (A) air, (B) bucket, (C) cent, (D) jet, (E) multiple, (F) multiple, (G) none, (H) piston, (I) rot, (J) submerg, (K) turb, (L) other

Power (type): diesel, elec, gas, gasoline, hand, gas, wind; H.P. 5 Trans. or meter no. U

Descrip. MP 1 ft above below LSD, Alt. MP 280± Accuracy: OK B&E 4
 42 43 44 45 46 47

Water Level -16 ft above below MP; Ft above below LSD 16 Accuracy: D
 48 49 50 51 52

Date meas: 1957 Yield: 51 133 gpm 133 Method determined 133
 53 54 55 56 57 58 59 60 61

Drawdown: 51 ft Accuracy: 16 hrs 133
 62 63 64 65 66 67 68 69

QUALITY OF WATER DATA: Iron 1 Sulfate 10 Chloride 30 Hard. 9
 70 71 72 73 74 75 76 77

Sp. Conduct 70 K x 10⁶ Temp. 70 Date sampled 863
 78 79 80 81 82

Taste, color, etc. 0

Well No.

R3

Well No. _____

Latitude-longitude _____
d m s d m s

HYDROGEOLOGIC CARD

SAME AS ON MASTER CARD 03 Section: _____
Province: _____

D Drainage Basin: 130 Subbasin: 0

(D) (C) (E) (F) (H) (K) (L)
Topo of depression, stream channel, dunes, flat, hilltop, sink, swamp,
well site: (O) (P) (S) (T) (U) (V)
offshore, pediment, hillside, terrace undulating, valley flat _____ 27 T

MAJOR AQUIFER: Tertiary, Miocene TM Cataboula C.A.
system series aquifer, formation, group

Basal

Lithology: sand U.S. Origin: 2 Aquifer Thickness: _____ ft
Length of well open to: _____ ft 4.4 Depth to top of: _____ ft

MINOR AQUIFER: _____
system series aquifer, formation, group

Lithology: _____ Origin: _____ Aquifer Thickness: _____ ft
Length of well open to: _____ ft _____ Depth to top of: _____ ft

Intervals Screened: _____

Depth to consolidated rock: _____ ft _____ Source of data: _____ 64

Depth to basement: _____ ft _____ Source of data: _____ 69

Surficial material: _____ Infiltration characteristics: _____ 72

Coefficient Trans: _____ gpd/ft _____ Coefficient Storage: _____ 76-78

Coefficient Perm: _____ gpd/ft²; Spec cap: _____ gpm/ft; Number of geologic cards: _____ 79

8" to (206') 4" to (48')
44' of 4" brass wire wrap.

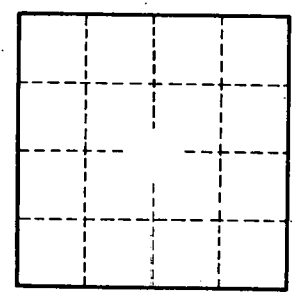
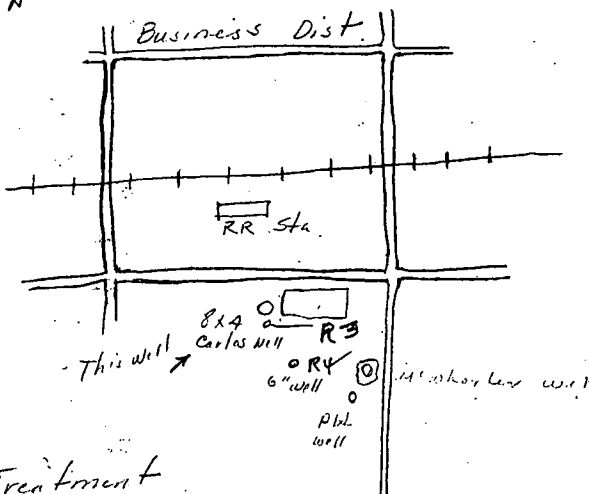

Treatment
Chlorine & lime and rapid sand filter
Makers 370 1955

Well No.