

WELL SCHEDULE

U. S. DEPT. OF THE INTERIOR

GEOLOGICAL SURVEY

WATER RESOURCES DIVISION

MASTER CARD

Record by WTO Source of data Owner Date 9-11-68 Map _____

State 28 County (or town) Smith 65

Latitude: 32° 05' 57" N Longitude: 089° 24' 00" W Sequential number: _____

Lat-long accuracy: 2 T. 30 S, R. 9 E, Sec 17, SW $\frac{1}{4}$, SE $\frac{1}{4}$, NW $\frac{1}{4}$

Local well number: H007DB1703NO9E Other number: _____ B & M

Local use: LOWI SW-1P Owner or name: Paul E. Nelson

Owner or name: PE NELSON Address: _____

Ownership: County, Fed Gov't, City, Corp or Co, Private, State Agency, Water Dist _____ P

Use of water: (A) Air cond, Bottling, Comm, Dewater, Power, Fire, Dom, Irr, Med, Ind, P S, Rec, (S) Stock, Instit, Unused, Repressure, Recharge, Desal-P S, Desal-other, Other Chickens + H

Use of well: (A) Anode, Drain, Seismic, Heat Res, Obs, Oil-gas, Recharge, Test, Unused, Withdraw, Waste, Destroyed _____ W

DATA AVAILABLE: Well data 0 Freq. W/L meas.: _____ 0 Field aquifer char. _____

Hyd. lab. data: _____

Qual. water data; type: USGS _____ C

Freq. sampling: _____ 0 Pumpage inventory: yes _____ no, period: _____

Aperture cards: _____ yes _____

Log data: _____

WELL-DESCRIPTION CARD

SAME AS ON MASTER CARD Depth well: _____ ft 486 Meas. _____ 6

Depth cased: (first perf.) _____ ft 466 Casing type: IRON; Diam. _____ in _____ 2

Finish: porous concrete, gravel w. (perf.), (screen), gravel w. (screen), gallery, end, (H) horiz. open perf., (S) screen, sd. pt., (W) shored, (X) open hole, other _____ S

Method Drilled: (A) air bored, (C) cable, (D) dug, (H) hyd jected, (J) air reverse, (P) percussion, (R) rotary, (T) trenching, (V) driven, (W) wash, other _____ H

Date Drilled: 9-6-4 Pump intake setting: _____ ft _____ 36 _____ 38

Driller: W.K. BARNES, STRINGER-

Lift (type): (A) air, (B) bucket, (C) cent, (J) jet, (L) multiple, (M) multiple, (N) none, (P) piston, (R) rot, (S) submerg, (T) turb, other _____ A Deep _____ 40 Shallow _____

Power (type): nat _____ LP _____ 1 _____ S Trans. or meter no. _____

Descrip. MP _____ above _____ ft below LSD, Alt. MP _____

Alt. LSD: _____ 347 Accuracy: (source) _____ 47

Water Level _____ ft above _____ MP; _____ ft below LSD _____ 30 Accuracy: _____ 52 G

Date meas: whndriller 64 Yield: _____ gpm _____ Method determined _____ 61

Drawdown: _____ ft _____ Accuracy: _____ Pumping period _____ hrs _____ 68

QUALITY OF WATER DATA: Iron _____ ppm _____ Sulfate _____ ppm _____ Chloride _____ Hard. _____ 72

Sp. Conduct 385 K x 10⁶ 3 Temp. _____ °F _____ 70 Date sampled _____ 968

Taste, color, etc. Clear

PUNCHED and VERIFIED
ROLLA CONFIDENTIAL

Well No.

H 7

Well No. H7

Latitude-longitude _____
N
S
d m s d m s

HYDROGEOLOGIC CARD

SAME AS ON MASTER CARD Physiographic Province: 0:3 Section: _____

D Drainage Basin: 1:3:0 Subbasin: _____

Topo of well site: (D) depression, (C) stream channel, (E) dunes, (F) flat, (H) hilltop, (K) sink, (L) swamp, (P) offshore, (S) pediment, (T) hillside, (U) terrace, (V) undulating, valley flat

MAJOR AQUIFER: system _____ series TIE aquifer, formation, group C:0

Lithology: U: S Origin: 2 Aquifer Thickness: _____ ft

Length of well open to: _____ ft Depth to top of: _____ ft

MINOR AQUIFER: system _____ series _____ aquifer, formation, group _____

Lithology: _____ Origin: _____ Aquifer Thickness: _____ ft

Length of well open to: _____ ft Depth to top of: _____ ft

Intervals Screened: _____

Depth to consolidated rock: _____ ft Source of data: _____

Depth to basement: _____ ft Source of data: _____

Surficial material: _____ Infiltration characteristics: _____

Coefficient Trans: _____ gpd/ft Coefficient Storage: _____

Coefficient Perm: _____ gpd/ft²; Spec cap: _____ gpm/ft; Number of geologic cards: _____

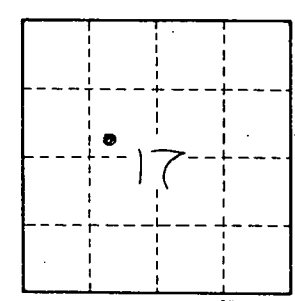
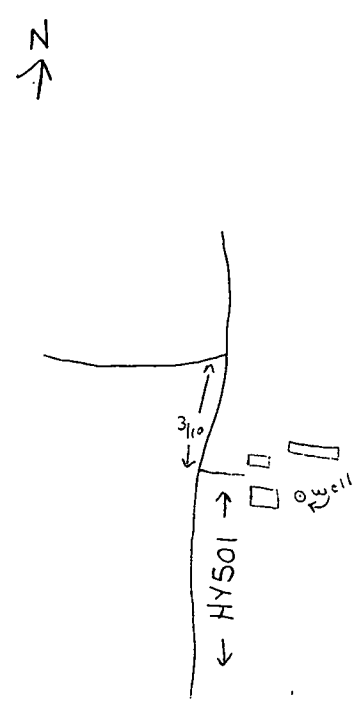

Well No. H7