

WRD Exp. (GW)
April 1966

Well No. F16

WELL SCHEDULE

U. S. DEPT. OF THE INTERIOR

GEOLOGICAL SURVEY

WATER RESOURCES DIVISION

MASTER CARD

Record by J. A. Callahan Source of data MOOWC Field Date 8-22-67 Map County

State Miss County (or town) SMITH 65

Latitude: 32° 07' 33" N Longitude: 089° 31' 46" W Sequential number: 1

Lat-long accuracy: 3 T 3 S, R 70 W, Sec 1, SE NE

Local well number: F001DA0103NOTE Other number: B & M

Local use: 626 Owner or name: Braxton L. Hawkins

Owner or name: BRAXTON HAWKINS Address: Burns, Miss

Ownership: County, Fed Gov't, City, Corp or Co, Private, State Agency, Water Dist P

Use of water: Air cond, Bottling, Comm, Dewater, Power, Fire, Dom, Irr, Med, Ind, P S, Rec, Stock, Instit, Unused, Repressure, Recharge, Desal-P S, Desal-other, Other H

Use of well: Anode, Drain, Seismic, Heat Res, Oos, Oil-gas, Recharge, Test, Unused, Withdraw, Waste, Destroyed. W

DATA AVAILABLE: Well data Freq. W/L meas.: Field aquifer char.

Hyd. lab. data:

Qual. water data; type:

Freq. sampling: Pumpage inventory: no. period:

Aperture cards: yes

Log data: Drillers log MOOWC D

WELL-DESCRIPTION CARD

SAME AS ON MASTER CARD Depth well: 641 ft Meas. 641 Meas. rept feet 6

Depth cased: 621 ft Casing type: steel ; Diam. 2 in. accuracy

Finish: porous concrete, gravel w. concrete, (perf.), gravel w. (screen), horiz. gallery, open end, (H) (Ø) perf., (S) screen, (T) sd. pt., (W) shored, (X) open hole, (Z) other S

Method Drilled: air rot, (A) (3) bored, cable, dug, (H) hyd, (J) jetted, (P) air percussion, (R) reverse, (T) trenching, (V) driven, (W) drive wash, (Z) other H

Date Drilled: 2-10-61 961 Pump intake setting: 961 ft

12/18/80
180
43.0
137.0
1.0 MP
136.0
455
136
319

Driller: Forest Drig Serv Forest Miss

Lift (type): air, bucket, cent, jet, multiple, multiple, none, piston, rot, submerg, turb, other J Deep Shallow

Power (type): diesel, elec, gas, gasoline, hand, gas, wind; H, P. 1 3 Trans. or meter no. 3

Descip. MP 1 above ft below LSD, Alt. MP 3

Alt. LSD: 455 Accuracy: 47

Water Level 165 ft above MP; 165 ft below LSD Accuracy: D

Date meas: 2-10-61 261 Yield: 261 gpm Method determined 61

Drawdown: 261 ft Accuracy: 61 Pumping period 61 hrs 61

QUALITY OF WATER DATA: Iron ppm 69 Sulfate ppm 70 Chloride ppm 71 Hard. ppm 72

Sp. Conduct K x 10⁶ 73 Temp. °F 74 Date sampled 75

Taste, color, etc.

PUNCHED and VERIFIED
ROLLA COMPUTATION BRANCH

Well No.

Well No. F1

Latitude-longitude 32 07 35^N 089 31 46
d m s d m s

HYDROGEOLOGIC CARD

SAME AS ON MASTER CARD Physiographic Province: 03 Section: _____

0 Drainage Basin: 130 Subbasin: _____

Topo of well site: (D) depression, stream channel, dunes, flat, hilltop, sink, swamp, (S) hillside, terrace, undulating, valley flat S

MAJOR AQUIFER: Tertiary system, Eocene series, TE aquifer, formation, group, C0

Lithology: sand U.S. Origin: 2 Aquifer Thickness: _____ ft

Length of well open to: 20 ft Depth to top of: 621 ft

MINOR AQUIFER: _____ system, _____ series, _____ aquifer, formation, group

Lithology: _____ Origin: _____ Aquifer Thickness: _____ ft

Length of well open to: _____ ft Depth to top of: _____ ft

Intervals Screened: 621-647

Depth to consolidated rock: _____ ft Source of data: _____

Depth to basement: _____ ft Source of data: _____

Surficial material: _____ Infiltration characteristics: _____

Coefficient Trans: _____ gpd/ft² Coefficient Storage: _____

Perm: _____ gpd/ft²; Spec cap: _____ gpm/ft; Number of geologic cards: _____

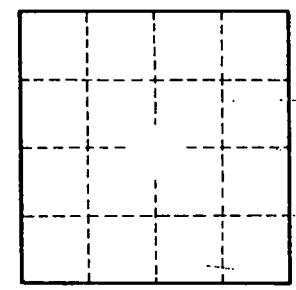
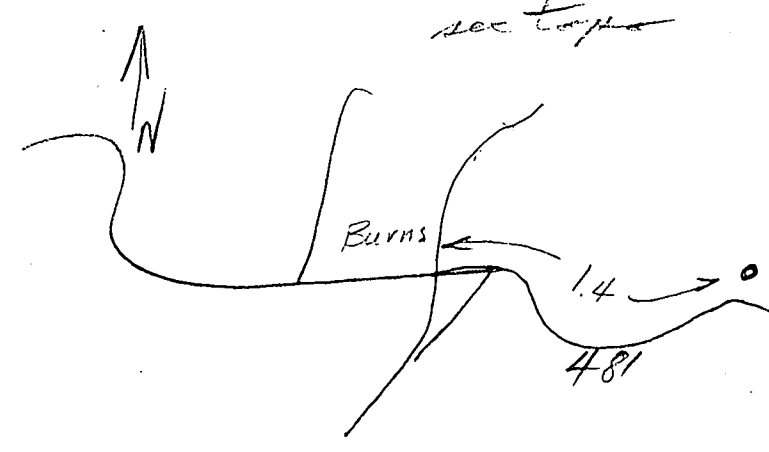

Well No. _____

F1