



#2

TRANSMITTED FOR ADP.

6/77 WTO

Recorded by WTO  
Date 8/77

U.S. GEOLOGICAL SURVEY  
WATER RESOURCES DIVISION  
MISSISSIPPI DISTRICT  
WELL RECORD

Well No. C17  
E-Log No. 183  
County SMITH

Site ID 320918089300901 R=0\* T=A\* 2=W\*

Data reliab. 3=C\*<sup>C</sup>U Report. agency 4=USGS\* Dist. 6=28\* 7=28\* Co. 8=129\*

Lat. 9=320918\* 10=0893009\* Well No. 12=C017\*

Location 13=NE SW S 29 T 04 N R 08 E\* Alt. 16=550.\* 545

Hyd. Unit (OWDC) 20= \* Date 21=07/19/1977\*

Well use 23=W\* Water Use 24=P\* Hole depth 27=1130.\* Well depth 28=1096.\*

WL 30=310.\* Date 31=08/26/1977\* Source 33=D\* 1228/94

Status 273=Y\* Project No. 5=

R=158\* T=A\* Date 1597 08/26/1977\* Owner No. I.H.#3 For Well #2

Owner 161=LORENA-LEMON-BURNS

R=192\* T=A\* Date 193# / / \* Temp. 196#00010\* 197= \*

R=192\* T=A\* Date 193# / / \* Cond. 196#00095\* 197= \*

R=192\* T=A\* Date 193# / / \* pH 196#00400\* 197= \*

R=58\* T=A\* 59#1\* Date 60=08/26/1977\* Remarks

Drlg. 63=94\* Name Roy West Method 65=H\* Finish 66=S\*

R=76\* T=A\* 59#1\*  
Top csng. 77# 0.\* Bot. csng. 78=1054.\* Diam. 79# 8.\*

R=76\* T=A\* 59#1\*  
Top csng. 77# 1012.\* Bot. csng. 78=1056.\* Diam. 79# 6.\*

R=82\* T=A\* 59#1\* Top 83# 1056.\* Bottom 84=1096.\*

Type 85=S\* Diam. 87=6.\* Size 88= \*

R=82\* T=A\* 59#1\* Top 83# \* Bottom 84= \*

Type 85= \* Diam. 87= \* Size 88= \*

R= 146\* T=A\* 147#1\* Q 150=200.\* Q/S 272= \*

134 flows 146 pumped

R=42\* T= A \* Lift type 43# T\* Intake 44= \* Power type 45= E\*

LIFT

Date 38= 08/26/1977\* H.P. 46= 40.\*

LOGS

R=198\* T= A \* Log 199# D\* Top 200= 0.\* Bot 201= 1130.\*

R=198\* T= A \* Log 199# E\* Top 200= 66.\* Bot 201= 1130.\*

R=189\* T= A \* E Log No. 190# 183\* 191= M I S S D I S T \*

ANAL.

R=114\* T= A \* Year 115# \* Type 120= \*

AQUIFERS

R=90\* T= A \* 256# 1 \* Top 91= 1010.\* Bot 92= 1130.\*

Unit ID 93= 124SPRT \* Name of Unit

R=90\* T= A \* 256# 1 \* Top 91= \* Bot 92= \*

Unit ID 93= \* Name of Unit

HYDRAULICS

R=98\* T= A \* 99# 1 \* Unit tested 100= \* 103= \*

R=105\* T= A \* 99# 1 \* Test No. 106# \*

107= \* Transmissivity (gal/d)/ft

108= \* Hydraul. cond. (gal/d)/ft<sup>2</sup>

110= \* Storage coeff. Boundaries

R=121\* T= \* Yr Begin 122# \*

Water Level Data Collection (1)

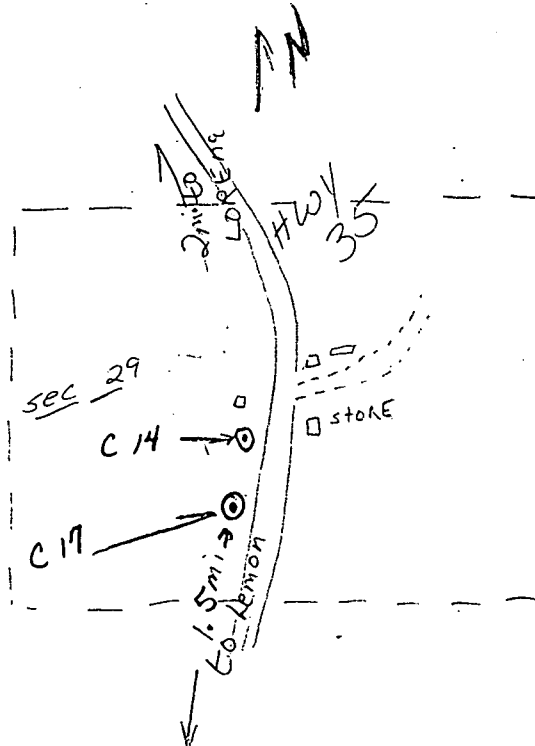

| encountered   | 1100 | 1100 |
|---------------|------|------|
| sand          | 0    | 20   |
| Blue clay     | 20   | 85   |
| sandy clay    | 85   | 160  |
| Blue clay     | 160  | 580  |
| sand          | 580  | 670  |
| sandy clay    | 670  | 773  |
| sand          | 773  | 773  |
| Blue clay     | 773  | 820  |
| rock          | 820  | 825  |
| rock & GRADED | 825  | 843  |
| sand          | 843  | 980  |
| sand & bk     | 980  | 1009 |
| sand          | 1009 | 1050 |
| clay          | 1050 | 1059 |
| sand          | 1059 | 1100 |
| clay          | 1100 | 1130 |