

WELL SCHEDULE

E Log 69

U. S. DEPT. OF THE INTERIOR

GEOLOGICAL SURVEY

WATER RESOURCES DIVISION

MASTER CARD

Record by FE. Grandjean Source of data Dy. + E Log Date 5-17-67 Map MAGEE NORTH LI

State Mississippi 301 28 County Simpson 64

Latitude: 31 52 56 N Longitude: 08 9 39 24 Sequential number: 1

Lat-long accuracy: 2 T. 1 S. R. 6 W. Sec 35, NE 1/4, SE 1/4, NW 1/4

Local well number: 40010B3501N06E Other number: \_\_\_\_\_

Local use: 184069 Owner or name: Oklahoma Wtr. Assoc.

Owner or name: OKLAOMA W A Address: Magre Miss

Ownership: County, Fed Gov't, City, Corp or Co, Private, State Agency, Water Dist N

Use of Air cond, Bottling, Comm, Dewater, Power, Fire, Dom, Irr, Med, Ind, P S, Rec, water: \_\_\_\_\_

Stock, Instit, Unused, Repressure, Recharge, Desal-P S, Desal-other, Other U

Use of well: Anode, Drain, Seismic, Heat Res, Obs, Oil-gas, Recharge, Test, Unused, Withdraw, Waste, Destroyed. U

DATA AVAILABLE: Well data  Freq. W/L meas.:  Field aquifer char.

Hyd. lab. data: \_\_\_\_\_

Qual. water data; type: USGS

Freq. sampling: \_\_\_\_\_ Pumpage inventory: yes  no, period: \_\_\_\_\_

Aperture cards: \_\_\_\_\_ yes

Log data: E Log 6-1800 - Schlumberger log 10-1500 D E

WELL-DESCRIPTION CARD

SAME AS ON MASTER CARD Depth well: \_\_\_\_\_ ft 1620 Meas. rept 3

Depth cased: \_\_\_\_\_ ft 1540 Casing type: \_\_\_\_\_; Diam. 10.6 in 1.0

Finish: porous concrete, gravel w. (perf.), gravel w. (screen), horiz. gallery, open end, perf., screen, sd. pt., shored, open hole, other G

Method Drilled: (A) air rot, (B) bored, (C) cable, (D) dug, (H) hyd jetted, (J) air rot., (P) percussion, (R) reverse, (T) trenching, (V) driven, (W) drive wash, other H

Date Drilled: 5-67 9.6.7 Pump intake setting: \_\_\_\_\_ ft \_\_\_\_\_

Driller: Griner Drlg. Serv. Inc., Columbia, Miss

Lift (type): (A) air, (B) bucket, (C) cent, (J) jet, (L) multiple, (M) multiple, (N) none, (P) piston, (R) submerg, (S) turb, other 5 Deep 5 Shallow 40

Power (type): diesel, elec, gas, gasoline, hand, gas, wind; H.P. V Trans. or meter no. \_\_\_\_\_

Descrip. NP Tor. well 2.5 ft above below LSD, Alt. MP \_\_\_\_\_

Alt. LSD: 534 Bar. 530 Accuracy: \_\_\_\_\_ 4

Water Level \_\_\_\_\_ ft above below MP; Ft below LSD 311 Accuracy: \_\_\_\_\_ A

Date meas: \_\_\_\_\_ Yield: \_\_\_\_\_ gpm 300 Method determined \_\_\_\_\_

Drawdown: \_\_\_\_\_ ft Accuracy: \_\_\_\_\_ Pumping period \_\_\_\_\_ hrs \_\_\_\_\_

QUALITY OF WATER DATA: Iron \_\_\_\_\_ Sulfate \_\_\_\_\_ Chloride \_\_\_\_\_ Hard. \_\_\_\_\_

Sp. Conduct \_\_\_\_\_ K x 10 6 Temp. 90 °F 32 Date sampled 5.6.8

Taste, color, etc. \_\_\_\_\_

foot a quarter

2/05/80  
350.00  
17.42  
332.58  
2.0  
330.58  
MP  
34 in AR  
VENT

Well No.

Well No. LI

Latitude-longitude N  
S  
d m s d m s

**HYDROGEOLOGIC CARD**

**SAME AS ON MASTER CARD** Physiographic Province: 03 Section: \_\_\_\_\_

**D** Drainage Basin: 13M Subbasin: \_\_\_\_\_

Topo of well site: (D) depression, stream channel, dunes, flat, hilltop, sink, swamp, (P) offshore, pediment, hillside, terrace, undulating, valley flat (L) \_\_\_\_\_

MAJOR AQUIFER: system \_\_\_\_\_ series TE Sparta aquifer, formation, group SS

Lithology: US Origin: 2 Aquifer Thickness: 240+ ft

240 Length of well open to: \_\_\_\_\_ ft 80 Depth to top of: 1536 ft ASA

MINOR AQUIFER: system \_\_\_\_\_ series \_\_\_\_\_ aquifer, formation, group \_\_\_\_\_ Aquifer Thickness: \_\_\_\_\_ ft

Lithology: \_\_\_\_\_ Origin: \_\_\_\_\_ Depth to top of: \_\_\_\_\_ ft

6" SS 1540-1620

Intervals Screened: \_\_\_\_\_

Depth to consolidated rock: \_\_\_\_\_ ft Source of data: \_\_\_\_\_

Depth to basement: \_\_\_\_\_ ft Source of data: \_\_\_\_\_

Surficial material: \_\_\_\_\_ Infiltration characteristics: \_\_\_\_\_

Coefficient Trans: \_\_\_\_\_ gpd/ft Coefficient Storage: \_\_\_\_\_

Coefficient Perm: \_\_\_\_\_ gpd/ft<sup>2</sup>; Spec cap: \_\_\_\_\_ gpm/ft; Number of geologic cards: \_\_\_\_\_

DRILLER reports pumping level of 850 feet!

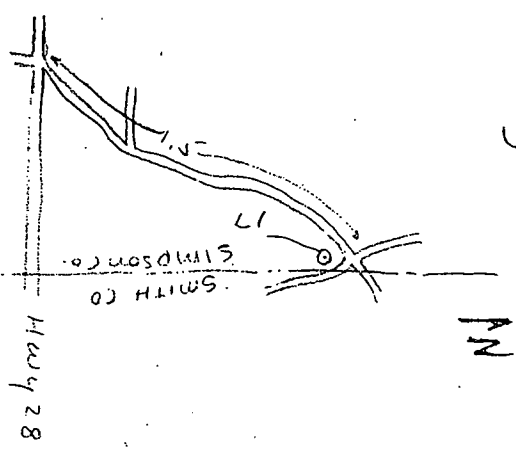
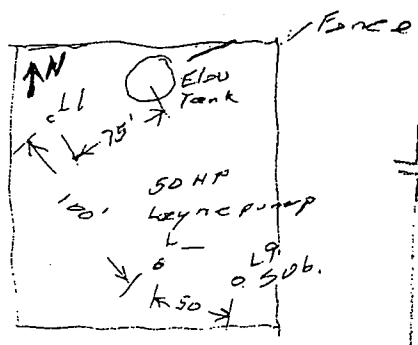
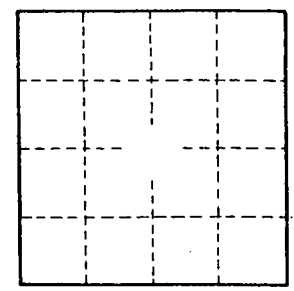

WL: 302' (1969)  
WL: 311' (1971)

Well No. LI