

WRD Exp. (GW)  
April 1966

# REPLACEMENT Well No.

K 5

## WELL SCHEDULE

U. S. DEPT. OF THE INTERIOR

GEOLOGICAL SURVEY

WATER RESOURCES DIVISION

### MASTER CARD

FUNCTIONED AND VERIFIED  
ROLLA CORN STATION BRANCH

Record by B Source of data Summit Date 7 68 Map \_\_\_\_\_

State 2 28 County (or town) Limpson 38 0.4

Latitude: 31 53 27 N Longitude: 08 94 64 W Sequential number: 3

Lat-long accuracy: 3 20 T. 1 S. R. 5 E. Sec 27, SW 1/4, NW 1/4, \_\_\_\_\_

Local well number: K0058C2701NOSE Other number: \_\_\_\_\_ B & M

Local use: 009040 Owner or name: Miss. State Sanitorium

Owner or name: SANITARIUM Address: \_\_\_\_\_

Ownership: County, Fed Gov't, City, Corp or Co, Private, State Agency, Water Dist \_\_\_\_\_ S

Use of water: (A) Air cond, (B) Bottling, (C) Comm, (D) Dewater, (E) Power, (F) Fire, (G) Dom, (H) Irr, (I) Med, (J) P S, (K) Rec, (L) Stock, (M) Instat, (N) Unused, (O) Repressure, (P) Recharge, (Q) Desal-P S, (R) Desal-other, (S) Other \_\_\_\_\_ T

Use of well: (A) Anode, (B) Drain, (C) Seismic, (D) Heat Res, (E) Obs, (F) Oil-gas, (G) Recharge, (H) Test, (I) Unused, (J) Withdraw, (K) Waste, (L) Destroyed \_\_\_\_\_ W

DATA AVAILABLE: Well data  Freq. W/L meas.:  Field aquifer char.

Hyd. lab. data: \_\_\_\_\_

Qual. water data; type: MSBH 7/78 5-69 \_\_\_\_\_ C

Freq. sampling: \_\_\_\_\_ Pumpage inventory: \_\_\_\_\_

Aperture cards: \_\_\_\_\_

Log data: See e-log # 40, 400' depth \_\_\_\_\_ D

### WELL-DESCRIPTION CARD

SAME AS ON MASTER CARD Depth well: \_\_\_\_\_ ft 130 Meas. \_\_\_\_\_ 3

Depth cased: \_\_\_\_\_ ft 90 Casing type: \_\_\_\_\_; Diam. 16 x 10 in \_\_\_\_\_ 16

Finish: porous concrete, gravel w. (perf.), gravel w. (screen), horiz. open perf., gallery, end, other \_\_\_\_\_ G

Method: (A) air rot, (B) bored, (C) cable, (D) dug, (E) hyd jetted, (F) air rot., (G) percussion, (H) rotary, (I) reverse, (J) trenching, (K) driven, (L) drive wash, (M) other \_\_\_\_\_ R

Date Drilled: 9.6.9 Pump intake setting: \_\_\_\_\_ ft 101

Driller: Carliss

Lift (type): (A) air, (B) bucket, (C) cent, (D) jet, (E) multiple, (F) multiple, (G) none, (H) piston, (I) rot, (J) submerg, (K) turb, (L) other \_\_\_\_\_ T Deep \_\_\_\_\_ Shallow 40

Power (type): (A) diesel, (B) elec, (C) gas, (D) gasoline, (E) hand, (F) gas, (G) wind, (H) H.P. \_\_\_\_\_ 25 Trans. or meter no. \_\_\_\_\_ V

Descrip. MP \_\_\_\_\_ ft above \_\_\_\_\_ below LSD. Alt. MP \_\_\_\_\_

Alt. LSD: \_\_\_\_\_ Accuracy: 482 \_\_\_\_\_ 4

Water Level \_\_\_\_\_ ft above MP; \_\_\_\_\_ ft below LSD \_\_\_\_\_ 43 Accuracy: \_\_\_\_\_ D

Date meas: 364 Yield: \_\_\_\_\_ gpm \_\_\_\_\_ 350 Method determined \_\_\_\_\_ 1

Drawdown: \_\_\_\_\_ ft \_\_\_\_\_ 2.1 Accuracy: \_\_\_\_\_ Pumping period \_\_\_\_\_ hrs \_\_\_\_\_ 24

QUALITY OF WATER DATA: Iron \_\_\_\_\_ ppm Sulfate \_\_\_\_\_ ppm Chloride \_\_\_\_\_ ppm Hard. \_\_\_\_\_ ppm

Sp. Conduct 34 K x 10<sup>6</sup> \_\_\_\_\_ Temp. 20.0 °F \_\_\_\_\_ Date sampled 7/78 \_\_\_\_\_

Taste, color, etc. pH = 5.2

9/1/21  
Rpt 42  
482  
42  
140

Well No.

51

Well No. K5

Latitude-longitude N  
S  
d m s d m s

HYDROGEOLOGIC CARD

SAME AS ON MASTER CARD Physiographic Province: 03 Section: \_\_\_\_\_

Drainage Basin: D Subbasin: 13N \_\_\_\_\_

Topo of well site: (D) depression, stream channel, dunes, flat, hilltop, sink, swamp, (E) (F) (H) (K) (L) (O) (P) (S) (T) (U) (V) offshore, pediment, hillside, terrace, undulating, valley flat \_\_\_\_\_

MAJOR AQUIFER: system \_\_\_\_\_ series TP aquifer, formation, group CI

Lithology: US Origin: 2 Aquifer Thickness: \_\_\_\_\_ ft

Length of well open to: \_\_\_\_\_ ft Depth to top of: \_\_\_\_\_ ft

MINOR AQUIFER: system \_\_\_\_\_ series \_\_\_\_\_ aquifer, formation, group \_\_\_\_\_

Lithology: \_\_\_\_\_ Origin: \_\_\_\_\_ Aquifer Thickness: \_\_\_\_\_ ft

Length of well open to: \_\_\_\_\_ ft Depth to top of: \_\_\_\_\_ ft

Intervals Screened: 10" x 40" .030 SS

Depth to consolidated rock: \_\_\_\_\_ ft Source of data: \_\_\_\_\_

Depth to basement: \_\_\_\_\_ ft Source of data: \_\_\_\_\_

Surficial material: \_\_\_\_\_ Infiltration characteristics: \_\_\_\_\_

Coefficient Trans: \_\_\_\_\_ gpd/ft<sup>2</sup> Coefficient Storage: \_\_\_\_\_

Coefficient Perm: \_\_\_\_\_ gpd/ft<sup>2</sup>; Spec cap: \_\_\_\_\_ gpm/ft;

70' of lay pipe

See old K5 for sketch.

101' airlin.

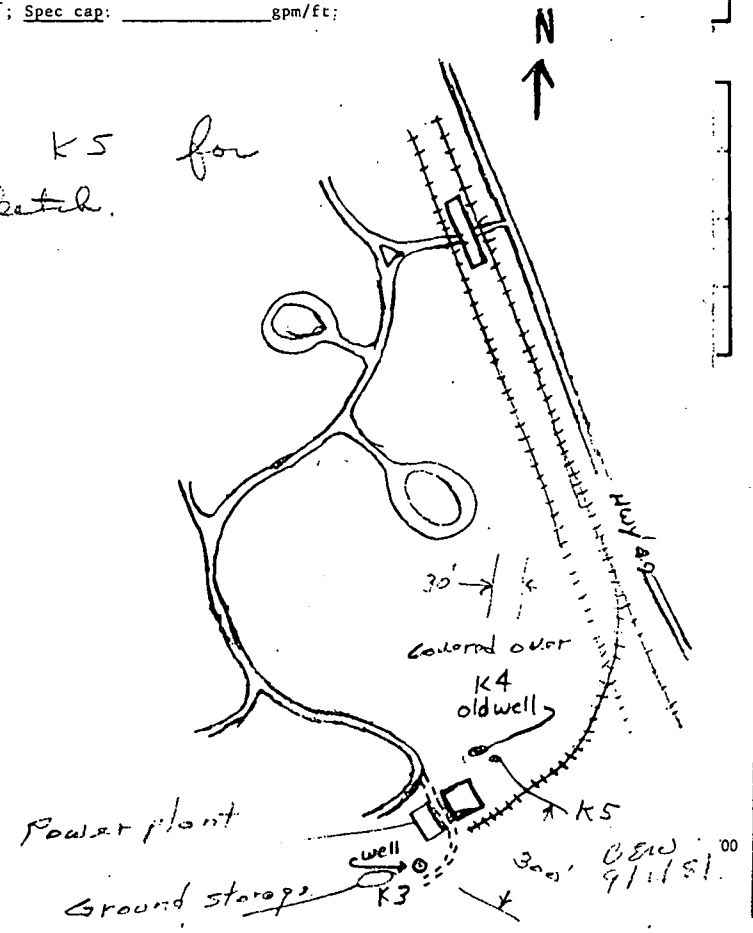

Well No.

K5