

APR 22 1974

WELL SCHEDULE

U. S. DEPT. OF THE INTERIOR

GEOLOGICAL SURVEY

WATER RESOURCES DIVISION

PUNCHED MAR 20 1974

MASTER CARD JCM  
Record by WTR

Source of data BOWC MGS

Date 5/72 Map

State MISS County 28 (or town) SIMPSON 64

Latitude: 31° 53' 22" N Longitude: 089° 53' 38" W Sequential number: 1

Local use: 064159 Owner or name: BOGGAN RIDGE WA

Local well number: J033CD2801NO4E Other number: B & M

Local use: 064159 Owner or name: BOGGAN RIDGE WA

Owner or name: BOGGAN RIDGE WA Address: Mendenhall

Ownership: County, Fed Gov't, City, Corp or Co, Private, State Agency, Water Dist N

Use of water: Air cond, Bottling, Comm, Dewater, Power, Fire, Dom, Irr, Med, Ind, P S, Rec, Stock, Instit, Unused, Recharge, Desal-P S, Desal-other, Other P

Use of well: Anode, Drain, Seismic, Heat Res, Obs, Oil-gas, Recharge, Test, Unused, Withdraw, Waste, Destroyed. W

DATA AVAILABLE: Well data  Freq. W/L meas:  Field aquifer char.

Hyd. lab. data:

Qual. water data; type:

Freq. sampling:  Pumpage inventory:  yes no, period:

Aperture cards:  yes

Log data: Elv 10' - 655' DE

WELL-DESCRIPTION CARD

SAME AS ON MASTER CARD Depth well: 629 ft Meas. rept accuracy 3

Depth cased: 579 ft Casing type: STEEL; Diam. 16 in

Finish: porous concrete, gravel w. gravel w. horiz. open perf., screen, sd. pt., shored, open hole, other S

Method Drilled: air bored, cable, dug, hyd jetted, air reverse trenching, driven, drive wash, other H

Date Drilled: 5-3-72 972 Pump intake setting: 36 ft

Driller: SINGER-LAYNE name address

Lift (type): air, bucket, cent, jet, multiple, multiple, none, piston, rot, submerg, turb, other T Deep  Shallow

Power (type): diesel, elec, gas, gasoline, hand, gas, wind; H.P. 60 W Trans. or meter no. 39

Descrip. MP 1" nipple at 3.0' ft above LSD, Alt. MP 460

Alt. LSD: 450 Accuracy: 460 11/24/81 topo

Water Level: 182 ft above MP; 182 ft below LSD Accuracy: 52

Date meas: 6.7.72 Yield: 400 gpm Method determined 61

Drawdown: 62 ft Accuracy: 60 Pumping period 68 hrs

QUALITY OF WATER DATA: Iron 69 ppm Sulfate 70 ppm Chloride 71 Hard. 72 ppm

Sp. Conduct 73 K x 10<sup>6</sup> Temp. 74 °F Date sampled 75

Taste, color, etc. 76 77 79

11/24/81  
296  
75.05  
220.95  
3.2  
100  
218  
247

Well No. W W W

Latitude-longitude \_\_\_\_\_  
N  
S  
d m s d m s

HYDROGEOLOGIC CARD

Physiographic Province: 03 Section: \_\_\_\_\_  
SAME AS ON MASTER CARD

Drainage Basin: 13T Subbasin: \_\_\_\_\_

Topo of well site: (D) (C) (E) (F) (H) (K) (L) depression, stream channel, dunes, flat, hilltop, sink, swamp.  
(0) (P) (S) (T) (U) (V) offshore, pediment, hillside, terrace, undulating, valley flat

MAJOR AQUIFER: system \_\_\_\_\_ series TM aquifer, formation, group CA

Lithology: \_\_\_\_\_ Origin: \_\_\_\_\_ Aquifer Thickness: 65 ft

Length of well open to: \_\_\_\_\_ ft 50 Depth to top of: \_\_\_\_\_ ft 568

MINOR AQUIFER: system \_\_\_\_\_ series \_\_\_\_\_ aquifer, formation, group \_\_\_\_\_

Lithology: \_\_\_\_\_ Origin: \_\_\_\_\_ Aquifer Thickness: \_\_\_\_\_ ft

Length of well open to: \_\_\_\_\_ ft \_\_\_\_\_ Depth to top of: \_\_\_\_\_ ft \_\_\_\_\_

Intervals Screened: 8" 55

Depth to consolidated rock: \_\_\_\_\_ ft \_\_\_\_\_ Source of data: \_\_\_\_\_

Depth to basement: \_\_\_\_\_ ft \_\_\_\_\_ Source of data: \_\_\_\_\_

Surficial material: \_\_\_\_\_ Infiltration characteristics: \_\_\_\_\_

Coefficient Trans: \_\_\_\_\_ gpd/ft \_\_\_\_\_ Coefficient Storage: \_\_\_\_\_

Coefficient Perm: \_\_\_\_\_ gpd/ft<sup>2</sup>; Spec cap: \_\_\_\_\_ gpm/ft; Number of geologic cards: \_\_\_\_\_

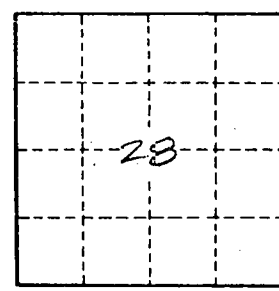
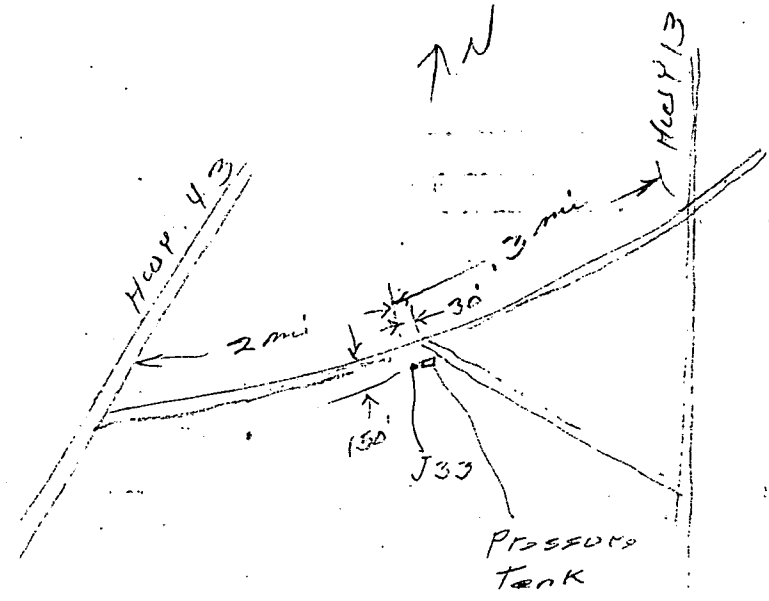

Well No.

533

Driller reported 42' dd @ 40 gpm