

WRD Exp. (GW)
April 1966

Well No. N3

WELL SCHEDULE
GEOLOGICAL SURVEY

EL LOG 58

U. S. DEPT. OF THE INTERIOR

WATER RESOURCES DIVISION

MASTER CARD

Record by Paul Grantam 3-3-66 Source of data Drill (Cox) Date 1-11-67 Map Morton Cr.

State Miss County Scott Sequential number: 6

Latitude: 32° 18' 27" N Longitude: 089° 39' 48" W

Lat-long accuracy: 3 T. 50 S. R. 60 W. Sec 3 SE $\frac{1}{4}$, NE $\frac{1}{4}$

Local well number: N003DA0305N06E Other number: B & M

Local use: 175058 Owner or name: Henry Young

Owner or name: Henry Young Address: Morton Cr.

Ownership: County, Fed Gov't, City, Corp or Co, Private, State Agency, Water Dist

Use of water: (A) Air cond, (B) Bottling, (C) Comm, (D) Dewater, (E) Power, (F) Fire, (G) Dom, (H) Irr, (I) Med, (M) Ind, (P) S, (R) Rec, (S) Stock, (T) Instit, (U) Unused, (V) Repressure, (W) Recharge, (X) Desal-P S, (Y) Desal-other, (Z) Other

Use of well: (A) Anode, (D) Drain, (G) Seismic, (H) Heat Res, (I) Obs, (J) Oil-gas, (K) Recharge, (L) Test, (M) Unused, (N) Withdraw, (O) Waste, (P) Destroyed

DATA AVAILABLE: Well data Freq. W/L meas.: Field aquifer char.

Hyd. lab. data: _____

Qual. water data; type: _____

Freq. sampling: _____ Pumpage inventory: yes, no, period: _____

Aperture cards: _____

Log data: Elog # 58

WELL-DESCRIPTION CARD

SAME AS ON MASTER CARD Depth well: 1052 ft Meas. 1052 Driller's 24

Depth cased: 1020 ft Casing type: steel ; Diam. 4 in

Finish: (C) porous concrete, (F) gravel w. (G) gravel w. (H) horiz. (I) open perf. (J) screen, (K) sd. pt., (L) shored, (M) open hole, (N) other

Method Drilled: (A) rot, (B) air bored, (C) cable, (D) dug, (E) hyd rot, (F) jetted, (G) air percussion, (H) rotary, (I) reverse, (J) trenching, (K) driven, (L) drive wash, (M) other

Date Drilled: 3-1966 Pump intake setting: 966 ft

Driller: Water Wells Inc., Jackson Miss

Lift (type): (A) air, (B) bucket, (C) cent, (D) jet, (E) multiple, (F) multiple, (G) none, (H) piston, (I) rot, (J) submerg, (K) turb, (L) other, (M) 5 Deep, (N) Shallow

Power (type): diesel (elec, gas, gasoline, hand, gas, wind, H.P.) 3/4 Trans. or meter no. 5

Descrip. MP 490 ft above LSD, Alt. MP 480 Accuracy: CI 20

Water Level 226 ft above MP; Ft below LSD 226 Accuracy: Rep

Date meas: 3-66 Yield: 20 gpm Method determined: 8

Drawdown: _____ ft Accuracy: _____ Pumping period: _____ hrs

QUALITY OF WATER DATA: Iron _____ Sulfate _____ Chloride _____ Hard. _____

Sp. Conduct _____ K x 10⁶ Temp. _____ °F Date sampled: _____

Taste, color, etc. _____

Well No. _____

NS

Latitude-longitude _____
d m s N S d m s

HYDROGEOLOGIC CARD

SAME AS ON MASTER CARD 03 Section: _____
 Physiographic Province: _____

D Drainage Basin: _____ Subbasin: 7
22 23 24 25 26

Topo of well site: (D) depression, (C) stream channel, (E) dunes, (F) flat, (H) hilltop, (K) sink, (L) swamp, (P) offshore, (S) pediment, (T) hillside, (U) terrace, (V) undulating, valley flat
H

MAJOR AQUIFER: Tertiary system, Eocene series, TE aquifer, formation, group, S.S.
28 29 30 31

Lithology: Sand, US Origin: US Aquifer Thickness: 170 ft
32 33 34

170 Length of well open to: 20 ft 20 Depth to top of: 920 ft 940
35 36 37 38 39 40 41 42

MINOR AQUIFER: _____ system, _____ series, _____ aquifer, formation, group, _____
44 45 46 47

Lithology: _____ Origin: _____ Aquifer Thickness: _____ ft
48 49 50

Length of well open to: _____ ft _____ Depth to top of: _____ ft _____
51 52 53 54 55 56 57 58 59

Intervals Screened: 920-930 & 990-1000

Depth to consolidated rock: _____ ft _____ Source of data: _____
60 61 62 63 64

Depth to basement: _____ ft _____ Source of data: _____
65 66 67 68 69

Surficial material: _____ Infiltration characteristics: _____
70 71 72

Coefficient Trans: _____ gpd/ft _____ Coefficient Storage: _____
73 74 75 76 77 78

Coefficient Perm: _____ gpd/ft²; Spec cap: _____ gpm/ft; Number of geologic cards: _____
79

Seven S.S. 1008 4 1/2; 20ft.

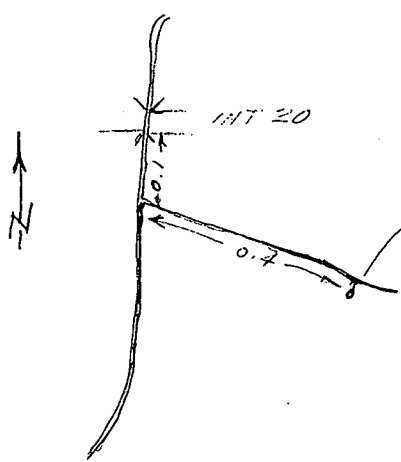

	Thick.	Depth
Reddish Sky Clay	8	8
Yellow coarse Sd	11-19	
Bluish Clay	326-345	
Gray Sky Shale	131-476	
Gray white Med-Course Sand	164-640	
Sand-Shale Rock	200	840
Sand & Shale	150-990	
White Sand fine	62	1052
White Sand med-course		

Well No. _____