

TRANSMITTED FOR ADP

1/81 WLO

Recorded by

WTO

U.S. GEOLOGICAL SURVEY

3/85

Well No.

L45<sup>6</sup>

Date

8/20/84

WATER RESOURCES DIVISION

E-Log No.

141

MISSISSIPPI DISTRICT

County

SCOTT

WELL RECORD

Site ID

3 2 2 1 5 7 0 8 9 2 7 1 9 0 1

R=0\*

T=A\*

2=W\*

Data reliab.

3=C\*

Report. agency

4=USGS\*

Dist.

6=28\*

7=28\*

Co.

8=123\*

Lat.

Long./

9=3 2 2 1 5 7 \*

10=0 8 9 2 7 1 9 \*

Well No.

12=L 0 4 6 \*

SW SW Location

13=N W N W s 1 4 T 0 6 N R 0 8 E \*

Alt.

16=4 7 4 6 2

Hyd. Unit (OWDC)

20=0 3 1 8 0 0 0 1 \*

Date

21=0 8 1 0 6 1 1 9 8 4 \*

Well use

23=W \*

Water use

24=P \*

Hole depth

27=1 7 5 6 . \*

Well depth

28=1 3 6 2 . \*

WL

30=2 1 6 . \*

Date

31=0 8 1 0 6 1 1 9 8 4 \*

Source

33=D \*

Status

273 = \*

Project No.

5=

R=158\*

T=A\*

Date

159# 0 8 1 0 6 1 1 9 8 4 \*

Owner No.

#6

Owner

161# F O R E S T

R=199\*

T=A\*

Date

193#

Temp.

196#00010\*

197#

R=192\*

T=A\*

Date

193#

Cond.

196#00095\*

197#

R=192\*

T=A\*

Date

193#

pH

196#00400\*

197#

R=58\*

T=A\*

Date

59# 1 \* 60=0 8 1 0 6 1 1 9 8 4 \*

Remarks

D=63\*

1 8 4 \*

Name

G r a n e

Method

65=4 \*

Finish

66=S \*

R=76\*

T=A\*

Date

59# 1 \*

Top csgn

77# 1 0 \*

Bot. csgn

78# 1 3 5 2 . \*

Diam.

79# 1 1 6 . \*

R=76\*

T=A\*

Date

59# 1 \*

Top csgn

77# 1 0 \*

Bot. csgn

78#

Diam.

79#

R=82\*

T=A\*

Date

59# 1 \*

Top

83# 1 3 5 2 . \*

Bottom

84# 1 3 6 2 . \*

Type

85=S \*

Diam

87=8 . \*

Size

88=

R=82\*

T=A\*

Date

59# 1 \*

Top

83#

Bottom

84#

Type

85=

Diam.

87=

Size

88=

R=146\*

T=A\*

Date

147# 1 \*

Q

150=1 0 0 0 . \*

Q/S

272=

134 flows 146 pumped

GEN. SITE DATA

OWNER

FIELD

CONSTR.

CASING

OPENINGS

YIELD

LIFT

R=42\* T= A \* Lift type 430 T \* Intake 44 \* Power type 45 E \*

Date 38 08/06/1984 \* H.P. 46 200 \*

LOGS

R=198\* T= A \* Log 199 E \* Top 200 4.2 \* Bot 201 75.0 \*

R=198\* T= A \* Log 199 D \* Top 200 0 \* Bot 201 75.0 \*

R=189\* T= A \* E Log No. 190 \* 191 MISS DIST \*

ANAL.

R=114\* T= A \* Year 115 \* 117 \* 120 \*

AQUIFERS

R=90\* T= A \* 256 1 \* Top 91 1,260 \* Bot 92 1,380 \*

Unit ID 93 1,24 M.U.W. x \* Name of Unit

R=90\* T= A \* 256 1 \* Top 91 \* Bot 92 \*

Unit ID 93 \* Name of Unit

HYDRAULICS

R=98\* T= A \* 99 1 \* Unit tested 100 \*

R=105\* T= A \* 99 1 \* Test No. 106 \*

107 \* Transmissivity (gal/d)

108 \* Hydraulic cond. (gal/d)

110 \* Storage coeff. Boundary

R=121\* T= A \* Begin 122 \* \*

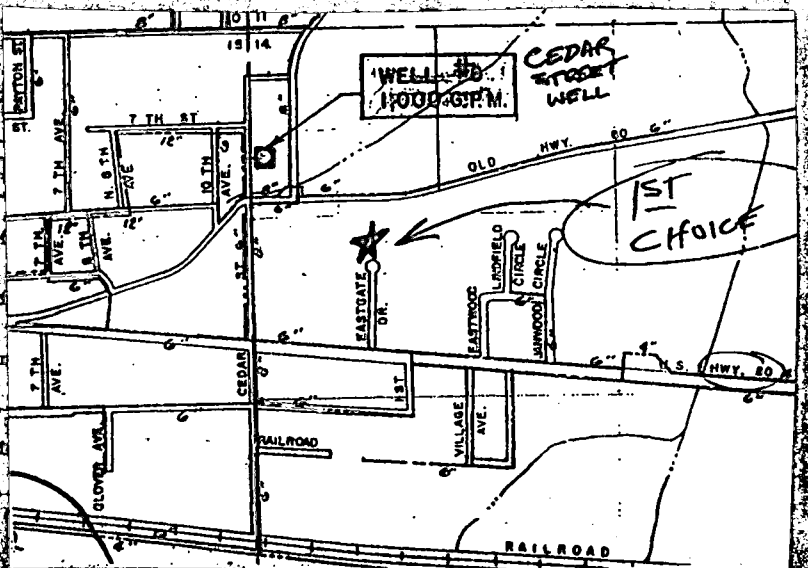

Water Level Data Collection (1)

pH = 8.7  
 Fe = 35  
 Mn = 10  
 Cl = 11  
 TANK = 360  
 Color = 60

WSL = 224  
 d = 79 @ 1002 gpm

CLAY	3	196
SAND + CLAY STREAKS	195	330
CLAY + Rocks	330	570
SAND	570	670
SAND + CLAY STREAKS	670	719
CLAY + Rocks	712	1250
SAND + thin CLAY STREAKS	1250	1386
CLAY	1386	1392
SAND + CLAY STREAKS	1392	1430
CLAY + Rocks, hard	1430	1560
CLAY + Rocks, with thin	1560	1636
SAND STREAKS		
CLAY + Rocks, hard	1636	1756

620002-07  
6W-00956

*Prod. Well*

MISSISSIPPI DEPARTMENT OF NATURAL RESOURCES  
Bureau of Land and Water Resources  
Southport Mall  
P.O. Box 10631  
Jackson, Mississippi 39209  
WATER WELL DRILLERS LOG

**CODED**

SCOTT  
L46  
8-6-84

19 84 KAIMER DRILLING SERV. SCOTT  
date well completed firm name county well located

LANDOWNER:	description of formations encountered	from	to
<u>CITY OF FOREST</u>	<u>TOP SOIL</u>	<u>0</u>	<u>3</u>
<u>8-84</u>	<u>CLAY</u>	<u>3</u>	<u>196</u>
(mailing address)	<u>SAND + CLAY STREAKS</u>	<u>195</u>	<u>330</u>
WELL LOCATION: <u>SW 1/4 SW 1/4 NW 1/4</u>	<u>CLAY + ROCKS</u>	<u>330</u>	<u>570</u>
<u>1400 T. 6N S. 8E</u>	<u>SAND</u>	<u>570</u>	<u>670</u>
(distance) miles (direction) of (nearest town)	<u>SAND + CLAY STREAKS</u>	<u>670</u>	<u>719</u>
WELL PURPOSE: (home, irrigation, <u>municipal</u> , industrial)	<u>CLAY + ROCKS</u>	<u>712</u>	<u>1250</u>
WELL COMPLETION DATA:	<u>SAND + thin CLAY streaks</u>	<u>1250</u>	<u>1386</u>
(1) diameter (inches) <u>16"</u>	<u>CLAY</u>	<u>1386</u>	<u>1392</u>
(2) total depth (feet) <u>1372</u>	<u>SAND + CLAY STREAKS</u>	<u>1392</u>	<u>1430</u>
(3) static water level (feet) <u>216</u> (below/above top of ground)	<u>CLAY + ROCKS, hard</u>	<u>1430</u>	<u>1560</u>
(4) casing (material) <u>steel</u> , (depth) <u>1252</u>	<u>CLAY + ROCKS with thin</u>	<u>1560</u>	<u>1636</u>
<u>16</u> if telescope see back. (size)	<u>SAND STREAKS</u>		
(5) screen (length) <u>1810</u> , (depth to top) <u>1262</u>	<u>CLAY + ROCKS, hard</u>	<u>1636</u>	<u>1756</u>
<u>8"</u> (size), <u>(0.016")</u> (material), <u>304 S.S.</u>			
(6) pump (HP) <u>800</u> , (yield gpm) <u>1000</u>			
<u>EL Oct.</u> (type power)			
(7) electric log <u>Yes</u> (yes or no)			
<u>MGS</u> (organization running log)			
(8) how well bottom plugged <u>BACK</u>			
DRILLERS REMARKS:			

L45 was the test well  
L46 is the production well.

RECEIVED  
FEB 07 1984

Department of Natural Resources  
Bureau of Land & Water Resources

①

If well telescopes please  
sketch and show depths.

GROUND LEVEL

SECTION \_\_\_\_\_

Please indicate well location X.

ADDITIONAL INFORMATION

If more than one screen,  
show locations of each on sketch.

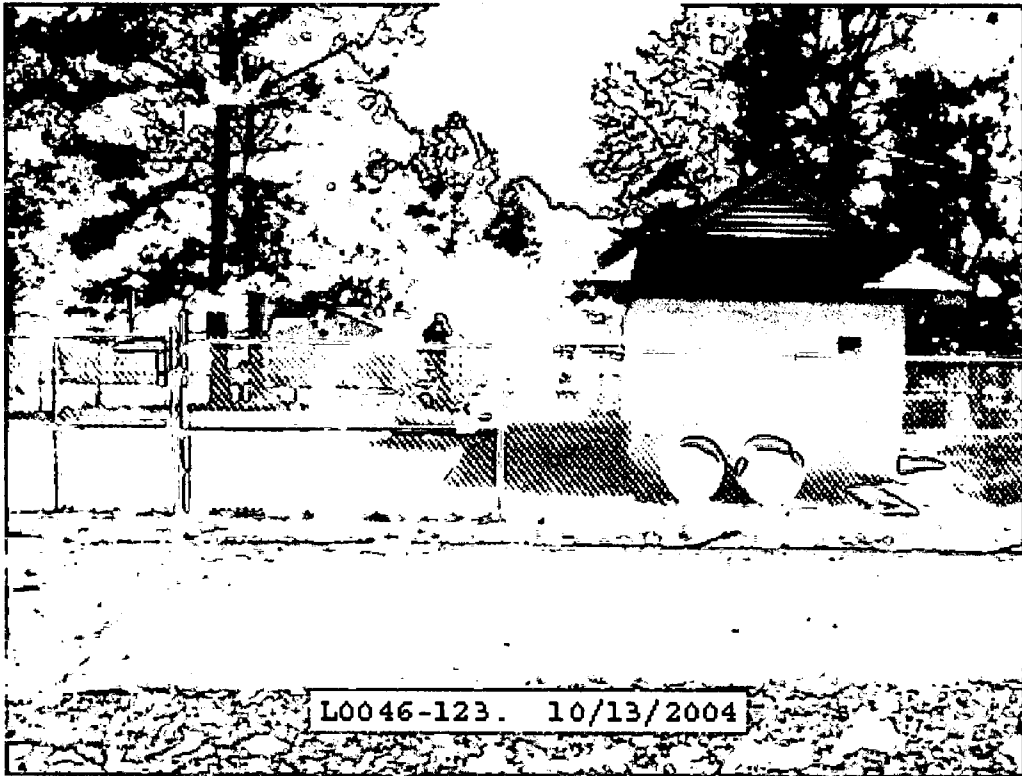

L0046-123. 10/13/2004

Real Time

DEPARTMENT OF ENVIRONMENTAL QUALITY - OLWR

PUBLIC SUPPLY WELLS PROJECT

GPS LOG

AUG 9 04

USER NAME(S): Phillips/Hardin DATE: 4/24/97

UNIT DEQ #: \_\_\_\_\_ FILE #: A042418C

HEALTH DEPT. #: 620002-07 ELEV. ~~469~~ 462 <sup>LWW</sup> 2/9/04

USGS #: L46 <sup>LWW</sup> 2/9/04 OLWR #: GW-00956 <sup>LWW</sup> 2/9/04

OWNER: City of Forest QUAD: Forest

LOCATION: NW/NW S 14 T 6N R 8E COUNTY: Scott

LOCATION DESCRIPTION: On east side of Cedar St. north of

Hwy 80

CASING DIA: 16" PUMP TYPE & SIZE: Turbine; 200 HP

GPS FIELD LOCATION: LAT. 32° 22.025' N LONG. 89° 27.356' W

GPS CORRECTED LOCATION: LAT. 32.36705980 LONG. 89.45589665

REMARKS: Measured 45' west of well

\_\_\_\_\_  
\_\_\_\_\_  
\_\_\_\_\_

tagged  
LWW  
10/13/04  
32.36712  
89.45577  
pic 107