

REPLACEMENT

Well No. L21

Log # 80

WELL SCHEDULE

U. S. DEPT. OF THE INTERIOR

GEOLOGICAL SURVEY

WATER RESOURCES DIVISION

6W-00927 (MU)

Backup for L27 MUX

MASTER CARD

620002-02

Record by P.E. Grantham

Source of data Driv. + Elag

Date 2-21-68

Map FOREST

State Mississippi 28 County (or town) Scott 62

Latitude: 32^{deg} 21^{min} 03^{sec} N Longitude: 089^{12 degrees} 28^{13 min} 57^{sec 10} Sequential number: 1

Lat-long accuracy: 3 T. 6 S. R. 8 W. Sec 21, NW SW NE

Local well number: L021BA2106NO8E Other number: Well 69-1

Local use: 064080 Owner or name: City of Forest #1

Owner or name: FOREST Address: _____

Ownership: County, Fed Gov't, City, Corp or Co, Private, State Agency, Water Dist M

Use of water: (A) Air cond, Bottling, Comm, Dewater, Power, Fire, Dom, Irr, Med, Ind, P S, Rec, (S) Stock, Instit, Unused, Repressure, Recharge, Desal-P S, Desal-other, Other P

Use of well: (A) Anode, Drain, Seismic, Heat Res, Obs, Oil-gas, Recharge, Test, Unused, Withdraw, Waste, Destroyed, (D) (G) (H) (P) (R) (T) (U) (W) (X) (Z) W

DATA AVAILABLE: Well data Freq. W/L meas.: Field aquifer char.

Hyd. lab. data: _____

Qual. water data; type: MASON

Freq. sampling: _____ Pumpage inventory: yes no; period: _____

Aperture cards: _____

Log data: E-log 1367 Mud Res. 1367 DE

WELL-DESCRIPTION CARD

SAME AS ON MASTER CARD Depth well: _____ ft 1320 Meas. rept. accuracy 3

Depth cased: (first perf.) _____ ft 1220 Casing type: Steel; Diam. 16 in 16

Finish: porous concrete, gravel w. (perf.), gravel w. (screen), horiz. gallery, open end, (H) (P) (S) (T) (W) (X) (Z) S

Method: (A) air bored, (B) cable, (C) dug, (D) hyd jetted, (E) air rot., (F) percussion, (G) rotary, (H) reverse, (I) trenching, (J) driven, (K) wash, (L) other H

Date Drilled: 969 Pump intake setting: _____ ft _____

Driller: Laure Central Co, Jackson Miss

Lift: (A) air, (B) bucket, (C) cent., (D) jet, (E) multiple, (F) multiple, (G) none, (H) piston, (I) rot., (J) submerg, (K) turb, (L) other T Deep Shallow

Power: (type): diesel, elec, gas, gasoline, hand, gas, wind; H.P. _____ Trans. or meter no. _____

Descrip. MP 472 ft above _____ below LSD, Alt. MP _____

Alt. LSD: 480 480 Accuracy: (source) 20' CI 3

Water Level: _____ ft above _____ below MP; _____ ft above _____ below LSD Accuracy: 180 4

Date meas: 269 Yield: _____ gpm 750 Method determined 4

Drawdown: _____ ft 111 Accuracy: _____ Pumping period: _____ hrs _____

QUALITY OF WATER DATA: Iron _____ ppm Sulfate _____ ppm Chloride _____ ppm Hard. _____ ppm

Sp. Conduct _____ K x 10⁶ Temp. _____ °F Date sampled _____

Taste, color, etc. _____

ROLLA COMPUTATION BRANCH PUNCHED and VERIFIED

Well No.

L21

7 gpm/ft

Latitude-longitude N
S
d m s d m s

HYDROGEOLOGIC CARD

SAME AS ON MASTER CARD **Physiographic Province:** 03 **Section:** _____

Drainage Basin: D **Subbasin:** 113T

Topo of well site: (D) depression, stream channel, dunes, flat, hilltop, sink, swamp, (E) (F) (R) (K) (L) (P) (S) (T) (U) (V) offshore, pediment, hillside, terrace, undulating, valley flat _____

MAJOR AQUIFER: TE **system** _____ **series** 28 29 **aquifer, formation, group** MW **Thickness:** _____ ft

Lithology: U5 **Origin:** 2 **Thickness:** _____ ft

Length of well open to: 7.6 ft **Depth to top of:** 7.0 ft **1216** ft A22

MINOR AQUIFER: _____ **system** _____ **series** 44 45 **aquifer, formation, group** _____ **Thickness:** _____ ft

Lithology: _____ **Origin:** _____ **Thickness:** _____ ft

Length of well open to: _____ ft **Depth to top of:** _____ ft

Intervals Screened: 1220-1260 and 1290-1320

Depth to consolidated rock: _____ ft **Source of data:** _____

Depth to basement: _____ ft **Source of data:** _____

Surficial material: _____ **Infiltration characteristics:** _____

Coefficient Trans: _____ **Coefficient Storage:** _____

Perm: _____ **Spec cap:** 7 **Number of geologic cards:** _____

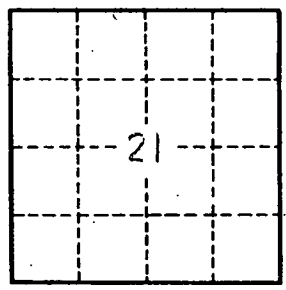
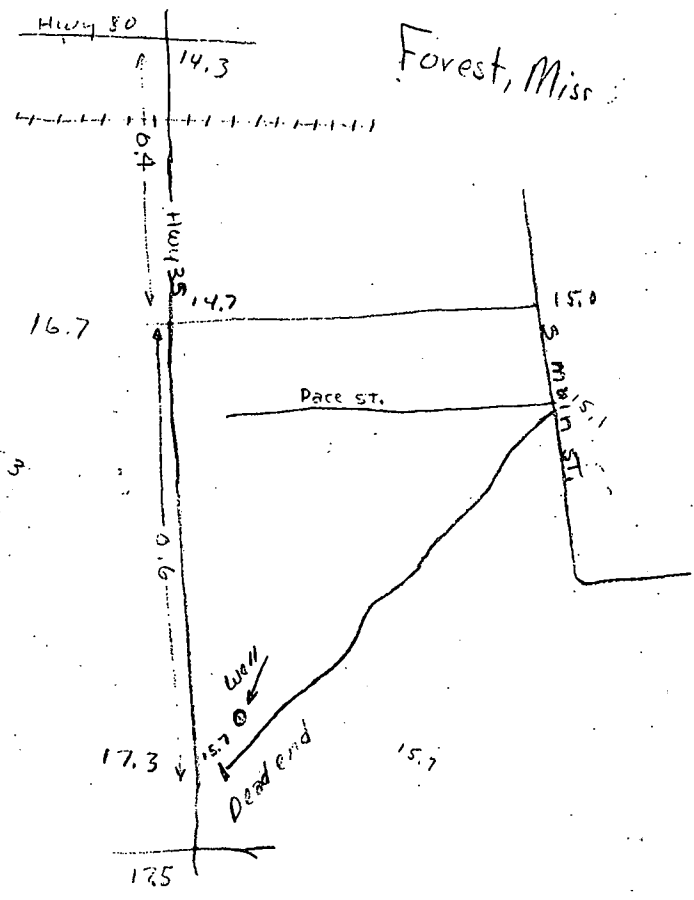

MBON Sample
From WBF
1240-1260
1290-1310

}

Split Screen

Well No.

127

L21
Scott Co.

MISSISSIPPI
BOARD OF WATER COMMISSION
416 North State Street
Jackson, Mississippi 39201

CODED

WATER WELL DRILLERS LOG

5/8 1969 Layne-Central Co. Scott
date well completed firm name county well located

LANDOWNER:	description of formations encountered	from	to
<u>City of Forest, Miss.</u>	<u>Yellow Clay</u>	<u>0</u>	<u>32</u>
<u>Forest, Miss.</u>	<u>Blue Clay</u>	<u>32</u>	<u>171</u>
(mailing address)	<u>Sand</u>	<u>171</u>	<u>250</u>
WELL LOCATION: <u>old Tannon Road</u>	<u>Hard Shale</u>	<u>250</u>	<u>310</u>
sec <u>21</u> T <u>6</u> N R <u>8</u> E	<u>Sand</u>	<u>310</u>	<u>398</u>
Information not available	<u>Hard Shale</u>	<u>398</u>	<u>488</u>
_____ miles _____ of _____	<u>Hard Rock</u>	<u>488</u>	<u>490</u>
(distance) (direction) (nearest town)	<u>Shale, Sand, D Rock</u>	<u>490</u>	<u>574</u>
WELL PURPOSE: <u>Municipal</u>	<u>Shale, Sand, Shale</u>	<u>574</u>	<u>665</u>
(home, irrigation, municipal, industrial)	<u>Sand</u>	<u>665</u>	<u>785</u>
WELL COMPLETION DATA:	<u>Shale</u>	<u>785</u>	<u>804</u>
(1) diameter (inches) <u>16"</u>	<u>Rock</u>	<u>804</u>	<u>806</u>
(2) total depth (feet) <u>1326'</u>	<u>Hard Shale</u>	<u>806</u>	<u>847</u>
(3) static water level (feet) <u>157'</u> below top of ground.	<u>Rock</u>	<u>847</u>	<u>850</u>
(4) casing <u>Steel</u> <u>1215'</u> (material) (depth)	<u>Shale, Hard Shale</u>	<u>850</u>	<u>947</u>
<u>16"</u> (size) If telescope see back.	<u>Rock</u>	<u>947</u>	<u>961</u>
(5) screen <u>70'</u> <u>1220'</u> (length) (depth to top)	<u>Hard Shale</u>	<u>961</u>	<u>971</u>
<u>8"</u> <u>Stainless Steel</u> (size) (material)	<u>Hard Shale</u>	<u>971</u>	<u>993</u>
(6) pump <u>700</u> (HP) (yield gpm)	<u>Sand</u>	<u>993</u>	<u>1002</u>
(type power)	<u>Shale, Sand, Shale, Sand</u>	<u>1002</u>	<u>1061</u>
(7) electric log <u>yes</u> (yes or no)	<u>Sand</u>	<u>1061</u>	<u>1067</u>
<u>U.S.G.S.</u> (organization running log)	<u>Shale</u>	<u>1067</u>	<u>1074</u>
(8) how well bottom plugged _____	<u>Rock</u>	<u>1074</u>	<u>1078</u>
	<u>Gummy Shale</u>	<u>1078</u>	<u>1140</u>
	<u>Rock</u>	<u>1140</u>	<u>1144</u>
	<u>Shale, Sand, Shale, Sand</u>	<u>1144</u>	<u>1205</u>
	<u>Sand</u>	<u>1205</u>	<u>1254</u>
	<u>Hard Shale</u>	<u>1254</u>	<u>1259</u>
	<u>Sand</u>	<u>1259</u>	<u>1269</u>
	<u>Shale (gummy)</u>	<u>1269</u>	<u>1284</u>
	<u>Sand</u>	<u>1284</u>	<u>1323</u>
	<u>Clay</u>	<u>1323</u>	<u>1326</u>
	<u>Sand, Shale, Lignite</u>	<u>1326</u>	<u>1354</u>
	<u>Shale</u>	<u>1354</u>	<u>1366</u>

MAY 23 1969

DRILLERS REMARKS:
Pump not installed as of this date

MISS. BD OF WATER COMM.



L0021-123. 10/13/2004

Real Time

DEPARTMENT OF ENVIRONMENTAL QUALITY - OLWR

PUBLIC SUPPLY WELLS PROJECT

GPS LOG

USER NAME(S): Hardin/Phillips DATE: 4/24/97

UNIT DEQ #: _____ FILE #: A0424180

HEALTH DEPT. #: 620002-02 ELEV. 472

USGS #: L21 LWW 8/2/04 OLWR #: GW-00927 LWW 8/2/04

OWNER: City of Forest QUAD: Forest

LOCATION: SW/NE S 21 T 6N R 8E COUNTY: Scott

LOCATION DESCRIPTION: Right off Hwy 35 on Trenton Rd

CASING DIA: 16" PUMP TYPE & SIZE: Turbine; 125 HP

GPS FIELD LOCATION: LAT. 32° 21.041' N LONG. 89° 28.859' W

GPS CORRECTED LOCATION: LAT. 32.35070397 LONG. 89.48101381

REMARKS: Measured 20' south of well

tagged
LWW
10/13/04
32,35082
89,48098
P106

Department of Environmental Quality
Office of Land and Water Resources

Ground Water Permit
General Report

Permit Number: MS-GW-00927

County: SCOTT

Owner: FOREST, CITY OF

Aquifer: MUWX

USGS No: L0021

BOH No: 0620002-02

Location: SW 1/4 of the NE 1/4 of SEC 21 TWN 06N RNG 08E **Lat:** 322103 **Long:** 892852

Quad: FOREST

District: N/A

Date Issued: 14-JAN-86

Date Renewed: 09-JAN-96

Date Expired: 14-JAN-06

Applicant: FOREST, CITY OF

Owner: FOREST, CITY OF

Address 1: 120 SOUTH DAVIS STREET

Address 1: 120 SOUTH DAVIS STREET

Address 2: PO BOX 298

Address 2: PO BOX 298

Address 3: N/A

Address 3: N/A

City: FOREST

City: FOREST

State: MS **Zip:** 39074

State: MS **Zip:** 39074

Driller: LAYNE CENTRAL

Maximum Rate: 620

Amount Withdrawn Acre feet: 660.9883

Amount Withdrawn Mgd: .59

Use

MUNICIPAL

Casing

Type: STEEL

Diameter: 16

Length: 1215

Screen

Type: STAINLESS STEEL

Diameter: 8

Length: 70