

WELL SCHEDULE

**516**

U. S. DEPT. OF THE INTERIOR

GEOLOGICAL SURVEY

WATER RESOURCES DIVISION

**SPRT**

**620017-01**  
**6W-00859(IN)**

MASTER CARD

Record by J. A. Callahan Source of data Tillery Eri. Date 1-6-67 Map MORTON QUAD.  
(E. H. Baswell 10-25-56)

State MISS County 28 (or town) Scott 62

Latitude: 32<sup>deg</sup> 21<sup>min</sup> 22<sup>sec</sup> N Longitude: 08<sup>deg</sup> 9<sup>min</sup> 39<sup>sec</sup> W Sequential number: 1

Lat-long accuracy: 2<sup>70</sup> T. 6 S, R. 6 W, Sec 23, SW SE NE NW

Local well number: J 016 A 23 06 N 06 E Other number: Koch Foods

Local use: 064 Owner or name: B. C. ROGERS

Owner or name: B. C. ROGERS CO. Address: MORTON MISS

Ownership: County (C) Fed Gov't (F) City (M) Corp or Co (N) Private (P) State Agency (S) Water Dist (W) N

Use of water: Air cond (A) Bottling (B) Comm (C) Dewater (D) Power (E) Fire (F) Dom (G) Irr (H) Med (I) Ind (N) P S, Rec (P) (R)

Use of well: Stock (S) Inst, Unused (T) Recharge (U) Recharge (V) Desal-P S (W) Desal-other (X) Other (Y) (Z) N

Use of well: Anode (A) Drain (D) Seismic (G) Heat Res (H) Obs (I) Oil-gas (J) Recharge (K) Test (L) Unused (M) Withdraw (N) Waste (O) Destroyed (P) (Q) (R) (S) (T) (U) (V) (W) (X) (Y) (Z) N

DATA AVAILABLE: Well data  Freq. W/L meas.:  Field aquifer char.

Hyd. lab. data:

Qual. water data; type:

Freq. sampling:  Pumpage inventory: yes  no  period:

Aperture cards:  yes

Log data:

WELL-DESCRIPTION CARD

SAME AS ON MASTER CARD Depth well: 934 ft Meas. driller 934 3

Depth cased; (first perf.) 874 ft Casing type: Steel ; Diam. 10X6 in 10

Finish: porous concrete (C) gravel w. concrete (F) gravel w. screen (G) horis. gallery (H) open end (I) open hole (J) other (K) (L) (M) (N) (O) (P) (Q) (R) (S) (T) (U) (V) (W) (X) (Y) (Z) G

Method Drilled: (A) air bored (B) cable (C) dug (D) hyd rot (E) jetted (F) air percussion (G) reverse (H) drive (I) wash (J) other (K) (L) (M) (N) (O) (P) (Q) (R) (S) (T) (U) (V) (W) (X) (Y) (Z) H

Date Drilled: 9-56 956 Pump intake setting:  ft

Driller: Layne Central Co. Jackson Miss.

Lift (type): (A) air (B) bucket (C) cent. (D) jet (E) multiple (F) multiple (G) none (H) piston (I) rot (J) submerg (K) turb (L) other (M) (N) (O) (P) (Q) (R) (S) (T) (U) (V) (W) (X) (Y) (Z) T Deep D

Power (type): diesel (D) elec (E) gas (F) gasoline (G) hand (H) gas (I) wind (J) H.P. (K) (L) (M) (N) (O) (P) (Q) (R) (S) (T) (U) (V) (W) (X) (Y) (Z) V Trans. or meter no.

Descrip. MP 480 ft above LSD, Alt. MP

Alt. LSD: 490 Accuracy: CI 20 5

Water Level: 230 ft above MP; Ft. below LSD 230 Accuracy:

Date meas: 10-56 056 Yield: 400 gpm 400 Method determined

Drawdown:  ft Accuracy:  Pumping period:  hrs

QUALITY OF WATER DATA: Iron  ppm Sulfate  ppm Chloride  ppm Hard.

Sp. Conduct  K x 10<sup>6</sup> Temp.  °F Date sampled

Taste, color, etc.

PUNCHED and VERIFIED  
ROLLA COMPUTATION BRANCH

Well No.

Latitude-longitude 32 21 22 S 089 39 16 W

DROGEOLOGIC CARD

AME AS ON MASTER CARD Physiographic Province: 03 Section:

Drainage Basin: 27 Subbasin: 26

Site: (D) (C) (E) (F) (H) (K) (L) (S) of depression, stream channel, dunes, flat, hilltop, sink, swamp, (S) hillside terrace, undulating, valley flat

OR IFER: Tertiary, Eocene TE Sparta S S aquifer, formation, group

Hology: Medium Grained Sand 3 S Origin: 2 Aquifer Thickness: ft

Length of well open to: 60 ft Depth to top of: 874 ft

OR IFER: system series aquifer, formation, group

Hology: Origin: Aquifer Thickness: ft

Length of well open to: ft Depth to top of: ft

Intervals screened: 874-934

Depth to consolidated rock: ft Source of data:

Depth to cement: ft Source of data:

Official: Silty Clay 7 P Infiltration characteristics: Poor 4

Efficient yield: gpd/ft Coefficient Storage: ft

Efficient yield: gpd/ft; Spec cap: gpm/ft; Number of geologic cards: 79

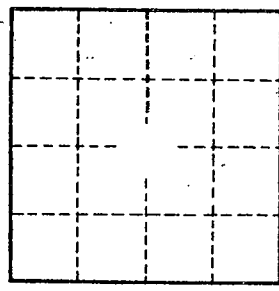
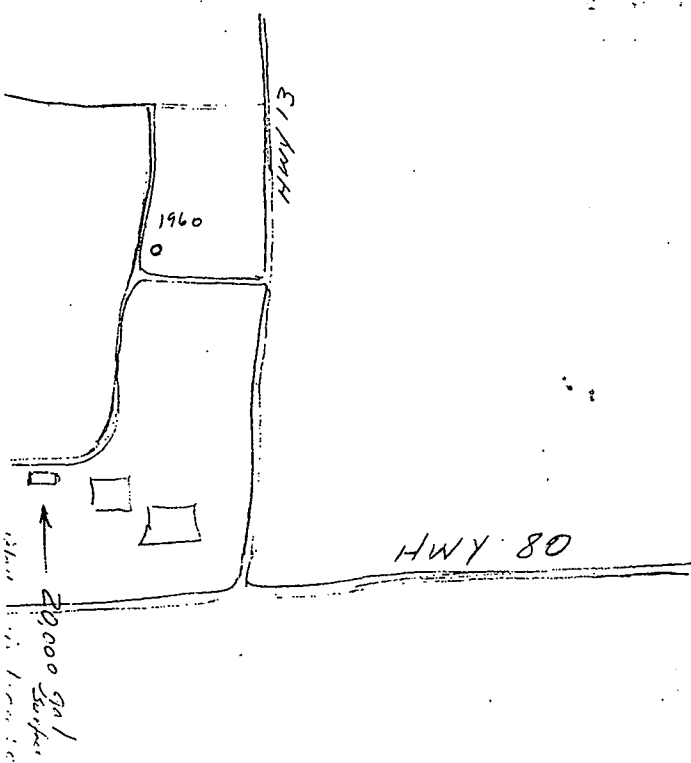

Well No.

J 16



J0016-123. 10/13/2004

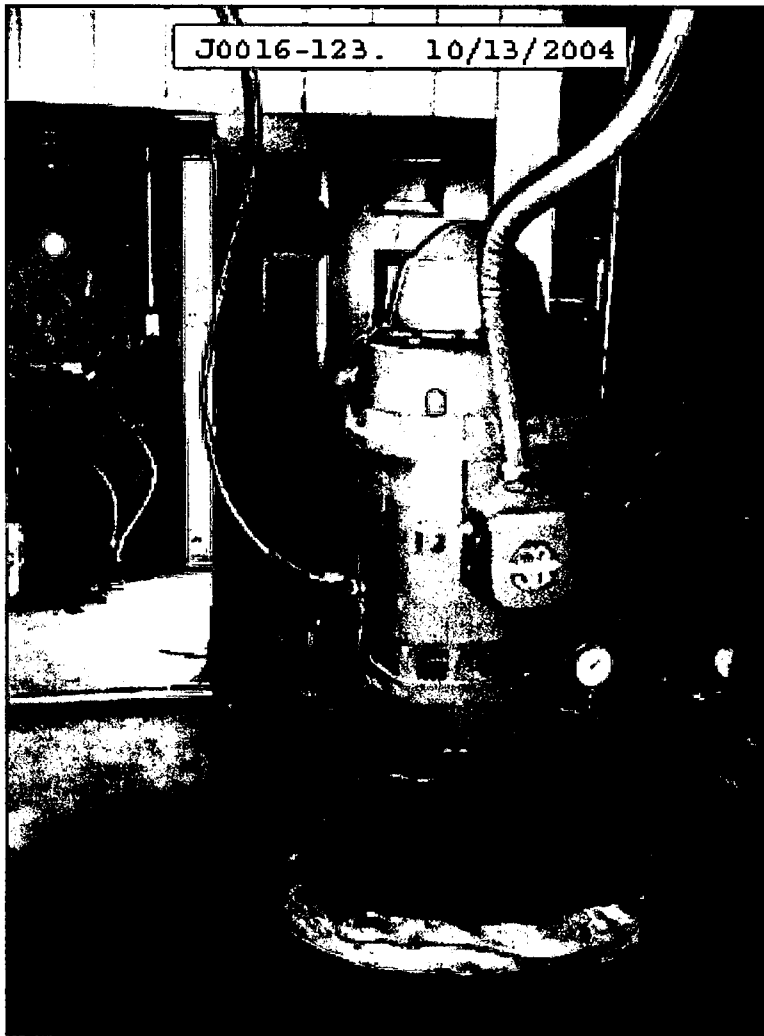

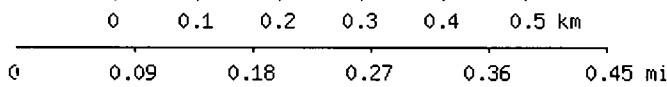
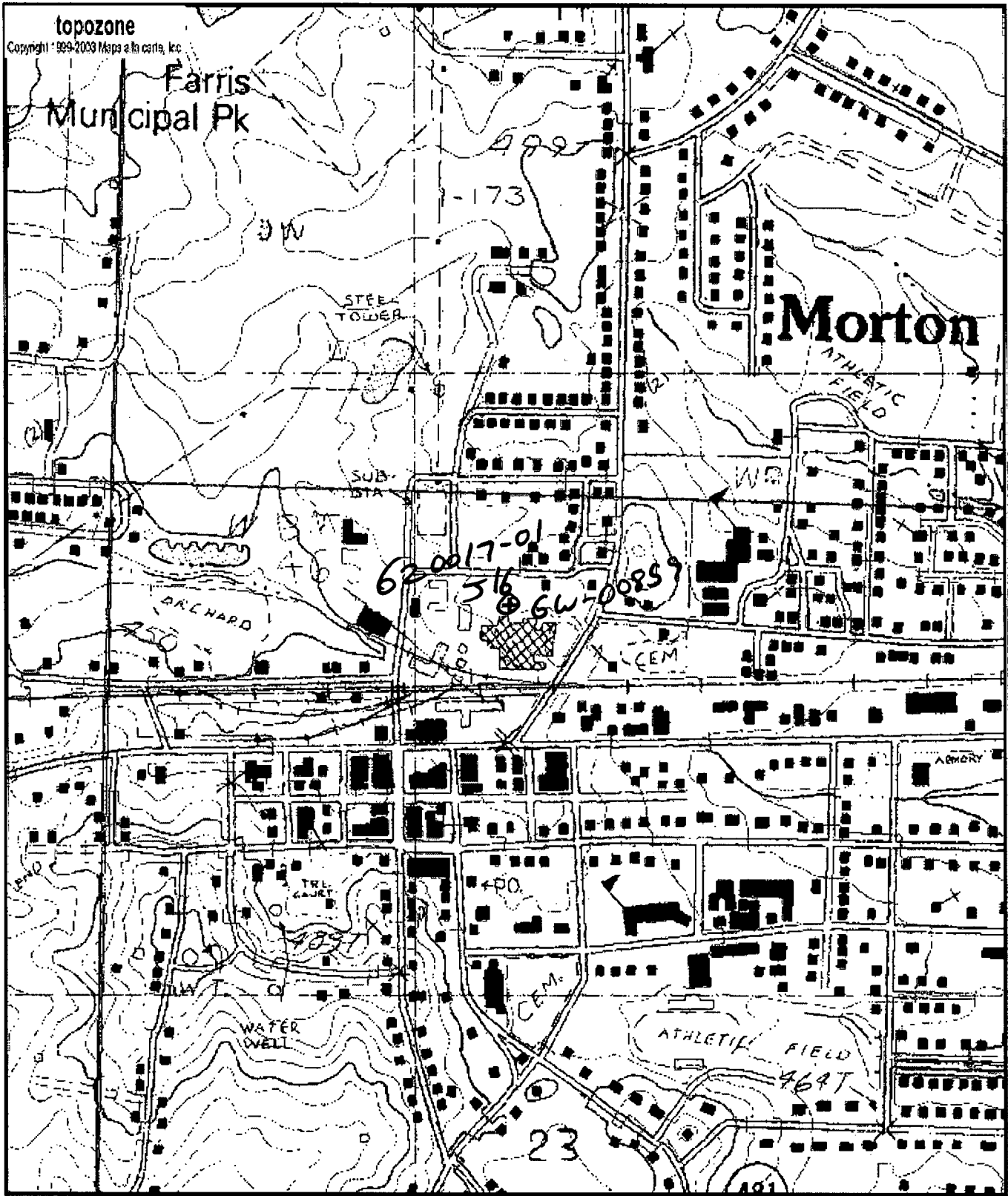

Map center is 32° 21' 17"N, 89° 39' 18"W (WGS84/NAD83)  
**Morton** quadrangle  
 Projection is UTM Zone 16 NAD83 Datum

5/1/97  
 PAP/DLH  
 M=0.057  
 G=-1.422



DEPARTMENT OF ENVIRONMENTAL QUALITY - OLWR

PUBLIC SUPPLY WELLS PROJECT

GPS LOG

USER NAME(S): Phillips/Hardin DATE: 5/1/97

UNIT DEQ #: \_\_\_\_\_ FILE #: A050115B

HEALTH DEPT. #: 620017-01 ELEV. 480

USGS #: 516 OLWR #: MS-GW-00859

OWNER: B.C. Rogers Poultry QUAD: Morton

LOCATION: NE/NW S 23 T 6N R 16E COUNTY: Scott

LOCATION DESCRIPTION: In well house next to B.C. Rogers Oil Co butane tank on plant site

CASING DIA: \_\_\_\_\_ PUMP TYPE & SIZE: Turbine 75 HP

GPS FIELD LOCATION: LAT. 32° 21.275' N LONG. 89° 39.300' W

GPS CORRECTED LOCATION: LAT. 32.354605 LONG. 89.65500669

REMARKS: Measured 30' north of well

\_\_\_\_\_  
\_\_\_\_\_  
\_\_\_\_\_

Tagged  
10/13/04 cww  
32.35456  
89.65502  
pic 97

**Department of Environmental Quality**  
**Office of Land and Water Resources**

**Ground Water Permit**  
**General Report**

**Permit Number:** MS-GW-00859

**County:** SCOTT

**Owner:** KOCH FOODS OF MISSISSIPPI

**Aquifer:** SPRT

**USGS No:** J0016

**BOH No:** 0620017-01

**Location:** NE 1/4 of the NW 1/4 of SEC 23 TWN 06N RNG 06E **Lat:** 322116 **Long:** 893916

**Quad:** MORTON

**District:** N/A

**Date Issued:** 14-JAN-86

**Date Renewed:** 14-JAN-97

**Date Expired:** 14-JAN-07

**Applicant:** KOCH FOODS OF MISSISSIPPI

**Owner:** KOCH FOODS OF MISSISSIPPI

**Address 1:** 4688 HIGHWAY 80

**Address 1:** 4688 HIGHWAY 80

**Address 2:** N/A

**Address 2:** N/A

**Address 3:** N/A

**Address 3:** N/A

**City:** MORTON

**City:** MORTON

**State:** MS **Zip:** 39117

**State:** MS **Zip:** 39117

**Driller:** LAYNE CENTRAL COMPANY

**Maximum Rate:** 510

**Amount Withdrawn Acre feet:** 560.1596

**Amount Withdrawn Mgd:** .5

**Use**

INDUSTRIAL

**Casing**

**Type:** STEEL

**Diameter:** 10

**Length:** 774

**Screen**

**Type:** STEEL

**Diameter:** 6

**Length:** 60