

WRD Exp. (GW)
April 1966

Well No. F 8
E 109 # 77

REPLACEMENT SCHEDULE

U. S. DEPT. OF THE INTERIOR GEOLOGICAL SURVEY WATER RESOURCES DIVISION

6W-1726(WA) Primary MUWX
620001-01

MASTER CARD

Record by WTO Source of data MSGs Date 9-68 Map Hillsboro
State 28 County (or town) SCOTT 62

Latitude: 32 28 25 N Longitude: 08 9 34 510 Sequential number: 1

Lat-long accuracy: 20 T. 7 S, R 7 W, Sec. 29 NNW NE NE Other number: B & M

Local well number: F008AA0407NO7E Owner or name: Test Hole #1

Local use: 145077 Owner or name: Test Hole #1

Owner or name: C & C W A Address: Test Hole #1

Ownership: County, Fed Gov't, City, Corp or Co, Private, State Agency, Water Dist N

Use of water: (A) Air cond, (B) Bottling, (C) Comm, (D) Dewater, (E) Power, (F) Fire, (G) Dom, (H) Irr, (I) Med, (J) P S, (K) Rec, (L) Stock, (M) Insatit, (N) Unused, (O) Repressure, (P) Recharge, (Q) Desal-P S, (R) Desal-other, (S) Other P

Use of well: (A) Anode, (B) Drain, (C) Seismic, (D) Heat Res, (E) Obs, (F) Oil-gas, (G) Recharge, (H) Test, (I) Unused, (J) Withdraw, (K) Waste, (L) Destroyed W

DATA AVAILABLE: Well data Freq. W/L meas.: Field aquifer char.

Hyd. lab. data:

Qual. water data; type:

Freq. sampling: Pumpage inventory: yes no, period:

Aperture cards: yes

Log data: Elog 724 - 1248 D E

WELL-DESCRIPTION CARD

SAME AS ON MASTER CARD Depth well: 1248 ft 1190 Meas. rept E-log 4

Depth cased: (first perf.) ft 1124 Casing type: Iron; Diam. 2 1/2 in 8

Finish: (C) porous concrete, (F) gravel w. (perf.), (G) gravel w. (screen), (H) horiz. gallery, (I) open end, (J) perf., (K) screen, (L) sd. pt., (M) shored, (N) open hole, (O) other G

Method Drilled: (A) air rot, (B) bored, (C) cable, (D) dug, (E) hyd. rot., (F) jetted, (G) air percussion, (H) rotary, (I) reverse, (J) trenching, (K) driven, (L) wash, (M) other H

Date Drilled: 4/67 9.6.8 Pump intake setting: ft 30

Driller: Comans Oleg. Service

Lift (type): (A) air, (B) bucket, (C) cent., (D) jet, (E) multiple, (F) multiple, (G) none, (H) piston, (I) rot., (J) submerg, (K) turb., (L) other S Deep Shallow

Power (type): (A) diesel, (B) elec, (C) gas, (D) gasoline, (E) hand, (F) gas, (G) wind; H.P. 30 Trans. or meter no. 41

Descrip. MP 418 ft above 418 ft below LSD, Alt. MP 418

Alt. LSD: 416 Accuracy: (source) Alt. 8

Water Level: above MP; Ft below LSD 152 Accuracy: 157 ± 70 2

Date meas: 1.7.9 Yield: 80 gpm 175 Method determined 61

Drawdown: ft 60 Accuracy: 60 Pumping period: 60 hrs 60

QUALITY OF WATER DATA: Iron ppm 69 Sulfate ppm 70 Chloride ppm 71 Hard. ppm 72

Sp. Conduct K x 10⁶ 73 Temp. °F 74 Date sampled 77 79

Taste, color, etc. 77 79

Water level data
12/0/85
WL=166.94
10/189
WL=154
NE 1/4
NE 1/4
S9 7117E
11/25/89
WL=156.25

PUNCHED and VERIFIED
ROLLA COMPUTATION BRANCH

Well No. 30h
Turb

HYDROGEOLOGIC CARD

SAME AS ON MASTER CARD **Physiographic Province:** 03 **Section:** _____

Drainage Basin: D 13T **Subbasin:** _____

Topo of well site: (D) depression, stream channel, dunes, flat, hilltop, sink, swamp. (E) (F) (H) (K) (L) (M) (N) (O) (P) (S) (T) (U) (V) _____

MAJOR AQUIFER: _____ **system** _____ **series** TE **aquifer, formation, group** MW _____

Lithology: _____ **Origin:** S **Aquifer Thickness:** _____ ft

Length of well open to: _____ ft **Depth to top of:** _____ ft

MINOR AQUIFER: _____ **system** _____ **series** _____ **aquifer, formation, group** _____

Lithology: _____ **Origin:** _____ **Aquifer Thickness:** _____ ft

Length of well open to: _____ ft **Depth to top of:** _____ ft

Intervals Screened: _____

Depth to consolidated rock: _____ ft **Source of data:** _____

Depth to basement: _____ ft **Source of data:** _____

Surficial material: _____ **Infiltration characteristics:** _____

Coefficient Trans: _____ gpd/ft **Coefficient Storage:** _____

Coefficient Perm: _____ gpd/ft²; **Spec cap:** _____ gpm/ft; **Number of geologic cards:** _____

40 ft screen } 1124-1144
 4" screen } 1169-1189

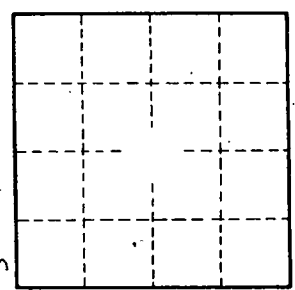

1020' of 8" casing

- 0-161 Grey Clay
- 165-237 F BKSD
- 280-310 Good sand
- 310-500 Clay chert
- 500-700 sd
- 700-820 fine clay
- 820-830 rk
- 830-850 Clay BKSD
- 850-880 rock & shell
- 880-920 green sd
- 920-1120 Gray clay
- 1120-1150 rock ledge
- 1150-1170 clay
- 1170-1200 sd
- 1200-1210 clay

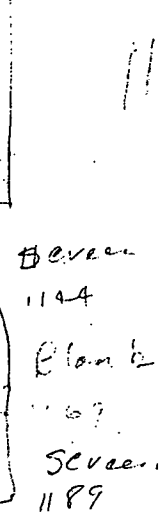

122' dd @ 175 gpm

#2.4 slot

Hay 13 west of Clifton

Date WL
 4/69 108 (D)

DEPARTMENT OF ENVIRONMENTAL QUALITY - OLWR
PUBLIC SUPPLY WELLS PROJECT

GPS LOG

JUL 29 04

USER NAME(S): Hardin/Phillips DATE: 4/24/97

UNIT DEQ #: _____ FILE #: A042416E

HEALTH DEPT. #: 620001-01 ✓ ELEV. 400' 418' ^{LWW} 7/29/04

USGS #: ~~_____~~ F8 ^{LWW} 7/29/04 OLWR #: 6W-01726 ^{LWW} 7/29/04

OWNER: CEC WA #1 QUAD: Hillsboro

LOCATION: NE/NE S 9 T 7N R 7E COUNTY: Scott

LOCATION DESCRIPTION: On Clifton-Hillsboro Rd at intersection
with Winstead Rd

CASING DIA: 8" PUMP TYPE & SIZE: Turbine; ? HP

GPS FIELD LOCATION: LAT. 32° 28.374' N LONG. 89° 34.767' W

GPS CORRECTED LOCATION: LAT. 32.47286441 LONG. 89.57943721

REMARKS: Right on top of well

*Triggered
LWW
10/19/04
32.47293
89.57947*

*9/13/00 WU/CBB
32.47292 89.57948*

Scott
 798
 9-10-68

WATER WELL DRILLERS LOG

Date: 9-10, 1968, Driller: Comans Valley Co. Scott
 (Name)

SW
 1726

		Description & Color of Materials Sand, Clay, Red Clay, Shell, etc.	Thick- ness Feet	Depth Feet
(1) Owner of Land: <u>C & E. Water Co.</u> (Name)				
<u>Clifton Miss.</u> (Address)		Clay heavy	0	160
(2) Location: <u>W. 1/4 NE 1/4</u> , Sec. <u>9</u> , T <u>7N</u> R <u>7E</u>		fine black sand	160	280
<u>1/4</u> miles <u>West</u> , of <u>Clifton</u> (distance) (direction) (Nearest Town)		Good sand	280	310
(3) Topography: <u>Flat</u> (Hilly) (Flat) (Level)		Clay & shell	310	500
(4) Purpose of Well: <u>Municipal</u> (Domestic Irrigation, Municipal, Industrial, Other)		Sand granite	500	700
		Gray Clay	700	920
		Rock	820	830
		Clay & Black sand	830	850
		Rock & shell	850	880
		Green sand	880	920
Information upon completion of well:		Gray Clay with	920	1020
(1) Diameter <u>8</u> inches.		Rock Ledges		
(2) Total Depth <u>1248</u> feet.		Sand	1020	1050
(3) Water Level <u>105</u> feet below top of ground.		Clay	1150	1120
(4) Cased to <u>1020</u> , Size <u>8 in.</u>		Sand	1170	1200
(5) Screen: Size <u>4 in.</u> , Length <u>50 ft.</u>		Clay	1200	1210
(6) Were any formations sealed against pollution?		Sand	1210	1248
	<input checked="" type="checkbox"/> yes, <input type="checkbox"/> no.			
If YES depth of formation <u>1120</u>				
Why: <u>Showered</u>				
Drillers Remarks:				

OCT 8 - 68

LESS

(Use Back Side)

Well No.

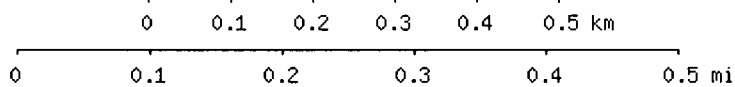
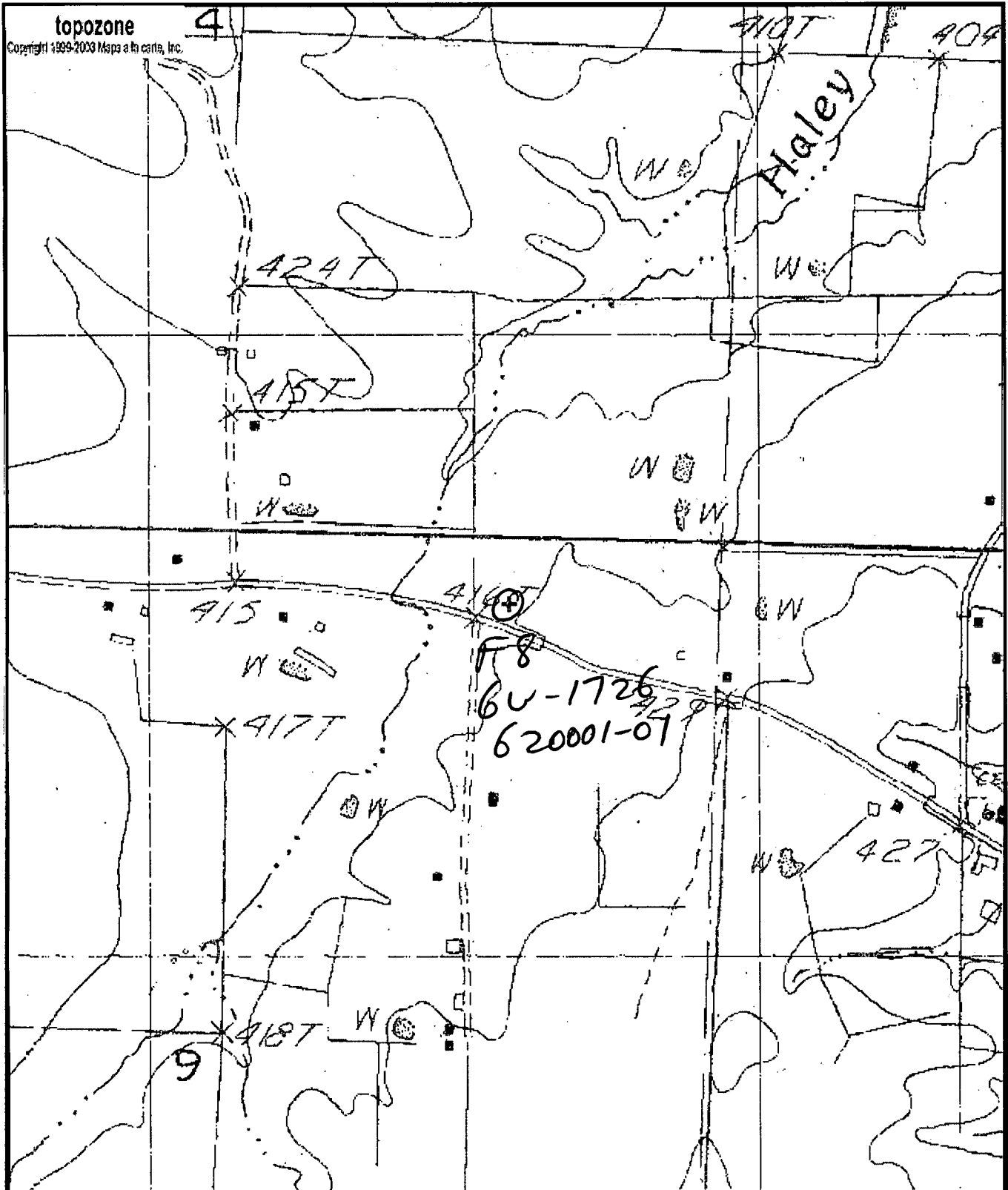

Map center is 32° 28' 22"N, 89° 34' 46"W (WGS84/NAD83)
Hillsboro quadrangle
 Projection is UTM Zone 16 NAD83 Datum

WW/CBB
9/13/00

M=0.961
 G=-1.386

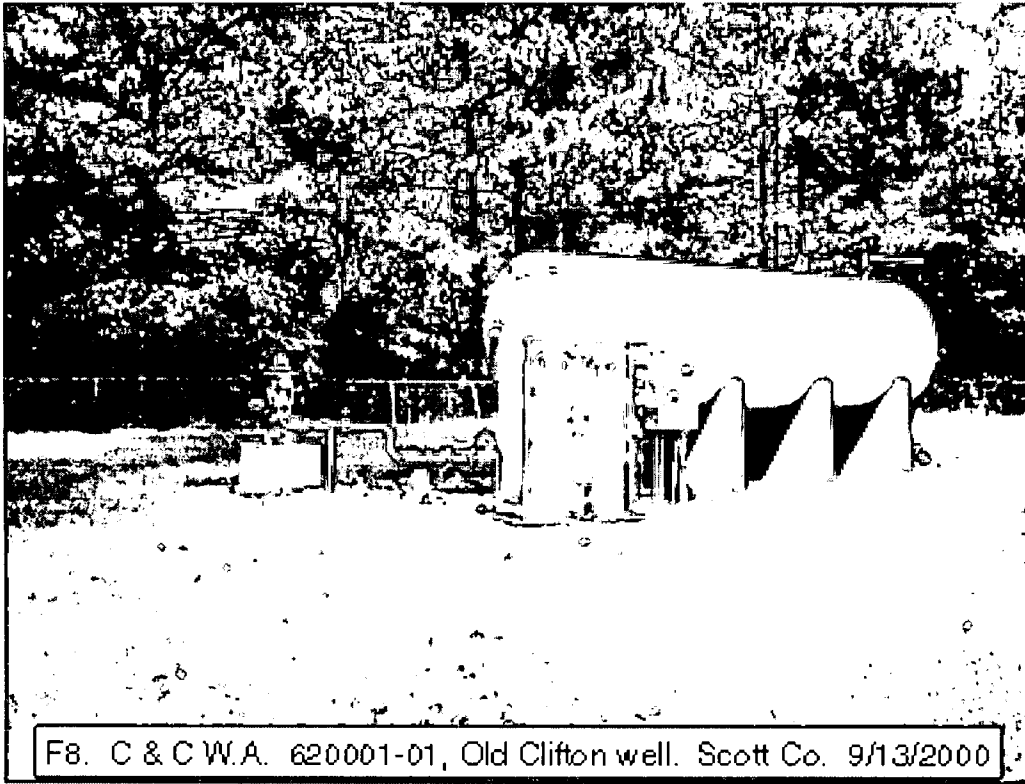

F8. C & C W.A. 620001-01, Old Clifton well. Scott Co. 9/13/2000

Department of Environmental Quality
Office of Land and Water Resources

Ground Water Permit
General Report

Permit Number: MS-GW-01726

County: SCOTT

Owner: C & C WATER ASSOCIATION, INC.

Aquifer: MUWX

USGS No: F0008

BOH No: 0620001-01

Location: NE 1/4 of the NE 1/4 of SEC 09 TWN 07N RNG 07E Lat: 322822 Long: 893446

Quad: HILLSBORO

District: N/A

Date Issued: 11-MAR-86

Date Renewed: 23-APR-96

Date Expired: 11-MAR-06

Applicant: C & C WATER ASSOCIATION, INC.

Owner: C & C WATER ASSOCIATION, INC.

Address 1: P. O. BOX 52

Address 1: P. O. BOX 52

Address 2: N/A

Address 2: N/A

Address 3: N/A

Address 3: N/A

City: HILLSBORO

City: HILLSBORO

State: MS Zip: 39087

State: MS Zip: 39087

Driller: COMANS WELL DRILLING

Maximum Rate: 200

Amount Withdrawn Acre feet: 22.4064

Amount Withdrawn Mgd: .02

Use

RURAL WATER
ASSOCIATION

Casing

Type: STEEL

Diameter: 8

Length: 1140

Screen

Type:

Diameter: 4

Length: 50