

PUNCHED

WELL SCHEDULE

U. S. DEPT. OF THE INTERIOR

GEOLOGICAL SURVEY

WATER RESOURCES DIVISION

MASTER CARD

Record by Witt Source of data ... Date 6/25/6 Map ...

State Miss County 218 (or town) London 41

Latitude: 32° 06' 40" N Longitude: 089° 47' 33" W Sequential number: 1

Lat-long accuracy: 30 T. 3 S. R. 5 W. Sec 9 SWNE SW

Local well number: X 01 4 A C 0 9 0 3 N O S E Other number: ... B & M

Local use: ... Owner or name: D. ALEXANDER Address: ...

Ownership: County, Fed Gov't, City, Corp or Co, Private, State Agency, Water Dist P

Use of water: (A) Air cond, Bottling, Comm, Dewater, Fower, Fire, Dom, Irr, Med, Ind, P S, Rec, (S) Stock, Instit, Unused, Repressure, Recharge, Desal-P S, Desal-other, Other H

Use of well: (A) Anode, Drain, Seismic, Heat Res, Obs, Oil-gas, Recharge, Test, Unused, Withdraw, Waste, Destroyed. W

DATA AVAILABLE: Well data ... Freq. W/L meas.: ... Field aquifer char. ...

Hyd. lab. data: ...

Qual. water data; type: ...

Freq. sampling: ... Pumpage inventory: ...

Aperture cards: ...

Log data: ...

WELL-DESCRIPTION CARD

SAME AS ON MASTER CARD Depth well: 45 ft Meas. 6

Depth cased: ... ft Casing type: ...; Diam. 6 in

Finish: porous concrete, gravel w. (perf.), gravel w. (screen), horz. gallery, open end, perf., screen, sd. pt., shored, open hole, other B

Method: (A) air bored, (B) cable, (C) dug, (D) hyd jetted, (H) air rot., (J) percussion, (P) rotary, (R) reverse trenching, (T) driven, (V) drive wash, (W) other B

Drilled: 956 Pump intake setting: ... ft

Driller: hand owner

Lift (type): (A) air, (B) bucket, (C) cent, jet, (J) multiple, (L) multiple, (M) multiple, (N) none, (P) piston, (R) rot, (S) submerg, (T) turb, other B Deep ... Shallow 40

Power (type): diesel, elec, gas, gasoline, hand, gas, wind; H.P. 1 Trans. or meter no. ...

Descrip. MP ... ft above LSD, Alt. MP ...

Alt. LSD: ... Accuracy: (source) ...

Water Level 30 ft above below MP; Ft below LSD 30 Accuracy: ...

Date meas: ... Yield: ... gpm Method determined ...

Drawdown: ... ft Accuracy: ... Pumping period ... hrs

QUALITY OF WATER DATA: Iron ... ppm Sulfate ... ppm Chloride ... ppm Hard. ... ppm

Sp. Conduct ... K x 10<sup>6</sup> Temp. ... °F Date sampled ...

Taste, color, etc. ...

Well No.

X17A

1950

Well No. X14

Latitude-longitude \_\_\_\_\_  
d m s d m s

HYDROGEOLOGIC CARD

**Physiographic Province:** 03 Section: \_\_\_\_\_

**Drainage Basin:** D **Subbasin:** 137

**Topo of well site:** (D) depression, stream channel, dunes, flat, hilltop, sink, swamp, (E) (F) (H) (K) (L) (P) (S) (T) (U) (V) offshore, pediment, hillside, terrace, undulating, valley flat \_\_\_\_\_

**MAJOR AQUIFER:** system \_\_\_\_\_ series TM aquifer, formation, group CA

**Lithology:** \_\_\_\_\_ **Origin:** 3 **Aquifer Thickness:** \_\_\_\_\_ ft

**Length of well open to:** \_\_\_\_\_ ft **Depth to top of:** \_\_\_\_\_ ft

**MINOR AQUIFER:** system \_\_\_\_\_ series \_\_\_\_\_ aquifer, formation, group \_\_\_\_\_

**Lithology:** \_\_\_\_\_ **Origin:** \_\_\_\_\_ **Aquifer Thickness:** \_\_\_\_\_ ft

**Length of well open to:** \_\_\_\_\_ ft **Depth to top of:** \_\_\_\_\_ ft

**Intervals Screened:** \_\_\_\_\_

**Depth to consolidated rock:** \_\_\_\_\_ ft **Source of data:** \_\_\_\_\_

**Depth to basement:** \_\_\_\_\_ ft **Source of data:** \_\_\_\_\_

**Surficial material:** \_\_\_\_\_ **Infiltration characteristics:** \_\_\_\_\_

**Coefficient Trans:** \_\_\_\_\_ gpd/ft **Coefficient Storage:** \_\_\_\_\_

**Coefficient Perm:** \_\_\_\_\_ gpd/ft<sup>2</sup> ; Spec cap: \_\_\_\_\_ gpm/ft; Number of geologic cards: \_\_\_\_\_

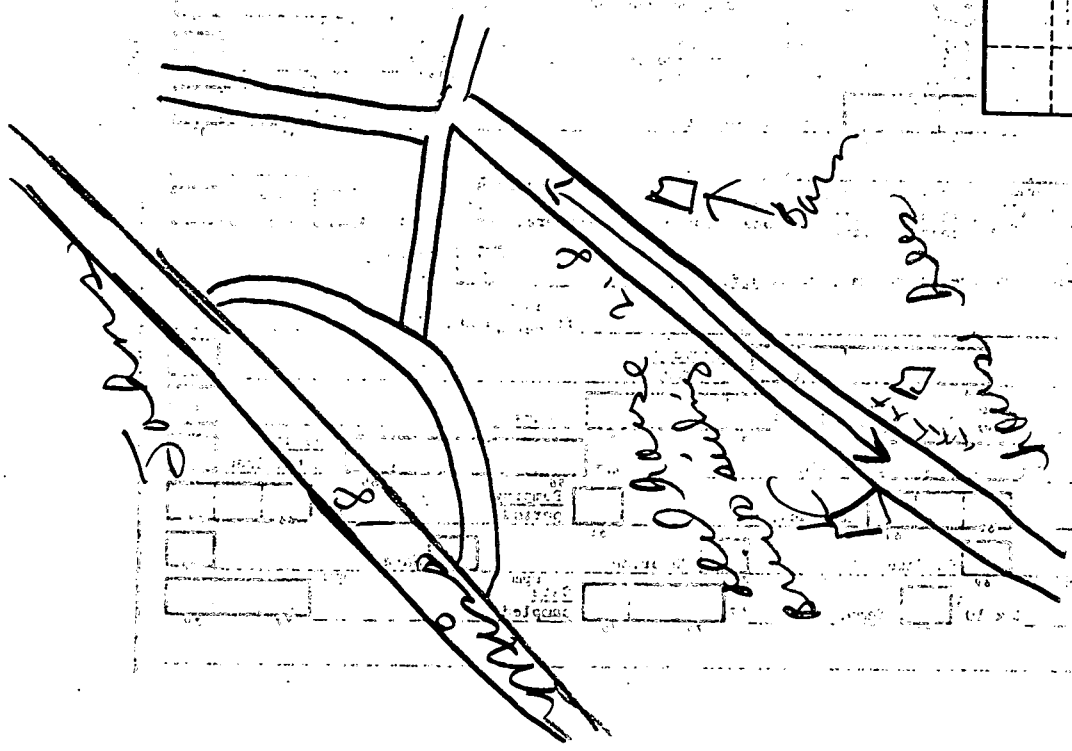
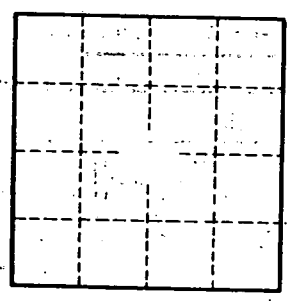

Well No. X14