

6/77 WTO

Recorded by WTO
Date 12/15/77

U.S. GEOLOGICAL SURVEY
WATER RESOURCES DIVISION
MISSISSIPPI DISTRICT
WELL RECORD

Well No. W 66
E-Log No. 443
County Rankin
Puckett Quad

GW01559 0610049-02

Site ID 320422089512601 R=0* T=A* 2=W*

GEN. SITE DATA

Data reliab. 3=C*U Report. agency 4=USGS* Dist. 6=28* 7=28* Co. 8=1,2,1*

Lat. Long. 9=320422* 10=0895126* Well No. 12=W066*

Location 13=SWNE S 26 T 03 N R 04 E* Alt. 16=428*

Hyd. Unit (OWDC) 20= Date 21=12/15/1977*

Well use 23=W* Water Use 24=P* Hole depth 27=1080* Well depth 28=1010*

WL 30=252* Date 31=02/01/1978* Source 33=D*

Status 273=Y* Project No. 5= WL=255.93 10/24/80

OWNER

R=158* T=A* Date 159#02/01/1978* Owner No. Well #2B

Owner 161=SOUTHEAST RANKIN WA* (Well #2 @ Site #2)

FIELD QW

R=192* T=A* Date 193# Temp. 196#00010* 197=

R=192* T=A* Date 193# Cond. 196#00095* 197=

R=192* T=A* Date 193# pH 196#00400* 197=

CONSTR.

R=58* T=A* 59#1* Date 60=02/01/1978* Remarks

Drlg. 63=0.53* Name T.M. Parks Method 65=H* Finish 66=G*

11/1/89 could get tape past 270'

CASING

R=76* T=A* 59#1*

Top csng. 77# 0* Bot. csng. 78=940* Diam. 79# 10*

R=76* T=A* 59#1*

Top csng 77# Bot. csng. 78= Diam. 79#

OPENINGS

R=82* T=A* 59#1* Top 83# 960* Bottom 84=1010*

Type 85=S* Diam. 87=6* Size 88=

R=82* T=A* 59#1* Top 83# Bottom 84=

Type 85= Diam. 87= Size 88=

YIELD

R=146* T=A* 147# 1* Q 150=200* Q/S 272=

134 flows 146 pumped

Lift type Intake Power type
 Date H.P.

R=198* T= A * Log 199# * Top 200= * Bot 201= *
 R=198* T= A * Log 199# * Top 200= * Bot 201= *
 R=189* T= A * E Log No. 190# * 191= M I S S D I S T *

R=114* T= A * Year 115# * Type 120= *

R=90* T= A * 256# 1 * Top 91= * Bot 92= *

Unit ID 93= * Name of Unit SPT on permit

R=90* T= A * 256# 1 * Top 91= * Bot 92= *

Unit ID 93= * Name of Unit

R=98* T= A * 99# 1 * Unit tested 100= * 103= *

R=105* T= A * 99# 1 * Test No. 106# *

107= * Transmissivity (gal/d)/ft

108= * Hydraul. cond. (gal/d)/ft²

110= * Storage coeff. Boundaries

R=121* T= * Yr Begin 122# *

Water Level Data Collection (1)

description of formations encountered	from	to
Top soil w/ sand streaks	0	80'
Sand - red	80	100'
Sand w/ clays + shales	100	200'
Clay	200	260'
Clay, sand + shales	260	408'
Clay w/ Gumbo	408	838'
Sand w/ shale + clays	838	980'
Good streaks broken w/ lignite + shale	980	1080'

CODED

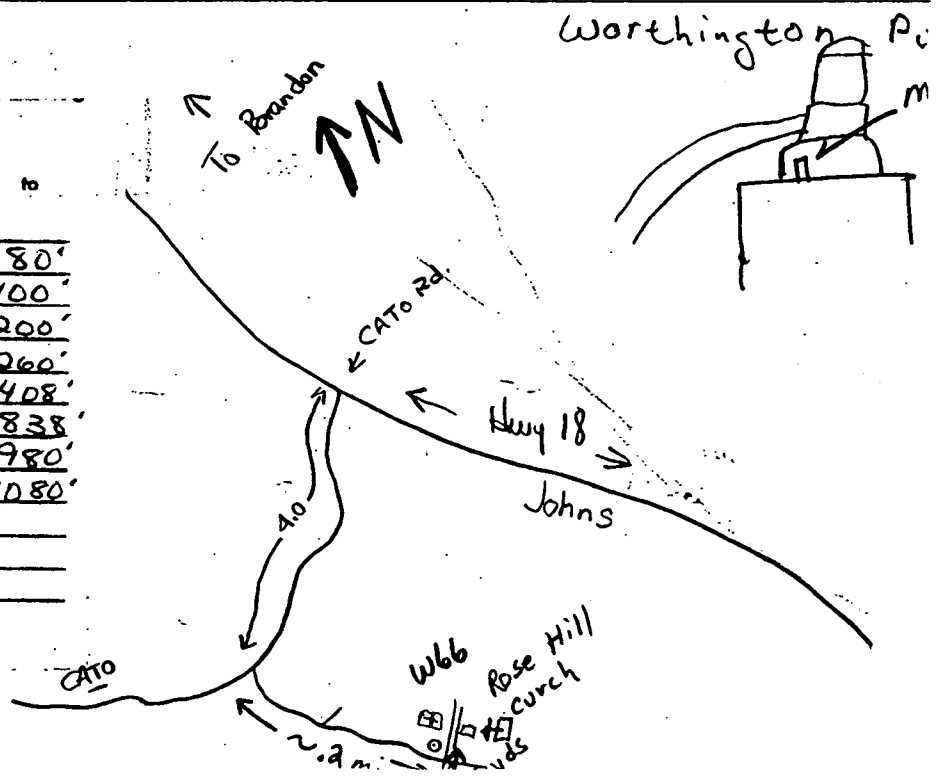

RANKIN
W66
2178
Elog 443

MISSISSIPPI
BOARD OF WATER COMMISSIONERS CODED
416 North State Street
Jackson, Mississippi 39201

WATER WELL DRILLERS LOG

February 1978 T.M. Parks Drilling Co. Rankin
date well completed firm name county well located

LANDOWNER:	description of formations encountered	from	to
Southeast Rankin Water Rankin County, MS (mailing address)	Top soil w/sand streaks Sand - red Sand w/clays + shales CLAY Clay, sand + shales Clay w/Gumbo Sand w/shale + clays Good streaks broken w/ lignite + shale	0 80 100 200 260 408 838 980	80' 100' 200' 260' 408' 838' 1080'
WELL LOCATION: sec. 26 T 3 N R 4 E S W 4 miles SOUTH of Cato (distance) (direction) (nearest town)	CODED		
WELL PURPOSE: MUNICIPAL (home, irrigation, municipal, industrial)			
WELL COMPLETION DATA:			
(1) diameter (inches) 10 3/4			
(2) total depth (feet) 1080'			
(3) static water level (feet) 252' below top of ground.			
(4) casing steel, 940' (material) (depth) 10 3/4 x 6 (size) if telescope see back.			
(5) screen 50' 960' (length) (depth to top) 6" stain less (size) (material) steel			
(6) pump 40 200' (HP) (yield gpm) 3Ø (type power)			
(7) electric log yes (yes or no) U.S. Geological Survey (organization running log)			
(8) how well bottom plugged SAW - both w/ B.P.V.			
DRILLERS REMARKS:			

RECEIVED
MAY 18 1978

MISS. BO. OF WATER COMM

(X)

If well telescopes please
sketch and show depths.

GROUND LEVEL

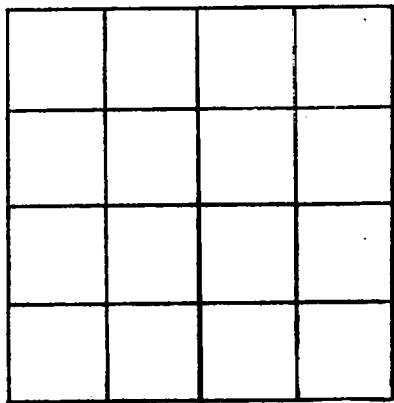

SECTION _____

Please indicate well location X.

ADDITIONAL INFORMATION

If more than one screen,
show locations of each on sketch.

DEPARTMENT OF ENVIRONMENTAL QUALITY - OLWR

PUBLIC SUPPLY WELLS PROJECT

GPS LOG

USER NAME(S): Hardin/ DATE: 7/31/96

UNIT DEQ #: _____ FILE #: A073119A

HEALTH DEPT. #: 610049--02 ELEV. 422'

USGS #: W66 OLWR #: GWO1559

OWNER: SE Rankin W.A. - Cato QUAD: Puckett

LOCATION: NW/NE S 26 T 3N R 4E COUNTY: Rankin

LOCATION DESCRIPTION: At elevated tank next to cemetery
on Rose Hill Rd.

CASING DIA: _____ PUMP TYPE & SIZE: Submersible

GPS FIELD LOCATION: LAT. 32°04.407'N LONG. 89°51.404'W

GPS CORRECTED LOCATION: LAT. 32.07303326 LONG. 89.85690940

REMARKS: Measured 35' east of well

