

STA ID 321649010103401

8/1/96

TRANSMITTED FOR ADP

U.S. GEOLOGICAL SURVEY  
WATER RESOURCES DIVISION  
MISSISSIPPI DISTRICT

Well No. K172  
E-Log No. 478  
County RANKIN  
229C JACKSON

Recorded by WTO

Date 12/5/78

WELL RECORD APR 1979

0610078-01 (?) may be K35

Site ID

3 2 1 6 4 9 0 9 1 0 1 0 3 4 0 1

R=0\*

T=A\*

2=W\*

Jackson Quad

Data reliab.

3=C \* C

Report. agency

4=USGS\*

Dist.

6=28\*

7=28\*

Co.

8=1 2 1 \*

Lat.

Long. /

9=3 2 1 6 4 9 \*

10=3 2 1 6 4 9 0 9 1 0 1 0 3 4 0 1 \*

Well No.

12=K 1 7 2 \*

Location

13=N W N W S 1 4 T 0 5 N R 0 1 E \*

Alt.

16=2 7 1 \*

Hyd. Unit (OWDC)

20=

Date

21=1 0 / 1 9 / 1 9 7 8 \*

Well use

23=W H \*

Water Use

24=H H \*

Hole depth

27=4 0 2 \*

Well depth

28=2 8 0 \*

WL

30=1 3 0 \*

26=

Date

31=1 0 / 1 9 / 1 9 7 8 \*

Source

33=D \*

260

Status

273 =

Project No.

5=

R=158\*

T=A\*

Date

159# 1 0 / 1 9 / 1 9 7 8 \*

Owner No.

Fred Harris Ownr  
Property

Owner

161=B I L L I P S S E R S T A \*

R=192\*

T=A\*

Date

193#

Temp.

196#00010\*

197=

R=192\*

T=A\*

Date

193#

Cond.

196#00095\*

197=

R=192\*

T=A\*

Date

193#

pH

196#00400\*

197=

R=58\*

T=A\*

59# 1\*

Date

60=1 0 / 1 9 / 1 9 7 8 \*

Remarks

Drlg.

63=2 8 2 \*

Name J. GUINN

Method

65=H \*

Finish

66=S \*

R=76\*

T=A\*

59# 1\*

Top csgn.

77# 0 \*

Bot. csgn.

78=2 4 0 \*

Diam.

79# 6 \*

R=76\*

T=A\*

59# 1\*

Top csgn

77#

Bot. csgn.

78=

Diam.

79#

R=82\*

T=A\*

59# 1\*

Top

83# 2 4 0 \*

Bottom

84=2 8 0 \*

Type

85=S \*

Diam.

87=4 \*

Size

88=

R=82\*

T=A\*

59# 1\*

Top

83#

Bottom

84=

Type

85=

Diam.

87=

Size

88=

CCKF

R=146\*

T=A\*

147# 1\*

Q

150=5 0 \*

Q/S

272=

134 flows 146 pumped

LIFT

R=42\* T= A \* Lift type 43# S\* Intake 44= \* Power type 45= E\*  
 Date 38= 10/19/1978\* H.P. 46= 5.\*

LOGS

R=198\* T= A \* Log 199# D\* Top 200= 0.\* Bot 201= 280.\*  
 R=198\* T= A \* Log 199# E\* Top 200= 10.\* Bot 201= 402.\*  
 R=189\* T= A \* E Log No. 190# 478\* 191= M I S S D I S T \*

ANAL.

R=114\* T= A \* Year 115# \* Type 120= \*

AQUIFERS

R=90\* T= A \* 256# 1 \* Top 91= 240.\* Bot 92= 280.\*  
 Unit ID 93= 12ACCKF\* Name of Unit \_\_\_\_\_  
 R=90\* T= A \* 256# 1 \* Top 91= \* Bot 92= \*  
 Unit ID 93= \* Name of Unit \_\_\_\_\_

HYDRAULICS

R=98\* T= A \* 99# 1 \* Unit tested 100= \* 103= \*  
 k=105\* T= A \* 99# 1 \* Test No. 106# \*  
 107= \* Transmissivity (gal/d)/ft \_\_\_\_\_  
 108= \* Hydraul. cond. (gal/d)/ft<sup>2</sup> \_\_\_\_\_  
 110= \* Storage coeff. Boundaries \_\_\_\_\_

R=121\* T= \* Yr Begin 122# \* Network 258= \*

Water Level Data Collection (1)

9/89

~~90.00  
 38.88  
 51.20  
 -1.45  
 49.75~~

description of formations encountered	from	to
yellow sand	0	40
sand & silt	40	240
sand	240	280

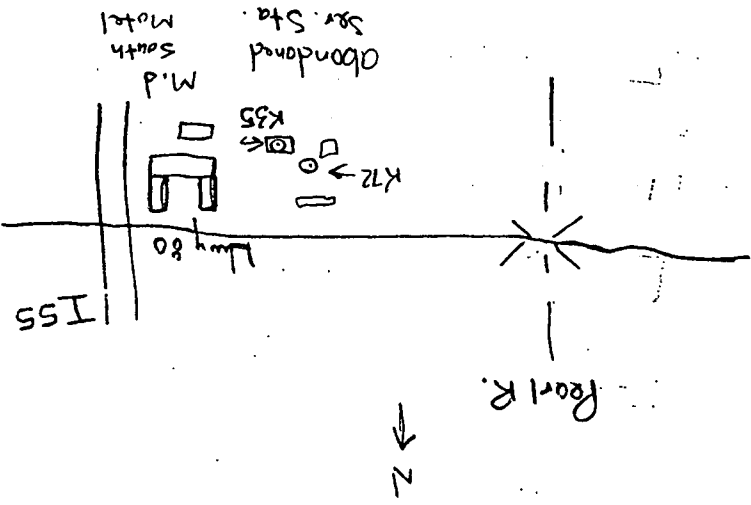

RANKIN  
K172  
10/19/78  
Firm # 478  
-10/19-1978

MISSISSIPPI  
BOARD OF WATER COMMISSIONERS  
416 North State Street  
Jackson, Mississippi 39201

CODED

WATER WELL DRILLERS LOG

date well completed 10/19/78 firm name Jack Quinn county well located Rankin

LANDOWNER:  
Billups Sr. Station  
(mailing address)

description of formations encountered	from	to
yellow sand	0	40
loam & shell sand	40	240
	240	280

WELL LOCATION:  
sec. 1405 N R 1 E  
1/2 miles Jackson  
(distance) (direction) (nearest town)

403' on Res. Log  
OK 19-1978  
JRC

WELL PURPOSE:  
(home, irrigation, municipal, industrial)

WELL COMPLETION DATA:  
(1) diameter (inches) 6 1/2"  
(2) total depth (feet) 405 ft  
(3) static water level (feet) 130 below top of ground  
(4) casing P.V.C. 40 240 ft. (material) (depth)  
4 in. if telescope see back. (size)  
(5) screen 40 ft. 220 ft. (length) (depth to top)  
4 in. P.V.C. (size) (material)  
(6) pump 5 20 gal. (HP) (yield gpm)  
Electric (type power)  
(7) electric log Yes (yes or no)  
M.S.D. (organization running log)  
(8) how well bottom plugged Back wash valve

CODED

RECEIVED

JAN 8 1978

DRILLERS REMARKS:

MISS. Bd. OF WATER COMM

If well telescopes please sketch and show depths.

CODED

GROUND LEVEL

Large grid area for sketching well telescopes and depths.

SECTION 14

Please indicate well location X.

ADDITIONAL INFORMATION

Series of horizontal lines for recording additional information.

If more than one screen, show locations of each on sketch.

DEPARTMENT OF ENVIRONMENTAL QUALITY - OLWR

PUBLIC SUPPLY WELLS PROJECT

GPS LOG

USER NAME(S): Phillips/Hardw DATE: 8/1/96

UNIT DEQ #: 610078-01? FILE #: A080115E

HEALTH DEPT. #: No tag - Well abandoned ELEV. 260'

USGS #: K172 (K35?) OLWR #: —

OWNER: Capital 66 QUAD: Jackson

LOCATION: NW/NW S 14 T 5N R 1E COUNTY: Rankin

LOCATION DESCRIPTION: just east of pink Health Studio

CASING DIA: \_\_\_\_\_ PUMP TYPE & SIZE: \_\_\_\_\_

GPS FIELD LOCATION: LAT. 32°16.860'N LONG. 90°10.497'W

GPS CORRECTED LOCATION: LAT. 32.28038389 LONG. 90.17522586

REMARKS: No pump, no tanks, looks like it has  
been gone a while - No gas station  
here anymore - now a health studio

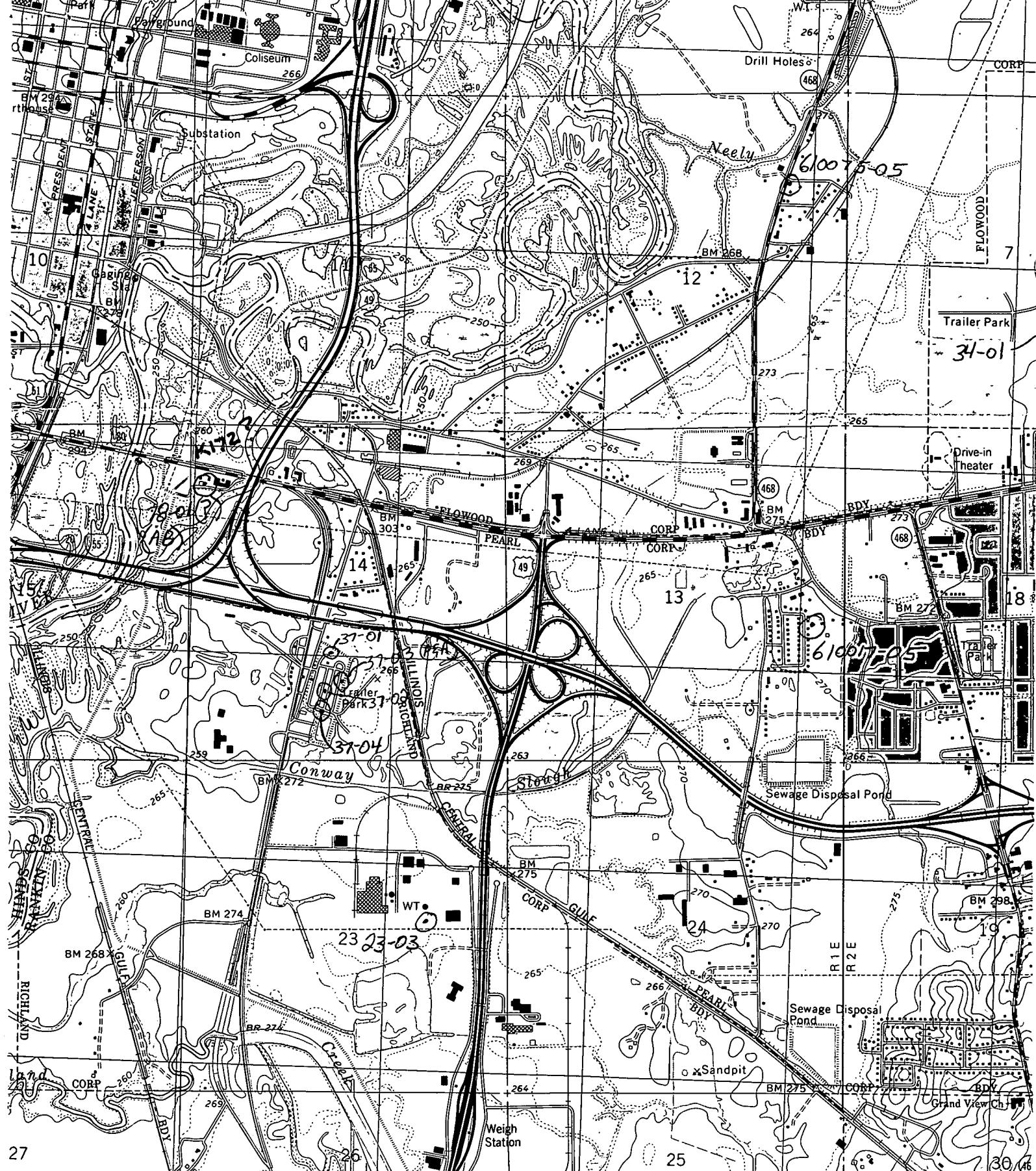

10' FOOT CONTOURS  
 DATUM OF 1929

MISS.

10 30 4000 5000 6000 7000 FEET  
 1 KILOMETER

ROAD CLASSIFICATION  
 Primary highway, hard surface  
 Secondary highway, hard surface  
 Light-duty improved surface  
 Unimproved

INTERIOR—GEOLOGICAL SURVEY, RESTON, 770000ME  
 INTERSTATE ROUTE U.S. ROUTE

FLORENCE 7 MI. MENDENHALL 27 MI.