

WELL SCHEDULE

U. S. DEPT. OF THE INTERIOR

GEOLOGICAL SURVEY

WATER RESOURCES DIVISION

GW14115 0610023-02

PUNCHED MAR 18 1974

MASTER CARD

Record by WTO Source of data Obs driller Date 12-1-71 Map FLORENCE QUAD

State MISS County 28 (or town) RANKIN 61

Latitude: 32^{deg} 13^{min} 39^{sec} N Longitude: 090^{degrees} 09^{min} 46^{sec} Sequential number: 1

Lat-long accuracy: 2⁰ 5⁰ 1⁰ 35 NE SW SE NW SE

Local well number: K1490D3504NO1E Other number: _____

Local use: 00235 672 16 Owner or name: _____

Owner or name: RICHLAND Address: City of Richland

Ownership: County, Fed Gov't, City, Corp or Co, Private, State Agency, Water Dist N

Use of water: (A) Air cond, Bottling, Comm, Dewater, Power, Fire, Dom, Irr, Med, Ind, P S, Rec, (S) Stock, Instat, Unused, Reppure, Recharge, Desal-P S, Desal-other, Other MU P

Use of well: (A) Anode, Drain, Seismic, Heat Res, Obs, Oil-gas, Recharge, Test, Unused, Withdraw, Waste, Destroyed. W

DATA AVAILABLE: Well data Freq. W/L meas Field aquifer char

Hyd. lab. data: _____

Qual. water data; type: _____

Freq. sampling: _____ Pumpage inventory: _____

Aperture cards: _____

Log data: Elog 107-971 SPRT D:E

WELL-DESCRIPTION CARD

SAME AS ON MASTER CARD Depth well: 767 ft Meas. rept 3

Depth cased (first perf.): 707 ft Casing type: _____; Diam. 12 X 6 in accuracy _____

Finish: porous concrete, gravel w. (perfor.), (screen), (horiz. gallery), (open end), other G

Method: (A) air bored, (B) cable, (C) dug, (D) hyd jetted, (E) air rot., (F) reverse, (G) trenching, (H) driven, (I) drive wash, other H

Date Drilled: 12-1-71 971 Pump intake setting: _____ ft

Driller: Robert RATLIFF

Lift (type): (A) air, (B) bucket, (C) cent., (D) jet, (E) multiple, (F) multiple, (G) nose, (H) piston, (I) rot., (J) submerg, (K) turb, other T Deep Shallow

Power (type): (A) diesel, (B) elec, (C) gas, (D) gasoline, (E) hand, (F) gas, (G) wind; H.P. 40 Trans. or meter no.

Descrip. MP 268 ft above LSD, Alt. MP 70

Alt. LSD: 290 Accuracy: 154

Water Level: _____ ft above MP; _____ ft below LSD Accuracy: _____

Date meas: 12/1/71 Yield: 532 m test 350 gpm Method determined _____

Drawdown: _____ ft Accuracy: _____ Pumping period: _____ hrs

QUALITY OF WATER DATA: Iron _____ ppm Sulfate _____ ppm Chloride _____ ppm Hard: _____ ppm

Sp. Conduct _____ K x 10⁶ Temp. _____ °F Date sampled _____

Taste, color, etc. _____

WL=182' 8/14/84

280

60#145

532' @

Well No. _____

Latitude-longitude _____

PUNCHED

HYDROGEOLOGIC CARD

SAME AS ON MASTER CARD Physiographic Province: **03** Section: _____

Drainage Basin: **D** Subbasin: **137**

Topo of well site: (D) depression, stream channel, dunes, flat, hilltop, sink, swamp, (P) offshore, pediment, hillside, terrace, undulating, valley flat

MAJOR AQUIFER: system _____ series **TE** aquifer, formation, group **SPRT SS**

Lithology: **US** Origin: **2** Aquifer Thickness: **150** ft
Length of well open to: **150** ft Depth to top of: **60** ft

MINOR AQUIFER: system _____ series _____ aquifer, formation, group _____

Lithology: _____ Origin: _____ Aquifer Thickness: _____ ft
Length of well open to: _____ ft Depth to top of: _____ ft

Intervals Screened: _____

Depth to consolidated rock: _____ ft Source of data: _____

Depth to basement: _____ ft Source of data: _____

Surficial material: _____ Infiltration characteristics: _____

Coefficient Trans: **58,000** gpd/ft. **55.3** Coefficient Storage: _____

Coefficient Perm: **370** gpd/ft²; Spec cap: **16** gpm/ft; Number of geologic cards: _____

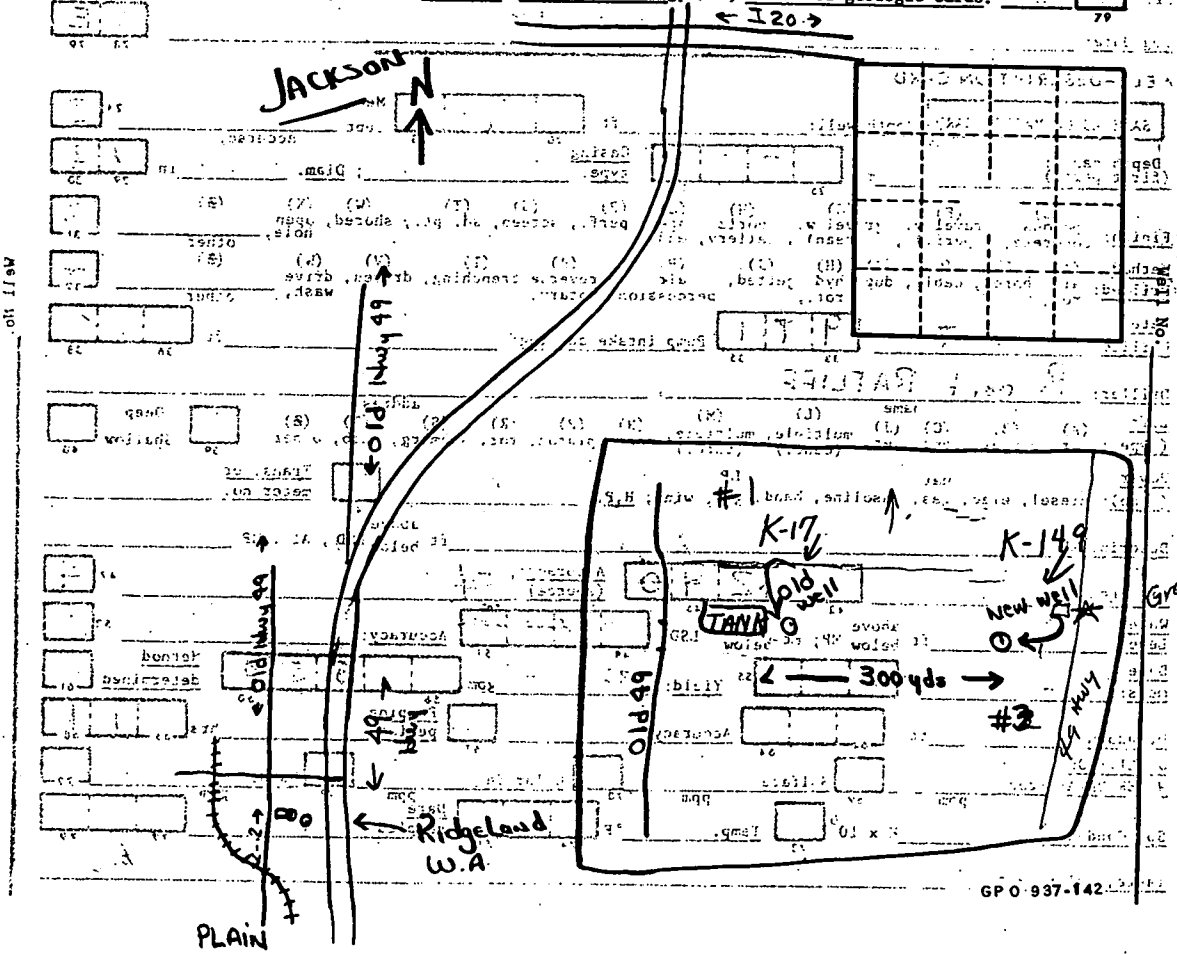

RANKIN
K149
12-1-71

ELOG #351

MISSISSIPPI
 BOARD OF WATER COMMISSIONERS
 416 North State Street
 Jackson, Mississippi 39201
FEB 25 1972

WATER WELL DRILLERS LOG *coded*

1 Apr 12/1 19*72* **ROBERT E RATLIFF Co Inc** **RANKIN**
 date well completed firm name county well located

LANDOWNER: <u>Town of</u>	description of formations encountered	from	to
<u>PLAIN [Richland WTR Co</u>	Top Soil	0	4
<u>PLAIN Miss.</u>	SAND	4	86
(mailing address)	Gumbo	86	268
WELL LOCATION:	Sandy Gumbo	268	330
sec. <u>35</u> T <u>S</u> N R <u>1</u> E	Gumbo	330	421
<u>0</u> miles of <u>PLAIN</u>	SANDY SHELL	421	482
(distance) (direction) (nearest town)	Sand	482	513
WELL PURPOSE: <u>municipal</u>	Sandy shell	513	605
(home, irrigation, municipal, industrial)	Shell	605	727
WELL COMPLETION DATA:	SAND	727	758
(1) diameter (inches) <u>13 3/8"</u>	SAND + SHELL	758	880
(2) total depth (feet) <u>770'</u>	SHELL	880	940
(3) static water level (feet) <u>105</u> below top of ground	SANDY SHELL	940	1001
(4) casing <u>Coated with Alcaite</u> <u>705'</u> (material) (depth)			
<u>13 3/8 x 6</u> (size) if telescope see back.			
(5) screen <u>60</u> <u>707'</u> (length) (depth to top)			
<u>6"</u> <u>S.S.S.</u> (size) (material)			
(6) pump <u>40</u> <u>350</u> (HP) (yield gpm)			
<u>Electric</u> (type power)			
(7) electric log <u>YES</u> (yes or no)			
<u>Ms STATE</u> (organization running log)			
(8) how well bottom plugged <u>BPU</u>			
DRILLERS REMARKS:			

If well telescopes please sketch and show depths.

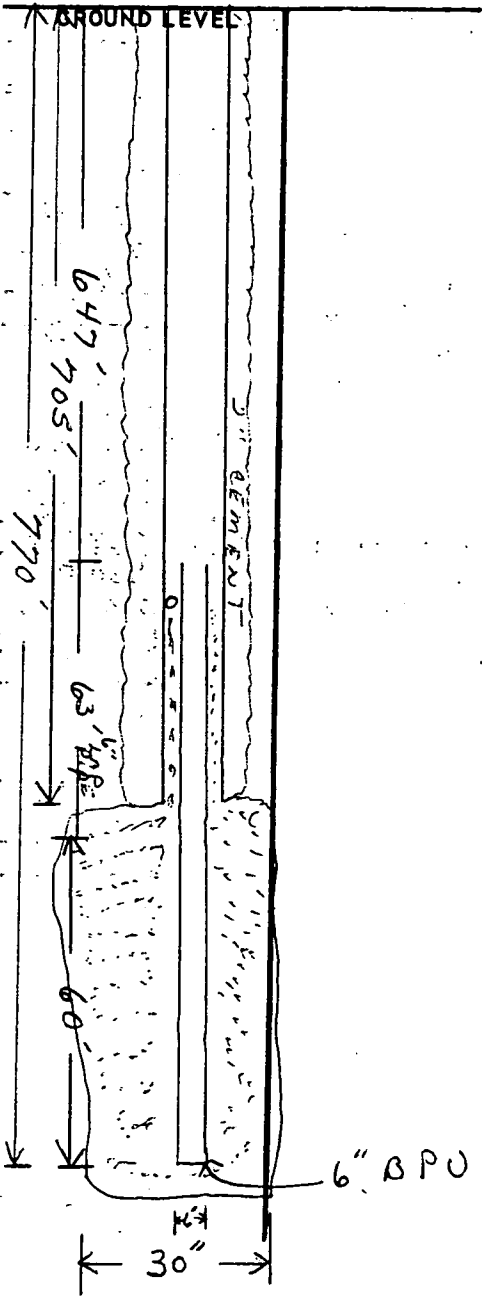

		35	
		X	

SECTION 35

Please indicate well location X.

ADDITIONAL INFORMATION

If more than one screen, show locations of each on sketch.

DEPARTMENT OF ENVIRONMENTAL QUALITY - OLWR

PUBLIC SUPPLY WELLS PROJECT

GPS LOG

USER NAME(S): Phillips/Hardin DATE: 7/3/96

UNIT DEQ #: _____ FILE #: A070319B

HEALTH DEPT. #: 610023-02 ELEV. 268'

USGS #: K149 OLWR #: GW14115

OWNER: City of Richland QUAD: Florence

LOCATION: SE/SE S 35 T 5N R 1E COUNTY: Rankin

LOCATION DESCRIPTION: At end of Reno St.

CASING DIA: _____ PUMP TYPE & SIZE: Turbine/100 HP

GPS FIELD LOCATION: LAT. 32°13.685'N LONG. 90°09.758'W

GPS CORRECTED LOCATION: LAT. 32.22825328 LONG. 90.16330253

REMARKS: Measured 50' NE of well

YAZOO CITY 49 MI.
2 MI. TO U.S. 80

