

No driller's log
2498

7/21/96

OCT 31 1975

WRD Exp. (GW)
April 1966

GW01302
0610017-01

Well No. K119
E-log # 373

WELL SCHEDULE

PUNCHED

U. S. DEPT. OF THE INTERIOR GEOLOGICAL SURVEY WATER RESOURCES DIVISION

Les
JAN 2 1974

MASTER CARD

C3=C, C5=SPRT

Record by Joe RN Source of data Layne Central Date 4/1/73 Map Jackson SE

State 5 County 28 (or town) Rankin 6 1

Latitude: 32^{deg} 15^{min} 18^{sec} N Longitude: 09^{degrees} 07^{min} 17^{sec} W Sequential number: 1

Lat-long accuracy: 2⁰ T. 5 S. R. 2 W. Sec 20 SE SE SW

Local well number: K119DC2005N02E Other number: B & H

Local use: 064 768 17 Owner or name: Metropolitan Water

Owner or name: Metropolitan Water Co. Address: City of Pearl

Ownership: County, Fed Gov't, City, Corp or Co, Private, State Agency, Water Dist N

Use of water: Air cond, Bottling, Comm, Dewater, Power, Fire, Dom, Irr, Med, Ind, P S, Rec, Stock, Instit, Unused, Repressure, Recharge, Desal-P S, Desal-other, Other MU

Use of well: Anode, Drain, Seismic, Heat Res, Obs, Oil-gas, Recharge, Test, Unused, Withdraw, Waste, Destroyed U

DATA AVAILABLE: Well data Freq. W/L meas.: Field aquifer char.

Hyd. lab. data:

Qual. water data: type: MSBH, Barrow-Agee, & Orlando Labs

Freq. sampling: Pumpage inventory: no period:

Aperture cards: yes

Log data: SPRT

WELL-DESCRIPTION CARD

SAME AS ON MASTER CARD Depth well: 984 ft Meas. rept 3

Depth cased: (first perf.) 924 ft Casing type: Steel Diam: 24 x 16 x 8 in

Finish: porous concrete, gravel w. (perf.), gravel w. (screen), horiz. open end, other G

Method: Drilled: air bored, cable, dug, hyd jetted, percussion, rotary, reverse trenching, driven, drive wash, other H

Date Drilled: 5/17 968 Pump intake setting: ft 36 38

Driller: Layne Central Co

Lift (type): (A) air, bucket, cent, jet, (B) multiple, (C) multiple, (D) none, piston, rot, submerg, turb, other T Deep Shallow

Power (type): diesel, elec, gas, gasoline, hand, gas, wind; H.P. 125 Trans. or meter no. W

Descrip. MP Breather m side of pump 3.0 ft above below LSD, Alt. MP 41

Alt. LSD: 322 300 Accuracy: (source) 320

Water Level 199.90 ft above below MP; Ft above below LSD 197 Accuracy: 52 D

Date meas: 4/1/73 473 Yield: @75 gpm 668 Method determined 61

Drawdown: ft 39 Accuracy: Pumping period hrs 23

QUALITY OF WATER DATA: Iron ppm 3 Sulfate ppm 70 Chloride ppm 71 Hard. ppm 72

Sp. Conduct 370 K x 10 3 Temp. 74 76 Date sampled 473 79

Taste, color, etc.

10/22/80
212-26
10-25/84
WL-219.40
WL-235.42
3/1/95

PUNCHED and VERIFIED
ROLLA COMPUTATION BRANCH
Old Whitefield well

Well No. K119

Well No. K119

Latitude-longitude _____
d m s d m s

HYDROGEOLOGIC CARD

SAME AS ON MASTER CARD Physiographic Province: _____ **03** Section: _____

D Drainage Basin: _____ **13T** Subbasin: _____

Topo of well site: (D) depression, stream channel, dunes, flat, hilltop, sink, swamp, (E) (F) (R) (K) (L) (O) (P) (S) (T) (U) (V) offshore, pediment, hillside, terrace, undulating, valley flat _____

MAJOR AQUIFER: _____ system _____ series **TE** _____ aquifer, formation, group **SPRT** _____ **SS**

Lithology: _____ **US** Origin: _____ **2** Aquifer Thickness: _____ ft

100 Length of well open to: _____ ft **60** Depth to top of: _____ ft **850**

MINOR AQUIFER: _____ system _____ series _____ aquifer, formation, group _____

Lithology: _____ Origin: _____ Aquifer Thickness: _____ ft

Length of well open to: _____ ft Depth to top of: _____ ft

Intervals Screened: _____

Depth to consolidated rock: _____ ft Source of data: _____

Depth to basement: _____ ft Source of data: _____

Surficial material: _____ Infiltration characteristics: _____

Coefficient Trans: **71,000** gpd/ft **713** Coefficient Storage: _____

Coefficient Perm: **710** gpd/ft²; Spec cap: **17** gpm/ft; Number of geologic cards: _____

WL 171 5768 1974/73 ZIS. 6/79

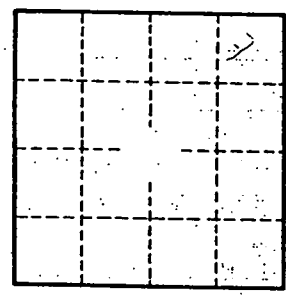
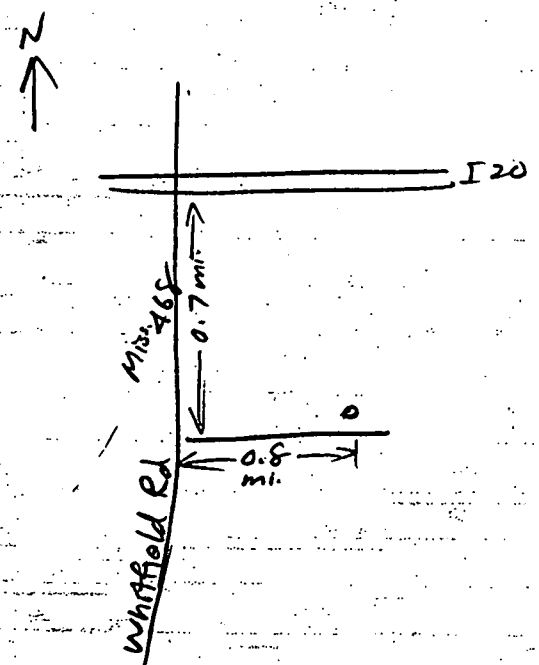

Well No. K119

SPRINT ZONE

DEPARTMENT OF ENVIRONMENTAL QUALITY - OLWR

PUBLIC SUPPLY WELLS PROJECT

GPS LOG

USER NAME(S): Phillips/Hardin DATE: 7/2/96

UNIT DEQ #: _____ FILE #: 6070215C

HEALTH DEPT. #: 610017-01 ELEV. @ 322'

USGS #: K119 OLWR #: GW01302

OWNER: City of Pearl QUAD: Jackson SE

LOCATION: SE/SW S 20 T 5N R 2E COUNTY: Rankin

LOCATION DESCRIPTION: On Old Whitfield Rd just past
intersection with Thompson Rd.

CASING DIA: _____ PUMP TYPE & SIZE: Turbine/125 HP

GPS FIELD LOCATION: LAT. 32° 15' 15.3" N LONG. 90° 07' 06.6" W

GPS CORRECTED LOCATION: LAT. 32.25421337 LONG. 90.11882227

REMARKS: Measured 50' south of well.

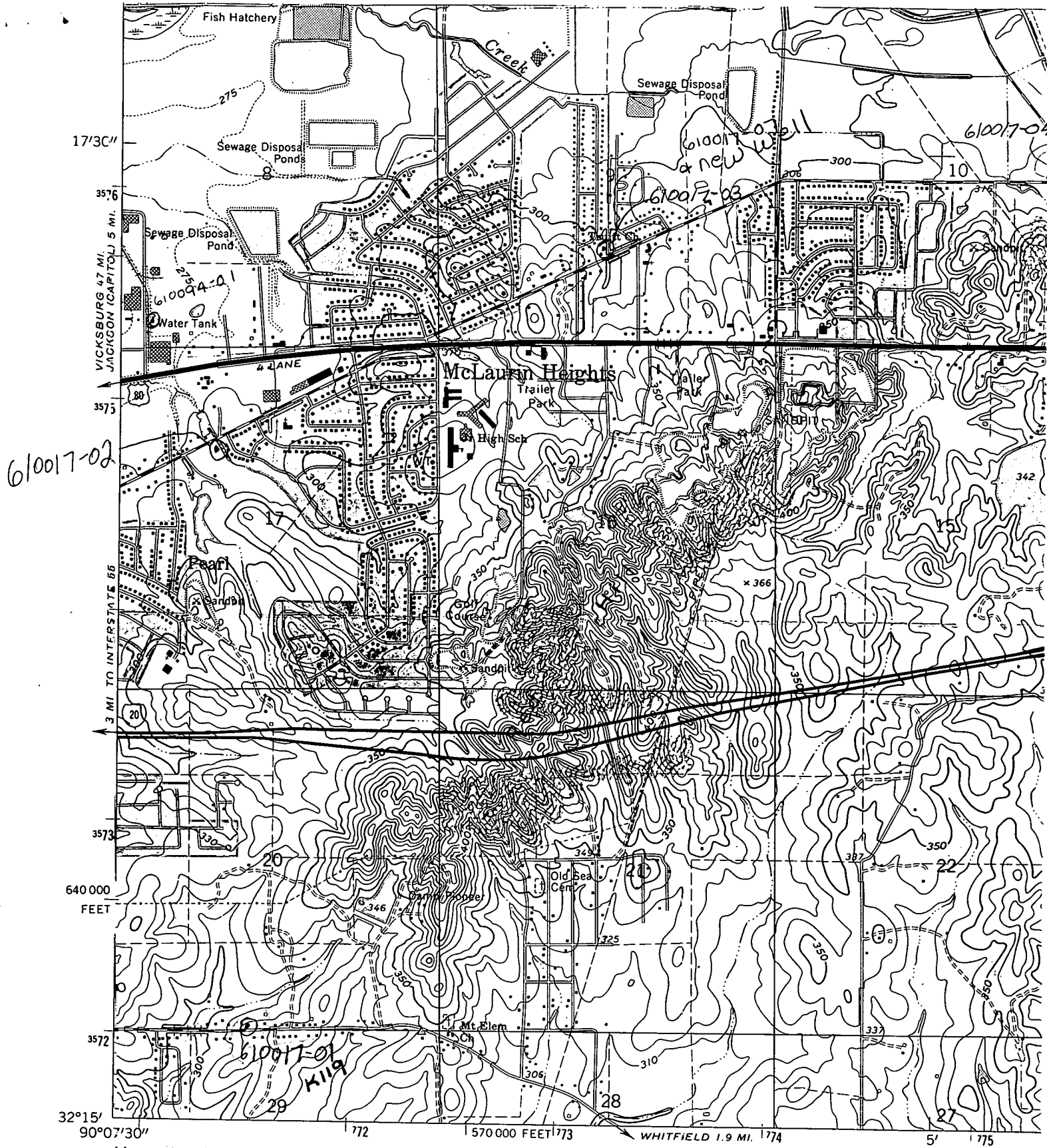

Mapped, edited, and published by the Geological Survey

Control by USGS and USC&GS

Topography by photogrammetric methods from aerial photographs taken 1960. Field checked 1963

Polyconic projection. 1927 North American datum
 10,000-foot grid based on Mississippi coordinate system, west zone
 1000-meter Universal Transverse Mercator grid ticks, zone 15, shown in blue

Fine red dashed lines indicate selected fence and field lines where generally visible on aerial photographs. This information is unchecked

Revisions shown in purple compiled from aerial photographs taken 1971. This information not field checked

(FLORENCE)
 2948 II NW

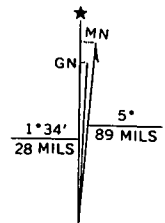

UTM GRID AND 1971 MAGNETIC NORTH DECLINATION AT CENTER OF SHEET