

GW01303

290

7/2/96

OCT 31 1975

WRD Exp. (GW) 0610017-04  
April 1966

Well No.

K95

WELL SCHEDULE

E-103372

PUNCHED

U. S. DEPT. OF THE INTERIOR

GEOLOGICAL SURVEY

WATER RESOURCES DIVISION

MASTER CARD

Record by C. Jessup Source of data dr. record MBWC Date 4/11/73 Map JACKSON SE 2790

State 8 28 County Rankin (or town) 61

Latitude: 32 17 28 N Longitude: 09 00 45 W Sequential number: 1

Lat-long accuracy: 2 T. 5 S. R. 2 W. Sec. 10 SW. SE. NE

Local well number: K095 CA1005N02E Other number: B & H

Local use: 064 Owner or name: metropolitan water assoc.

Owner or name: PEARL WATER CO. Address: old Brandon Rd. Jackson, Miss

Ownership: County, Fed Gov't, City, Corp or Co, Private, State Agency, Water Dist City of Pearl

Use of water: (A) Air cond, Bottling, Comm, Dewater, Power, Fire, Dom, Irr, Med, Ind, P S, Rec, (S) Stock, Instit, Unused, Repressure, Recharge, Desal-P S, Desal-other, Other MU

Use of well: (A) Anode, Drain, Seismic, Heat Res, Obs, Oil-gas, Recharge, Test, Unused, Withdraw, Waste, Destroyed W

DATA AVAILABLE: Well data  Freq. W/L meas.:  Field aquifer char.

Hyd. lab. data:

Qual. water data; type: MSBH, Barrow-Azee, + Orlando Labs

Freq. sampling:  Pumpage inventory: no; period:

Aperture cards:

Log data: Sch log State has SPRT DE

WELL-DESCRIPTION CARD

SAME AS ON MASTER CARD Depth well: TD 1150' ft 1143 Meas. accuracy 3

Depth cased: 1093 ft Casing type: Steel Diam. 16 in

Finish: (C) porous concrete, (F) gravel w. concrete, (G) gravel w. (screen), (H) horiz. gallery, (I) open end, (J) other, (K) perf., (L) screen, (M) sd. pt., (N) shored, (O) open hole, (P) other

Method Drilled: (A) air rot, (B) bored, (C) cable, (D) dug, (E) hyd jetted, (F) air percussion, (G) rotary, (H) reverse, (I) trenching, (J) driven, (K) wash, (L) other

Date Drilled: 4-3-68 9-6-8 Pump intake setting: 3.5 ft

Driller: Layne Central Co.

Lift (type): (A) air, (B) bucket, (C) cent, (D) jet, (E) multiple, (F) multiple, (G) nose, (H) piston, (I) rot, (J) submerg, (K) turb, (L) other

Power (type): (A) diesel, (B) elec, (C) gas, (D) gasoline, (E) hand, (F) gas, (G) wind, (H) H.P., (I) LP, (J) Trans. or meter no.

Descrip. MP: Breather hole in E side pump base 3.5 ft above LSD. Alt. MP 323'

Alt. LSD: 323' 320' accuracy: (source) 4

Water Level: 204.02 ft above MP; 201 ft below LSD accuracy: D

Date meas: 4/12/72 Yield: 400 904 gpm Method determined: 662

Drawdown: 3.6 ft Accuracy: 2.5 hr

QUALITY OF WATER DATA: Iron 360 ppm Sulfate 3 ppm Chloride 290 ppm Hard. 473 ppm

Sp. Conduct 360 K x 10<sup>6</sup> Temp. 73 °F Date sampled 4-7-73

Taste, color, etc. H<sub>2</sub>S Temp. 3 1/2 °C 5/20/68

JAN 2 1974

PEARL

3/8/95  
WL-250.

PUNCHED AND VERIFIED  
ROLLA COMPUTATION BRANCH

Well No. K95

Well No. K95

Latitude-longitude \_\_\_\_\_ N  
S  
d m s d m s

HYDROGEOLOGIC CARD

SAME AS ON MASTER CARD Physiographic Province: \_\_\_\_\_ Section: 03

Drainage Basin: D Subbasin: 13T

Topo of well site: (D) depression, stream channel, dunes, flat, hilltop, sink, swamp, (E) offshore, pediment, hillside, terrace, undulating, valley flat

MAJOR AQUIFER: system \_\_\_\_\_ series T.E aquifer, formation, group SPRT S.S

Lithology: V.S Origin: 2 Aquifer Thickness: \_\_\_\_\_ ft

Length of well open to: 95 ft Depth to top of: 50 ft 955 ft

MINOR AQUIFER: system \_\_\_\_\_ series \_\_\_\_\_ aquifer, formation, group \_\_\_\_\_

Lithology: \_\_\_\_\_ Origin: \_\_\_\_\_ Aquifer Thickness: \_\_\_\_\_ ft

Length of well open to: \_\_\_\_\_ ft Depth to top of: \_\_\_\_\_ ft

Intervals Screened: 1093-1143' 8" SS #7

Depth to consolidated rock: \_\_\_\_\_ ft Source of data: \_\_\_\_\_

Depth to basement: \_\_\_\_\_ ft Source of data: \_\_\_\_\_

Surficial material: \_\_\_\_\_ Infiltration characteristics: \_\_\_\_\_

Coefficient Trans: 64,000 gpd/ft 643 Coefficient Storage: \_\_\_\_\_

Coefficient Perm: 670 gpd/ft<sup>2</sup>; Spec cap: 16 gpm/ft; Number of geologic cards: \_\_\_\_\_

WL 167-5/68

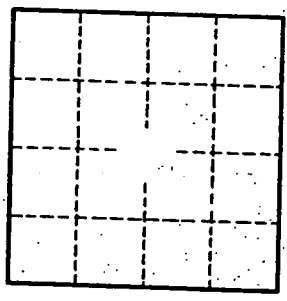
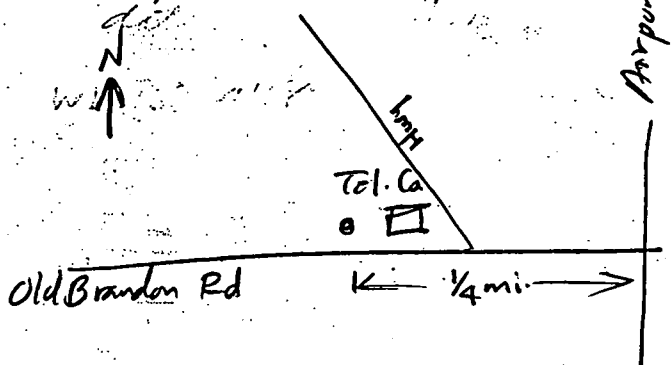

Telephone well

- Wh. 167. 5/68
- WL = 201. /12
- WL = 201. 4/73
- WL = 205. 6/79
- WL = 207.4 10/22/80
- = 224.90 10/24/83

Well No. K95

Rankin  
K 95  
4-3-68  
Schlumberger  
4-3- 1968  
 date well completed

MISSISSIPPI  
 BOARD OF WATER COMMISSIONERS  
 416 North State Street  
 Jackson, Mississippi

APR 15 1968  
 BOARD OF  
 WATER COMMISSIONERS

**CODED**

WATER WELL DRILLERS LOG  
Leiper Central Co.  
 firm name  
Rankin  
 county well located

LANDOWNER:  
Metropolitan Water, Inc  
Jackson, Miss.  
 (mailing address)

WELL LOCATION: old Brunson Rd.  
sec. 10 T 5 N R 2 E well # EA  
 (distance) miles \_\_\_\_\_ of \_\_\_\_\_ (direction) of \_\_\_\_\_ (nearest town)

WELL PURPOSE: Domestic  
 (home, irrigation, municipal, industrial)

WELL COMPLETION DATA:  
 (1) diameter (inches) 16"  
 (2) total depth (feet) 1150'  
 (3) static water level (feet) 168' below top of ground.  
 (4) casing Steel 1088'  
 (material) (depth)  
16" if telescope see back.  
 (size)  
 (5) screen 50' 1093'  
 (length) (depth to top)  
8" Stainless Steel  
 (size) (material)  
 (6) pump \_\_\_\_\_ (HP) \_\_\_\_\_ (yield gpm)  
Electric  
 (type power)  
 (7) electric log Yes  
 (yes or no)  
Schlumberger  
 (organization running log)  
 (8) how well bottom plugged valve  
cement

description of formations encountered	from	to
yellow clay	0	38
green clay	38	314
Hard Clay	314	322
Sandy Shale	322	357
Sand	357	372
Sandy Shale	372	426
Clay	426	445
Clay and Sand streaks	445	453
Sand & Shale streaks	453	493
Sand & Shale streaks	493	638
Shale	638	693
Hard Shale	693	741
Rock	741	742
Shale	742	747
Rock	747	750
Shale	750	764
Hard Shale	764	767
Rock	767	779
Shale	779	780
Sandy Shale	780	797
Shale	797	817
Sand	817	819
Shale	819	830
Sand	830	845
Shale (Hard)	845	848
Sand	848	859
Shale, Sandy Shale	859	884
Sand	884	911
Shale	911	915
Sand	915	919
Shale	919	924
Sand	924	948
Shale	948	976
Sand	976	981
Sandy Shale	981	1008
Sand	1008	1034
Shale	1034	1044
Sand	1044	1058
Sand, streaks of Shale	1058	1080
Sand, Shale streaks	1080	1110
Hard Rock	1110	1151
Hard Shale	1151	1152
Hard Shale	1152	1255

DRILLERS REMARKS:  
 \_\_\_\_\_  
 \_\_\_\_\_  
 \_\_\_\_\_

ANKIN  
K 95  
4-68  
Schlumberger

MISSISSIPPI  
BOARD OF WATER COMMISSIONERS  
416 North State Street  
Jackson, Mississippi 39201

MCS  
COVERED

MISSISSIPPI  
WATER WELL DRILLERS LOG

4-3-1968 date well completed  
Lynn Central Co. firm name  
ANKIN county well located

LANDOWNER:  
Metropolitan Water, Inc.  
Jackson, Miss.  
(mailing address)

WELL LOCATION: Old Brandon Road  
sec. 10 T. 5 N R. 2 E  
near Airport  
(distance) miles (direction) of (nearest town)

WELL PURPOSE: Domestic  
(home, irrigation, municipal, industrial)

WELL COMPLETION DATA:

- (1) diameter (inches) 16"
- (2) total depth (feet) 1150'
- (3) static water level (feet) 168' below top of ground.
- (4) casing 1088' (material) (depth)  
16" (size) if telescope see back.
- (5) screen 50' (length) 1088' (depth to top)  
8" (size) stainless steel (material)
- (6) pump (HP) (yield gpm)  
Electric (type power)
- (7) electric log Yes (yes or no)  
Schlumberger Well Survey (organization running log)
- (8) how well bottom plugged Cement

description of formations encountered	from	to
yellow clay	0	38
green clay	38	314
hard clay	314	322
sandy shale	322	357
sand	357	372
sandy shale	372	436
clay	436	445
clay and sand streaks	445	453
sand & shale (hard)	453	493
sandy shale streaks	493	638
shale	638	693
hard shale	693	741
rock	741	742
shale	742	747
rock	747	750
shale	750	764
rock	764	767
hard shale	767	779
rock	779	780
shale	780	797
sandy shale	797	817
shale	817	819
sand	819	830
shale	830	845
sand	845	848
shale (hard)	848	859
sand	859	884
shale & sand streaks	884	911
sand	911	915
shale	915	919
sand	919	924
shale	924	948
sand	948	976
shale	976	981
sand	981	1008
sandy shale	1008	1034
sand	1034	1044
shale	1044	1058
sand	1058	1080
hard, broken shale	1080	1110
sand, shale streaks	1110	1151
hard rock	1151	1152
hard shale	1152	1253

DRILLERS REMARKS:  
Pump not set as of this date  
no test run



DEPARTMENT OF ENVIRONMENTAL QUALITY - OLWR

PUBLIC SUPPLY WELLS PROJECT

GPS LOG

USER NAME(S): Phillips/Hardin DATE: 7/2/96

UNIT DEQ #: \_\_\_\_\_ FILE #: B070214C

HEALTH DEPT. #: 610017-04 ELEV. @ 323'

USGS #: 1 K95 OLWR #: GW01303

OWNER: City of Pearl QUAD: Jackson SE

LOCATION: NE/SE S 10 T 5N R 2E COUNTY: Rankin

LOCATION DESCRIPTION: On Old Brandon Rd. at intersection  
with 475.

CASING DIA: \_\_\_\_\_ PUMP TYPE & SIZE: Turbine/125 HP

GPS FIELD LOCATION: LAT. 32° 17' 28.3" N LONG. 90° 04' 43.2" W

GPS CORRECTED LOCATION: LAT. 32.29107927 LONG. 90.07810118  
32.28518661 90.04566990

REMARKS: No tag  
\_\_\_\_\_  
\_\_\_\_\_  
\_\_\_\_\_  
\_\_\_\_\_

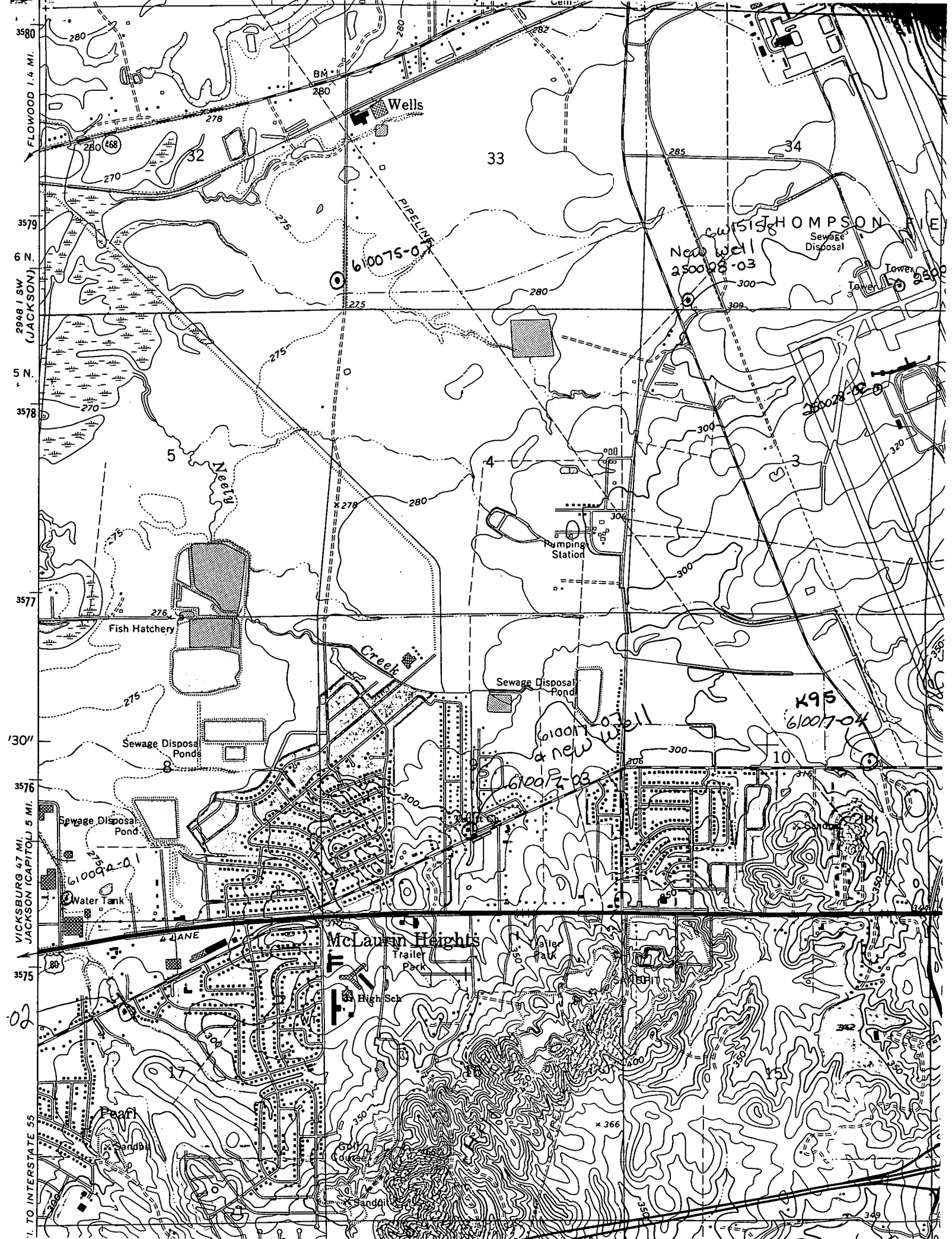

FLOWOOD 1.4 MI.

2948 / SW (JACKSON)

5 N.

3577

30"

VICKSBURG 4.7 MI.  
JACKSON (CAPITOL) 5 MI.

3575

02

I. TO INTERSTATE 55

Wells  
610075-03  
PIPELINE

THOMPSON AVE  
New Well  
610074-03  
Sewage Disposal  
Lower

Fish Hatchery

Creek

Sewage Disposal Pond

Sewage Disposal Ponds

610077-04 well  
& new well  
610074-03

K95  
610077-04

Sewage Disposal Pond

Water Tank

McLaurin Heights

Trailer Park

Water Tank

High Sch

Pond

Pond

x 366

349