

PUNCHED

WELL SCHEDULE

U. S. DEPT. OF THE INTERIOR GEOLOGICAL SURVEY WATER RESOURCES DIVISION

MASTER CARD

Record by Harvey Colahan Source of data SHIVERS Date 1-8-57 Map _____

State Miss County (or town) Miss 6-1

Latitude: 32° 16' 38" N Longitude: 090° 07' 26" W Sequential number: 1

Lat-long accuracy: 2 T 5 S, R 2 W, Sec 6 NE ME 1/4, NW 1/4

Local well number: K029CB0605NOZE Other number: _____ B & M

Local use: _____ Owner or name: KENNETH DUKES Address: _____

Ownership: County, Fed Gov't, City, Corp or Co, Private, State Agency, Water Dist P

Use of water: (A) Air cond, Bottling, Comm, Dewater, Power, Fire, Dom, Irr, Med, Ind, P S, Rec, (S) Stock, Instit, Unused, Repressure, Recharge, Desal-P S, Desal-other, Other P

Use of well: (A) Anode, Drain, Seismic, Heat Res, Obs, Oil-gas, Recharge, Test, Unused, Withdraw, Waste, Destroyed. U

DATA AVAILABLE: Well data Freq. W/L meas.: Field aquifer char.

Hyd. lab. data: _____

Qual. water data; type: _____

Freq. sampling: _____ Pumpage inventory: no. period: _____

Aperture cards: _____

Log data: _____

WELL-DESCRIPTION CARD

SAME AS ON MASTER CARD Depth well: 69.6 Meas. 6

Depth cased; (first perf.) _____ Casing type: _____; Diam. 4 1/2 in _____

Finish: (C) porous concrete, (F) gravel w. (perf.), (G) gravel w. (screen), (H) horiz. gallery, (J) open end, (P) perf., (S) screen, (T) sd. pt., (W) shored, (X) open hole, (Z) other J

Method Drilled: (A) air rot, (B) bored, (C) cable, (D) dug, (H) hyd. rot., (J) jetted, (P) air percussion, (R) reverse, (T) trenching, (V) driven, (W) drive wash, (Z) other H

Date Drilled: 9-9-57 Pump intake setting: _____ ft _____

Driller: R. G. McNEECE McNEECE name address

Lift (type): (A) air, (B) bucket, (C) cent. jet, (L) multiple, (M) multiple, (N) none, (P) piston, (R) rot., (S) submerg, (T) turb., (Z) other J Deep Shallow

Power (type): nat, elec, gas, gasoline, hand, gas, wind; H.P. 5 Trans. or meter no. 7

Descrip. MP _____ ft above _____ ft below LSD, Alt. MP _____

Alt. LSD: _____ Accuracy: (source) _____

Water Level: 85-90 ft above below MP; Ft. below LSD: 87 Accuracy: _____

Date meas.: 4-9 Yield: _____ gpm 30 Method determined _____

Drawdown: _____ ft Accuracy: _____ Pumping period _____ hrs _____

QUALITY OF WATER DATA: Iron _____ ppm Sulfate _____ ppm Chloride _____ ppm Hard. _____ ppm

Sp. Conduct _____ K x 10⁶ Temp. _____ °F Date sampled _____

Taste, color, etc. _____

Well No. K29

Latitude-longitude d m s N S

DROGEOLOGIC CARD

SAME AS ON MASTER CARD Physiographic Province: 03 Section: 03

D Drainage Basin: 137 Subbasin: 03

of site: (D) (C) (E) (F) (H) (K) (L) depression, stream channel, dunes, flat, hilltop, sink, swamp, (S) (P) (S) (T) (U) (V) offshore, pediment, hillside, terrace, undulating, valley flat

OR IFER: TE system series aquifer, formation, group SS

ology: US Origin: 2 Aquifer Thickness: 560 ft

80 Length of well open to: 40 ft Depth to top of: 560 ft

OR IFER: system series aquifer, formation, group

ology: Origin: Aquifer Thickness: ft

Length of well open to: ft Depth to top of: ft

ervals ended:

th to consolidated rock: ft Source of data:

th to cement: ft Source of data:

ficial erial: Infiltration characteristics:

fficient is: gpd/ft Coefficient Storage:

fficient is: gpd/ft²; Spec cap: gpm/ft; Number of geologic cards:

2000 gal. storage tank

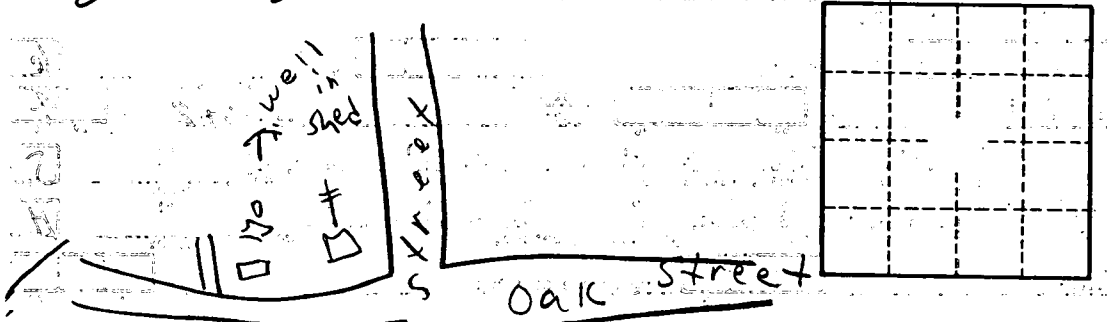

*PEARL CITY
FLOWOOD*