

WELL SCHEDULE

E Log #178

PUNCHED

U. S. DEPT. OF THE INTERIOR

GEOLOGICAL SURVEY

WATER RESOURCES DIVISION

MASTER CARD

Record by PE. Grantham Source of data E Log + Driv. Date 10-25-67 Map Jackson SE

State Mississippi 28 County (or town) Rankin 61

Latitude: 322033N Longitude: 0900046 Sequential number: 1

Lat-long accuracy: 20 T. 6 S. R. 3 W. Sec 20, SW 1/4, SE 1/4, SW 1/4

Local well number: G009CD2006N03E Other number: B & M

Local use: 174178 Owner or name: Percy Guyton

Owner or name: PERCY GUYTON Address: Brandon, Miss

Ownership: (C) County, Fed Gov't, City, Corp or Co, Private, State Agency, Water Dist P

Use of water: (A) Air cond, Bottling, Comm, Dewater, Power, Fire, Dom, Irr, Med, Ind, P S, Rec, (S) Stock, Instit, Unused, Repressure, Recharge, Desal-P S, Desal-other, Other H

Use of well: (A) Anode, Drain, Seismic, Heat Res, Obs, Oil-gas, Recharge, Test, Unused, Withdraw, Waste, Destroyed W

DATA AVAILABLE: Well data Freq. W/L meas.: Field aquifer char.

Hyd. lab. data:

Qual. water data; type:

Freq. sampling: Pumpage inventory: period:

Aperture cards:

Log data: E Log LA-516

WELL-DESCRIPTION CARD

SAME AS ON MASTER CARD Depth well: 460 ft 460 Meas. accuracy 6

Depth cased: (first perf.) 450 ft 450 Casing type: Steel; Diam. 4x2 in 4

Finish: (C) concrete, (F) gravel w. (perf.), (G) gravel w. (screen), (H) horiz. gallery, (O) open end, (P) perf., (S) screen, (T) sd. pt., (W) shored, (X) open hole, (Z) other S

Method: (A) air, (B) bored, (C) cable, (D) dug, (H) hyd jetted, (J) rot., (P) air percussion, (R) reverse, (T) trenching, (V) driven, (W) wash, (Z) other H

Date Drilled: 10-67 967 Pump intake setting: ft

Driller: Water Wells Service, Brandon Miss

Lift (type): (A) air, (B) bucket, (C) cent, (J) jet, (L) multiple, (M) multiple, (N) nose, (P) piston, (R) rot, (S) submerg, (T) turb, other J Deep D Shallow 40

Power (type): (nat) diesel, elec, gas, gasoline, hand, gas, wind; (LP) H.P. Trans. or meter no.

Descrip. MP ft above below LSD. Alt. MP

Alt. LSD: 360 360 Accuracy: (source) 4

Water Level ft above below MP; ft above below LSD Accuracy:

Date meas: Yield: gpm Method determined

Drawdown: ft Accuracy: Pumping period hrs

QUALITY OF WATER DATA: Iron ppm Sulfate ppm Chloride ppm Hard. ppm

Sp. Conduct K x 10⁶ Temp. °F Date sampled

Taste, color, etc.

Well No.

Latitude-longitude _____
d m s N
d m s S

HYDROGEOLOGIC CARD

SAME AS ON MASTER CARD 19 Physiographic Province: 03 Section: _____
20 21

D Drainage Basin: _____ Subbasin: _____
22 23 25 26

po of depression, stream channel, dunes, flat, hilltop, sink, swamp,
ll site: (Ø) (P) (S) (T) (U) (V) _____
offshore, pediment, hillside, terrace, undulating, valley flat _____ 27

JOR _____
UIFER: _____ aquifer, formation, group _____
system series 28 29 30 31

thology: _____ Origin: _____ Aquifer Thickness: _____ ft
32 33 34

Length of well open to: _____ ft _____ Depth to top of: _____ ft _____
35 37 38 40 41 43

NOR _____
UIFER: _____ aquifer, formation, group _____
system series 44 45 46 47

thology: _____ Origin: _____ Aquifer Thickness: _____ ft
48 49 50

Length of well open to: _____ ft _____ Depth to top of: _____ ft _____
51 53 54 56 57 59

Intervals screened: _____

Depth to consolidated rock: _____ ft _____ Source of data: _____
60 63 64

Depth to cement: _____ ft _____ Source of data: _____
65 68 69

Official serial: _____ Infiltration characteristics: _____
70 71 72

Efficient storage: _____ gpd/ft _____ Coefficient Storage: _____
73 75 76 78

Efficient transmissivity: _____ gpd/ft²; Spec cap: _____ gpm/ft; Number of geologic cards: _____
79

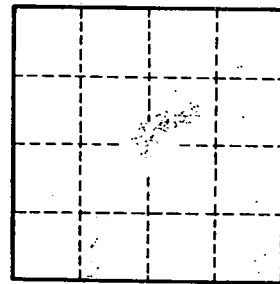
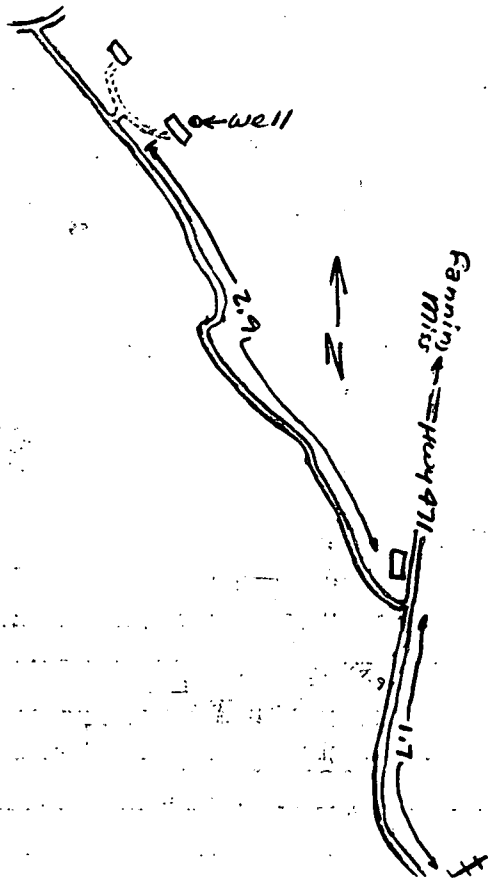

Well No. _____