

3/78

U.S. GEOLOGICAL SURVEY  
WATER RESOURCES DIVISION  
MISSISSIPPI DISTRICT  
WELL RECORD

230A GOSHEN SPRINGS

TRANSMITTED FOR ADP  
4/77

Record by WTO Date 3-23-76 County Rankin Well No. A21  
GW02863 0610035-02 Goshen Springs Quad E-log No. 419

Site ID 

3	2	3	0	0	2	0	8	9	5	5	2	8	0	1
---	---	---	---	---	---	---	---	---	---	---	---	---	---	---

 R= 0 T= (A) M 2= (W) \*

Data reliab. 3= (C) U \*Report. agency 4= U S 2 0 5 5 Dist. 6= 2 8 \*7= 2 8 3 \*

County 8= 1 2 1 \* Lat/Long. 9= 3 2 3 0 0 2 10= 0 8 9 5 5 2 8 \*

Well No. 12= A 0 2 1 \* Loc 13= S E S E S 3 0 T 0 8 N R 0 4 E \*

Alt. 308 16= 3 1 2 3 9 Hyd. Unit (OWDC) 20= \* \*

Date 21= 0 2 / 0 4 / 1 9 7 6 \* Well use 23= W \* Water use 24= P \* WA

Hole depth 27= 5 0 5 \* Well depth 28= 5 0 0 \*

WL 30= 7 3 \* Date 31= 0 2 / 1 7 / 1 9 7 6 \* Source 33= (D) \*

GEN. SITE DATA

OWNER

R = 158 \* T= (A) M \* Date 159# 0 2 / 1 7 / 1 9 7 6 \* Owner No. LAKE HARBOR  
Owner 161= P E A R L R V A L L E Y D I S T \* Hwy 43 #2

FIELD QW

R = 192 \* T= A M \* Date 193# 0 8 / 1 9 / 1 9 8 1 \* Additional cards same R thru 193 for each parameter.  
Temp. 196# 0 0 0 1 0 \* °C 197= 2 1 . 0 \*  
Cond. 196# 0 0 0 9 5 \* uMhos 197= 3 5 0 . \*  
pH 196# 0 0 4 0 0 \* Value 197= 6 . 7 \* CCKF

CONSTR.

R = 58 \* T= (A) M \* 59# 1 \* Date 60= 0 2 / 1 7 / 1 9 7 6 \*  
Drlr 63= 0 6 4 \* Name: Jayne Method 65= H \*  
Finish 66= S \* Remarks

CASING

R = 76 \* T= (A) M \* 59# 1 \*  
Top csng 77# - 0 . \* Bot. csng 78= 3 7 8 . \* Diam. 79# 1 0 . . \*  
R = 76 \* T= (A) M \* 59# 1 \*  
Top csng 77# 3 7 8 . \* Bot. csng 78= 4 4 0 . \* Diam. 79# 6 . . \*

OPENINGS

R = 82 * T= (A) M * 59# 1 *	R = 82 * T= A M * 59# *
Top 83# 4 4 0 . *	83# . . . *
Bot. 84# 4 9 0 . *	84# . . . *
Type 85= S *	85# * . . . *
Diam. 87= 6 . . *	87# . . . *
Size 88= . . . *	88# . . . *

YIELD

R = 134 146 \* T= (A) M \* 147# 1 \* Q 150= 3 0 0 . \* Q/s 272= . . . . \*

200 e20#

LIFT

R= 42 \* T= (A) M \* Lift type 43# T \* Intake 44= [ ][ ][ ] \* Power type 45= E \*  
Date 38= 0 2 / 1 7 / 1 9 7 6 \* H.P. 46= [ ][ ] 25 [ ][ ] \*

LOGS

R= 198 \* T= (A) M \* Log 199# D \* Top 200= [ ][ ][ ] 0 [ ][ ] \* Bot. 201= [ ][ ] 50 6 [ ][ ] \*  
R= 198 \* T= (A) M \* Log 199# E \* Top 200= [ ][ ][ ] 55 [ ][ ] \* Bot. 201= [ ][ ] 50 2 [ ][ ] \*  
R= 189 \* T= (A) \* 190# 419 \* 191= M I S S [ ][ ] D I S T \*

ANAL.

R= 114 \* T= A M \* Year 115# [ ][ ][ ] \* Type 120= [ ][ ] \*

AQUIFERS

R= 90 \* T= (A) M \* √ 256# 1 \* Top 91= [ ][ ] 350 [ ][ ] \* Bot. 92= [ ][ ] 490 [ ][ ] \*  
Unit ID 93= 1 2 4 2 < K F \* Name of unit  
R= 90 \* T= A M \* 256# [ ][ ] \* Top 91= [ ][ ][ ][ ] \* Bot. 92= [ ][ ][ ][ ] \*  
Unit ID 93= [ ][ ][ ][ ][ ][ ] \* Name of unit

R= 98 \* T= A M \* 99# 1 \* Unit tested 100= [ ][ ][ ][ ][ ][ ][ ][ ] \*  
R= 105 \* T= A M \* 99# 1 \* Test No. 106# [ ][ ][ ][ ][ ][ ][ ][ ] \*  
Transmissivity 107= [ ][ ][ ][ ][ ][ ][ ][ ] \* T(gal/d)/ft  
Hydraul. conduct. 108= [ ][ ][ ][ ][ ][ ][ ][ ] \* P(gal/d)/ft<sup>2</sup>  
Storage coeff. 110= [ ][ ][ ][ ][ ][ ][ ][ ] \* Boundaries

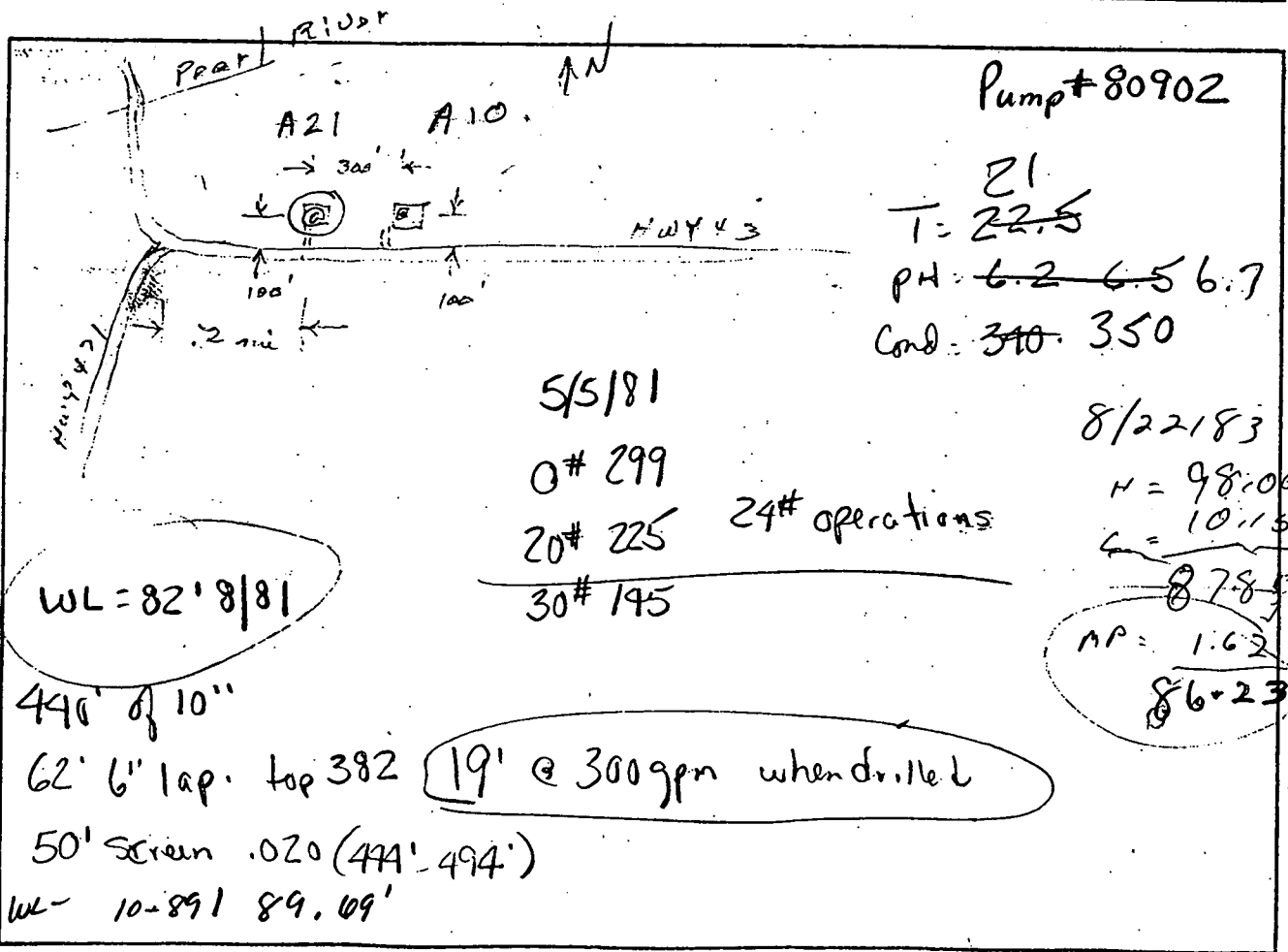

30  
494  
50  
494

**RANKIN**  
**AZT**  
**2-17-76**  
**E. Co. #419**

MISSISSIPPI  
 BOARD OF WATER COMMISSIONERS  
 416 North State Street  
 Jackson, Mississippi 39201

CODED

WATER WELL DRILLERS LOG

2-17-1976 date well completed  
 Super Central Company firm name  
 Rankin county well located

LANDOWNER	description of formations encountered	from	to
Pearl River Valley Water Supply District	Clay	0	30
P.O. Box 12128, Jackson Miss. 39211 (mailing address)	Coarse Sand	30	40
WELL LOCATION: sec. 30 T. 8 N. R. 4 E	Clay and Sand Shale	40	130
(distance) miles of (direction) of (nearest town)	Rock	130	131
WELL PURPOSE: (home, irrigation, municipal, industrial)	Sandy Clay	131	260
WELL COMPLETION DATA:	Sand and Shale	260	330
(1) diameter (inches) 10"	Sandy Shale and Sand beds	330	428
(2) total depth (feet) 500'	Sand and Shale beds	428	500
(3) static water level (feet) 73 below top of ground	Clay	500	506
(4) casing Steel 440' (material) (depth) 10" if telescope see back. (size) and 62' 26" (size)			
(5) screen 50' 440' (length) (depth to top) 6" Stainless Steel (size) (material)			
(6) pump 25 HP 300 (type) (yield gpm) Electric (type power)			
(7) electric log yes (yes or no) Miss. Geol. Survey (organization running log)			
(8) how well bottom plugged Valve			
DRILLERS REMARKS:			

446  
 1/31/78  
 MAR 29 1976  
 MISS. BD. OF WATER COMM.

DEPARTMENT OF ENVIRONMENTAL QUALITY - OLWR

PUBLIC SUPPLY WELLS PROJECT

GPS LOG

USER NAME(S): Phillips/Hardin DATE: 7/1/96

UNIT DEQ #: \_\_\_\_\_ FILE #: B070120D

HEALTH DEPT. #: 610035-02 ELEV. @ 308'

USGS #: A21 OLWR #: GW02863

OWNER: PRVWSD QUAD: Goshen Springs

LOCATION: SE/SE S 30 T 8N R 4E COUNTY: Rankin

LOCATION DESCRIPTION: 0.2 mi east of intersection with  
471 on Hwy 43 at elevated tank

CASING DIA: \_\_\_\_\_ PUMP TYPE & SIZE: Turbine/30 HP

GPS FIELD LOCATION: LAT. 32° 29' 54.7" N LONG. 89° 55' 22.0" W

GPS CORRECTED LOCATION: LAT. 32.49865425 LONG. 89.92285711

REMARKS: Measured 15' south of well

\_\_\_\_\_  
\_\_\_\_\_  
\_\_\_\_\_

# TopoZone.com

Target is 32° 29' 55"N, 89° 55' 22"W - GOSHEN SPRINGS quad [Quad\_Info]

