

WELL SCHEDULE

U. S. DEPT. OF THE INTERIOR

GEOLOGICAL SURVEY

WATER RESOURCES DIVISION

PUNCHED

DEC 20 1973

MASTER CARD

Record by GJD BKE Source of data Bowc Date 8-9-61 Map _____

State 2A County (or town) Quintman 600

Latitude: 340620N Longitude: 0902115 Sequential number: 1

Lat-long accuracy: 2 Local well number: K029CD2426NO2W

Local use: OGP Owner or name: W. M. YOUNG

Ownership: County, Fed Gov't, City, Corp or Co, Private, State Agency, Water Dist P

Use of water: (S) (T) (U) (V) (W) (X) (Y) (Z) pasture

Use of well: (A) (D) (G) (H) (I) (J) (K) (L) (M) (N) (O) (P) (Q) (R) (S) (T) (U) (V) (W) (X) (Y) (Z) W

DATA AVAILABLE: Well data Freq. W/L meas.: Field aquifer char.

Hyd. lab. data:

Qual. water data; type:

Freq. sampling: Pumpage inventory:

Aperture cards:

Log data:

WELL-DESCRIPTION CARD

SAME AS ON MASTER CARD Depth well: 9.5 Meas. rept accuracy 6

Depth cased: 4.2 Casing type: _____ Diam. in 6

Finish: (C) porous concrete, (F) gravel w. (perf.), (G) gravel w. (screen), (H) horiz. gallery, (I) open end, (J) percuss, rotary, (K) other, (L) shored, open hole, (M) other, (N) other, (O) other, (P) other, (Q) other, (R) other, (S) other, (T) other, (U) other, (V) other, (W) other, (X) other, (Y) other, (Z) other S

Method Drilled: (A) air rot., (B) bored, (C) cable, (D) dug, (E) hyd rot., (F) jetted, (G) air percuss, (H) reverse, (I) trenching, (J) driven, (K) wash, (L) other H

Date Drilled: 9.6.1 Pump intake setting: _____ ft 36

Driller: Five County Farmer Assoc. name address _____

Lift (type): (A) air, (B) bucket, (C) cent, (D) jet, (E) multiple, (F) multiple, (G) noise, (H) piston, (I) rot, (J) submerg, (K) turb, (L) other, (M) Deep, (N) Shallow 39

Power (type): (A) diesel, (B) elec, (C) gas, (D) gasoline, (E) hand, (F) gas, (G) wind, (H) H.P., (I) Trans. or meter no. 3

Descrip. MP _____ ft above below LSD, Alt. MP _____

Alt. LSD: _____ Accuracy: (source) _____ 47

Water Level: _____ ft above below MP; Ft below LSD 1.5 Accuracy: _____ 52

Date meas: 10.6.1 Yield: _____ gpm _____ Method determined _____ 61

Drawdown: _____ ft _____ Accuracy: _____ Pumping period _____ hrs _____ 68

QUALITY OF WATER DATA: Iron _____ ppm Sulfate _____ ppm Chloride _____ ppm Hard. _____ ppm 72

Sp. Conduct _____ K x 10⁶ _____ Temp. _____ °F _____ Date sampled _____ 79

Well No. K29

HYDROGEOLOGIC CARD

MASTER CARD

Physiographic Province:

03

Section:

220

E

Drainage Basin:

15F

Subbasin:

26

(D) depression, stream channel, dunes, flat, hilltop, sink, swamp,
site: (O) (P) (S) (T) (U) (V)
offshore, pediment, hillside, terrace, undulating, valley flat

ER: system series 06 29

aquifer, formation, group MA

logy: 5R Origin: 2 Aquifer Thickness: ft

Length of well open to: ft 53 Depth to top of: ft

ER: system series 44 45 aquifer, formation, group

logy: Origin: Aquifer Thickness: ft

Length of well open to: ft Depth to top of: ft

vals ned: 42-95' = 53' of 6"

to lidated rock: ft Source of data:

to ent: ft Source of data:

cial ial: Infiltration characteristics:

icient gpd/ft Coefficient Storage:

icient gpd/ft²; Spec cap: gpm/ft; Number of geologic cards:

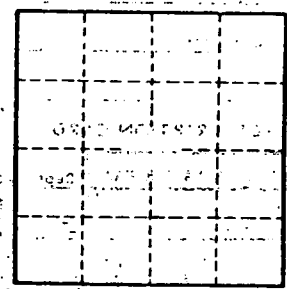
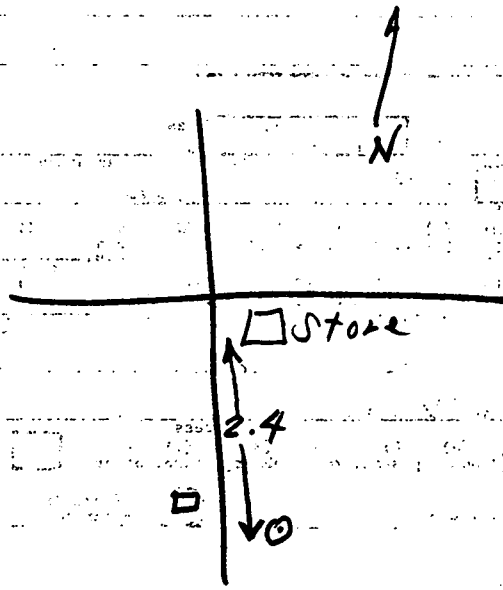

Well No.

K-29