

WELL SCHEDULE

U. S. DEPT. OF THE INTERIOR

GEOLOGICAL SURVEY

WATER RESOURCES DIVISION

PUNCHED
DEC 20 1973

MASTER CARD

Record by Charpen Source of data _____ Date 7-4-57 Map _____

State 28 County Quitman (or town) 60

Latitude: 34° 10' 58" N Longitude: 090° 16' 60" W Sequential number: 1

Lat-long accuracy: 2 T N E S, R W, Sec 27, SW $\frac{1}{4}$, SE $\frac{1}{4}$, NE $\frac{1}{4}$

Local well number: H0050A2727NO1W Other number: _____ B & M. _____

Local use: _____ Owner or name: _____

Owner or name: _____ Address: _____

Ownership: County, Fed Gov't, City, Corp or Co, Private, State Agency, Water Dist P

Use of Air cond, Bottling, Comm, Dewater, Power, Fire, Dom, Irr, Med, Ind, P S, Rec, water: _____

Stock, Instic, Unused, Repressure, Recharge, Desal-P S, Desal-other, Other H

Use of Anode, Drain, Seismic, Heat Res, Obs, Oil-gas, Recharge, Test, Unused, Withdraw, Waste, Destroyed. well: W

DATA AVAILABLE: Well data Freq. W/L meas.: Field aquifer char.

Hyd. lab. data: _____

Qual. water data; type: _____

Freq. sampling: _____ Pumpage inventory: yes no; period: _____

Aperture cards: _____ yes

Log data: _____

WELL-DESCRIPTION CARD

SAME AS ON MASTER CARD Depth well: _____ ft Meas. rept accuracy 0

Depth cased; (first perf.) _____ ft Casing type: _____; Diam. 1/4 in 7

Finish: porous concrete, gravel w. (perf.), gravel w. (screen), horiz. gallery, open end, perf., screen, sd. pt., shored, open hole, other 7

Method Drilled: (A) air rot, (B) bored, (C) cable, (D) dug, (H) hyd rot., (J) jetted, (P) air percussion, (R) reverse, (T) rotary, (V) trenching, (W) driven, (X) wash, (Z) other 7

Date Drilled: _____ Pump intake setting: _____ ft _____

Driller: _____ name _____ address _____

Lift (type): (A) air, (B) bucket, (C) cent., (J) jet, (L) multiple, (M) multiple, (N) none, (P) piston, (R) rot., (S) submerg, (T) turb., other 7 Deep Shallow

Power (type): diesel, elec, gas, gasoline, hand, gas, wind; H.P. 7 Trans. or meter no. _____

Descrip. MP _____ ft above below LSD, Alt. MP _____

Alt. LSD: 155 Accuracy: (source) 0

Water Level 12.07 ft above below MP; Ft above below LSD 12 Accuracy: _____

Date meas: 7-4-57 Yield: 757 gpm Method determined _____

Drawdown: _____ ft Accuracy: _____ Pumping period _____ hrs _____

QUALITY OF WATER DATA: Iron _____ ppm Sulfate _____ ppm Chloride _____ ppm Hard. _____ ppm

Sp. Conduct _____ K x 10⁶ Temp. _____ °F Date sampled _____

Well No.

H5

HYDROGEOLOGIC CARD

WATER CARD

Physiographic Province:

03

Section:

0833E

Drainage Basin:

15F

Subbasin:

(D) depression, stream channel, dunes, flat, hilltop, sink, swamp, site: (P) offshore, pediment, hillside, terrace, undulating, valley flat

System:

QB

MA

Origin:

R

2

Aquifer Thickness:

Length of well open to:

Depth to top of:

System:

Origin:

Length of well open to:

Depth to top of:

Consolidated rock:

Infiltration characteristics:

Coefficient of storage:

Coefficient of storage:

Spec cap:

Number of geologic cards:

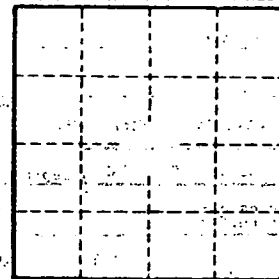
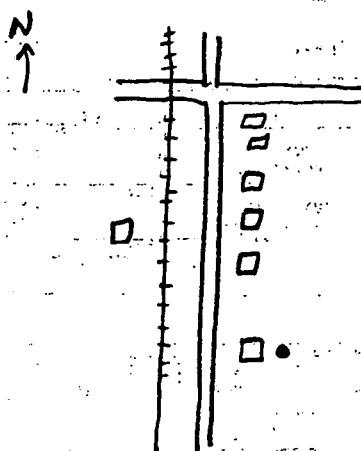

Well No.

45