

WELL SCHEDULE

U. S. DEPT. OF THE INTERIOR

GEOLOGICAL SURVEY

WATER RESOURCES DIVISION

**PUNCHED**  
DEC 20 1973

MASTER CARD

Record by FH <sup>GJD</sup> Source of data Mr. Barksdale Date 3-10-54 Map \_\_\_\_\_

State 28 County Quitman 60

Latitude: 34 14 15 N Longitude: 09 02 31 W Sequential number: 1

Lat-long accuracy: 3 deg 7 min 9 sec 11 S, R, W, Sec \_\_\_\_\_

Local well number: G001B.D0327N02W Other number: \_\_\_\_\_ B & M

Local use: 064 Owner or name: Dalmar Plantation

Owner or name: DALMAR PLANT Address: \_\_\_\_\_

9-19-80  
 WL-25-2.89-7.5  
 WL=14.61  
 166-14.61=151.39  
 J.S.A

Ownership: County, Fed Gov't, City, Corp or Co, Private, State Agency, Water Dist N

Use of water: (A) Air cond, Bottling, Comm, Dewater, Power, Fire, Dom, Irr, Med, Ind, P S, Rec, (S) (T) (U) (V) (W) (X) (Y) (Z) T

Use of well: (A) Anode, Drain, Seismic, Heat Res, Obs, Oil-gas, Recharge, Test, Unused, Withdraw, Waste, Destroyed, (D) (G) (H) (I) (J) (K) (L) (M) (N) (O) (P) (Q) (R) (S) (T) (U) (V) (W) (X) (Y) (Z) W

DATA AVAILABLE: Well data  Freq. W/L meas:  Field aquifer char.

Hyd. lab. data:

Qual. water data; type:

Freq. sampling:  Pumpage inventory: no  period: \_\_\_\_\_

Aperture cards:  yes

Log data: D

WELL-DESCRIPTION CARD

SAME AS ON MASTER CARD Depth well: 108 ft Meas. rept accuracy 6

Depth cased (first perf.): 83 ft Casing type: \_\_\_\_\_; Diam. 8 in 8

Finish: porous concrete, gravel w. (perf.), (screen), gallery, end, (C) (F) (G) (H) (I) (J) (K) (L) (M) (N) (O) (P) (S) (T) (W) (X) (Z) S

Method drilled: (A) air bored, (B) cable, (C) dug, (D) hyd jetted, (E) air rot., (F) percussion, (G) rotary, (H) reverse, (I) trenching, (J) driven, (K) drive wash, (L) other H

Date Drilled: 9.53 Pump intake setting: \_\_\_\_\_ ft 36 38

Driller: Layne Central name address \_\_\_\_\_

Lift (type): (A) air, (B) bucket, (C) cent, (D) jet, (E) multiple, (F) multiple, (G) (cent.), (H) (turb.), (I) none, (J) piston, (K) rot, (L) submerg, (M) turb, (N) other T Deep  Shallow

Power (type): diesel, elec, gas, gasoline, hand, gas, wind; H.P. 7 1/2 U Trans. or meter no. \_\_\_\_\_

Descrip. MP 8.0 ft below LSD, Alt: MP \_\_\_\_\_

Alt. LSD: 166 Accuracy: (source) 4

Water Level 21.73 ft above/below MP; Ft below LSD 14 Accuracy: 1

Date meas: 3-10-54 3.54 Yield: \_\_\_\_\_ gpm Method determined \_\_\_\_\_

Drawdown: \_\_\_\_\_ ft Accuracy: \_\_\_\_\_ Pumping period \_\_\_\_\_ hrs \_\_\_\_\_

QUALITY OF WATER DATA: Iron \_\_\_\_\_ Sulfate \_\_\_\_\_ Chloride \_\_\_\_\_ Hard. \_\_\_\_\_

Sp. Conduct \_\_\_\_\_ K x 10 6 Temp. \_\_\_\_\_ °F \_\_\_\_\_ Date sampled \_\_\_\_\_

Taste, color, etc. \_\_\_\_\_

Well No.

61

Well No. 61

Latitude-longitude \_\_\_\_\_  
d m s d m s

**HYDROGEOLOGIC CARD**

NAME AS ON MASTER CARD  
DEC 3 1953

Physiographic Province: \_\_\_\_\_ Section: \_\_\_\_\_

Drainage Basin: E Subbasin: 1151F

Topo of well site: (D) depression, (C) stream channel, (E) dunes, (F) flat, (H) hiltop, (K) sink, (L) swamp, (P) offshore, (S) pediment, (T) hillside, (U) terrace, (V) undulating, (W) valley flat

MAJOR AQUIFER: system \_\_\_\_\_ series 06 aquifer, formation, group MZ

Lithology: 5R Origin: 2 Aquifer Thickness: \_\_\_\_\_ ft

Length of well open to: \_\_\_\_\_ ft Depth to top of: \_\_\_\_\_ ft

MINOR AQUIFER: system \_\_\_\_\_ series \_\_\_\_\_ aquifer, formation, group \_\_\_\_\_

Lithology: \_\_\_\_\_ Origin: \_\_\_\_\_ Aquifer Thickness: \_\_\_\_\_ ft

Length of well open to: \_\_\_\_\_ ft Depth to top of: \_\_\_\_\_ ft

Intervals Screened: 83'-108ft = 25' of 8"

Depth to consolidated rock: \_\_\_\_\_ ft Source of data: \_\_\_\_\_

Depth to basement: \_\_\_\_\_ ft Source of data: \_\_\_\_\_

Surficial material: \_\_\_\_\_ Infiltration characteristics: \_\_\_\_\_

Coefficient Trans: \_\_\_\_\_ gpd/ft Coefficient Storage: \_\_\_\_\_

Coefficient Perm: \_\_\_\_\_ gpd/ft<sup>2</sup>; Spec cap: \_\_\_\_\_ gpm/ft; Number of geologic cards: \_\_\_\_\_

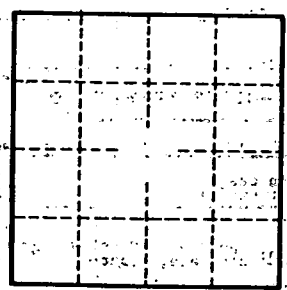
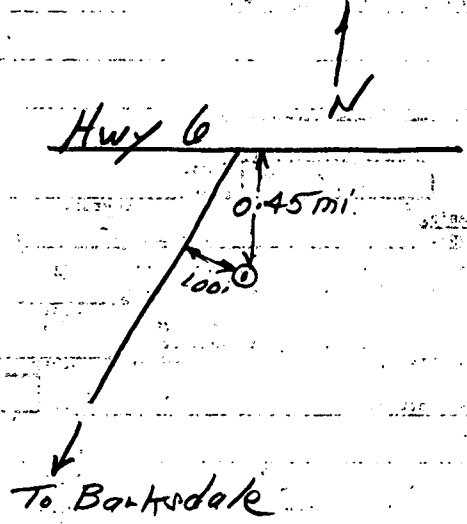

Well No. \_\_\_\_\_

61