

WELL SCHEDULE

U. S. DEPT. OF THE INTERIOR

GEOLOGICAL SURVEY

WATER RESOURCES DIVISION

PUNISHED and VERIFIED  
ROLLA COMMUNICATION BRANCH

MASTER CARD

Record by M Smith Source of data \_\_\_\_\_ Date 8/70 Map \_\_\_\_\_

State 29 County (or town) Quitman Sequential number: 60

Latitude: 34 deg 15 min 38 sec N Longitude: 090 degrees 16 min 14 sec W Sequential number: 1

Lat-long accuracy: 3 T 28 S, R 1 Sec 35, SE 1, NW 1

Local well number: E027PB3528NO1W Other number: Well #2 B & M

Local use: 064 Owner or name: Town of Marks

Owner or name: MARKS Address: \_\_\_\_\_

Ownership: County, Fed Gov't, City, Corp or Co, Private, State Agency, Water Dist M

Use of water: (A) Air cond, (B) Bottling, (C) Comm, (D) Dewater, (E) Power, (F) Fire, (G) Dom, (H) Irr, (I) Med, (J) P, S, Rec, (K) Stock, (L) Inatit, (M) Unused, (N) Reppure, (O) Recharge, (P) Desal-P S, (Q) Desal-other, (R) Other U

Use of well: (A) Anode, (B) Drain, (C) Seismic, (D) Heat Res, (E) Obs, (F) Oil-gas, (G) Recharge, (H) Test, (I) Unused, (J) Withdraw, (K) Waste, (L) Destroyed U

DATA AVAILABLE: Well data  Freq. W/L meas.:  Field aquifer char:

Hyd. lab. data: \_\_\_\_\_

Qual. water data; type: \_\_\_\_\_

Freq. sampling: \_\_\_\_\_ Pumpage inventory:  no; period: \_\_\_\_\_

Aperture cards: \_\_\_\_\_ yes

Log data: \_\_\_\_\_

WELL-DESCRIPTION CARD

SAME AS ON MASTER CARD Depth well: 927 ft Meas. accuracy 6

Depth cased: \_\_\_\_\_ ft Casing type: \_\_\_\_\_; Diam. in 16

Finish: (C) porous concrete, (F) gravel w. (perf.), (G) gravel w. (screen), (H) horiz. gallery, (I) open end, (J) perf., (K) screen, (L) sd. pt., (M) shored, (N) open hole, (O) other S

Method Drilled: (A) air rot, (B) bored, (C) cable, (D) dug, (E) hyd rot., (F) jetted, (G) air percussion, (H) rotary, (I) reverse, (J) trenching, (K) driven, (L) drive wash, (M) other H

Date Drilled: 952 Pump intake setting: \_\_\_\_\_ ft

Driller: Layne C. name address \_\_\_\_\_

Lift (type): (A) air, (B) bucket, (C) cent, (D) jet, (E) multiple, (F) multiple, (G) none, (H) piston, (I) rot, (J) submerg, (K) turb, (L) other T Deep  Shallow

Power (type): (A) diesel, (B) elec, (C) gas, (D) gasoline, (E) hand, (F) gas, (G) wind, (H) H.P. 50 Trans. or meter no. V

Descrip. MP \_\_\_\_\_ ft above below LSD, Alt. MP \_\_\_\_\_

Alt. LSD: 160 Accuracy: (source) 3

Water Level: \_\_\_\_\_ ft above below MP; Ft below LSD +5 Accuracy: 6

Date meas: 552 Yield: \_\_\_\_\_ gpm 1155 Method determined 61

Drawdown: \_\_\_\_\_ ft Accuracy: \_\_\_\_\_ Pumping period: \_\_\_\_\_ hrs \_\_\_\_\_

QUALITY OF WATER DATA: Iron \_\_\_\_\_ ppm Sulfate \_\_\_\_\_ ppm Chloride \_\_\_\_\_ ppm Hard. \_\_\_\_\_ ppm

Sp. Conduct \_\_\_\_\_ K x 10 6 Temp. \_\_\_\_\_ °F Date sampled \_\_\_\_\_

Taste, color, etc. \_\_\_\_\_

Well No.

E27

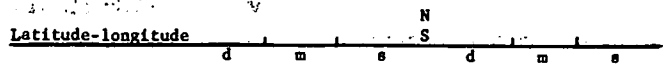

**DROGEOLOGIC CARD**

NAME AS ON MASTER CARD \_\_\_\_\_ Physiographic Province: 03 Section: \_\_\_\_\_

E Drainage Basin: 15E Subbasin: \_\_\_\_\_

(D) (C) (E) (F) (H) (K) (L)  
 of depression, stream channel, dunes, flat, hilltop, sink, swamp,  
 site: (O) (P) (S) (T) (U) (V)  
 offshore, pediment, hillside, terrace, undulating, valley flat \_\_\_\_\_

OR  
 IFER: \_\_\_\_\_ TE \_\_\_\_\_ MW  
 system series aquifer, formation, group

ology: \_\_\_\_\_ US \_\_\_\_\_ 2 Aquifer  
 Origin: Thickness: ft

Length of well open to: \_\_\_\_\_ ft \_\_\_\_\_ 27 Depth to top of: \_\_\_\_\_ ft \_\_\_\_\_  
 37 38 39 40 41 42 43

OR  
 IFER: \_\_\_\_\_ \_\_\_\_\_ \_\_\_\_\_  
 system series aquifer, formation, group

ology: \_\_\_\_\_ \_\_\_\_\_ \_\_\_\_\_  
 Origin: \_\_\_\_\_ Aquifer  
 Thickness: \_\_\_\_\_ ft

Length of well open to: \_\_\_\_\_ ft \_\_\_\_\_ \_\_\_\_\_ Depth to top of: \_\_\_\_\_ ft \_\_\_\_\_  
 44 45 46 47 48 49 50 51 52 53

ervals  
 ened:

h to consolidated rock: \_\_\_\_\_ ft \_\_\_\_\_ \_\_\_\_\_ Source of data: \_\_\_\_\_  
 54 55 56 57 58 59 60 61 62 63 64

h to ment: \_\_\_\_\_ ft \_\_\_\_\_ \_\_\_\_\_ Source of data: \_\_\_\_\_  
 65 66 67 68 69 70 71 72 73 74 75

icial  
 rial: \_\_\_\_\_ \_\_\_\_\_ \_\_\_\_\_ Infiltration characteristics: \_\_\_\_\_  
 76 77 78 79 80 81 82 83 84 85 86

icient  
 s: \_\_\_\_\_ gp4/ft \_\_\_\_\_ \_\_\_\_\_ Coefficient Storage: \_\_\_\_\_  
 87 88 89 90 91 92 93 94 95 96 97

icient  
 s: \_\_\_\_\_ gp4/ft<sup>2</sup>; Spec cap: \_\_\_\_\_ gpm/ft; Number of geologic cards: \_\_\_\_\_  
 98 99 100 101 102 103 104 105 106 107 108 109 110

EX 4 8 93

*water level*  
*6-7-1973*  
*25.88' below lsd @ 1705*

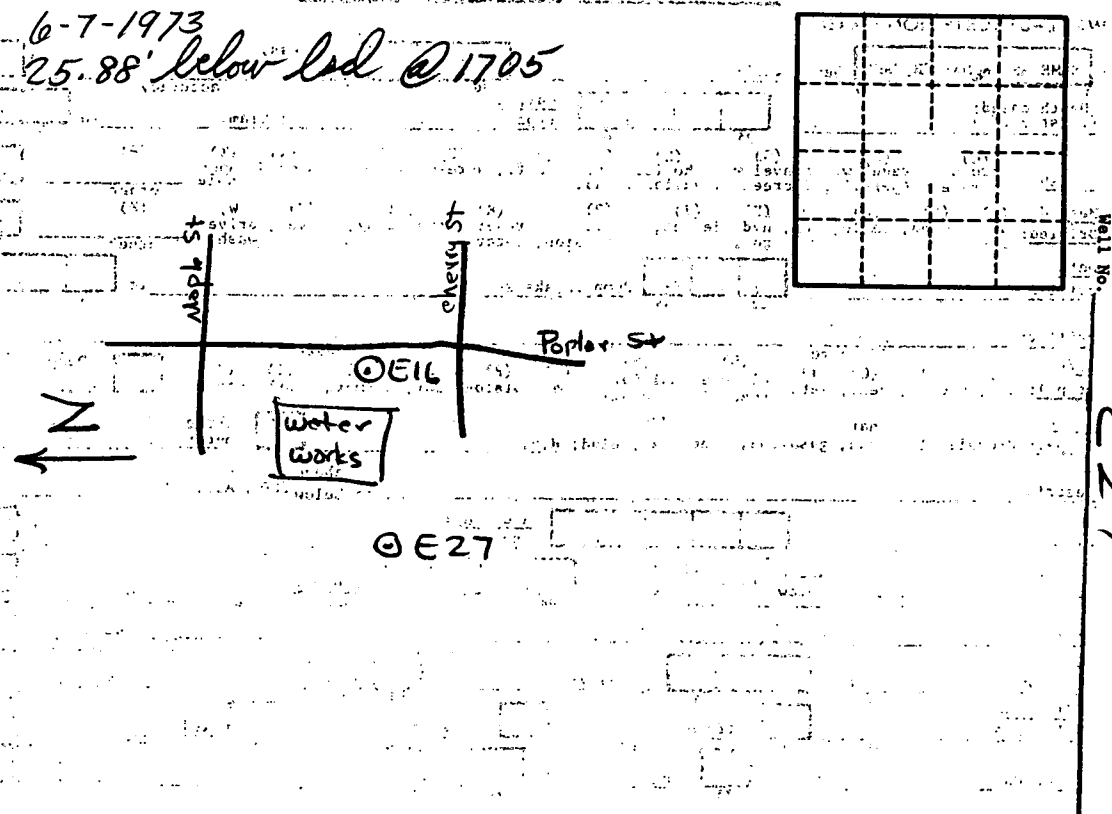

Well No. E27