

Recorded
11/23/76
JAC

FORM 9-1642
(1-68)

Well No. E-109 # 21
A 15

WELL SCHEDULE
GEOLOGICAL SURVEY

PUNCHED

U. S. DEPT. OF THE INTERIOR

WATER RESOURCES DIVISION

NOV 7 1972

MASTER CARD

Record by G. J. Dalsin Source of data E-109 Driller Date 12-10-1971 Map Sledge 1:62,500

State 28 County (or town) Quitman 69

Latitude: 34^{deg} 26^{min} 00^{sec} N Longitude: 09^{degrees} 01^{min} 31^{sec} W Sequential number:

Lat-long accuracy: 2⁰ T. 7⁰ S. 10⁰ Sec 35 t. SW t. NE t. Other number: B & M

Local well number: A015CA3507S10W Other number:

Local use: 064021 874 17 Owner or name: Town of Sledge

Owner or name: SLEDGE Address: Sledge, Miss.

Ownership: (C) County, Fed Gov't, (F) City, Corp or Co, Private, (M) State Agency, Water Dist (N) (P) (S) (W) M

Use of water: (A) Air cond, Bottling, Comm, Dewater, Power, Fire, Dom, Irr, Med, Ind, P S, Rec, (S) (T) (U) (V) (W) (X) (Y) (Z) P

Use of well: (A) Anode, Drain, Seismic, Heat Res, Obs, Oil-gas, Recharge, Test, Unused, Withdraw, Waste, Destroyed. (D) (G) (H) (I) (J) (K) (L) (M) (N) (O) (P) (Q) (R) (S) (T) (U) (V) (W) (X) (Y) (Z) W

DATA AVAILABLE: Well data Freq. W/L meas.: Field aquifer char. 2

Hyd. lab. data:

Qual. water data; type:

Freq. sampling: Pumpage inventory: yes no; period:

Aperture cards: yes

Log data: E-109 7' - 14/9 DE

WELL-DESCRIPTION CARD

SAME AS ON MASTER CARD Depth well: 1405 ft Meas. rept 3

Depth cased: (first perf.) 1355 ft Casing type: ; Diam. 8x6 in accuracy 8

Finish: (C) concrete, (F) porous gravel w. (perf.), (G) gravel w. (screen), (H) horiz. open gallery, end, (I) open perf., (J) screen, (K) sd. pt., (L) shored, (M) open hole, (N) other (O) (P) (Q) (R) (S) (T) (U) (V) (W) (X) (Y) (Z) 5

Method: (A) air bored, (B) cable, (C) dug, (D) hyd jetted, (E) rot., (F) percussion, (G) rotary, (H) air reverse, (I) trenching, (J) driven, (K) wash, (L) other (M) (N) (O) (P) (Q) (R) (S) (T) (U) (V) (W) (X) (Y) (Z) 4

Date Drilled: 12-10-1971 971 Pump intake setting: ft

Driller: Singer Layne Central, Memphis

Lift (type): (A) air, bucket, cent, jet, (B) multiple, (C) multiple, (D) none, (E) piston, (F) rot, (G) submerg, (H) turb, (I) other (J) (K) (L) (M) (N) (O) (P) (Q) (R) (S) (T) (U) (V) (W) (X) (Y) (Z) T Deep Shallow 40

Power (type): (A) diesel, elec, gas, gasoline, hand, gas, wind; H.P. 20 V Trans. or meter no.

Descrip. MP ft above below LSD, Alt. MP

Alt. LSD: 165 Accuracy: (source) 20' cont. interval 5

Water Level: ft above below MP; ft above below LSD +16 Accuracy: D

Date meas: 172 Yield: 330 m test 300 gpm Method determined

Drawdown: ft Accuracy: 0 Pumping period: hrs

QUALITY OF WATER DATA: Iron ppm Sulfate ppm Chloride ppm Hard. ppm

Sp. Conduct K x 10 Temp. °F Date sampled

Taste, color, etc.

✓
DEC 10 1974

Well No. A 15

Well No. A 15

PUNCHED

Latitude-longitude _____
d m s d m s

HYDROGEOLOGIC CARD

Physiographic Province: 03 Section: _____

Drainage Basin: E Subbasin: _____

Topo of well site: (D) depression, stream channel, dunes, (F) flat, hilltop, sink, swamp, (G) offshore, pediment, hillside, terrace, undulating, valley flat. F

MAJOR AQUIFER: system _____ series T.E aquifer, formation, group L.W

Lithology: _____ Origin: 2 Aquifer Thickness: ≥ 110 ft

Length of well open to: _____ ft 50 Depth to top of: 1310 ft

MINOR AQUIFER: system _____ series _____ aquifer, formation, group _____

Lithology: _____ Origin: _____ Aquifer Thickness: _____ ft

Length of well open to: _____ ft _____ Depth to top of: _____ ft

Intervals Screened: _____

Depth to consolidated rock: _____ ft _____ Source of data: _____

Depth to basement: _____ ft _____ Source of data: _____

Surficial material: _____ Infiltration characteristics: _____

Coefficient Trans: 110,000 gpd/ft. 1.14 Coefficient Storage: _____

Coefficient Perm: 1000 gpd/ft.²; Spec cap: 17 gpm/ft.; Number of geologic cards: _____

See well A 10 for location

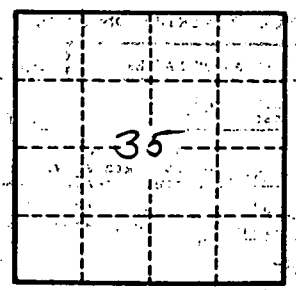
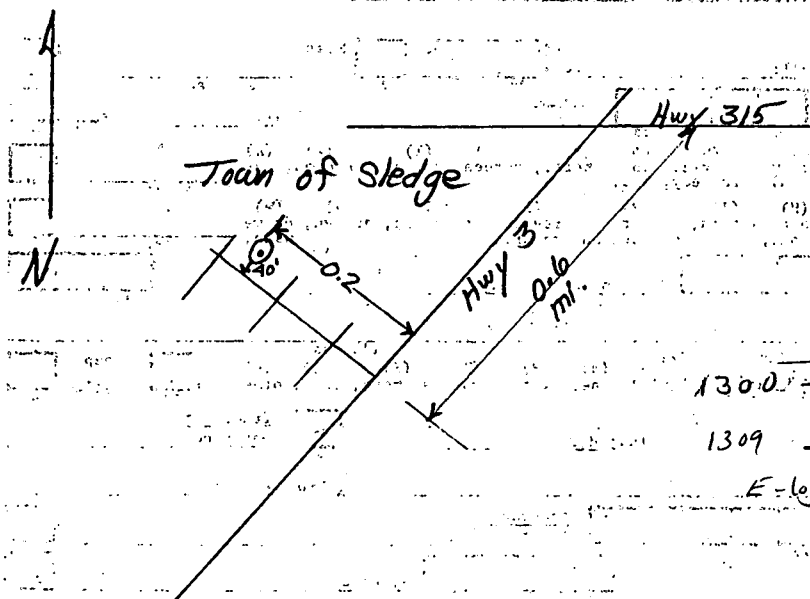

Driller's log
130.0 - 130.9 Hardshale
1309 - 1410 SAND
E-log shows sand to bottom (1419')

8 1/2 hr. pumping test by driller
5-30-92
static water level = +20'
305 gpm by orifice
22' of dd
Specific Capacity = 14 gpm/ft. of dd