

WELL SCHEDULE

U. S. DEPT. OF THE INTERIOR

- GEOLOGICAL SURVEY

WATER RESOURCES DIVISION

PUNCHED

PUNCHED and VERIFIED  
ROLLA COMPUTATION BRANCH

MASTER CARD

Record by M Smith Source of data \_\_\_\_\_ Date 8/70 Map \_\_\_\_\_

State 28 County Quitman 60

Latitude: 34<sup>deg</sup> 26<sup>min</sup> 16<sup>sec</sup> N Longitude: 09<sup>degrees</sup> 01<sup>min</sup> 30<sup>sec</sup> W Sequential number: 1

Lat-long accuracy: 3 T 7 S R 10 E Sec 35 t, SW t, NE t B & M

Local well number: A0106A3507S10W Other number: \_\_\_\_\_

Local use: 064 Owner or name: Town of Sledge

Owner or name: SLEDGE Address: \_\_\_\_\_

Ownership: County, Fed Gov't, City, Corp or Co, Private, State Agency, Water Dist M

Use of water: (A) Air cond, Bottling, Comm, Dewater, Power, Fire, Dom, Irr, Med, Ind, P S, Rec, (S) Stock, Inatit, Unused, Reppure, Recharge, Desal-P S, Desal-other, Other P

Use of well: (A) Anode, Drain, Seismic, Heat Res, Obs, Oil-gas, Recharge, Test, Unused, Withdraw, Waste, Destroyed. W

DATA AVAILABLE: Well data  Freq. W/L meas.:  Field aquifer char:

Hyd. lab. data:

Qual. water data; type: USGS 3/71

Freq. sampling: 0 Pumpage inventory:  yes no: period: \_\_\_\_\_

Aperture cards:  yes

Log data:

✓  
DEC 10 1974  
MT

WELL-DESCRIPTION CARD

SAME AS ON MASTER CARD

Depth well: 1480 ft Meas. rept accuracy 6

Depth cased; (first perf.): 1400 ft Casing type: \_\_\_\_\_; Diam. in 8

Finish: (C) porous concrete, (F) gravel w. (perf.), (G) gravel w. (screen), (H) horiz. gallery, (I) open end, (P) perf., (S) screen, (T) sd. pt., (W) shored, (X) open hole, (Y) other S

Method: (A) air rot, (B) bored, (C) cable, (D) dug, (H) hyd rot., (J) jetted, (P) air percussion, (R) reverse, (T) trenching, (V) driven, (W) drive wash, (X) other H

Date Drilled: 960 Pump intake setting: \_\_\_\_\_ ft

Driller: Layne name (L) (M) address \_\_\_\_\_

Lift (type): (A) air, (B) bucket, (C) cent, (J) jet, (L) multiple, (M) multiple, (N) nose, (P) piston, (R) rot, (S) submerg, (T) turb, other 7 Deep  Shallow

Power (type): diesel, elec, gas, gasoline, hand, gas, wind; H.P. 20  Trans. or meter no. \_\_\_\_\_

Descrip. MP \_\_\_\_\_ ft above \_\_\_\_\_ ft below LSD, Alt. MP \_\_\_\_\_

Alt. LSD: 167 Accuracy: (source) 3

Water Level: \_\_\_\_\_ ft above \_\_\_\_\_ ft below MP; \_\_\_\_\_ ft below LSD +12 Accuracy: \_\_\_\_\_

Date meas: 972 Yield: \_\_\_\_\_ gpm 310 Method determined \_\_\_\_\_

Drawdown: \_\_\_\_\_ ft Accuracy: \_\_\_\_\_ Pumping period \_\_\_\_\_ hrs

QUALITY OF WATER DATA: Iron \_\_\_\_\_ ppm Sulfate \_\_\_\_\_ ppm Chloride \_\_\_\_\_ ppm Hard. \_\_\_\_\_ ppm

Sp. Conduct 600 K x 10<sup>6</sup> 4 Temp. 26 °F 260 Date sampled 3-10-71 371

Taste, color, etc. \_\_\_\_\_

Well No. A10

Well No. A10

Latitude-longitude \_\_\_\_\_ N \_\_\_\_\_ S \_\_\_\_\_ d \_\_\_\_\_ m \_\_\_\_\_ s

**HYDROGEOLOGIC CARD**

SAME AS ON MASTER CARD: Physiographic Province: 03 Section: \_\_\_\_\_  
 Drainage Basin: E Subbasin: 1 SE  
 Topo of well site: (D) depression, stream channel, dunes, flat, hilltop, sink, swamp, (E) (F) (R) (K) (L) (M) (N) (O) (P) (Q) (T) (U) (V) offshore, pediment, hillside, terrace, undulating, valley flat  
 MAJOR AQUIFER: system \_\_\_\_\_ series TE aquifer, formation, group LW  
 Lithology: US Origin: 2 Aquifer Thickness: \_\_\_\_\_ ft  
 Length of well open to: \_\_\_\_\_ ft Depth to top of: \_\_\_\_\_ ft  
 MINOR AQUIFER: system \_\_\_\_\_ series \_\_\_\_\_ aquifer, formation, group \_\_\_\_\_  
 Lithology: \_\_\_\_\_ Origin: \_\_\_\_\_ Aquifer Thickness: \_\_\_\_\_ ft  
 Length of well open to: \_\_\_\_\_ ft Depth to top of: \_\_\_\_\_ ft  
 Intervals Screened: \_\_\_\_\_  
 Depth to consolidated rock: \_\_\_\_\_ ft Source of data: \_\_\_\_\_  
 Depth to basement: \_\_\_\_\_ ft Source of data: \_\_\_\_\_  
 Surficial material: \_\_\_\_\_ Infiltration characteristics: \_\_\_\_\_  
 Coefficient Trans: \_\_\_\_\_ gpd/ft Coefficient Storage: \_\_\_\_\_  
 Coefficient Perm: \_\_\_\_\_ gpd/ft<sup>2</sup>; Spec cap: 26 gpm/ft; Number of geologic cards: \_\_\_\_\_

2 hr. test by driller WL = +26 (1960) rpt.  
 9-25-72  
 static water level = +1 1/2'  
 12' of dd @ 310 gpm  
 Specific capacity = 2.6 gpm/ft of dd  
 Town of Stodge

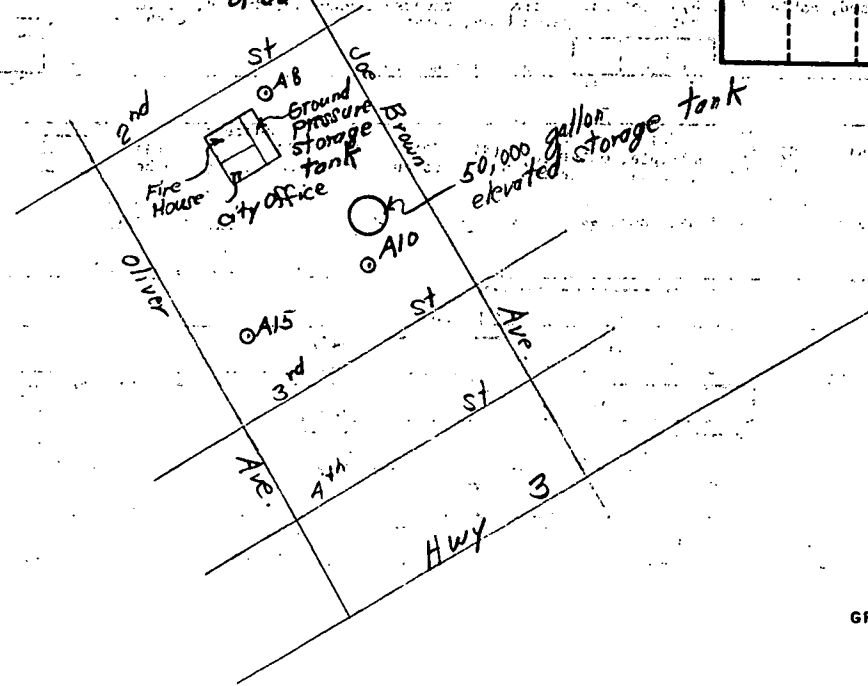
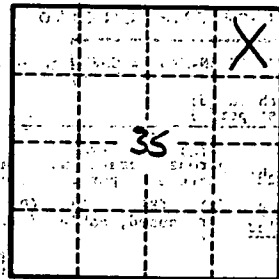

Well No. A10