

Plugged

Fulton NE

FORM 9-1642 (1-68)

Well No. M 19

WELL SCHEDULE  
GEOLOGICAL SURVEY

Ely #64

**PUNCHED**

U. S. DEPT. OF THE INTERIOR

WATER RESOURCES DIVISION

NOV 18 1972

MASTER CARD

WL Data  
11/17/82  
NL = 7.84  
1987  
WL = 7.78

Record by \_\_\_\_\_ Source of data \_\_\_\_\_ Date \_\_\_\_\_ Map \_\_\_\_\_

State \_\_\_\_\_ County (or town) \_\_\_\_\_ 59

Latitude: 34 29 11 N Longitude: 0 8 8 20 52 Sequential number: 1

Lat-long accuracy: 2 T 7 N 9 S 9 W NE NE NE SE

Local well number: M 019 A D 0907509 E Other number: \_\_\_\_\_

Local use: 064 Owner or name: \_\_\_\_\_ Address: \_\_\_\_\_

Ownership: County, Fed Gov't, City, Corp or Co, Private, State Agency, Water Dist F

Use of water: Air cond, Bottling, Comm, Devater, Power, Fire, Dom, Irr, Med, Ind, P S, Rec, Stock, Inscit, Unused, Repressure, Recharge, Desal-P S, Desal-other, Other V

Use of well: Anode, Drain, Seismic, Heat Res, Obs, Oil-gas, Recharge, Test, Unused, Withdraw, Waste, Destroyed. 4

DATA AVAILABLE: Well data 30 Freq. W/L meas.: M Field aquifer char. 72

Hyd. lab. data: \_\_\_\_\_ 73

Qual. water data; type: USGS 74

Freq. sampling: \_\_\_\_\_ Pumpage inventory: \_\_\_\_\_ 76

Aperture cards: \_\_\_\_\_ 77

Log data: \_\_\_\_\_ D E 78 79

← SE/NE on Plugging Affidavit

P/A 10/10/90

WELL-DESCRIPTION CARD

SAME AS ON MASTER CARD Depth well: \_\_\_\_\_ ft 410 Meas. rept \_\_\_\_\_ 24

Depth cased; (first perf.) \_\_\_\_\_ ft 35 Casing type: PVC; Diam. in \_\_\_\_\_ 4

Finish: porous concrete, gravel w. (screen), gravel w. (turb.), horis. gallery, open end, open perf., screen, sd. pt., shored, open hole, other 5

Method: Drilled: air bored, cable, dug, rot., hyd jetted, percussion, rotary, air reverse trenching, driven, drive wash, other H

Date Drilled: \_\_\_\_\_ Pump intake setting: \_\_\_\_\_ ft \_\_\_\_\_ 38

Driller: \_\_\_\_\_

Lift (type): (A) air, (B) bucket, (C) cent. jct, (J) multiple, (M) multiple, (N) nose, (P) piston, (R) rot., (S) submerg, (T) turb, other \_\_\_\_\_ Deep \_\_\_\_\_ Shallow \_\_\_\_\_

Power (type): diesel, elec, gas, gasoline, hand, gas, wind; H.P. \_\_\_\_\_ Trans. or meter no. \_\_\_\_\_

Descrip. MP OK (11/89) above \_\_\_\_\_ ft below LSD, Alt. MP \_\_\_\_\_

Alt. LSD: 324 Accuracy: \_\_\_\_\_ 47

Water Level 8.51 ft above \_\_\_\_\_ below MP \_\_\_\_\_ Ft below LSD \_\_\_\_\_ Accuracy: \_\_\_\_\_ 52

Date meas: \_\_\_\_\_ Yield: 0.72 gpm \_\_\_\_\_ 20 Method determined \_\_\_\_\_ 61

Drawdown: \_\_\_\_\_ ft \_\_\_\_\_ Accuracy: \_\_\_\_\_ Pumping period \_\_\_\_\_ hrs \_\_\_\_\_ 68

QUALITY OF WATER DATA: Iron \_\_\_\_\_ Sulfate \_\_\_\_\_ Chloride \_\_\_\_\_ Hard. \_\_\_\_\_ 72

Sp. Conduct <50 K x 10<sup>6</sup> \_\_\_\_\_ Temp. 68 °F \_\_\_\_\_ Date sampled \_\_\_\_\_ 572 77

Taste, color, etc. Red Water + sand pH = 6.0

Well No.

**HYDROGEOLOGIC CARD**

RECORDED

Physiographic Province: 03 Section: \_\_\_\_\_

Drainage Basin: D Subbasin: 13B

Topo of well site: (D) (C) (E) (F) (H) (K) (L) (P) (S) (T) (U) (V) F  
depression, stream channel, dunes, flat, hilltop, sink, swamp, offshore, pediment, hillside, terrace, undulating, valley flat

MAJOR AQUIFER: system \_\_\_\_\_ series K-3 aquifer, formation, group G-φ

Lithology: Q-G Origin: 2 Aquifer Thickness: \_\_\_\_\_ ft

Length of well open to: 22 ft 020 ft Depth to top of: 5 ft 23 ft

MINOR AQUIFER: system \_\_\_\_\_ series \_\_\_\_\_ aquifer, formation, group \_\_\_\_\_

Lithology: \_\_\_\_\_ Origin: \_\_\_\_\_ Aquifer Thickness: \_\_\_\_\_ ft

Length of well open to: \_\_\_\_\_ ft Depth to top of: \_\_\_\_\_ ft

Intervals Screened: \_\_\_\_\_

Depth to consolidated rock: \_\_\_\_\_ ft Source of data: \_\_\_\_\_

Depth to basement: \_\_\_\_\_ ft Source of data: \_\_\_\_\_

Surficial material: \_\_\_\_\_ Infiltration characteristics: \_\_\_\_\_

Coefficient Trans: \_\_\_\_\_ spd/ft Coefficient Storage: \_\_\_\_\_

Coefficient Perm: \_\_\_\_\_ spd/ft<sup>2</sup> Spec cap: \_\_\_\_\_ gpm/ft; Number of geologic cards: \_\_\_\_\_

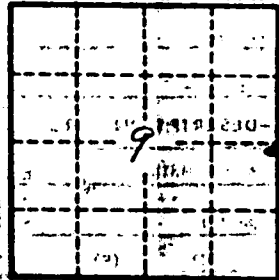
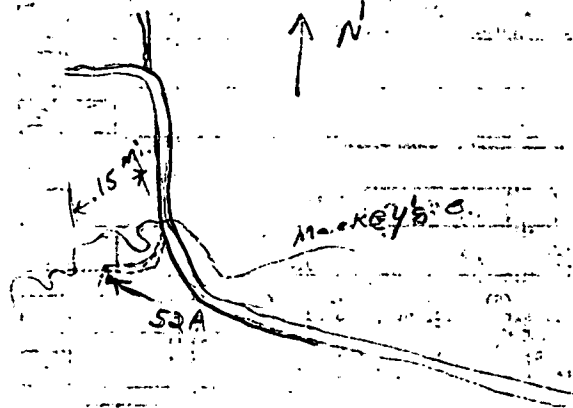

- 0-5 Clay
- 5-15 sand white
- 15-40 Gravel
- 40-50 Clay/gravel
- 50-78.5 Clay-gray
- 78.5-78.9 Rock-hard

Well No. M19

MISSISSIPPI DEPARTMENT OF ENVIRONMENTAL QUALITY  
Bureau of Land and Water Resources

P.O. Box 10631  
Jackson, Mississippi 39289-0631  
WATER WELL PLUGGING  
DECOMMISSIONING

COUNTY WELL LOCATED PRENTISS	
WELL NUMBER 52 A	CODED
DATE WELL PLUGGED 10-16-90	

PERMIT NUMBER
NAME OF DRILLING FIRM

NAME & MAILING ADDRESS OF LANDOWNER U.S. ARMY CORPS OF ENG DIST. MOBILE P.O. BOX 2288 MOBILE AL 36628			
WELL LOCATION	SEC	TOWNSHIP	RANGE
SENE S09T075R09E			
DISTANCE	DIRECTION	NEAREST TOWN	
OTHER LANDMARK WEST OF MOBILE MILL			
WELL PURPOSE: Home, Irrigation, Municipal, Industrial, Fish Pond, etc GROUND WATER STUDY			

NAME OF WELL CONTRACTOR WHO DRILLED THE WELL		
NAME OF LANDOWNER WHEN WELL WAS DRILLED		
WELL DATA		
Well Depth 40'	Casing Diameter (In.) 4"	Casing Length (Ft.) .
Type of Casing PVC	Hole Depth	Depth to Static Water Level 8.0 Ground Surface
DATE WELL COMPLETED 10-16-90		

DESCRIBE HOW THE WELL OR HOLE WAS PLUGGED (AMOUNT OF CASING AND/OR SCREEN THAT WAS REMOVED, OR LEFT IN HOLE. MATERIAL USED IN PLUGGING, ETC.)
PORTLAND CEMENT MIX 1 BAG CEMENT TO 5.5 GALLONS WATER
PUMPED 4 BAGS 4.8 CF GROUT MIXTURE
CUT 6" PROTECTOR PIPE AND 4" PVC RISER PIPE FLUSH WITH GROUND
CUT GUARD POST FLUSH WITH SURFACE - LEFT SCREEN WITH RISER
PIPE IN HOLE

I CERTIFY THAT THE WELL WAS PLUGGED OR ABANDONED IN ACCORDANCE WITH THE STATE OF MISSISSIPPI REGULATIONS	
<u>James Childers</u> SIGNATURE	10-16-90 DATE

# FULTON NE QUAD

