

UNITED STATES
DEPARTMENT OF THE INTERIOR
GEOLOGICAL SURVEY
WATER RESOURCES DIVISION

WELL SCHEDULE

Date April 12, 1959 Field No. 180
Record by B. E. ELISON Office No. L-43
Source of data E. L. CANNISS, OWNER

1. Location: State Miss County Prentiss
Map

NW 1/4 NW 1/4 sec. 36 T 6 N R 8 E
W

2. Owner: E. L. Canniss Address Marietta

Tenant _____ Address _____

Driller Norville Address Canniss

3. Topography creek bottom

4. Elevation 340 ft. above _____
below _____

5. Type: Dug, drilled, driven, bored, jetted _____ 1951

6. Depth: Rept. 180 ft. Meas. _____ ft.

7. Casing: Diam. 4 in., to _____ in., Type _____

Depth 80 ft., Finish open

8. Chief Aquifer RE From _____ ft. to _____ ft.

Others _____

9. Water level 15 ft. rept. 19.59 above _____
meas. below _____

which is _____ ft. above surface
below _____

10. Pump: Type 9 ft Capacity _____ G. M.

Power: Kind Electric Horsepower _____

11. Yield: Flow _____ G. M., Pump _____ G. M., Meas., Rept. Est.

Drawdown _____ ft. after _____ hours pumping _____ G. M.

12. Use: Dom. Stock, PS., RR., Ind., Irr., Obs.

Adequacy, permanence plenty

13. Quality good Temp _____ °F.

Taste, odor, color _____ Sample Yes _____ No _____

Unfit for _____

14. Remarks: (Log, Analyses, etc.) well filled with sand
easily owned considering digging
a well

N.

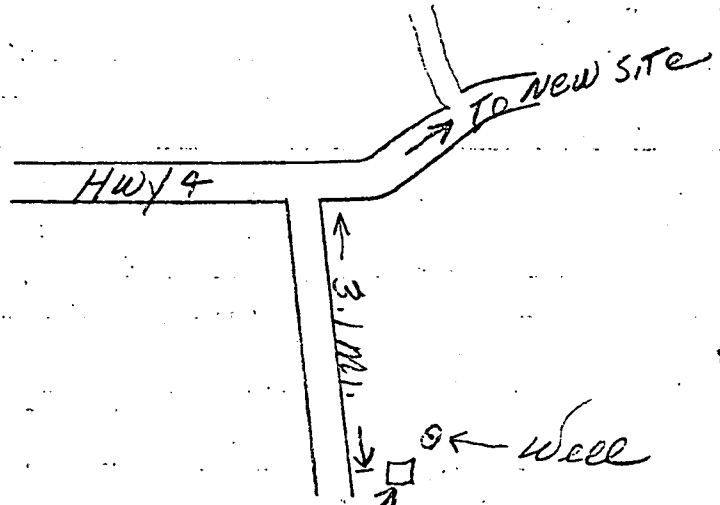
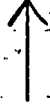

Tracy Creek - walking down

MARIETTA QUAD

