

Baldwyn

FORM 9-1642 (1-68)

W. J84

WELL SCHEDULE

PUNCHED

U. S. DEPT. OF THE INTERIOR

GEOLOGICAL SURVEY

WATER RESOURCES DIVISION

DEC 27 1972

MASTER CARD

Record by \_\_\_\_\_ Source of data \_\_\_\_\_ Date 10-70 Map \_\_\_\_\_

State \_\_\_\_\_ County (or town) Prentiss \_\_\_\_\_

Latitude: 34 31 42 N Longitude: 08 8 8 4 W Sequential number: 1

Lat-long accuracy: 70 T 60 R 60 Sec 26 NE 1/4 SE 1/4

Local well number: J084DA2606S06E Other number: \_\_\_\_\_

Local use: 021 Owner or name: BALDWIN IMPLANT Address: Baldwyn

Ownership: County, Fed Gov't, City, Corp or Co, Private, State Agency, Water Dist [N]

Use of water: (S) (T) (U) (V) (W) (X) (Y) (B) [H]

Use of well: (A) (D) (G) (H) (I) (P) (R) (T) (U) (W) (X) (B) [W]

DATA AVAILABLE: Well data [ ] Freq. W/L meas.: [ ] Field aquifer char. [ ]

Hyd. lab. data: [ ]

Qual. water data; type: [ ]

Freq. sampling: [ ] Pumpage inventory: [ ]

Aperture cards: [ ]

Log data: [ ]

1982 WL=51.1

1987 WL=49.8

10/21/92 70.0 4.9 65.1 0.0 mp 65.1

10/22/72 Now s/s Used cans! U-Haul

WELL-DESCRIPTION CARD

SAME AS ON MASTER CARD Depth well: 490 ft Meas. rept accuracy 3

Depth cased: 154 ft Casing type: \_\_\_\_\_; Diam. in 4

Finish: (C) porous concrete, (F) gravel w. (perf.), (G) gravel w. (screen), (H) horiz. gallery, (I) open end, (J) open hole, (K) shored, (L) other [Y]

Method Drilled: (A) air rot, (B) bored, (C) cable, (D) dug, (E) hyd rot., (F) jetted, (G) percussion, (H) air, (I) reverse, (J) trenching, (K) driven, (L) drive wash, (M) other [H]

Date Drilled: 70 Pump intake setting: \_\_\_\_\_ ft

Driller: \_\_\_\_\_

Lift (type): (A) air, (B) bucket, (C) cent., (D) jet, (E) multiple, (F) multiple, (G) none, (H) piston, (I) rot., (J) submerg, (K) turb., (L) other [ ] Deep [ ] Shallow [ ]

Power (type): diesel, elec, gas, gasoline, hand, LP, gas, wind, H.P. [ ] Trans. or meter no. \_\_\_\_\_

Descrip. MP current at 1.0' above LSD above 350' (11/89) ft below LSD. Alt. MP 20' old

Alt. LSD: 345 Accuracy: (source) 20' old [5]

Water Level: 31.0 7-25-73 60 ft above below MP; Ft below LSD 30 Accuracy: [A]

Date: 60 - July 1963 Yield: 7.73 8pm Method determined [ ]

Drawdown: \_\_\_\_\_ ft Accuracy: \_\_\_\_\_ Pumping period: \_\_\_\_\_ hrs

QUALITY OF WATER DATA: Iron 0.16 ppm Sulfate \_\_\_\_\_ ppm Chloride \_\_\_\_\_ ppm Hard. \_\_\_\_\_ ppm

Sp. Conduct 280 K x 10<sup>6</sup> Temp. \_\_\_\_\_ °F Date sampled 7-25-73 7.73

Taste, color, etc. PH 8.0 clear, odorless

WELL NO.

Latitude-longitude  
 N  
 S  
 d m s d m s

HYDROGEOLOGIC CARD

SAME AS ON MASTER CARD  
 Physiographic Province: 0:3 Section: \_\_\_\_\_  
 Drainage Basin: 13:B Subbasin: \_\_\_\_\_  
 Topo of well site: (D) depression, stream channel, dunes, flat, hilltop, sink, swamp, (E) (F) (H) (K) (L) (M) (P) (S) (T) (U) (V) offshore, pediment, hillside, terrace, undulating, valley flat \_\_\_\_\_  
 MAJOR AQUIFER: system \_\_\_\_\_ series H3 aquifer, formation, group EZ  
 Lithology: \_\_\_\_\_ Origin: 6 Aquifer Thickness: 140 ft  
 Length of well open to: \_\_\_\_\_ ft 140 Depth to top of: \_\_\_\_\_ ft 300  
 MINOR AQUIFER: system \_\_\_\_\_ series \_\_\_\_\_ aquifer, formation, group \_\_\_\_\_  
 Lithology: \_\_\_\_\_ Origin: \_\_\_\_\_ Aquifer Thickness: \_\_\_\_\_ ft  
 Length of well open to: \_\_\_\_\_ ft \_\_\_\_\_ Depth to top of: \_\_\_\_\_ ft \_\_\_\_\_  
 Intervals Screened: \_\_\_\_\_  
 Depth to consolidated rock: \_\_\_\_\_ ft \_\_\_\_\_ Source of data: \_\_\_\_\_  
 Depth to basement: \_\_\_\_\_ ft \_\_\_\_\_ Source of data: \_\_\_\_\_  
 Surficial material: \_\_\_\_\_ Infiltration characteristics: \_\_\_\_\_  
 Coefficient Trans: \_\_\_\_\_ gpd/ft \_\_\_\_\_ Coefficient Storage: \_\_\_\_\_  
 Coefficient Perm: \_\_\_\_\_ gpd/ft<sup>2</sup>; Spec csp: \_\_\_\_\_ gpm/ft; Number of geologic cards: \_\_\_\_\_

Submersible Pump on north side of Bldg.

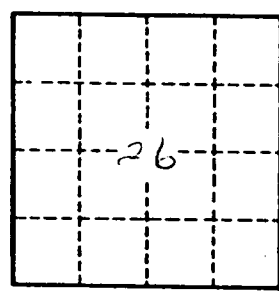
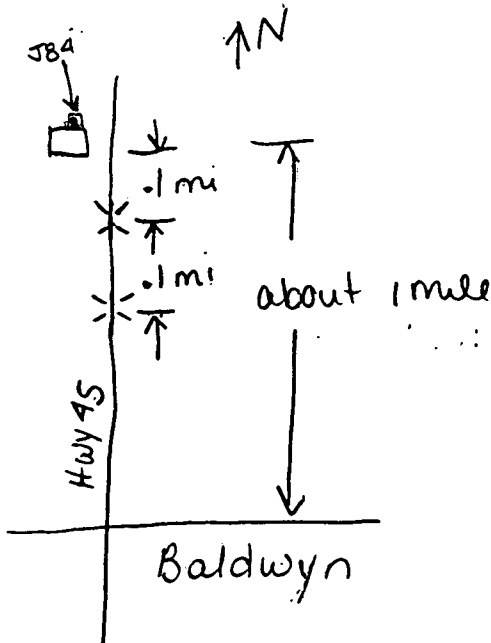

Well No. 184

Observation Well

County Pratt

Well No. J 84

Owner's Name Baldwyn Implement Co.

Location Baldwyn  
(town)

1.7 mi N on west side of US Highway 45  
(miles and direction from center of town)

Other description \_\_\_\_\_

Depth 440 Diameter 4 Date drilled 1970

Formation Eutaw

Elev. of lsd \_\_\_\_\_ Recorder \_\_\_\_\_ Type \_\_\_\_\_ No. \_\_\_\_\_

M.P. Top of 3/8 in vent at 1.5 ft above below lsd. Date 4/9/76

M.P. \_\_\_\_\_ at \_\_\_\_\_ ft above below lsd. Date \_\_\_\_\_

M.P. \_\_\_\_\_ at \_\_\_\_\_ ft above below lsd. Date \_\_\_\_\_

Special \_\_\_\_\_

Water Level 37 - 1976?

Sketch of location

Sketch of well head

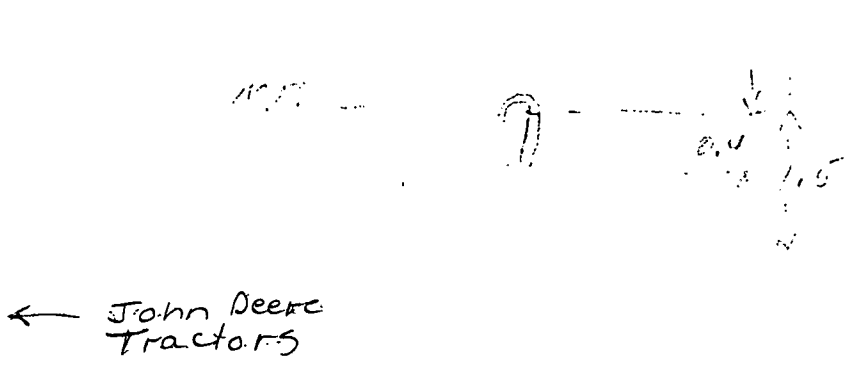
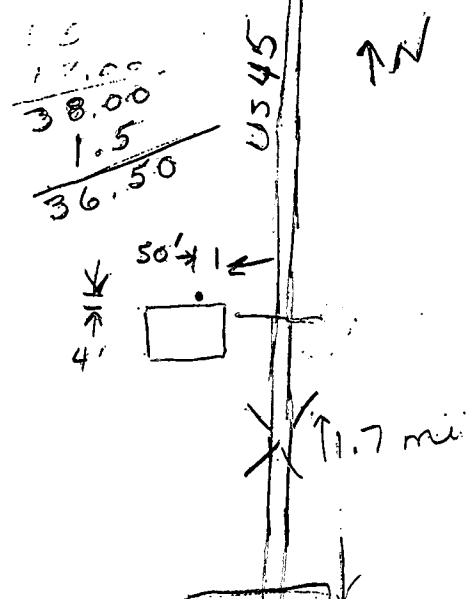

**CODED**

JTB GA  
7-16-63

**WATER WELL DRILLERS LOG**

Date: 7/16, 1963, Driller: INDIAN WELLS & SUPPLY CO County Prentiss

(1) Owner of Land (Name) (Address)	Description & Color of Materials Sand, Clay, Red Clay, Shell, etc.	Thick- ness Feet	Depth Feet
<u>Baldwyn Excavator Co.</u> <u>Baldwyn, Miss.</u>	<u>surface sand</u> <u>&amp; clay</u>		<u>0</u>
(2) Location: <u>1/4</u> , <u>1/4</u> , Sec. <u>26 63E</u> T <u>68E</u> R <u>6E</u>	<u>Blue rock</u>		<u>155</u>
<u>1</u> miles <u>N</u> of <u>Baldwyn</u> (distance) (direction) (Nearest Town)	<u>Sand</u>		<u>300</u>
(3) Topography: <u>flat</u> (Hill) (Flat) (Level)	<u>Bottom</u>		<u>440</u>
(4) Purpose of Well: <u>Domestic</u> (Domestic Irrigation Municipal, Industrial, Other)			

Information upon completion of well:

- (1) Diameter 4 inches.
- (2) Total Depth 440 feet.
- (3) Water Level 60 feet below top of ground.
- (4) Cased to 155', Size 4"
- (5) Screen: Size —, Length —
- (6) Were any formations sealed against pollution?  
 yes,  no.

If YES depth of formation 155'  
Why surface & sand

Drillers Remarks: \_\_\_\_\_

**CODED**

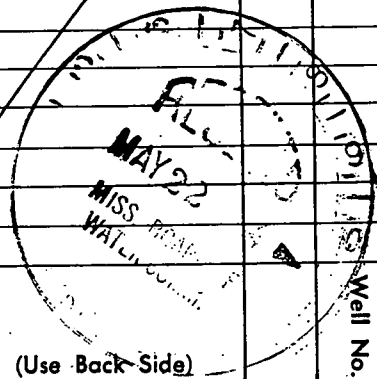

(Use Back Side)

Mail this copy to Board of Water Commissioners 429 Miss. St. Jackson, Miss.

# BALDWIN QUAD

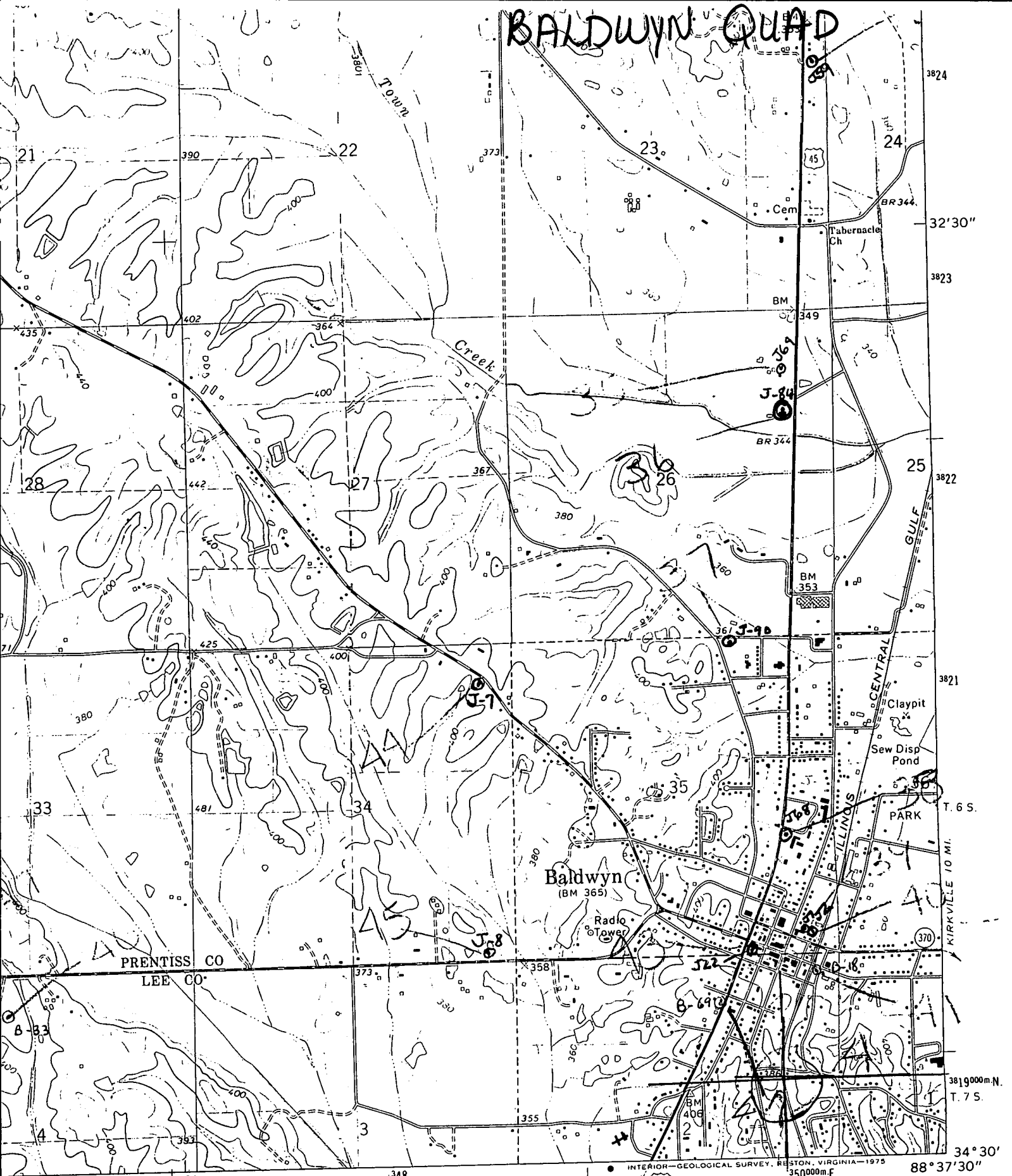

PRENTISS CO  
LEE CO

GUNTOWN 4.5 MI.  
TUPELO 17 MI.

INTERIOR—GEOLOGICAL SURVEY, RESTON, VIRGINIA—1975

## ROAD CLASSIFICATION

- Primary highway, hard surface
- Secondary highway, hard surface
- Light-duty road, hard or improved surface
- Unimproved road
- Interstate Route
- U. S. Route
- State Route

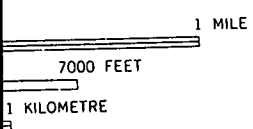

(RATLIF 352) 1 INE