

9-185
(October 1950)

UNITED STATES
DEPARTMENT OF THE INTERIOR
GEOLOGICAL SURVEY
WATER RESOURCES DIVISION

WELL SCHEDULE

Date April 28, 1959 Field No. 229
Record by B. E. ELLISON Office No. F-36
Source of data Mrs. W. E. COX, Sr., Wife

1. Location: State MISS County PRENTISS

Map NE 1/4 SE 1/4 sec. 30 T 5 N R 7 E
W

2. Owner: W. E. COX, Sr. Address Booneville

Tenant _____ Address Ret

Driller LIVINGSTON Address _____

3. Topography Creek bottom

4. Elevation 380 ft. above TAPO below _____

5. Type: Dug, drilled, driven, bored, jetted _____ 1947

6. Depth: Rept. 180 ft. Meas. _____ ft.

7. Casing: Diam. 4 in., to _____ in., Type _____

Depth _____ ft., Finish _____

8. Chief Aquifer Coarse sand (lower) From _____ ft. to _____ ft.

Others _____

9. Water level + ft. rept. 1959 above below _____

which is _____ ft. above below surface

10. Pump: Type jet Capacity _____ G. M.

Power: Kind Electric Horsepower _____

11. Yield: Flow _____ G. M., Pump _____ G. M., Meas., Rept. Est. _____

Drawdown _____ ft. after _____ hours pumping _____ G. M.

12. Use: Dom., Stock, PS., RR., Ind., Irr., Obs.

Adequacy, permanence Plenty

13. Quality good Temp _____ °F.

Taste, odor, color _____ Sample Yes No _____

Unfit for _____

14. Remarks: (Log, Analyses, etc.) This is a flowing well when pump not running

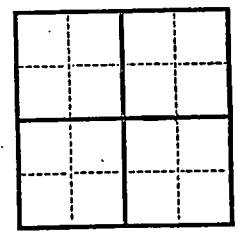

UNITED STATES
 DEPARTMENT OF THE INTERIOR
 GEOLOGICAL SURVEY
 WATER RESOURCES DIVISION

9-122
 (1030)

Boonville

Well No. _____
 Date of _____
 Field No. _____
 Office No. _____

Remarks by _____

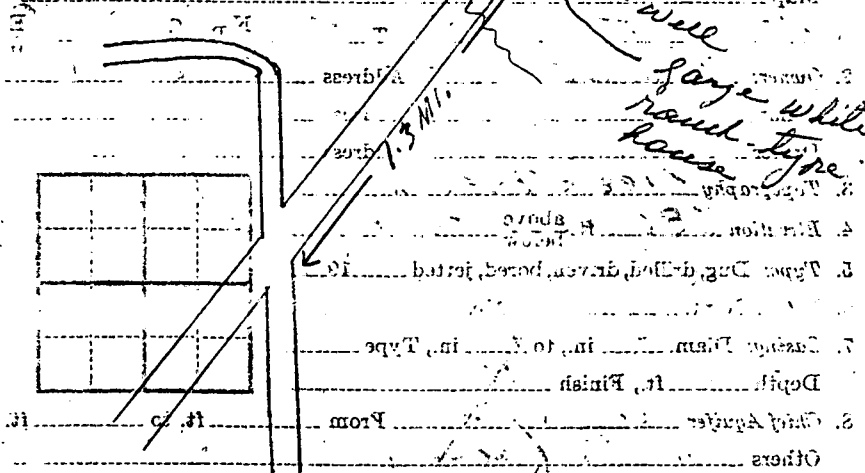

9. Water level _____ ft. _____
 _____ ft. _____
 _____ ft. _____
 _____ ft. _____

10. Pump type _____

11. Motor _____

12. _____

13. _____

14. _____

15. _____

16. _____

17. _____

18. _____

19. _____

20. _____

WHEELER QUAD

