

Wheeler

FORM 9-1642 (1-68)

Well No. F 36

WELL SCHEDULE
GEOLOGICAL SURVEY

U. S. DEPT. OF THE INTERIOR

DEC 27 1972
WATER RESOURCES DIVISION

PUNCHED

MASTER CARD

Record by B. E. Eddins Source of data owner Date 4-28-59 Map 70 p.m.

State 28 County (or town) 59

Latitude: 34 37 01 N Longitude: 08 8 35 44 Sequential number: 1

Lat-long accuracy: 1 5 5 R 7 W, Sec 30, SW t., NE t., SE t.

Local well number: F036AD3005S07E Other number: B & H

Local use: W, E, Coy Owner or name: W, E, Coy

Owner or name: W, E, COX Address: Rt 2 - Boonville

Ownership: County, Fed Gov't, City, Corp or Co, Private, State Agency, Water Dist P

Use of water: (A) Air cond, (B) Bottling, (C) Comm, (D) Dewater, (E) Power, (F) Fire, (G) Dom, (H) Irr, (I) Med, (J) P S, (K) Rec, (L) Stock, (M) Instit, (N) Unused, (O) Reprussure, (P) Recharge, (Q) Desal-P S, (R) Desal-other, (S) Other H

Use of well: (A) Anode, (B) Drain, (C) Seismic, (D) Heat Res, (E) Obs, (F) Oil-gas, (G) Recharge, (H) Test, (I) Unused, (J) Withdraw, (K) Waste, (L) Destroyed. W

DATA AVAILABLE: Well data Freq. W/L meas: Field aquifer char.

Hyd. lab. data:

Qual. water data; type:

Freq. sampling: Pumpage inventory: yes no; period:

Aperture cards: yes

Log data:

WELL-DESCRIPTION CARD

SAME AS ON MASTER CARD Depth well: 180 ft 180 Meas. rept accuracy 6

Depth cased; (first perf.) ft Casing type: ; Diam. 4 in 4

Finish: porous concrete, gravel w. (perf.), (screen), gravel w. (screen), horiz. open end, (P) perf., (S) screen, (T) sd. pt., (W) shored, (X) open hole, (Y) other X

Method Drilled: (A) air rot., (B) bored, (C) cable, (D) dug, (E) hyd jetted, (F) air rot., (G) percussion, (H) rotary, (I) reverse, (J) trenching, (K) driven, (L) drive wash, (M) other H

Date Drilled: 9-4-7 Pump intake setting: ft

Driller: Livingston name address

Lift (type): (A) air, (B) bucket, (C) cent., (D) jet, (E) multiple, (F) multiple, (G) none, (H) piston, (I) rot., (J) submerg, (K) turb., (L) other J Deep S Shallow S

Power (type): (A) diesel, (B) elec, (C) gas, (D) gasoline, (E) hand, (F) gas, (G) wind, (H) H.P., (I) LP, (J) Trans. or meter no. S

Descrip. MP 376' (12/89) ft above below LSD, Alt. MP

Alt. LSD: 380 Accuracy: (source) Topo

Water Level: -1.0 ft above below MP; Ft below LSD F Accuracy: -1.0

Date meas: 11-15-73 Yield: 379 gpm Method determined A

Drawdown: ft Accuracy: Pumping period: hrs

QUALITY OF WATER DATA: Iron ppm Sulfate ppm Chloride ppm Hard. ppm

Sp. Conduct K x 10⁶ Temp. °F Date sampled

Taste, color, etc.

Shallow well when pump first running

780 10 000

Latitude-longitude d m s N
d m s S

HYDROGEOLOGIC CARD

SAME AS ON MASTER CARD Physiographic Province: 03 Section:

D Drainage Basin: 13B Subbasin:

Topo of well site: (D) depression, (C) stream channel, (E) dunes, (F) flat, (H) hilltop, (K) sink, (L) swamp, (M) offshore, (P) pediment, (S) hillside, (T) terrace, (U) undulating, (V) valley flat 27 C

MAJOR AQUIFER: *Coffea Sands* K3 CIS

Lithology: S Origin: b Aquifer Thickness:

Length of well open to: ft Depth to top of: ft

MINOR AQUIFER: system series aquifer, formation, group

Lithology: Origin: Aquifer Thickness:

Length of well open to: ft Depth to top of: ft

Intervals Screened:

Depth to consolidated rock: ft Source of data:

Depth to basement: ft Source of data:

Surficial material: Infiltration characteristics:

Coefficient Trans: gpd/ft Coefficient Storage:

Coefficient Perm: gpd/ft² Spec cap: gpm/ft Number of geologic cards:

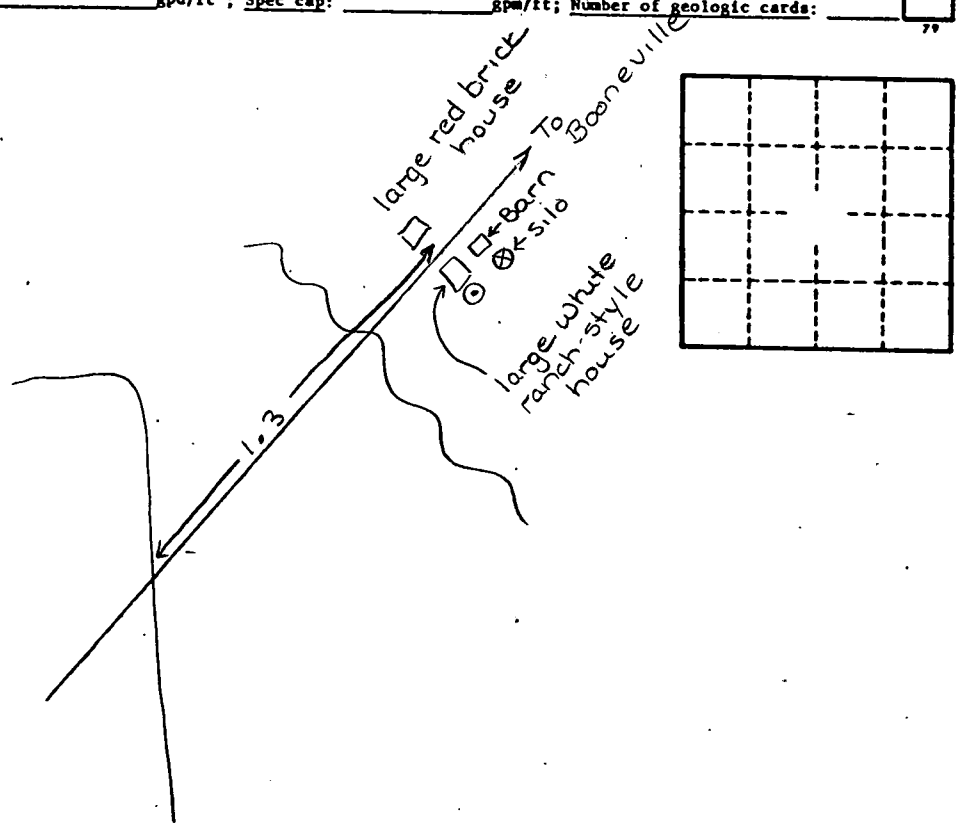

Well No.