

155

9-185
(October 1950)

UNITED STATES
DEPARTMENT OF THE INTERIOR
GEOLOGICAL SURVEY
WATER RESOURCES DIVISION

WELL SCHEDULE

Date April 8, 1959 Field No. 135
Record by B. E. ELLISON Office No. F-21
Source of data H. W. Green

1. Location: State Miss County Prentiss

Map SW 1/4 SW 1/4 sec. 32 T 5 N R 7 E
W

2. Owner: H. W. Green Address Booneville

Tenant _____ Address 104

Driller _____ Address _____

3. Topography Hill side

4. Elevation 405 ft. ^{above} 7000 _{below}

5. Type: Dug (drilled) driven, bored, jetted _____ 1959

6. Depth: Rept. 250 ft. Meas. _____ ft.

7. Casing: Diam. 4 in., to _____ in., Type _____

Depth _____ ft., Finish open

8. Chief Aquifer KC (L) From _____ ft. to _____ ft.

Others _____

9. Water level 40 ft. ^{rept.} _{meas.} _____ 1959 ^{above} _{below} surface

which is _____ ft. ^{above} _{below} surface

10. Pump: Type jet Capacity _____ G. M.

Power: Kind ELM Horsepower _____

11. Yield: Flow _____ G. M., Pump _____ G. M., Meas., Rept. Est. _____

Drawdown _____ ft. after _____ hours pumping _____ G. M.

12. Use: Dom, Stock, PS., RR., Ind., Irr., Obs. _____

Adequacy, permanence plenty

13. Quality good Temp _____ °F.

Taste, odor, color _____ Sample Yes No

Unfit for _____

14. Remarks: (Log, Analyses, etc.) _____

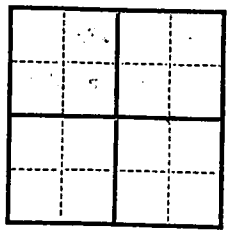

UNITED STATES
 DEPARTMENT OF THE INTERIOR
 GEOLOGICAL SURVEY
 WATER RESOURCES DIVISION

9-122
 (October 1930)

WATER RESOURCES



Boonville

1. Location: State _____

2. Name of well _____

3. Type of well _____

4. Depth _____

5. Construction _____

6. Diameter _____

7. Depth to water _____

8. Construction _____

9. Other _____

10. Pump type _____

11. Flow _____

12. Other _____

13. Other _____

14. Remarks (log, analyses, etc.) _____

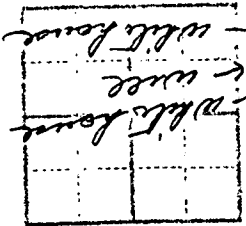
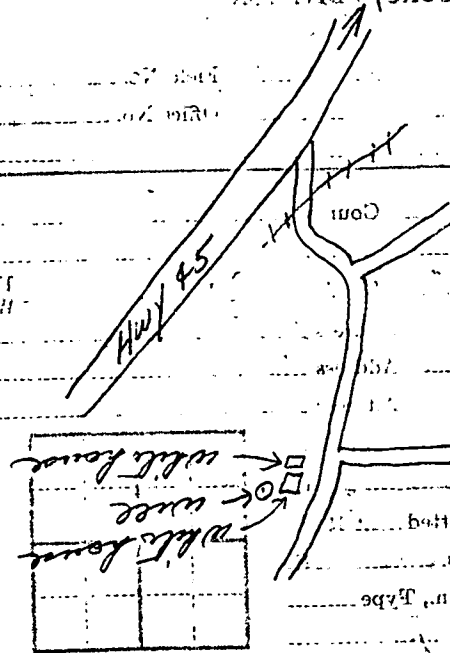

WHEELER QUAD

