

FORM 9-1642 (1-68)

Well No. E 48

WELL SCHEDULE

U. S. DEPT. OF THE INTERIOR

GEOLOGICAL SURVEY

WATER RESOURCES DIVISION

PUNCHED DEC 27 1972

MASTER CARD

Record no. B.D. Source of data Bowr Date 5-71 Mar

State 28 County (or town) Prineville 59

Latitude: 343602N Longitude: 0883815 Sequential number: 1

Lat-long accuracy: 3 degrees 5 min 0 sec 6 W, Sec 35 N, E 1 NE 1 SW

Local well number: E048AC3505506E Other number: B & M

Local use: 268 Owner or name: CHAS LOVELL Address: Beemerille

Ownership: County, Fed Gov't, City, Corp or Co, Private, State Agency, Water Dist P

Use of water: Air cond, Bottling, Comm, Dewater, Power, Fire, Dom, Irr, Med, Ind, P S, Rec, Stock, Instit, Unused, Repressure, Recharge, Desal-P S, Desal-other, Other H

Use of well: Anode, Drain, Seismic, Heat Res, Obs, Oil-gas, Recharge, Test, Unused, Withdraw, Waste, Destroyed W

DATA AVAILABLE: Well data  Freq. W/L meas.:  Field aquifer char.

Hyd. lab. data:

Qual. water data: type:

Freq. sampling:  Pumpage inventory:  period:

Aperture cards:

Log data:

WELL-DESCRIPTION CARD

SAME AS ON MASTER CARD Depth well: 150 ft Mean rept accuracy 5

Depth cased: 42 ft Casing type: Steel ; Diam. in 4

Finish: porous concrete, gravel w. (perf.), gravel w. (screen), horiz. gallery, end, horiz. open perf., screen, sd. pt., shored, open hole, other X

Method Drilled: air bored, cable, dog, hod jetted, rot., air percussion, rotary, reverse trenching, driven, drive wash, other H

Date Drilled: 9-7-71 Pump intake setting: 1 ft

Driller: Banks

Lift (type): air, bucket, cent, jet, multiple (cent.), multiple (turb.), none, piston, rot, submerg, turb, other  Deep  Shallow 40

Power (type): diesel, elec, gas, gasoline, hand, gas, wind; H.P. 1/2 5 Trans. or meter no. 5

Descrip. MP 5 ft above LSD, Alt. MP 5 ft below LSD, Alt. MP 5

Alt. LSD: 380 Accuracy: 5

Water Level: 15 ft above below MP; Fr below LSD 15 Accuracy: 5

Date meas: 4-7-71 Yield: 5 gpm Method determined 5

Drawdown: 5 ft Accuracy: 5 hrs

QUALITY OF WATER DATA: Iron ppm 5 Chloride ppm 5 Hard. ppm 5

Sp. Conduct: 5 K x 10 5 Temp. 5 °F Date sampled 5

Taste, color, etc.

Well No.

150

Latitude-longitude N  
S

HYDROGEOLOGIC CARD

SAME **PHYSIOGRAPHIC PROVINCE** Province: 03 Section: \_\_\_\_\_  
**STE 1318** Drainage Basin: 1318 Subbasin: \_\_\_\_\_

Topo of well site: (D) depression, stream channel, dunes, flat, hilltop, sink, swamp, (C) (E) (F) (H) (K) (L) (Ø) (P) (S) (T) (U) (V) offshore, pediment, hillside, terrace, undulating, valley flat \_\_\_\_\_

MAJOR AQUIFER: system \_\_\_\_\_ series R3 aquifer, formation, group: C5

Lithology: UP Origin: 6 Aquifer Thickness: 53 ft  
 Length of well open to: \_\_\_\_\_ ft 53 Depth to top of: \_\_\_\_\_ ft 97

MINOR AQUIFER: system \_\_\_\_\_ series \_\_\_\_\_ aquifer, formation, group \_\_\_\_\_

Lithology: \_\_\_\_\_ Origin: \_\_\_\_\_ Aquifer Thickness: \_\_\_\_\_ ft  
 Length of well open to: \_\_\_\_\_ ft \_\_\_\_\_ Depth to top of: \_\_\_\_\_ ft \_\_\_\_\_

Intervals Screened: \_\_\_\_\_

Depth to consolidated rock: \_\_\_\_\_ ft \_\_\_\_\_ Source of data: \_\_\_\_\_

Depth to basement: \_\_\_\_\_ ft \_\_\_\_\_ Source of data: \_\_\_\_\_

Surficial material: \_\_\_\_\_ Infiltration characteristics: \_\_\_\_\_

Coefficient Trans: \_\_\_\_\_ gpd/ft \_\_\_\_\_ Coefficient Storage: \_\_\_\_\_

Coefficient Perm: \_\_\_\_\_ gpd/ft<sup>2</sup>; Spec cap: \_\_\_\_\_ gpm/ft; Number of geologic cards: \_\_\_\_\_

*Red clay 0-39*  
*Blue clay 39-97*  
*Water pond 97-150*

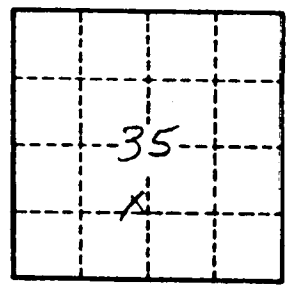

Well No. E 48

PRENTISS  
E48  
4-27-71

MISSISSIPPI  
BOARD OF WATER COMMISSIONERS  
416 North State Street  
Jackson, Mississippi 39201

**CODED**

WATER WELL DRILLERS LOG

4-27 1971 Bond Well Drilling Premier  
date well completed firm name county well located

LANDOWNER: <u>Charles Lovell</u>	description of formations encountered		from	to
<u>Boonerville Miss</u> (mailing address)	<u>Red clay</u>		<u>0</u>	<u>39</u>
	<u>Blaze Clay</u>		<u>39</u>	<u>97</u>
	<u>Water sand</u>		<u>97</u>	<u>150</u>
WELL LOCATION:				
sec <u>35</u> T <u>5</u> N R <u>6</u> E				
<div style="display: flex; justify-content: center; align-items: center;"> <div style="text-align: center; margin-right: 10px;"> <u>4</u> (distance)         </div> <div style="text-align: center; margin-right: 10px;"> <u>S.W.</u> (direction)         </div> <div style="text-align: center;"> <u>Boonerville</u> (nearest town)         </div> </div>				
WELL PURPOSE: <u>Home</u> (home, irrigation, municipal, industrial)				
WELL COMPLETION DATA:				
(1) diameter (inches) <u>4</u>				
(2) total depth (feet) <u>150</u>				
(3) static water level (feet) <u>15</u> <u>below</u> above top of ground.				
(4) casing <u>Steel</u> <u>42</u> (material) (depth)				
_____ (size) If telescope see back.				
(5) screen <u>none</u> (length) (depth to top)				
_____ (size) _____ (material)				
(6) pump <u>1/2</u> <u>5</u> (HP) (yield gpm)				
<u>electric pump</u> (type power)				
(7) electric log <u>no</u> (yes or no)				
_____ (organization running log)				
(8) how well bottom plugged <u>open</u>				
DRILLERS REMARKS:				
MISS. BD. OF WATER COMM.				

**CODED**

# BALDWIN QUAD

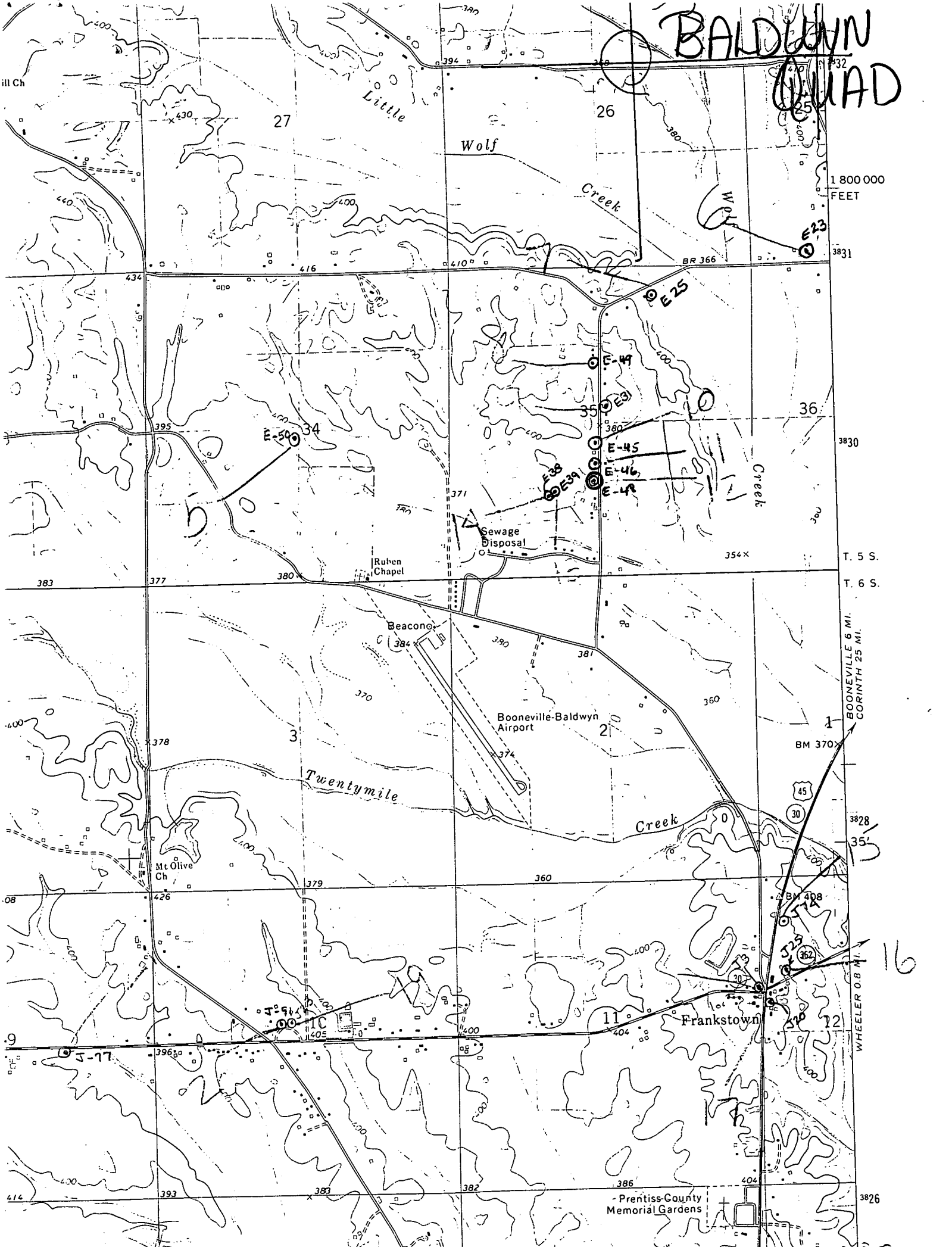

1 800 000  
FEET

T. 5 S.  
T. 6 S.

BOONEVILLE 6 MI.  
CORINTH 25 MI.

WHEELER 0.8 MI.

- Prentiss-County  
Memorial Gardens

16