

Baldwyn

FORM 9-1642 (1-68)

Well No. F 96

WELL SCHEDULE  
GEOLOGICAL SURVEY

**PUNCHED**  
WATER RESOURCES DIVISION  
**DEC 27 1972**

MASTER CARD

Record by B.D. Source of data bowc Date 9-71 Map \_\_\_\_\_

State 28 County (or town) Pennitiss 59

Latitude: 343600N Longitude: 0883825 Sequential number: 1

Lat-long accuracy: 3 T 5 N 6 S R 6 W. Sec 35 NE SE NE SW

Local well number: E046AC3505S06E Other number: \_\_\_\_\_

Local use: 268 Owner or name: CHARLES LOVELL Address: Bonnewille

Ownership: (C) County, (F) Fed Gov't, (M) City, Corp or Co, (N) Private, (P) State Agency, (S) Water Dist P

Use of water: (A) Air cond, (B) Bottling, (C) Comm, (D) Dewater, (E) Power, (F) Fire, (H) Dom, (I) Irr, (M) Med, (N) Ind, (P) P S, (R) Rec, (S) Stock, (T) Instit, (U) Unused, (V) Recharge, (W) Dessal-P S, (X) Desal-other, (Y) Other H

Use of well: (A) Anode, (D) Drain, (G) Seismic, (H) Heat Res, (I) Obs, (J) Oil-gas, (K) Recharge, (L) Test, (M) Unused, (N) Withdraw, (O) Waste, (P) Destroyed W

DATA AVAILABLE: Well data  Freq. W/L meas.:  Field aquifer char.

Hyd. lab. data:

Qual. water data; type:

Freq. sampling:  Pumpage inventory:  no. period:

Aperture cards:  yes

Log data:

WELL-DESCRIPTION CARD

SAME AS ON MASTER CARD Depth well: 110 ft Meas. rept. accuracy 3

Depth cased; (first perf.) 21 ft Casing type: steel Diam. in 4

Finish: (C) porous concrete, (F) gravel w. (C) gravel w. (H) horiz. (O) open (P) perf., (S) screen, (T) sd. pt., (W) shored, (X) other, (B) other K

Method Drilled: (A) air rot, (B) bored, (C) cable, (D) dug, (H) hyd jetted, (J) air percussion, (R) reverse, (T) trenching, (V) driven, (W) drive wash, (X) other H

Date Drilled: 971 Pump intake setting: \_\_\_\_\_ ft

Driller: Berk name address

Lift (type): (A) air, (B) bucket, (C) cent, (J) jet, (L) multiple, (M) multiple, (N) none, (P) piston, (R) rot, (S) submerg, (T) turb, (U) other  Deep  Shallow

Power (type): (nat) diesel, (elec) elec, (gas) gas, (hand) hand, (LP) gas, (wind) wind; H.P. 1/2 Trans. or meter no. 5

Descrip. MP \_\_\_\_\_ ft above LSD, Alt. MP \_\_\_\_\_

Alt. LSD: 380 Accuracy: (source) 5

Water Level 16 ft above below MP; Ft below LSD 16 Accuracy: 2

Date meas: 371 Yield: 5 Method determined \_\_\_\_\_

Drawdown: \_\_\_\_\_ ft Accuracy: \_\_\_\_\_ Pumping period \_\_\_\_\_ hrs

QUALITY OF WATER DATA: Iron \_\_\_\_\_ ppm Sulfate \_\_\_\_\_ ppm Chloride \_\_\_\_\_ ppm Hard. \_\_\_\_\_ ppm

Sp. Conduct \_\_\_\_\_ K x 10<sup>6</sup> Temp. \_\_\_\_\_ °F Date sampled \_\_\_\_\_

Taste, color, etc. \_\_\_\_\_

Well No. F 96

PUNCHED

Latitude-longitude

N  
S

HYDROGEOLOGIC CARD

SAME AS ON MASTER CARD

Physiographic Province:

03

Section:

GRAD 112212

Drainage Basin: D

13B

Subbasin:

Topo of well site: (D) depression, (C) stream channel, (E) dunes, (F) flat, (H) hilltop, (K) sink, (L) swamp, (P) offshore, (S) pediment, (T) hillside, (U) terrace, (V) undulating, (W) valley flat

MAJOR AQUIFER:

K3

C3

Lithology:

U.S.

Origin:

6

Aquifer Thickness:

50

Length of well open to:

50

Depth to top of:

60

MINOR AQUIFER:

Lithology:

Length of well open to:

50

Depth to top of:

60

Intervals Screened:

Depth to consolidated rock:

Source of data:

Depth to basement:

Source of data:

Surficial material:

Infiltration characteristics:

Coefficient Trans:

gpd/ft

Coefficient Storage:

Coefficient Perm:

gpd/ft<sup>2</sup>; Spec cap:

gpd/ft; Number of geologic cards:

Red clay 0-18  
Blue clay 18-60  
Water sand 60-110

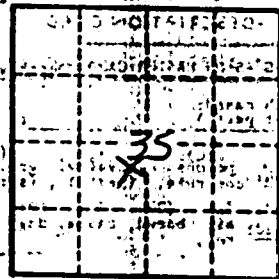

Well No.

F46

PRENTISS  
E 46  
3-18-71

MISSISSIPPI  
BOARD OF WATER COMMISSIONERS  
416 North State Street  
Jackson, Mississippi 39201

**CODED**

WATER WELL DRILLERS LOG

3-18 1971 Bond Well Drilling Prentiss  
date well completed firm name county well located

LANDOWNER: <u>Charles Jewell</u>	description of formations encountered	from	to
<u>Bonnville Miss</u> (mailing address)			
WELL LOCATION: sec. <u>35</u> T. <u>5</u> N. R. <u>6</u> E. <u>6</u> miles <u>West</u> of <u>Bonnville</u> (distance) (direction) (nearest town)	<u>Blue clay</u>	<u>18</u>	<u>60</u>
WELL PURPOSE: <u>Home</u> (home, irrigation, municipal, industrial)	<u>Water sand</u>	<u>60</u>	<u>110</u>
WELL COMPLETION DATA: (1) diameter (inches) <u>4</u>	<b>CODED</b>		
(2) total depth (feet) <u>110</u>			
(3) static water level (feet) <u>16</u> <sup>below</sup> <u>above</u> top of ground.			
(4) casing <u>Steel</u> <u>21</u> (material) (depth)			
(size) _____ If telescope see back.			
(5) screen <u>none</u> (length) (depth to top)			
(size) _____ (material) _____			
(6) pump <u>1/2</u> <u>5</u> (HP) (yield gpm)			
<u>Electric pump</u> (type power)			
(7) electric log <u>no</u> (yes or no)			
(organization running log)			
(8) how well bottom plugged <u>open</u>			
DRILLERS REMARKS:			

**CODED**

APR - 2 1971

MISS. BD. OF  
WATER COMMISSIONERS

# BALDWIN QUAD

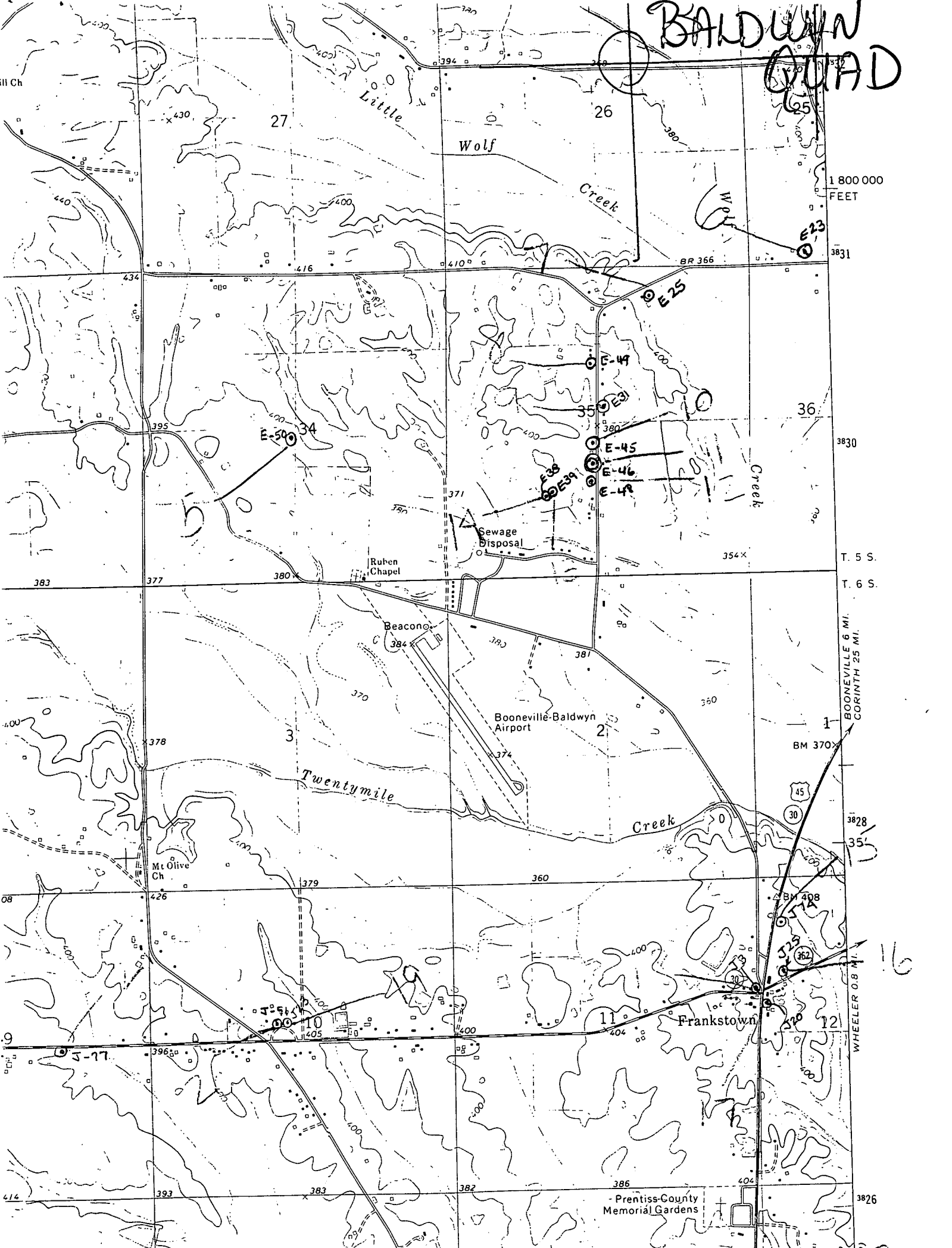

1 800 000  
FEET

T. 5 S.  
T. 6 S.

BOONEVILLE 6 MI.  
CORINTH 25 MI.

WHEELER 0.8 MI.

Prentiss-County  
Memorial Gardens

16