

WELL SCHEDULE

PUNCHED DEC 27 1972

U. S. DEPT. OF THE INTERIOR

GEOLOGICAL SURVEY

WATER RESOURCE DIVISION

MASTER CARD

Record by P.D. Source of data BOWC Date 10-70 Map \_\_\_\_\_

State 28 County (or town) Prentiss 59

Latitude: 343601N Longitude: 0883826 Sequential number: 1

Lat-long accuracy: 3 T. 5 N. 6 W. Sec. 35 SE 1 SW 4 NE 6 SW 7

Local well number: E1039AC3505S06E Other number: \_\_\_\_\_ B & M

Local use: 171 Owner or name: CHARLES LOVELL Address: Boonville, Ms.

Ownership: County, Fed Gov't, City, Corp or Co, Private, State Agency, Water Dist. P

Use of water: (A) Air cond, (B) Bottling, (C) Comm, (D) Dewater, (E) Power, (F) Fire, (G) Dom, (H) Irr, (I) Mad, (J) Ind, (K) P S, (L) Rec, (M) Stock, (N) Instit, (O) Unused, (P) Repressure, (Q) Recharge, (R) Desal-P S, (S) Desal-other, (T) Other IT

Use of well: (A) Anode, (B) Drain, (C) Seismic, (D) Heat Res, (E) Obs, (F) Oil-gas, (G) Recharge, (H) Test, (I) Unused, (J) Withdraw, (K) Waste, (L) Destroyed. W

DATA AVAILABLE: Well data  Freq. W/L meas.:  Field aquifer char.

Hyd. lab. data: \_\_\_\_\_

Qual. water data; type: \_\_\_\_\_

Freq. sampling: \_\_\_\_\_ Pumpage inventory:  no; period: \_\_\_\_\_

Aperture cards: \_\_\_\_\_ yes

Log data: D

WELL-DESCRIPTION CARD

SAME AS ON MASTER CARD Depth well: 100 ft Meas. rept accuracy 3

Depth cased; (if not perf.) 21 ft Casing type: Steel Diam. in \_\_\_\_\_

Finish: (C) porous concrete, (D) gravel w. screen, (E) gravel w. gallery, (F) horix. open end, (G) open perf., (H) screen, (I) sd. pt., (J) shored, (K) open able, (L) other X

Method Drilled: (A) air rot., (B) bored, (C) cable, (D) dug, (E) hyd jetted, (F) air percussion, (G) rotary, (H) reverse, (I) trenching, (J) driven, (K) drive wash, (L) other H

Date Drilled: 9-7-70 Pump intake setting: \_\_\_\_\_ ft

Driller: Bond

Lift (type): (A) air, (B) bucket, (C) cent, (D) jet, (E) multiple, (F) multiple, (G) nose, (H) piston, (I) rot, (J) submerg, (K) turb, (L) other  Deep  Shallow

Power (type): (A) diesel, (B) elec, (C) gas, (D) gasoline, (E) hand, (F) gas, (G) wind; H.P. 3 Trans. or meter no. 5

Descrip. MP \_\_\_\_\_ ft above below LSD. Alt. MP \_\_\_\_\_

Alt. LSD: 380 Accuracy: (source) 5

Water Level: 16 ft above below MP; Ft below LSD 16 Accuracy: D

Date meas: 9-7-70 Yield: \_\_\_\_\_ gpm Method determined 5

Drawdown: \_\_\_\_\_ ft Accuracy: \_\_\_\_\_ Pumping period \_\_\_\_\_ hrs

QUALITY OF WATER DATA: Iron \_\_\_\_\_ ppm Sulfate \_\_\_\_\_ ppm Chloride \_\_\_\_\_ ppm Hard. \_\_\_\_\_ ppm

Sp. Conduct \_\_\_\_\_ K x 10<sup>6</sup> Temp. \_\_\_\_\_ °F Date sampled \_\_\_\_\_

Taste, color, etc. \_\_\_\_\_

Well No. E 39

Well No. F 39

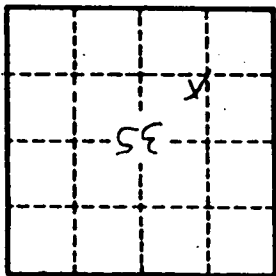

3 1/2" clay 0-16  
 Blue clay 16-56  
 White sand 56-100

HYDROGEOLOGIC CARD

1 SAME AS ON MASTER CARD

2 Physiographic Province:  3 Section:  4

3 Well site: (A) offshore, pediment, hillside, terrace, undulating, valley flat

4 Top of depression, stream channel, dunes, flat, hilltop, sink, swamp, (B) (C) (D) (E) (F) (G) (H) (I) (J)

5 Major Aquifer:  6 system  7 series  8 aquifer, formation, group  9 aquifer  10 thickness:  11

12 Minor Aquifer:  13 system  14 series  15 aquifer, formation, group  16 aquifer  17 thickness:  18

19 Lithology:  20 Length of well open to:  21 Depth to top of:  22 Origin:  23 Aquifer thickness:  24

25 Depth to consolidated rock:  26 Source of data:  27

28 Depth to permanent:  29 Source of data:  30

31 Surface:  32 Infiltration  33 Source of data:  34

35 Material:  36 Characteristics:  37

38 Trans:  39 Coefficient  40 Spd/ft:  41 Storages:  42

43 Perm:  44 Spd/ft:  45 Spec cap:  46 Number of geologic cards:  47

Latitude-Longitude

N

REACHED

SEP 19 5 30

PRENTISS  
E 39  
9-1-70

MISSISSIPPI  
BOARD OF WATER COMMISSIONERS  
416 North State Street  
Jackson, Mississippi 39201

**CODED**

WATER WELL DRILLERS LOG

9-1 date well completed 1970 Bonds Well Drilling Prentiss firm name county well located

LANDOWNER: <u>Charles Lovell</u>	description of formations encountered	from	to
<u>Brownville Miss.</u> (mailing address)			
<b>WELL LOCATION:</b> sec. <u>35</u> T <u>5</u> N R <u>6</u> E <u>6</u> miles <u>West</u> of <u>Brownville</u> (distance) (direction) (nearest town)			
<b>WELL PURPOSE:</b> <u>Home</u> (home, irrigation, municipal, industrial)			
<b>WELL COMPLETION DATA:</b>			
(1) diameter (inches) <u>4</u>			
(2) total depth (feet) <u>100</u>			
(3) static water level (feet) <u>16 ft</u> <u>below</u> above top of ground.			
(4) casing <u>Steel</u> <u>21</u> (material) (depth)			
_____ If telescope see back. (size)			
(5) screen <u>none</u> (length) (depth to top)			
_____ (size) _____ (material)			
(6) pump <u>3/4</u> <u>5</u> (HP) (yield gpm)			
<u>Electric</u> (type power)			
(7) electric log <u>no</u> (yes or no)			
_____ (organization running log)			
(8) how well bottom plugged <u>open</u>			
<b>DRILLERS REMARKS:</b>			
MISS. BD. OF WATER COMM.			

**CODED**

OCT 12 1970

# BALDWIN QUAD

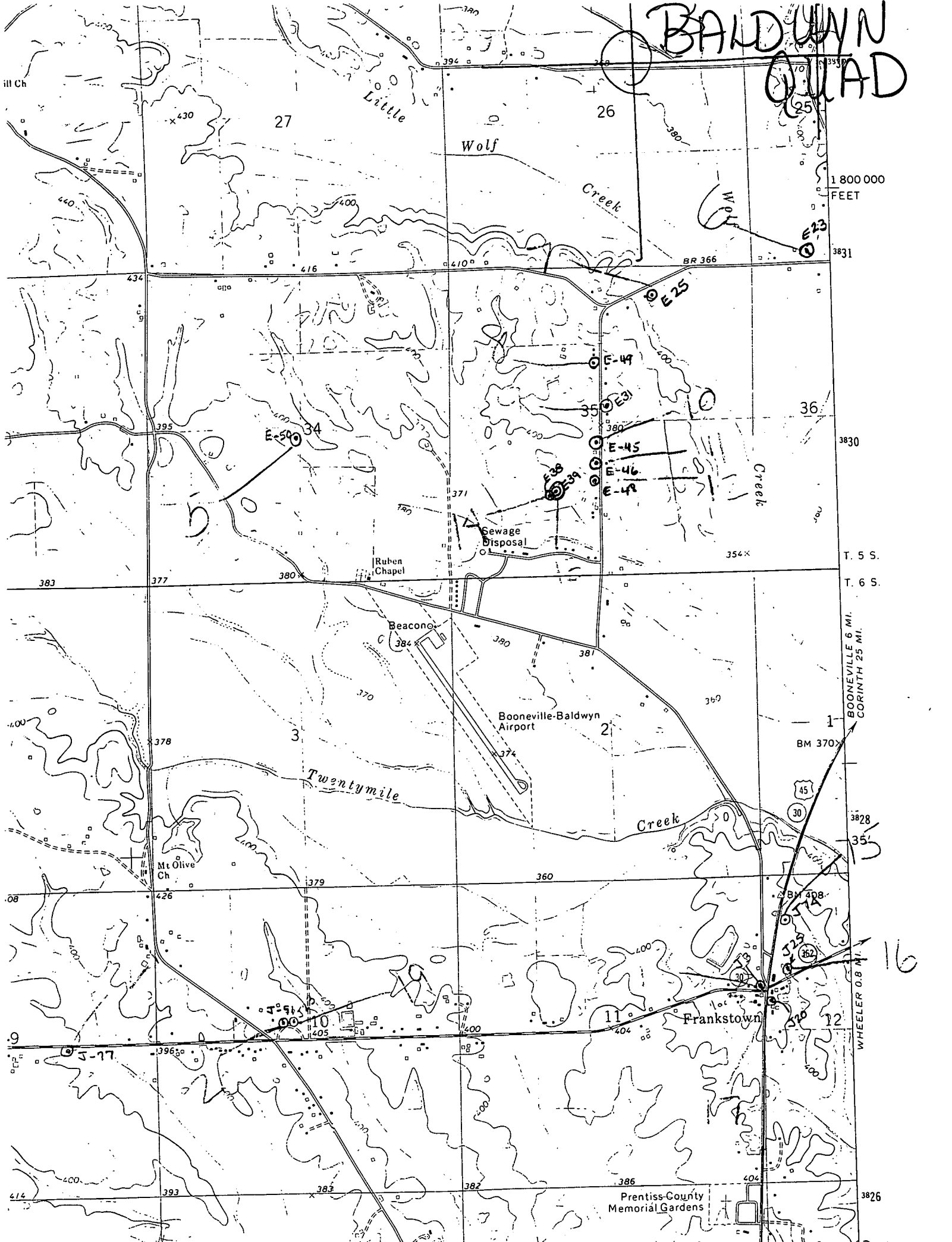

1800 000  
FEET

T. 5 S.  
T. 6 S.

BOONEVILLE 6 MI.  
CORINTH 25 MI.

BM 370

45  
30

BM 408

WHEELER 0.8 MI.

Prentiss-County  
Memorial Gardens

3826

16

53