

WELL SCHEDULE

**PUNCHED**

U. S. DEPT. OF THE INTERIOR

GEOLOGICAL SURVEY

WATER RESOURCES DIVISION

DEC 27 1972

MASTER CARD

Record by B. D. Source of data BOWC Date 10-70 Map \_\_\_\_\_

State \_\_\_\_\_ County 28 Prentiss (or town) \_\_\_\_\_

Latitude: 34 36 00 N Longitude: 08 8 38 26 Sequential number: 1

Lat-long accuracy: 3 5 6 35 NE SW NE SW

Local well number: E 038 AC 35 05 06 E Other number: \_\_\_\_\_

Local use: 171 Owner or name: \_\_\_\_\_

Owner or name: CHARLES LOVELL Address: Boonville, Mo.

Ownership: County, Fed Gov't, City, Corp or Co, Private, State Agency, Water Dist. P

Use of Air cond, Bottling, Comm, Dewater, Power, Fire, Dom, Irr, Med, Ind, P S, Rec. H

Water: Stock, Instit, Unused, Repressure, Recharge, Desal-P S, Desal-other, Other H

Use of well: Anode, Drain, Seismic, Heat Res, Obs, Oil-gas, Recharge, Test, Unused, Withdraw, Waste, Destroyed. W

DATA AVAILABLE: Well data  Freq. W/L meas.:  Field aquifer char.

Hyd. lab. data: \_\_\_\_\_

Qual. water data: type: \_\_\_\_\_

Freq. sampling: \_\_\_\_\_ Pumpage inventory:  period: \_\_\_\_\_

Aperture cards: \_\_\_\_\_

Log data: \_\_\_\_\_

WELL-DESCRIPTION CARD

SAME AS ON MASTER CARD Depth well: \_\_\_\_\_ ft 115 Meas. rept accuracy 3

Depth cased: \_\_\_\_\_ ft 21 Casing type: Steel ; Diam. \_\_\_\_\_ in 4

Finish: porous gravel w. concrete, (parf.), (screen), gallery, end, (H) horiz. open perf., screen, ad. pt., shored, open hole, other X

Method Drilled: air bored, cable, dug, hyd jetted, air rot., percussion, rotary, reverse trenching, driven, drive wash, other H

Date Drilled: 9-7-70 Pump intake setting: \_\_\_\_\_ ft \_\_\_\_\_

Driller: Bond

Lift (type): air, bucket, cent, jet, multiple, (cent.) multiple, (turb.) none, piston, rot, submerg, turb, other J Deep  Shallow

Power (type): diesel, elec nat gas, gasoline, hand, gas, wind; H.P. 5 Trans. of meter no. 5

Descrip. MP \_\_\_\_\_ ft above below LSD. Alt. MP \_\_\_\_\_

Alt. LSD: \_\_\_\_\_ Accuracy: (source) S

Water Level 18 ft above below MP; Ft below LSD 18 Accuracy: \_\_\_\_\_

Date meas: 9-7-70 Yield: \_\_\_\_\_ Method determined \_\_\_\_\_

Drawdown: \_\_\_\_\_ ft \_\_\_\_\_ Accuracy: \_\_\_\_\_ Pumping period \_\_\_\_\_ hrs \_\_\_\_\_

QUALITY OF WATER DATA: Iron \_\_\_\_\_ Sulfate \_\_\_\_\_ Chloride \_\_\_\_\_ Hard. \_\_\_\_\_

Sp. Conduct \_\_\_\_\_ K x 10<sup>6</sup> \_\_\_\_\_ Temp. \_\_\_\_\_ °F \_\_\_\_\_

Taste, color, etc. \_\_\_\_\_

Well No. E 38

PUNCHED

Latitude-longitude \_\_\_\_\_  
N  
S  
d m s d m s

HYDROGEOLOGIC CARD

SAME AS ON MASTER CARD

Physiographic Province: \_\_\_\_\_

03 Section: \_\_\_\_\_

D Drainage Basin: \_\_\_\_\_

13B Subbasin: \_\_\_\_\_

Top of depression, stream channel, dunes, flat, hilltop, sink, swamp, well site: \_\_\_\_\_

offshore, pediment, hillside, terrace, undulating, valley flat \_\_\_\_\_

MAJOR

AQUIFER: \_\_\_\_\_

system

series

53

aquifer, formation, group

C/S

Lithology: \_\_\_\_\_

U/S

Origin: \_\_\_\_\_

6

Aquifer

Thickness: \_\_\_\_\_

48 ft

Length of well open to: \_\_\_\_\_ ft

48

Depth to top of: \_\_\_\_\_ ft

67

MINOR

AQUIFER: \_\_\_\_\_

system

series

aquifer, formation, group

Lithology: \_\_\_\_\_

Origin: \_\_\_\_\_

Aquifer

Thickness: \_\_\_\_\_

ft

Length of well open to: \_\_\_\_\_ ft

Depth to top of: \_\_\_\_\_ ft

Intervals

Screened: \_\_\_\_\_

Depth to consolidated rock: \_\_\_\_\_ ft

Source of data: \_\_\_\_\_

Depth to basement: \_\_\_\_\_ ft

Source of data: \_\_\_\_\_

Surficial material: \_\_\_\_\_

Infiltration characteristics: \_\_\_\_\_

Coefficient Trans: \_\_\_\_\_

gpd/ft

Coefficient Storage: \_\_\_\_\_

Coefficient Perm: \_\_\_\_\_

gpd/ft<sup>2</sup>

gpd/ft

Number of geologic cards: \_\_\_\_\_

Mixed Clay 0-16  
Blue clay 16-67  
Water sand 67-115

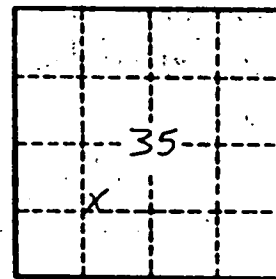

Well No.

E 38

PRENTISS  
E 38  
9-1-70

MISSISSIPPI  
BOARD OF WATER COMMISSIONERS  
416 North State Street  
Jackson, Mississippi 39201

**CODED**

WATER WELL DRILLERS LOG

9-1 1970 Bonch Well Drilling Prentiss  
date well completed firm name county well located

LANDOWNER: <u>Charles Sovell</u>	description of formations encountered	from	to
<u>Brownsville Miss</u> (mailing address)	<u>medial clay</u> <u>blue clay</u> <u>Water sand</u>	<u>0</u> <u>16</u> <u>67</u>	<u>16</u> <u>67</u> <u>115</u>
WELL LOCATION: sec <u>35</u> T <u>5</u> N R <u>6</u> E <u>6</u> miles <u>West</u> of <u>Brownsville</u> (distance) (direction) (nearest town)			
WELL PURPOSE: <u>Home</u> (home, irrigation, municipal, industrial)			
WELL COMPLETION DATA:			
(1) diameter (inches) <u>4</u>			
(2) total depth (feet) <u>115</u>			
(3) static water level (feet) <u>18</u> <u>below</u> above top of ground.			
(4) casing <u>Steel</u> , <u>21</u> (material) (depth)			
(size) If telescope see back.			
(5) screen <u>None</u> (length) (depth to top)			
(size) (material)			
(6) pump <u>3/4</u> <u>5</u> (HP) (yield gpm)			
<u>Electric</u> (type power)			
(7) electric log <u>No</u> (yes or no)			
(organization running log)			
(8) how well bottom plugged <u>Open</u>			
DRILLERS REMARKS:			

**CODED**

OCT 12 1970

MISS. BD. OF  
WATER COMMISSIONERS

# BALDWIN QUAD

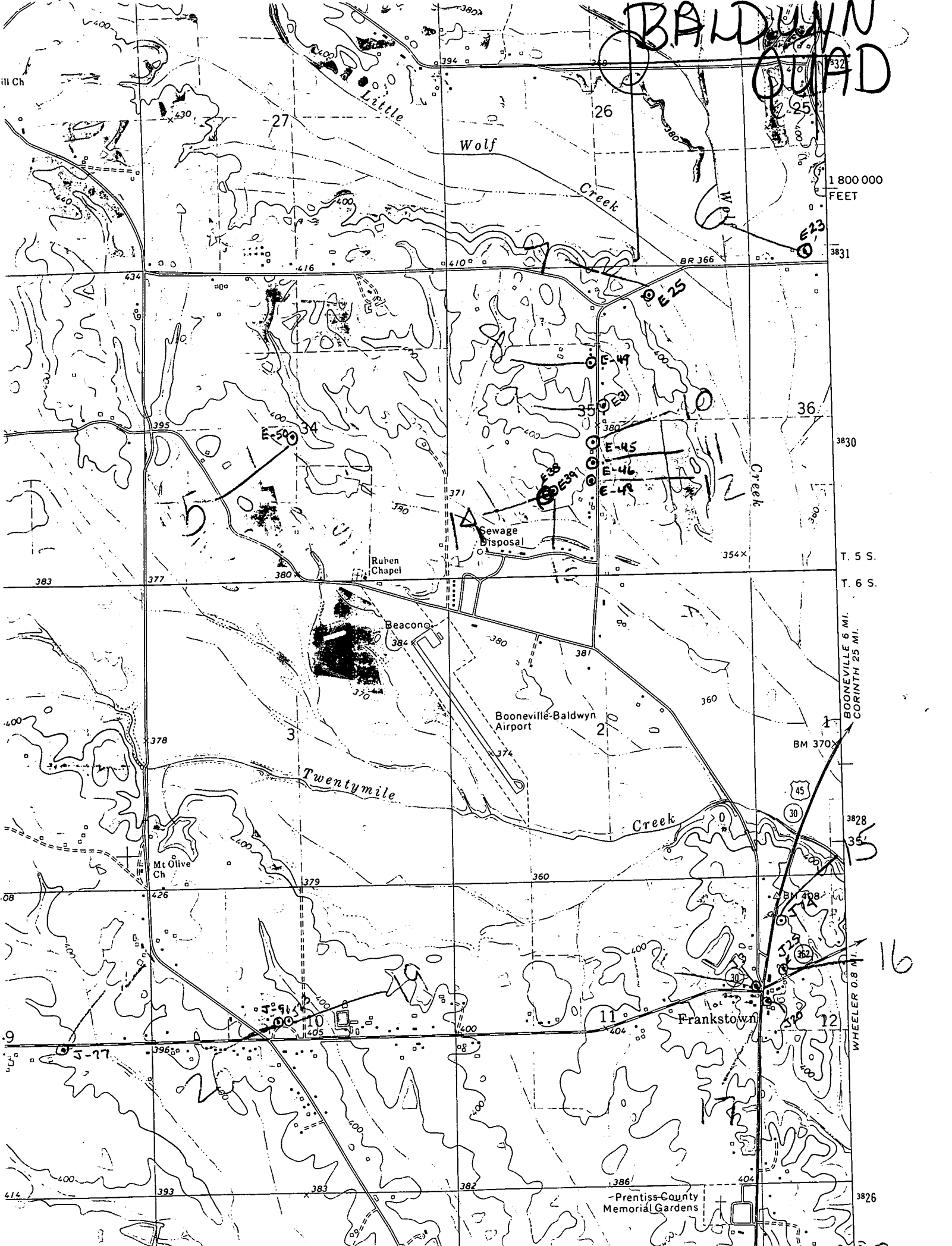

1 800 000  
FEET

T. 5 S.  
T. 6 S.

BOONEVILLE 6 MI.  
CORINTH 25 MI.

WHEELER 0.8 MI.

Prentiss-County  
Memorial Gardens

16

3826

(R) E