

Baldwyn

FORM 9-1642 (1-68)

Well No. E 31

WELL SCHEDULE  
GEOLOGICAL SURVEY

**PUNCHED**

U. S. DEPT. OF THE INTERIOR

WATER RESOURCES DIVISION

DEC 27 1972

MASTER CARD

Record by JIS Source of data Bowc Date 12/69 Map \_\_\_\_\_

State 28 County (or town) Prendis 59

Latitude: 34<sup>deg</sup> 36<sup>min</sup> 21<sup>sec</sup> N Longitude: 088<sup>deg</sup> 38<sup>min</sup> 19<sup>sec</sup> W Sequential number: 1

Lat-long accuracy: 3<sup>sec</sup> T 5<sup>sec</sup> S R 6<sup>sec</sup> W. Sec 35 SW 50 NE

Local well number: E031 Other number: \_\_\_\_\_

Local use: 171 Owner or name: \_\_\_\_\_

Owner or name: LEROY AGNUM Address: Boonville

Ownership: (C) County, Fed Gov't, (F) City, Corp or Co, (N) Private, (P) State Agency, (W) Water Dist. P

Use of well: (A) Air cond, (B) Bottling, (C) Comm, (D) Dewater, (E) Power, (F) Fire, (G) Irr, (H) Mod, (I) Ind, (J) P & B, (K) Rec, (L) Stock, (M) Insult, (N) Unused, (O) Reprocess, (P) Boilerm, (Q) Head-P B, (R) Basal-other, (S) Other. W

Use of well: (A) Amids, (B) Heats, (C) Solvents, (D) Heat Res, (E) Oils, (F) Oil gas, (G) Boilerm, (H) Text, (I) Unused, (J) Wildflow, (K) Waste, (L) Hestymad. W

DATA AVAILABLE: Well data 0 Freq. W/L meas.: \_\_\_\_\_ Field aquifer char. 0

Hyd. lab. data: \_\_\_\_\_

Qual. water data; type: \_\_\_\_\_

Freq. sampling: \_\_\_\_\_ Pumpage inventory: yes 0 no, period: \_\_\_\_\_

Aperture cards: \_\_\_\_\_ yes 0

Log data: \_\_\_\_\_ 0

WELL-DESCRIPTION CARD

SAME AS ON MASTER CARD Depth well: \_\_\_\_\_ ft 119.0 Meas. rept. accuracy 3

Depth cased; (if not perf.) \_\_\_\_\_ ft 8.4 Casing type: Steel ; Diam. \_\_\_\_\_ in 4

Finish: (C) porous concrete, (F) gravel v. concrete, (G) gravel v. (perf.), (H) horis. gallery, (I) open end, (J) screen, (K) open end, (L) shored, (M) other. X

Method Drilled: (A) air bored, (B) cable, (C) dug, (D) hyd jetted, (E) air rot., (F) reverse, (G) trenching, (H) driven, (I) drive wash, (J) other. H

Date Drilled: 9.6.9 Pump intake setting: \_\_\_\_\_ ft \_\_\_\_\_

Driller: \_\_\_\_\_

Lift (type): (A) air, (B) bucket, (C) cent, (D) jet, (E) multiple, (F) multiple, (G) none, (H) piston, (I) rot, (J) submerg, (K) turb, (L) other. J Deep 0 Shallow 0

Power (type): diesel, (elec) gas, gasoline, hand, gas, wind; H.P. 3/4 Trans. or meter no. 5

Descrip. MP ✓ above ft below LSD, Alt. MP \_\_\_\_\_

Alt. LSD: \_\_\_\_\_ Accuracy: (source) 5

Water Level 20 ft above HP; Ft below LSD 30 Accuracy: 0

Date meas: 0.6.9 Yield: \_\_\_\_\_ gpm Method determined 6

Drawdown: \_\_\_\_\_ ft Accuracy: \_\_\_\_\_ Pumping period \_\_\_\_\_ hrs

QUALITY OF WATER DATA: Iron \_\_\_\_\_ ppm Sulfate \_\_\_\_\_ ppm Chloride \_\_\_\_\_ ppm Hard. \_\_\_\_\_ ppm

Sp. Conduct \_\_\_\_\_ K x 10<sup>6</sup> Temp. \_\_\_\_\_ °F Date sampled \_\_\_\_\_

Taste, color, etc. \_\_\_\_\_

Well No.

E 31



**PRENTISS**  
**E 31**  
**10-23-69**

MISSISSIPPI  
 BOARD OF WATER COMMISSIONERS  
 416 North State Street  
 Jackson, Mississippi 39201

CODED

**WATER WELL DRILLERS LOG**

10-23 1969 Prentiss Well Drilling Prentiss  
 date well completed firm name county well located

LANDOWNER: <u>James E. Brown</u>	description of formations encountered	from	to
<u>Brownville</u> (mailing address)			
WELL LOCATION: sec <u>35</u> T <u>5</u> N R <u>6</u> E <u>4</u> miles <u>West</u> of <u>Brownville</u> (distance) (direction) (nearest town)	<u>Yellow sand</u> <u>sandy shale</u> <u>blue shale</u> <u>blue shale</u>	<u>0</u> <u>30</u> <u>75</u> <u>140</u>	<u>35</u> <u>78</u> <u>140</u> <u>140</u>
WELL PURPOSE: <u>Home</u> (home, irrigation, municipal, industrial)			
<b>WELL COMPLETION DATA:</b> (1) diameter (inches) <u>4</u> (2) total depth (feet) <u>170</u> (3) static water level (feet) <u>30</u> below above top of ground. (4) casing <u>Steel</u> <u>364</u> (material) (depth) _____ If telescope see back. (size) (5) screen <u>none</u> (length) (depth to top) (size) (material) (6) pump <u>3</u> <u>6</u> (HP) (yield gpm) <u>1/2</u> (type power) (7) electric log <u>yes</u> (yes or no) (organization running log) (8) how well bottom plugged <u>yes</u>			
<b>DRILLERS REMARKS:</b>			

# BALDWIN QUAD

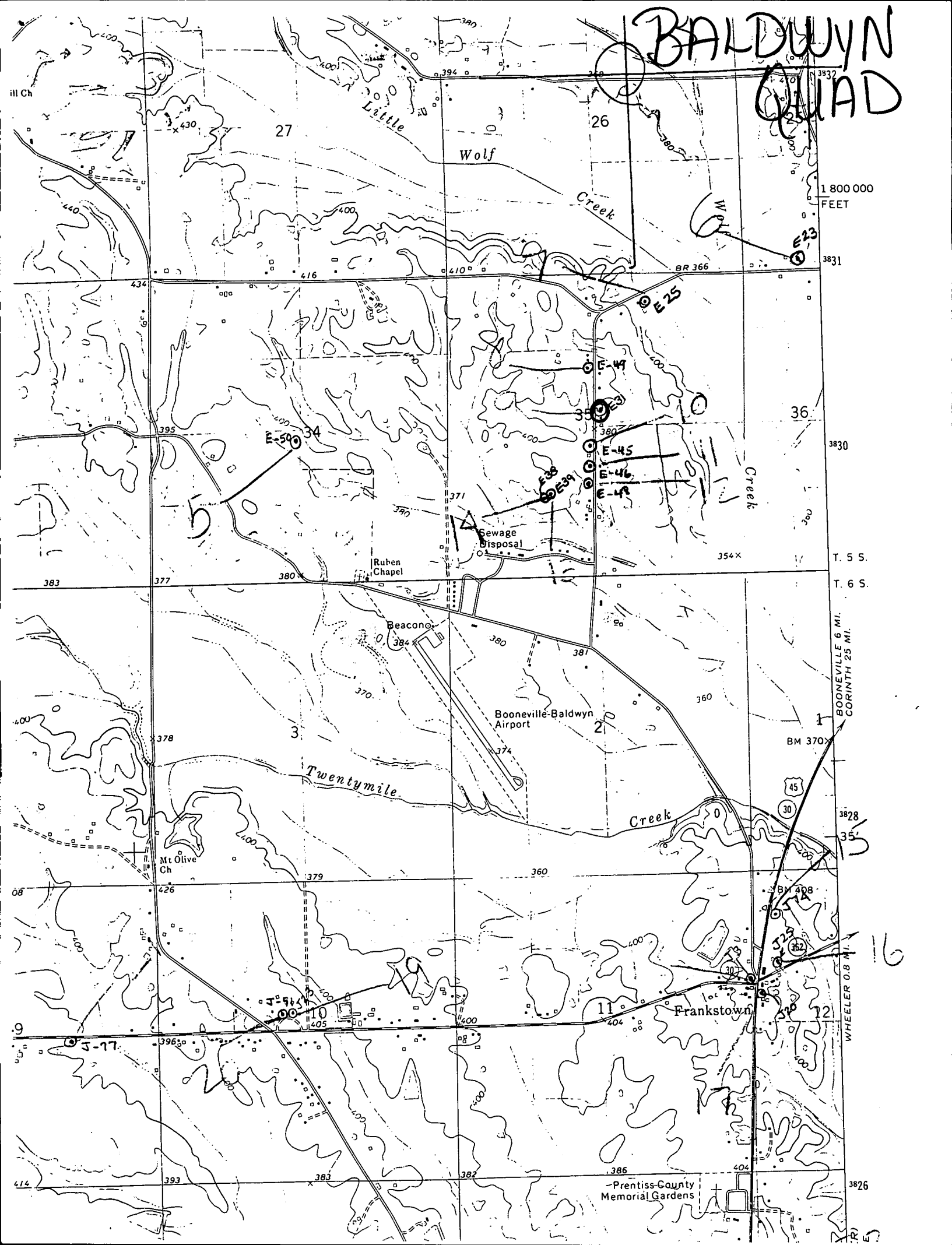

1 800 000  
FEET

T. 5 S.  
T. 6 S.

BOONEVILLE 6 MI.  
CORINTH 25 MI.

WHEELER 0.8 MI.

Prentiss-County  
Memorial Gardens

16

5

BM 370

BM 408

3826

(R) E