

Booneville

FORM 9-1642 (1-68)

Well No. B32

WELL SCHEDULE

U. S. DEPT. OF THE INTERIOR

GEOLOGICAL SURVEY

WATER RESOURCES DIVISION

MASTER CARD

**PUNCHED**

Mr. Doss  
11/30/82  
WL = 26.25  
1987  
WL = 29.4

Record by BEE Source of data \_\_\_\_\_ Date 4/25/59 Map \_\_\_\_\_

State 28 County 59 (or town) \_\_\_\_\_

Latitude: 344422N Longitude: 0883330 Sequential number: 1

Lat-long accuracy: 3 Sec 15 NW/NW, NW Other number: B & M

Local well number: B032BBI504507E Owner or name: S E DOSS Address: Rt. 3 Range

Local use: \_\_\_\_\_ Owner or name: \_\_\_\_\_

Ownership: County, Fed Gov't, City, Corp or Co, Private, State Agency, Water Dist P

Use of water: Air cond, Bottling, Comm, Dewater, Power, Fire, Dom, Irr, Med, Ind, P S, Rec, Stock, Inact, Unused, Repressure, Recharge, Desal-P S, Desal-other, Other H

Use of well: Anode, Drain, Seismic, Heat Res, Obs, Oil-gas, Recharge, Test, Unused, Withdraw, Waste, Destroyed. W

DATA AVAILABLE: Well data  Freq. W/L meas: None Field aquifer char.

Hyd. lab. data: \_\_\_\_\_

Qual. water data; type: \_\_\_\_\_

Freq. sampling: \_\_\_\_\_ Pumpage inventory: yes  no: \_\_\_\_\_

Aperture cards: \_\_\_\_\_ yes

Log data: \_\_\_\_\_

WELL-DESCRIPTION CARD

SAME AS ON MASTER CARD Depth well: 115.6 Meas. rept accuracy 6

Depth cased: 5.2 Casing type: \_\_\_\_\_ Diam. in 4

Finish: porous concrete, gravel w. (perf.), gravel w. (screen), horiz. gallery, open end, (P) perf., (S) screen, (T) ad. pt., (W) shored, (X) open hole, (B) other X

Mechod: (A) air bored, (C) cable, (D) dug, (H) jettied, (P) air reverse, (R) trenching, (T) driven, (V) drive wash, (W) other H

Date Drilled: 945 Pump intake setting: \_\_\_\_\_ ft \_\_\_\_\_

Driller: None

Lift (type): (A) air, (B) bucket, (C) cent, (J) jet, (L) multiple, (M) multiple, (N) none, (P) piston, (R) rot, (S) submerg, (T) turb, (Z) other P Deep  Shallow

Power (type): diesel, (elec) elec, gas, gasoline, hand, LP gas, wind, H.P. 5 Trans. or meter no. \_\_\_\_\_

Descrip. MP 463' (12/89) ft above LSD, Alt. MP \_\_\_\_\_

Alt. LSD: 46.5 Accuracy: \_\_\_\_\_

Water Level: \_\_\_\_\_ ft above MP; \_\_\_\_\_ ft below LSD Accuracy: \_\_\_\_\_

Date meas: \_\_\_\_\_ Yield: \_\_\_\_\_ gpm Method determined \_\_\_\_\_

Drawdown: \_\_\_\_\_ ft Accuracy: \_\_\_\_\_ Pumping period \_\_\_\_\_ hrs \_\_\_\_\_

QUALITY OF WATER DATA: Iron \_\_\_\_\_ ppm Sulfate \_\_\_\_\_ ppm Chloride \_\_\_\_\_ ppm Hard. \_\_\_\_\_ ppm

Sp. Conduct \_\_\_\_\_ K x 10<sup>6</sup> Temp. \_\_\_\_\_ °F Date sampled \_\_\_\_\_

Taste, color, etc. \_\_\_\_\_

10/21/78  
WL = 29.12

1992  
Probably destroyed

Well No.

HYDROGEOLOGIC CARD

SAME AS ON MASTER CARD Physiographic Province: 03 Section: \_\_\_\_\_

D Drainage Basin: 116L Subbasin: \_\_\_\_\_

Topo of well site: (D) depression, stream channel, dunes, flat, hilltop, sink, swamp, (E) (F) (H) (K) (L) (M) (P) (S) (T) (U) (V) offshore, pediment, hillside, terrace, undulating, valley flat \_\_\_\_\_

MAJOR AQUIFER: system \_\_\_\_\_ series K3 aquifer, formation, group C5

Lithology: US Origin: 6 Aquifer Thickness: \_\_\_\_\_ ft

Length of well open to: \_\_\_\_\_ ft Depth to top of: \_\_\_\_\_ ft

MINOR AQUIFER: system \_\_\_\_\_ series \_\_\_\_\_ aquifer, formation, group \_\_\_\_\_

Lithology: \_\_\_\_\_ Origin: \_\_\_\_\_ Aquifer Thickness: \_\_\_\_\_ ft

Length of well open to: \_\_\_\_\_ ft Depth to top of: \_\_\_\_\_ ft

Intervals Screened: \_\_\_\_\_

Depth to consolidated rock: \_\_\_\_\_ ft Source of data: \_\_\_\_\_

Depth to basement: \_\_\_\_\_ ft Source of data: \_\_\_\_\_

Surficial material: \_\_\_\_\_ Infiltration characteristics: \_\_\_\_\_

Coefficient Trans: \_\_\_\_\_ gpd/ft Coefficient Storage: \_\_\_\_\_

Coefficient Perm: \_\_\_\_\_ gpd/ft<sup>2</sup>; Spec cap: \_\_\_\_\_ gpm/ft; Number of geologic cards: \_\_\_\_\_

Sketch on B31

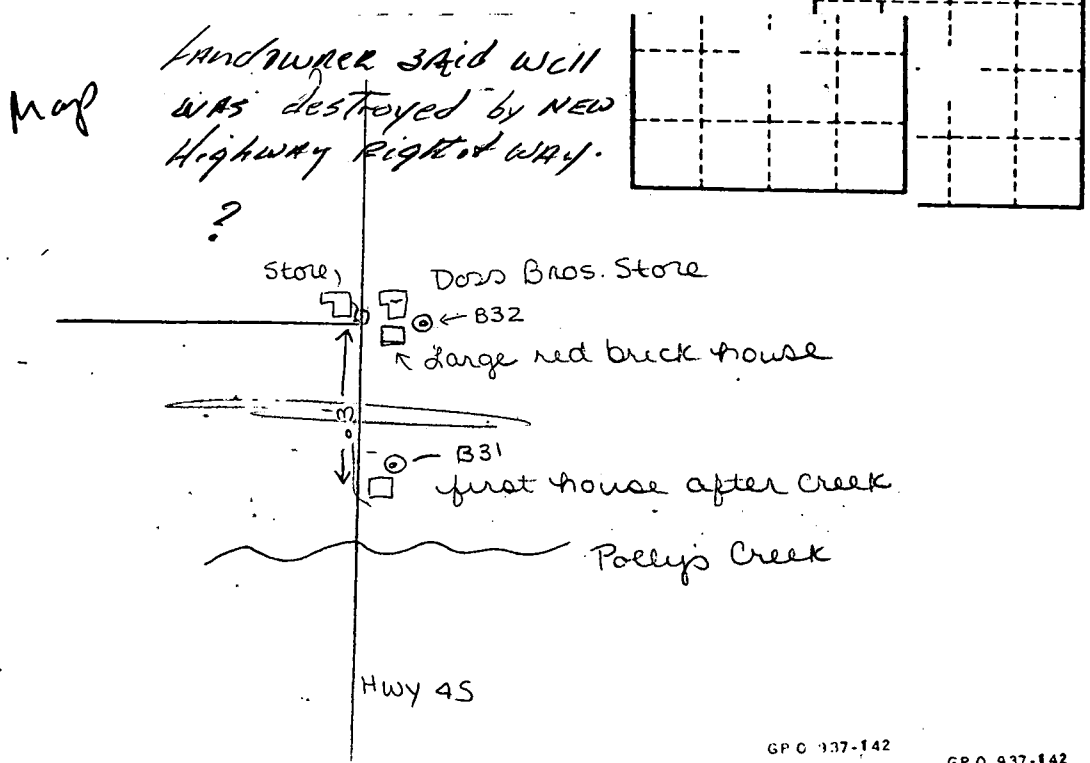

Well No. B32