

FILE COPY WELL SCHEDULE

U. S. DEPT. OF THE INTERIOR

GEOLOGICAL SURVEY

WATER RESOURCES DIVISION

PUNCHED

AUG 6 1973

MASTER CARD

Record by INS Source of data owner Date 7/56 Map _____

State 28 County (or town) PONTIAC 58

Latitude: 340519N Longitude: 089004W Sequential number: 1

Lat-long accuracy: 30 T 11 S 3 W, Sec 29, SE SW

Local well number: L002DC2911503E Other number: _____

Local use: _____ Owner or name: _____

Owner or name: L N STEGALL Address: _____

Ownership: County, Fed Gov't, City, Corp or Co, Private, State Agency, Water Dist P

Use of water: (A) Air cond, Bottling, Comm, Dewater, Power, Fire, Dom, Irr, Med, Ind, P S, Rec, (S) Stock, Instit, Unused, Repressure, Recharge, Desal-P S, Desal-other, Other H

Use of well: (A) Anode, Drain, Seismic, Heat Res, Obs, Oil-gas, Recharge, Test, Unused, Withdraw, Waste, Destroyed. W

DATA AVAILABLE: Well data Freq. W/L meas.: Field aquifer char.

Hyd. lab. data: _____

Qual. water data; type: _____

Freq. sampling: Pumpage inventory: Aperture cards:

Log data: _____

WELL-DESCRIPTION CARD

SAME AS ON MASTER CARD Depth well: 155 Meas. 6

Depth cased: (first perf.) 60 Casing type: _____; Diam. 4 in

Finish: porous concrete, gravel w. (perf.), gravel w. (screen), horiz. gallery, end, open perf., screen, sd. pt., shored, open hole, other X

Method Drilled: (A) air bored, (B) cable, (C) dug, (D) hyd jetted, (E) air reverse, (F) percussion, (G) rotary, (H) trenching, (I) driven, (J) drive wash, (K) other H

Date Drilled: 954 Pump intake setting: _____ ft

Driller: Red Hill name _____ address _____

Lift (type): (A) air, (B) bucket, (C) cent, (D) jet, (E) multiple, (F) multiple, (G) none, (H) piston, (I) rot, (J) submerg, (K) turb, (L) other J Deep Shallow

Power (type): (A) diesel, (B) elec, (C) gas, (D) gasoline, (E) hand, (F) gas, (G) wind; H.P. 1/2 5 Trans. or meter no. _____

Descrip. MP _____ ft above LSD, Alt. MP _____

Alt. LSD: 430 Accuracy: (source) _____

Water Level: _____ ft above MP; _____ ft below LSD 35 Accuracy: _____

Date meas: 54 Yield: _____ gpm Method determined _____

Drawdown: _____ ft Accuracy: _____ Pumping period _____ hrs

QUALITY OF WATER DATA: Iron _____ ppm Sulfate _____ ppm Chloride _____ ppm Hard. _____ ppm

Sp. Conduct _____ K x 10⁶ Temp. _____ °F Date sampled _____

Taste, color, etc. _____

8/14/87
WL = 54.70

11/19/78
WL = 57.00

Well No.

HYDROGEOLOGIC CARD

ON MASTER CARD Physiographic Province: 03 Section: _____

Drainage Basin: D 13E Subbasin: _____

Topo of well site: (D) (C) (E) (F) (H) (K) (L) depression, stream channel, dunes, flat, hilltop, sink, swamp
(O) (P) (S) (T) (U) (V) offshore, pediment, hillside, terrace, undulating, valley flat

MAJOR AQUIFER: system _____ series K3 aquifer, formation, group R1

Lithology: _____ Origin: _____ Aquifer Thickness: _____ ft
Length of well open to: _____ ft Depth to top of: _____ ft

MINOR AQUIFER: system _____ series _____ aquifer, formation, group _____

Lithology: _____ Origin: _____ Aquifer Thickness: _____ ft
Length of well open to: _____ ft Depth to top of: _____ ft

Intervals Screened: _____

Depth to consolidated rock: _____ ft Source of data: _____

Depth to basement: _____ ft Source of data: _____

Surficial material: _____ Infiltration characteristics: _____

Coefficient Trans: _____ gpd/ft Coefficient Storage: _____

Coefficient Perm: _____ gpd/ft²; Spec cap: _____ gpm/ft; Number of geologic cards: _____

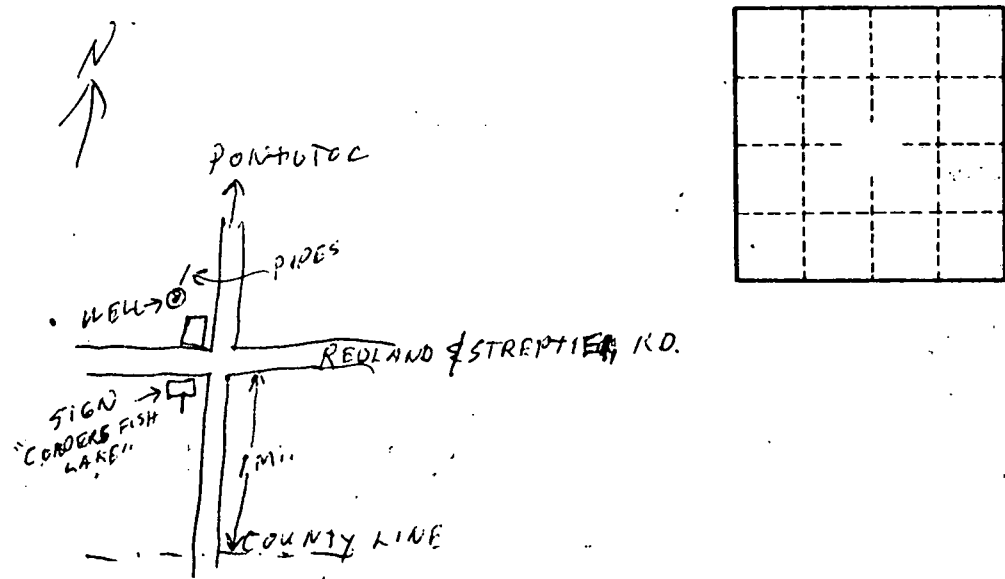

HOULKA QUADRANGLE
MISSISSIPPI
7.5 MINUTE SERIES (TOPOGRAPHIC)

3252' (TROY)

30" 312 R. 2 E. R. 3 E. 440 000 FEET

NEW ALBANY 25 MI. 89° 00'
PONTOTOC MISS 5 & 91 9 MI 34° 07' 30"

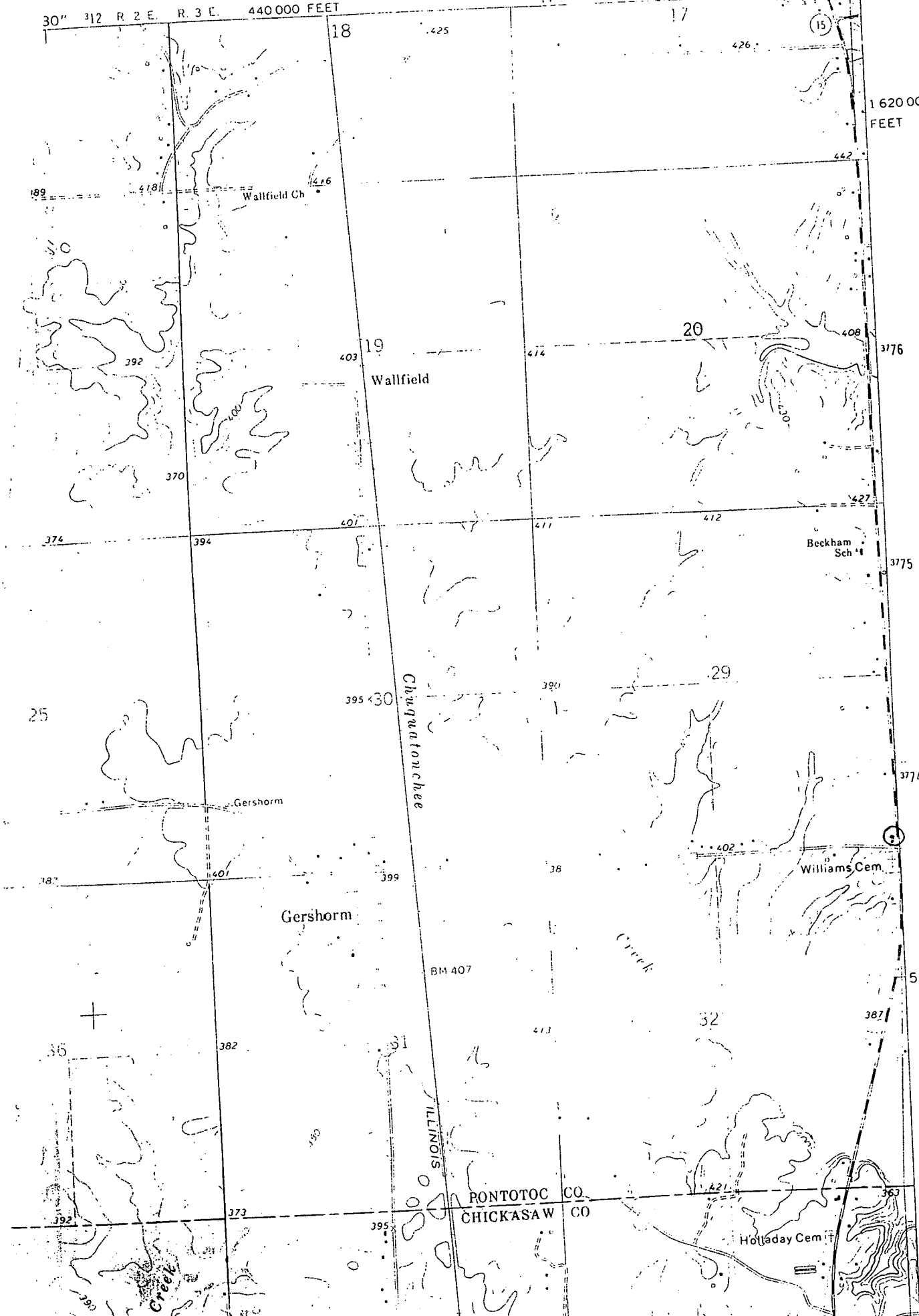

TITLE COPY

1160 43
L2

T 11 S
T 12 S