

WELL SCHEDULE

U. S. DEPT. OF THE INTERIOR

GEOLOGICAL SURVEY

**PUNCHED**  
WATER RESOURCES DIVISION  
**JUL '11 1973**

MASTER CARD

*WL Danta*  
*12.54*  
*2.35*  
*122.65*  
*121.65*

Record by JCM Source of data BOWC Date 2-73 Map \_\_\_\_\_  
 State 28 County Pentotoc Sequential number: 58  
 Latitude: 340535N Longitude: 0890827  
 Accuracy: 2 T 11 S R 1 Sec 25 SE, NE, SE  
 Local well number: J008AD2511501E Other number: \_\_\_\_\_  
 Local use: 079 Owner or name: H. FERGUSON Address: Pentotoc  
 Ownership: (C) County, (F) Fed Gov't, (M) City, Corp or Co, (N) Private, (P) State Agency, (S) Water Dist, (W) \_\_\_\_\_ P  
 Use of water: (A) Air cond, (B) Bottling, (C) Comm, (D) Dewater, (E) Power, (F) Fire, (H) Dom, (I) Irr, (M) Med, (N) Ind, (P) P S, (R) Rec, (S) Stock, (T) Instit, (U) Unused, (V) Reppure, (W) Recharge, (X) Desal-P S, (Y) Desal-other, (Z) Other \_\_\_\_\_ H  
 Use of well: (A) Anode, (D) Drain, (G) Seismic, (H) Heat Res, (I) Obs, (P) Oil-gas, (R) Recharge, (T) Test, (U) Unused, (W) Withdraw, (X) Waste, (Z) Destroyed \_\_\_\_\_ W  
 DATA AVAILABLE: Well data  Freq. W/L meas.:  Field aquifer char. \_\_\_\_\_  
 Hyd. lab. data: \_\_\_\_\_  
 Qual. water data; type: \_\_\_\_\_  
 Freq. sampling: \_\_\_\_\_ Pumpage inventory:  yes, no, period: \_\_\_\_\_  
 Aperture cards: \_\_\_\_\_ yes \_\_\_\_\_  
 Log data: \_\_\_\_\_ D

WELL-DESCRIPTION CARD

SAME AS ON MASTER CARD Depth well: 465 Meas. rept accuracy \_\_\_\_\_  
 Depth cased: (first perf.) 120 Casing type: Steel Diam. in \_\_\_\_\_  
 Finish: (C) porous concrete, (F) gravel w. (G) gravel w. (H) horiz. open (I) perf., (S) screen, (T) sd. pt., (W) shored, (X) open hole, (Z) other \_\_\_\_\_ X  
 Method: (A) air rot., (B) bored, (C) cable, (D) dug, (H) hyd jetted, (J) air percussion, (P) reverse, (R) trenching, (T) driven, (V) drive wash, (W) other \_\_\_\_\_ H  
 Date Drilled: 972 Pump intake setting: \_\_\_\_\_ ft \_\_\_\_\_  
 Driller: Leeper name address \_\_\_\_\_  
 Lift (type): (A) air, (B) bucket, (C) cent, (J) jet, (L) multiple, (M) multiple, (N) none, (P) piston, (R) rot, (S) submerg, (T) turb, (Z) other \_\_\_\_\_ S Deep \_\_\_\_\_ Shallow \_\_\_\_\_  
 Power (type): X nat, LP, diesel, elec, gas, gasoline, hand, gas, wind; H.P. \_\_\_\_\_ 3/4 S Trans. or meter no. \_\_\_\_\_  
 Descrip. MP \_\_\_\_\_ ft above below LSD, Alt. MP \_\_\_\_\_  
 Alt. LSD: 268 Accuracy: (source) \_\_\_\_\_  
 Water Level: \_\_\_\_\_ ft above below MP; \_\_\_\_\_ ft above below LSD 110 Accuracy: \_\_\_\_\_  
 Date meas: N72 Yield: \_\_\_\_\_ gpm \_\_\_\_\_ Method determined \_\_\_\_\_  
 Drawdown: \_\_\_\_\_ ft \_\_\_\_\_ Accuracy: \_\_\_\_\_ Pumping period \_\_\_\_\_ hrs \_\_\_\_\_  
 QUALITY OF WATER DATA: Iron \_\_\_\_\_ ppm Sulfate \_\_\_\_\_ ppm Chloride \_\_\_\_\_ ppm Hard. \_\_\_\_\_ ppm  
 Sp. Conduct \_\_\_\_\_ K x 10<sup>6</sup> Temp. \_\_\_\_\_ °F Date sampled \_\_\_\_\_  
 Taste, color, etc. \_\_\_\_\_

*130.00*  
*122.40*  
*122.60*  
*121.95*  
*11/20/78*  
*WL = 117.20*

Well No. J8

HYDROGEOLOGIC CARD

19 03 Physiographic Province: 03 Section: \_\_\_\_\_  
20 21

22 D Drainage Basin: 156 Subbasin: \_\_\_\_\_ 26

Topo of well site: (D) depression, stream channel, dunes, flat, hilltop, sink, swamp, (K) (L) (M) (N) (O) (P) (S) (T) (U) (V) offshore, pediment, hillside, terrace, undulating, valley flat \_\_\_\_\_ 27

MAJOR AQUIFER: \_\_\_\_\_ system \_\_\_\_\_ series K13 \_\_\_\_\_ aquifer, formation, group R1 \_\_\_\_\_ 28 29 30 31

Lithology: \_\_\_\_\_ 32 33 Origin: 6 Aquifer Thickness: 115 ft \_\_\_\_\_ 34

Length of well open to: \_\_\_\_\_ ft 115 Depth to top of: \_\_\_\_\_ ft 350 \_\_\_\_\_ 35 37 38 40 43

MINOR AQUIFER: \_\_\_\_\_ system \_\_\_\_\_ series \_\_\_\_\_ aquifer, formation, group \_\_\_\_\_ 44 45 46 47

Lithology: \_\_\_\_\_ 48 49 Origin: \_\_\_\_\_ Aquifer Thickness: \_\_\_\_\_ ft \_\_\_\_\_ 50

Length of well open to: \_\_\_\_\_ ft \_\_\_\_\_ Depth to top of: \_\_\_\_\_ ft \_\_\_\_\_ 51 53 54 56 57 59

Intervals Screened: NONE \_\_\_\_\_

Depth to consolidated rock: \_\_\_\_\_ ft \_\_\_\_\_ Source of data: \_\_\_\_\_ 64

Depth to basement: \_\_\_\_\_ ft \_\_\_\_\_ Source of data: \_\_\_\_\_ 69

Surficial material: \_\_\_\_\_ 70-71 Infiltration characteristics: \_\_\_\_\_ 72

Coefficient Trans: \_\_\_\_\_ gpd/ft \_\_\_\_\_ Coefficient Storage: \_\_\_\_\_ 76 78

Coefficient Perm: \_\_\_\_\_ gpd/ft<sup>2</sup>; Spec cap: \_\_\_\_\_ gpm/ft; Number of geologic cards: \_\_\_\_\_ 79

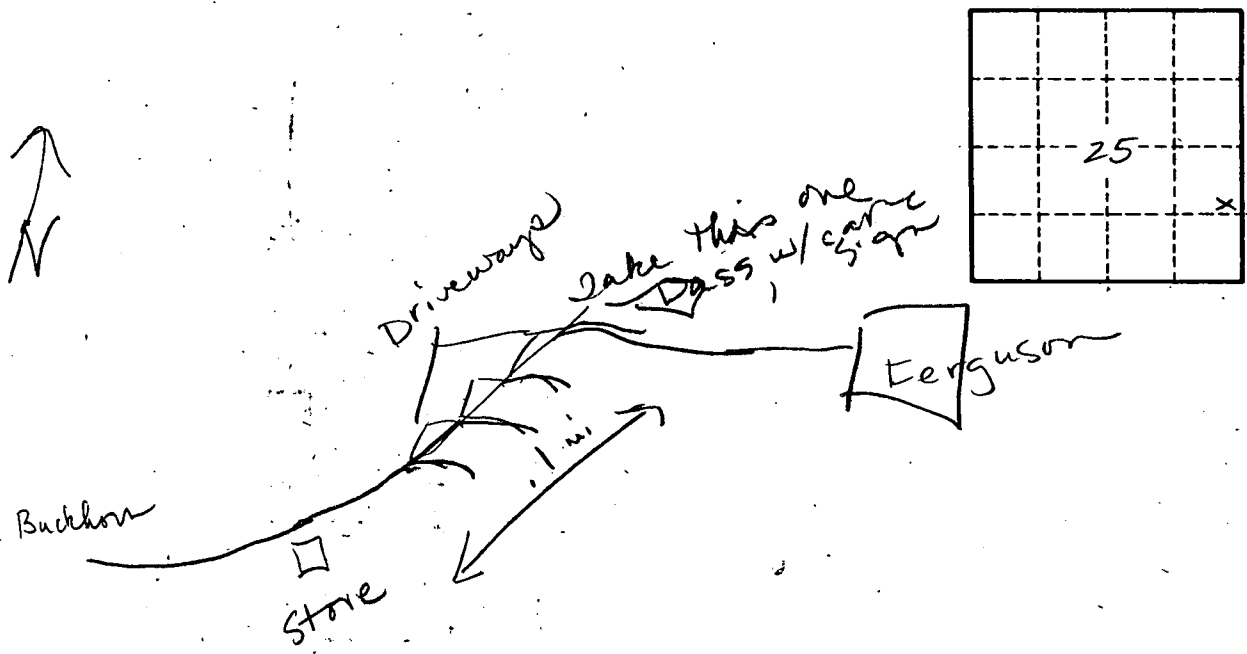

Well No. \_\_\_\_\_

81



Robbs Quad  
Elevation: 380

ROBBS QUADRANGLE  
MISSISSIPPI  
7.5 MINUTE SERIES (TOPOGRAPHIC)

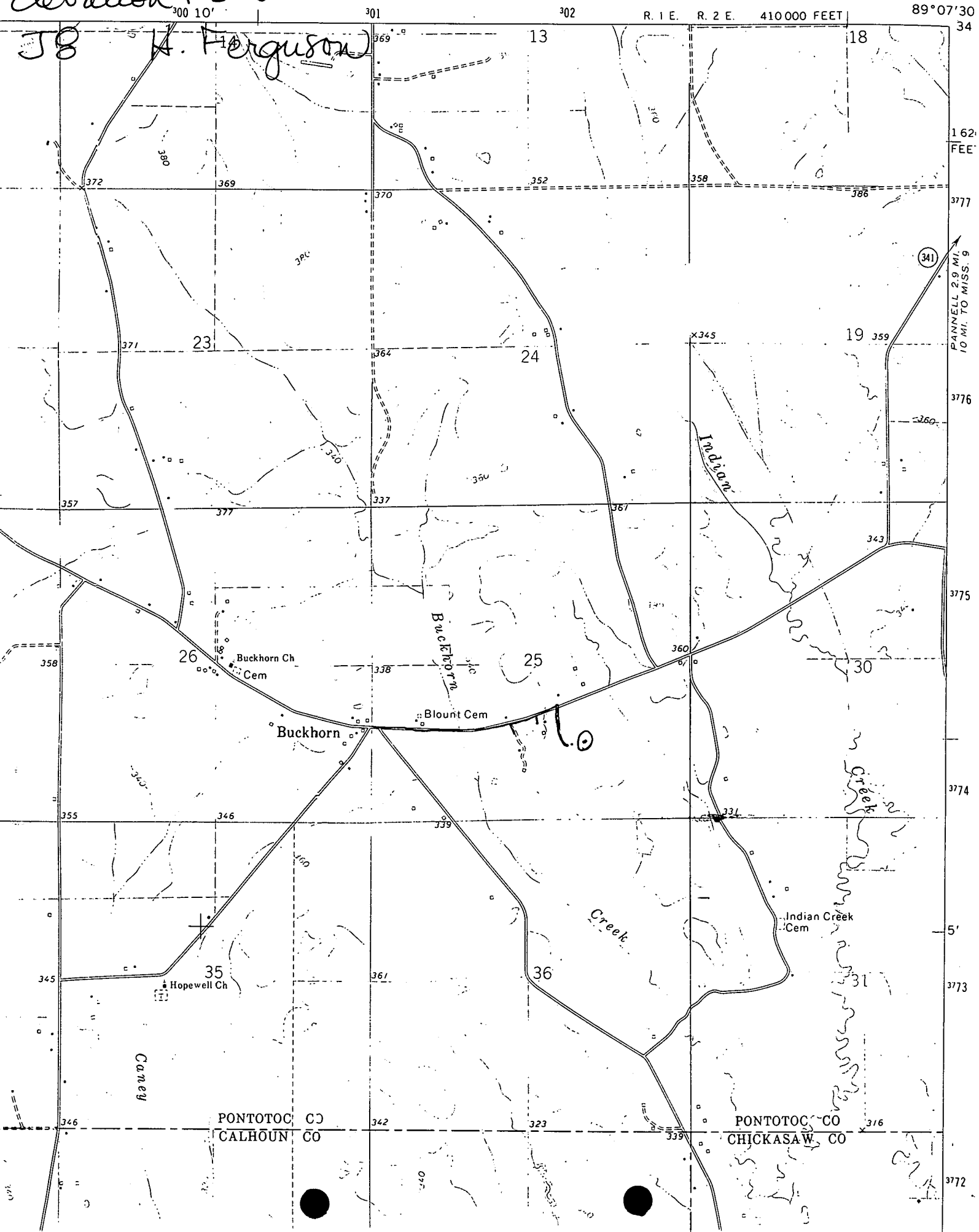

PONTOTOC CO  
CALHOUN CO

PONTOTOC CO  
CHICKASAW CO

34  
162  
FEE'  
377  
376  
375  
374  
5'  
373  
372