

Abandoned before 1985 Sherman

Sherman

WRD Exp. (GW)  
April 1966

Well No. D19  
Elog # 25

WELL SCHEDULE

U. S. DEPT. OF THE INTERIOR

GEOLOGICAL SURVEY

WATER RESOURCES DIVISION

MASTER CARD RN

Record by BE Watson Source of data BOWC Date 3/3/72 Map Sherman

State Miss County 28 Pontotoc (or town) 518

Latitude: 34 21 52 N Longitude: 08 8 50 35 Sequential number: 1

Lat-long accuracy: 3 T. 8 S. R. 4 W. Sec 26, NE, NE, NE

Local well number: D019AA2608S04E Other number: B & M

Local use: 025 Owner or name: SHERMAN Address: \_\_\_\_\_

Ownership: (C) County, (F) Fed Gov't, (M) Corp or Co, (N) Private, (P) State Agency, (S) Water Dist, (W) \_\_\_\_\_ M

Use of water: (A) Air cond, (B) Bottling, (C) Comm, (D) Dewater, (E) Power, (F) Fire, (H) Dom, (I) Irr, (M) Med, (N) Ind, (P) P.S., (R) Rec, (S) Stock, (T) Instit, (U) Unused, (V) Repressure, (W) Recharge, (X) Desal-P S, (Y) Desal-other, (Z) Other P

Use of well: (A) Anode, (D) Drain, (G) Seismic, (H) Heat Res, (O) Obs, (P) Oil-gas, (R) Recharge, (T) Test, (U) Unused, (W) Withdraw, (X) Waste, (Z) Destroyed W

DATA AVAILABLE: Well data  Freq. W/L meas.:  Field aquifer char.

Hyd. lab. data: \_\_\_\_\_

Qual. water data; type: USGS 4/72

Freq. sampling: 0 Pumpage inventory: no period: \_\_\_\_\_

Aperture cards: \_\_\_\_\_

Log data: E-log 4-882

WELL-DESCRIPTION CARD

SAME AS ON MASTER CARD Depth well: \_\_\_\_\_ ft 847 Meas. rept accuracy 3

Depth cased; (first perf.) \_\_\_\_\_ ft 676 Casing type: Steel; Diam. 10x6 in 10

Finish: (C) concrete, (F) porous gravel w. (G) gravel w. (H) horiz. open (I) screen, (J) gallery, (K) end, (L) perf., (M) screen, (N) sd. pt., (O) shored, (P) open hole, (Q) other 5

Method Drilled: (A) air bored, (B) cable, (C) dug, (D) hyd rot., (E) air percussion, (F) reverse, (G) trenching, (H) driven, (I) wash, (J) other 4

Date Drilled: 1-19-68 968 Pump intake setting: \_\_\_\_\_ ft \_\_\_\_\_

Driller: Hammond-Hammon well co.

Lift (type): (A) air, (B) bucket, (C) cent., (D) jet, (E) multiple, (F) multiple, (G) none, (H) piston, (I) rot., (J) submerg, (K) turb., (L) other Deep Shallow

Power (type): (A) diesel, (B) elec, (C) gas, (D) gasoline, (E) hand, (F) gas, (G) wind, (H) H.P., (I) LP, (J) Trans. or meter no. 30

Descrip. MP 395 ft above below LSD. Alt. MP \_\_\_\_\_

Alt. LSD: \_\_\_\_\_ Accuracy: (source) 4

Water Level \_\_\_\_\_ ft above below MP; \_\_\_\_\_ ft above below LSD Accuracy: D

Date meas: 167 Yield: 200 gpm 200 Method determined 61

Drawdown: \_\_\_\_\_ ft 100 Accuracy: \_\_\_\_\_ Pumping period \_\_\_\_\_ hrs \_\_\_\_\_

QUALITY OF WATER DATA: Iron \_\_\_\_\_ Sulfate \_\_\_\_\_ Chloride \_\_\_\_\_ Hard. \_\_\_\_\_

Sp. Conduct 580 K x 10<sup>6</sup> 4 Temp. °F 195 Date sampled 472

Taste, color, etc. pH = 8.3

1987  
WL = 219.93

Problem - Permit for D56 says that it is 58008-01  
Health # 580008-01

10-29-92  
241.00  
3.32  
237.68  
- 2.00450  
235.68

10/11/78  
WL = 188.92

TOPO



Well No. D19

Well No. D19

Latitude-longitude \_\_\_\_\_  
d m s d m s

HYDROGEOLOGIC CARD

SAME AS ON MASTER CARD Physiographic Province: 03 Section: \_\_\_\_\_

Drainage Basin: D Subbasin: 13C

Topo of well site: (D) depression, stream channel, dunes, flat, (H) hilltop, sink, swamp, (V) valley flat

MAJOR AQUIFER: system \_\_\_\_\_ series K3 aquifer, formation, group EZ

Lithology: US Origin: L Aquifer Thickness: \_\_\_\_\_ ft

Length of well open to: \_\_\_\_\_ ft Depth to top of: 670 ft

MINOR AQUIFER: system \_\_\_\_\_ series \_\_\_\_\_ aquifer, formation, group \_\_\_\_\_

Lithology: \_\_\_\_\_ Origin: \_\_\_\_\_ Aquifer Thickness: \_\_\_\_\_ ft

Length of well open to: \_\_\_\_\_ ft Depth to top of: \_\_\_\_\_ ft

Intervals Screened: 676-696 773-783 807-847

Depth to consolidated rock: \_\_\_\_\_ ft Source of data: \_\_\_\_\_

Depth to basement: \_\_\_\_\_ ft Source of data: \_\_\_\_\_

Surficial material: \_\_\_\_\_ Infiltration characteristics: \_\_\_\_\_

Coefficient Trans: \_\_\_\_\_ gpd/ft Coefficient Storage: \_\_\_\_\_

Coefficient Perm: \_\_\_\_\_ gpd/ft<sup>2</sup>; Spec cap: \_\_\_\_\_ gpm/ft; Number of geologic cards: \_\_\_\_\_

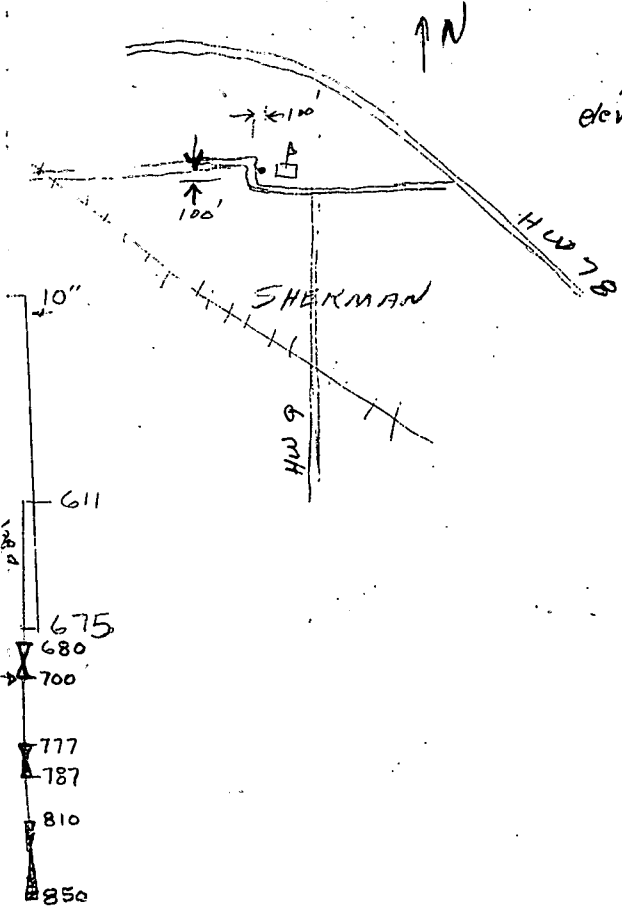

158 customers  
100,000 gal. elevated storage tank

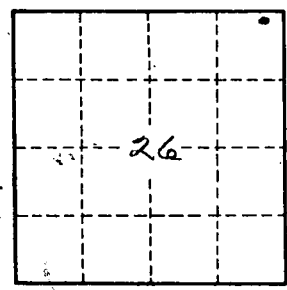

For key, see Mr. W.G. Littlejohn  
city clerk  
works at bank  
WL by airline only

Well No. D19

**CODED**

ELOG # 25

*Permit*

**D-19**

**3-68**

MISSISSIPPI  
 BOARD OF WATER COMMISSIONERS  
 416 North State Street  
 Jackson, Mississippi 39201

**CODED**

WATER WELL DRILLERS LOG  
 Herndon-Homan Well & Supply, Inc.  
 P. O. Box 42

3/27 19 <sup>68</sup>  
 date well completed

SHANNON, MISSISSIPPI 38860 county well located *Postoffice*

LANDOWNER:  
*Town of Sherman*  
*Sherman Miss.*  
 (mailing address)

WELL LOCATION:  
 sec. 26 T. 8 N. R. 4 E  
 NE 1/4 S NE 1/4 W  
 \_\_\_\_\_ miles \_\_\_\_\_ of \_\_\_\_\_  
 (distance) (direction) (nearest town)

WELL PURPOSE: TOWN  
 (home, irrigation, municipal, industrial)

WELL COMPLETION DATA:

(1) diameter (inches) 10

(2) total depth (feet) 850

(3) static water level (feet) 155 below above top of ground.

(4) casing steel 675  
 (material) (depth)  
10"  
 (size) If telescope see back.

(5) screen 70' 304 55  
 (length) (depth to top)  
6" (size) (material)

(6) pump 30 200  
 (HP) (yield gpm)  
electric  
 (type power)

(7) electric log yes  
 (yes or no)  
USGS  
 (organization running log)

(8) how well bottom plugged g/w

description of formations encountered	from	to
Red clay + sand	0	12
Blue clay	16	18
Light sand +	186	-
Blue clay		27
Coarse sand	278	38
Blue clay	385	42
Sand + clay streaks	424	43
Blue clay	436	57
Light sand	578	64
Shale	670	67
ENTRUS SAND	674	73
Shale	736	75
SAND	750	79
Shale	795	80
SAND	805	86
Plate clay	860	88
BOTTOM	880	

**CODED**

MISS. BD. OF  
 WATER COM. 8 1968

DRILLERS REMARKS:

If well telescopes please sketch and show depths.

GROUND LEVEL

675'

10'

top of LAP pipe  
611'

675

695

772

782

805

64' 11" Black

20' Screen

77' 3" Black

10' Screen

23' 11" Black

40' Screen

SECTION \_\_\_\_\_

Please indicate well location X.

ADDITIONAL INFORMATION

If more than one screen, show locations of each on sketch.

NY 11 MI. 3290000E 330 331 50' R 4 E R 5 E 333

